

PING PONG TABLE

M251

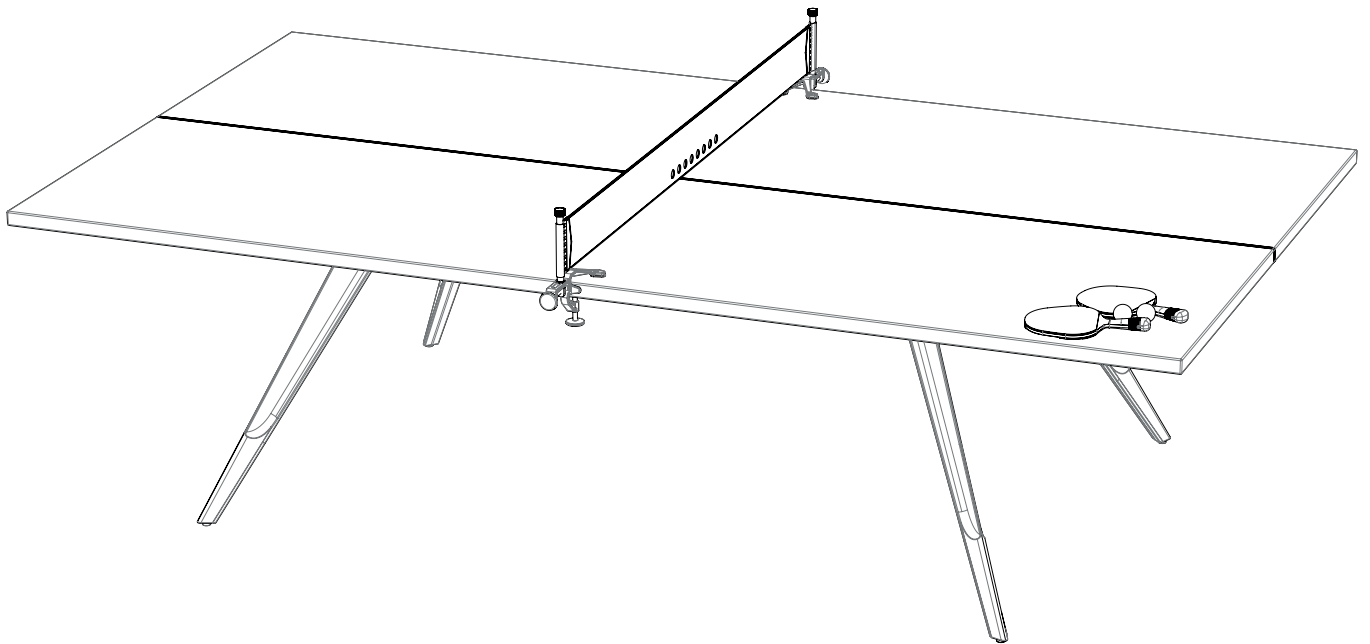

DISTRICT EIGHT

CARE INSTRUCTIONS

Thank you for purchasing a piece of District Eight furniture. To make sure the design you have chosen remains looking it's best please follow these care instructions.

Metal and wood components can be cleaned using a clean cloth and if you feel it is needed, use Pledge or any other wax based furniture polish to restore your furniture's lustre.

Leather finished designs should be vacuumed regularly to remove dust using the small soft bristle attachment. Remove dirt by wiping with a damp cloth and drying immediately with a clean dry cloth. Avoid placing near heat or in direct sunlight.

www.districteight.com

SUPPLIED COMPONENTS

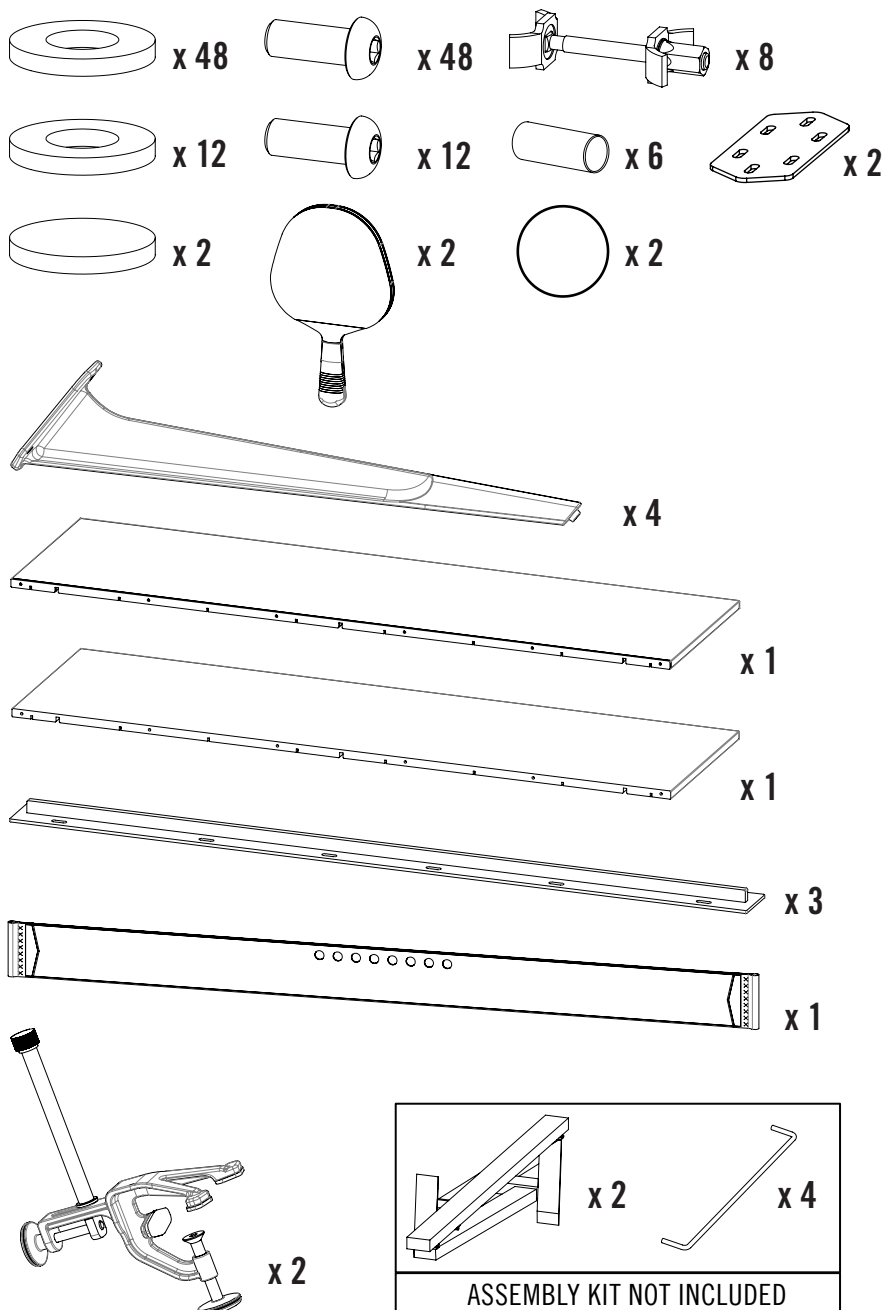

TOOLS NEEDED



RECOMMENDED TOOLS

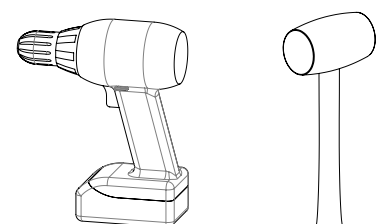

DISTRICT EIGHT

ASSEMBLY STEPS

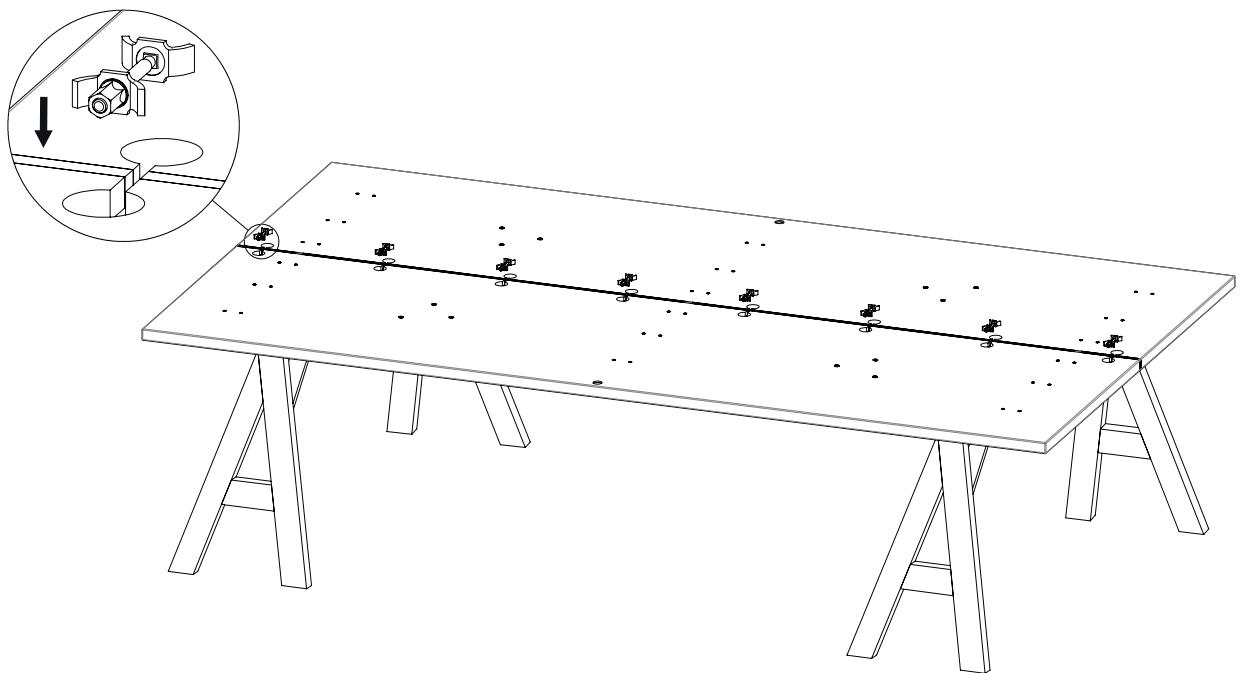
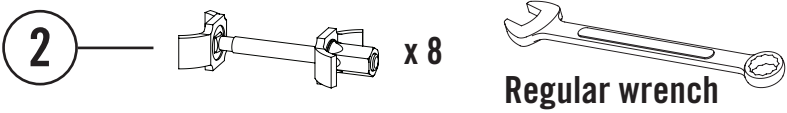
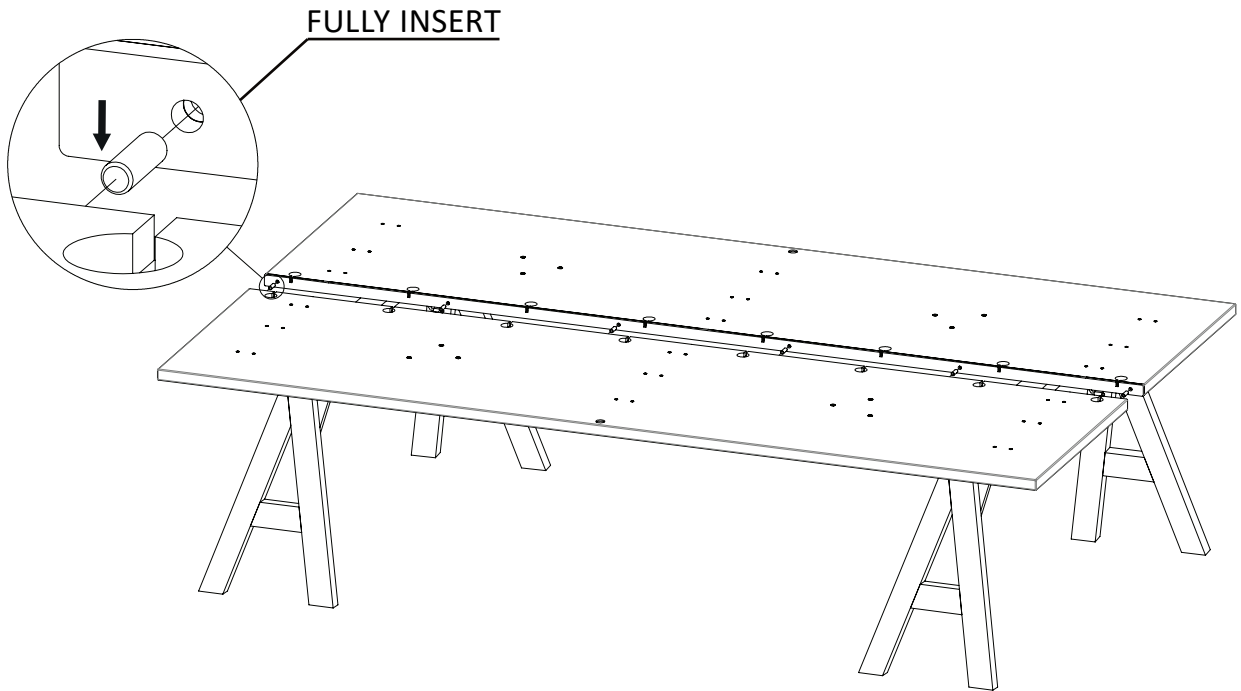

ASSEMBLY STEPS

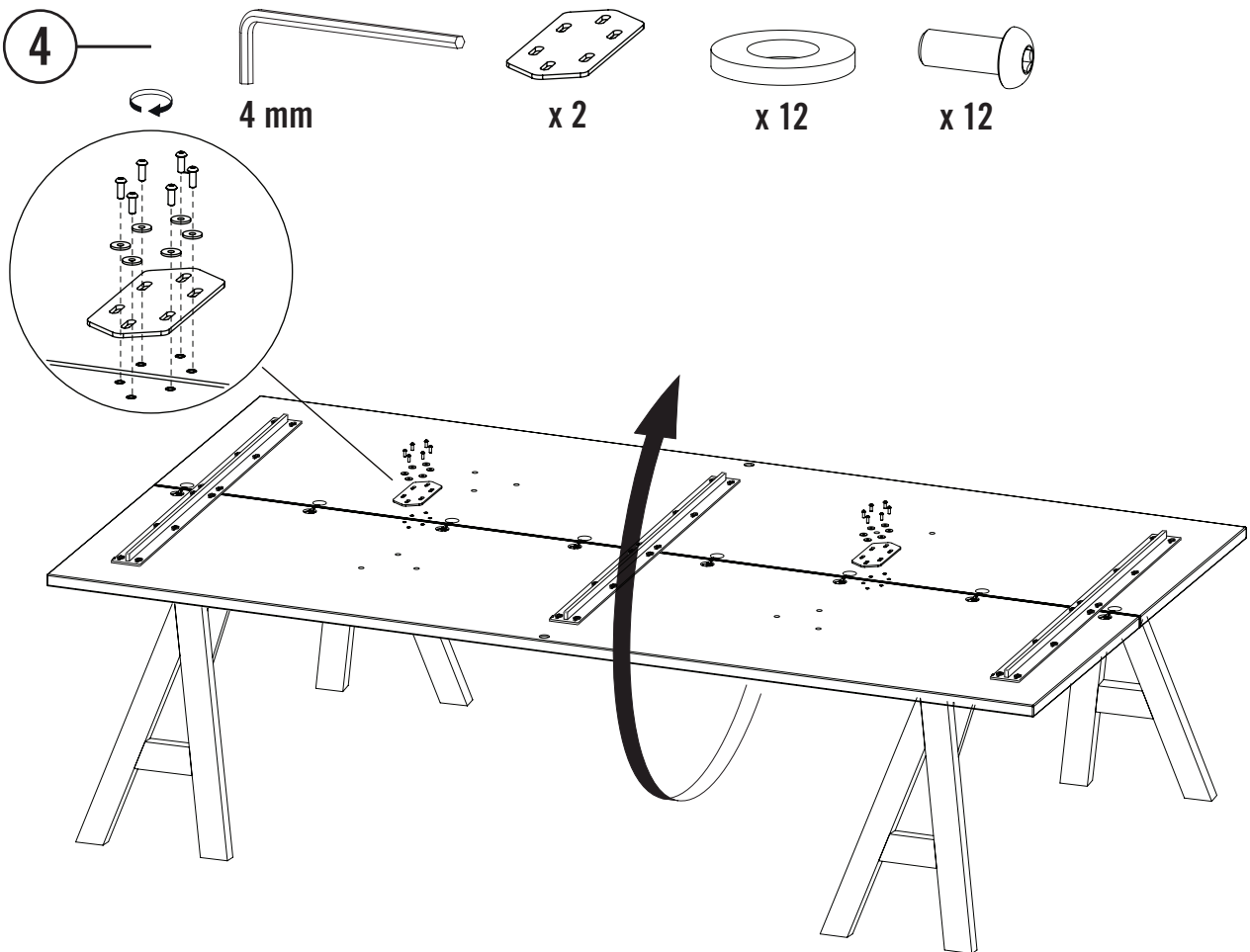
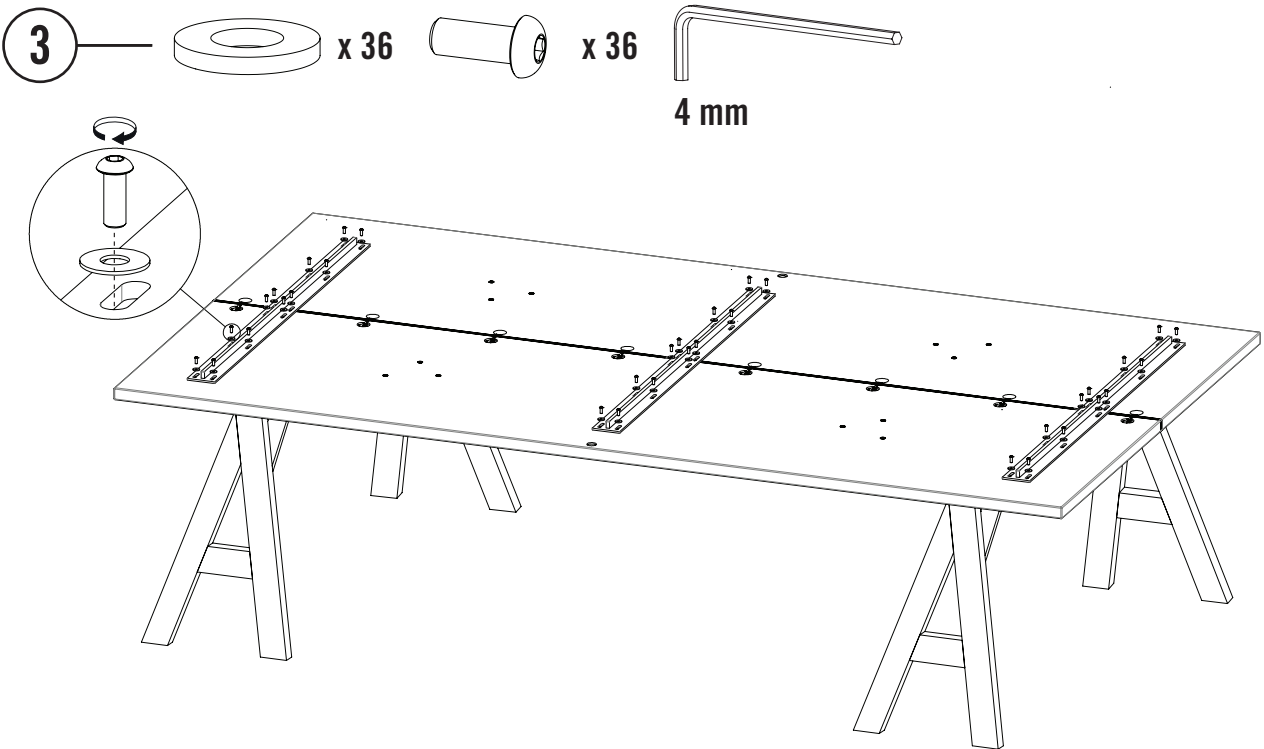

ASSEMBLY STEPS

5



5 —  x 12  x 12



6 mm

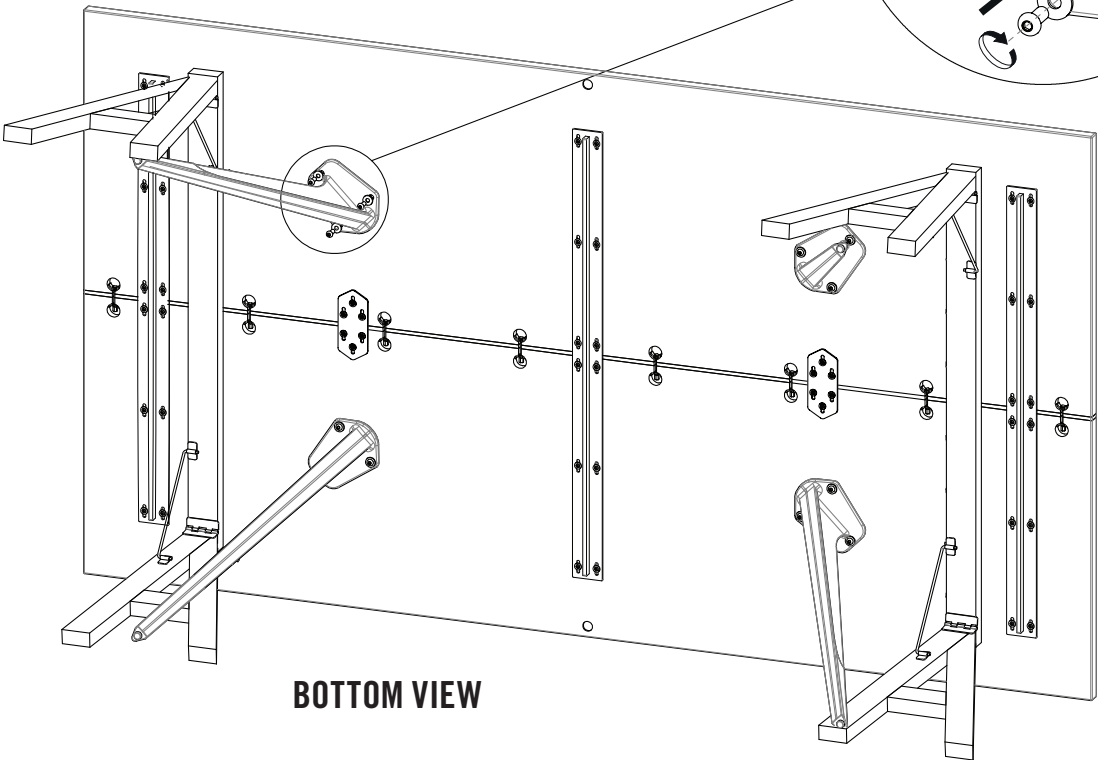
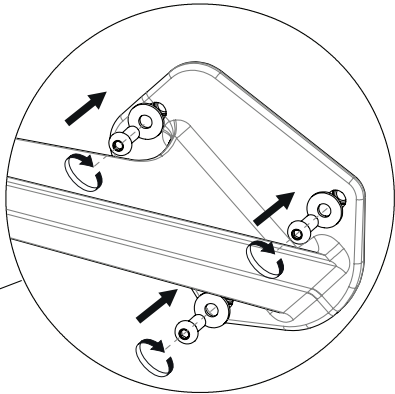

DISTRICT EIGHT

ASSEMBLY STEPS

7

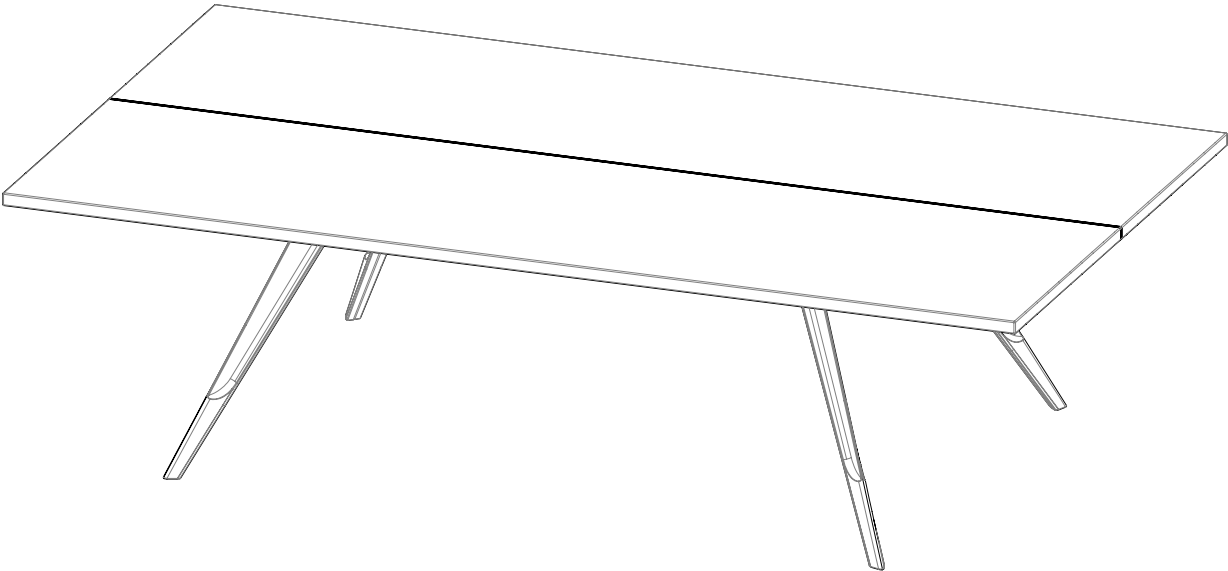

8

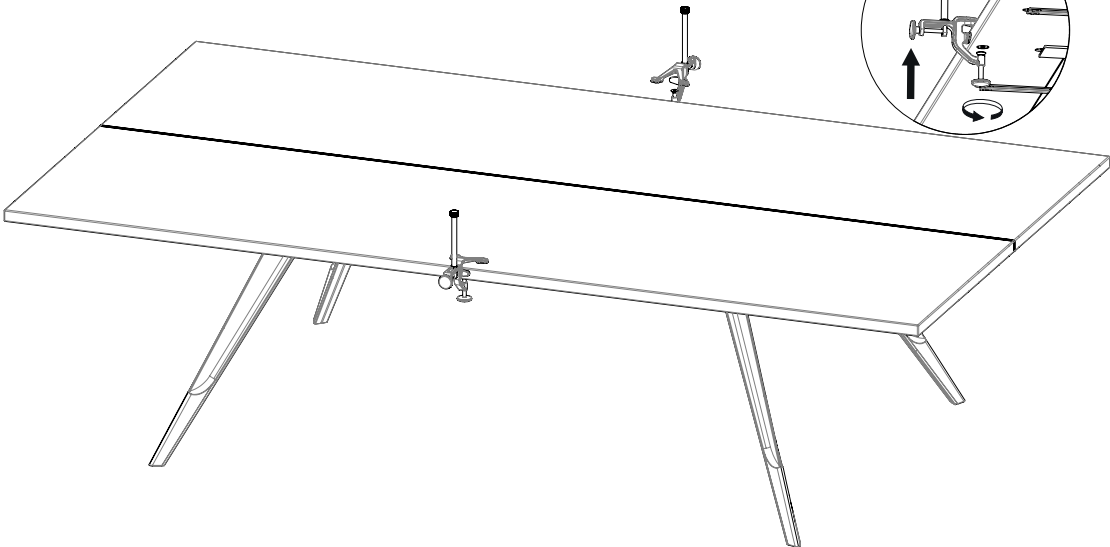
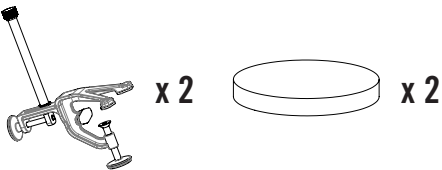

ASSEMBLY STEPS

