

# ASSEMBLY INSTRUCTION

## Langham Motion LAF PC

### Components

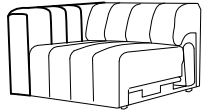

A  
x1

Hardware List			
a		Transformer	1
b		Charger	1

### Assembly Instructions

- ① Pull the power input wire from the back of the body, connect with the transformer and charger.

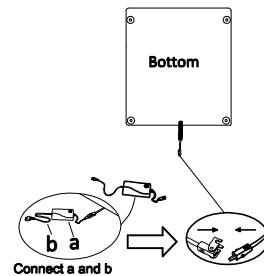
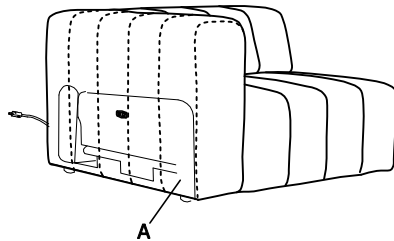

- ② Take out the wire connector from the side and connect with other pieces.

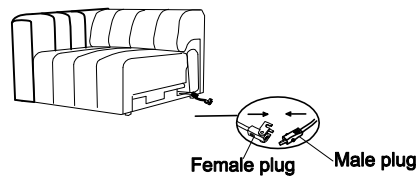

# ASSEMBLY INSTRUCTION

## Langham Motion LAF PC

- ③ Find switch panel on the side of the seat cushion .

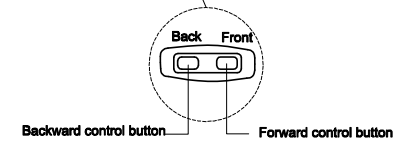
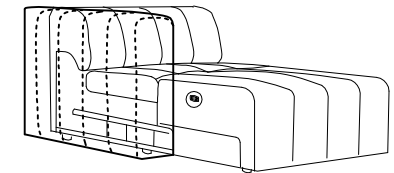
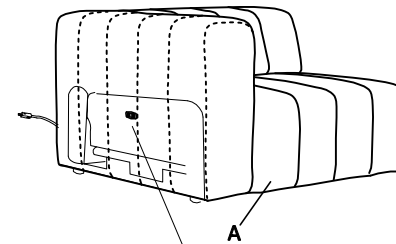

- ④ Each charger can support running maximum 3 pieces at the same time.

