



Specifier: _____ Date: _____

Project name: _____

Project location: _____

1100LED [LED]

Name: Conical Accord Pendant 1100 LED
Collection: Conical
Application: Pendant
Construction: Natural Wood Venner, MDF and Acrylic

Specifications

Light Source:	Integrated LED Module
Driver Location	Canopy
Color Temperature:	3000K, 3500K and 4000K
Dimming Option:	0-10V OR ELV/TRIAC
CRI:	90
Delivered Lumens:	550 lm
Total Power:	8 W
Input Voltage:	120V - 277V
Input Frequency:	60 Hz
Canopy Dimension	N/A
Height Adjustment Limit:	10'
Weight:	N/A

Fixture Image



Technical Drawing

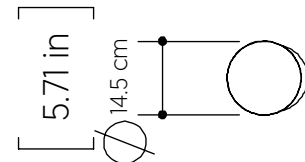

Photometric Graph



Standards

