

## Installation & Bulb Changing Instructions

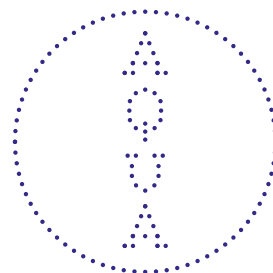

---

Maestro  
Designed by Aqua Creations



Aqua Creations  
Lighting & Furniture Atelier

# Aqua Creations Lighting & Furniture Atelier

## Maestro

### Silk Care Instructions

For optimal maintenance vacuum the silk frequently (make sure the vacuum cleaner is at low suction and use a clean attachment) and avoid direct sunlight or smoke. To remove stains use upholstery foam cleaner (as these vary from country to country, testing the product on a hidden spot first is recommended). In case of heavier dirt use a moist sponge and make sure to move it along the crushed line of the silk.

Please do not clean coated lamps with water.

Note that any good quality silk fibers weaken when exposed to sun and natural dyes may fade. Hence, avoid direct sunlight on the silk lights.

---

#### 220-240 V Model

CFL with ECG dimmable [Type C] 4 x 55W bulbs

Optional:

CFL with ECG dimmable [Type E] 4 x 55W bulbs

CE Certified

#### 120 V Model

CFL with ECG dimmable [Type C] 4 x 55W bulbs

Optional:

CFL with ECG dimmable [Type E] 4 x 55W bulbs

UL Listed

#### Package

Volume: 72 x 58 x 220cm, 28 x 23 x 87"

Weight: 51kg / 112.4lb

---

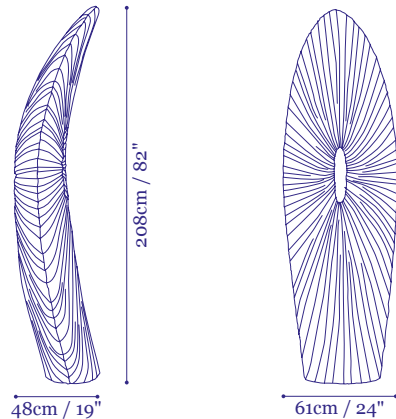

Aqua Creations  
Lighting & Furniture Atelier

Bulb Changing Instructions Maestro Floor Lamp

Caution: The base is very heavy. To prevent injury, make sure the lamp is lying on a clean cushioned surface, as shown below, before removing the screws.

1.

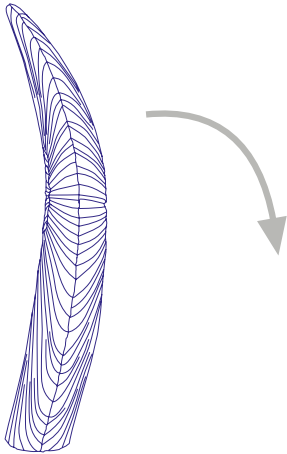

2.

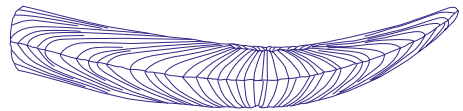

3.

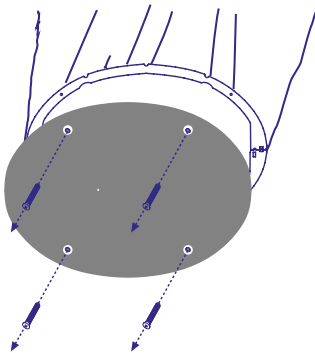

4.

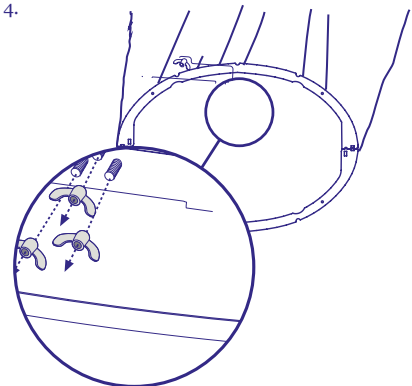

Aqua Creations  
Lighting & Furniture Atelier

Bulb Changing Instructions Maestro Floor Lamp

5.

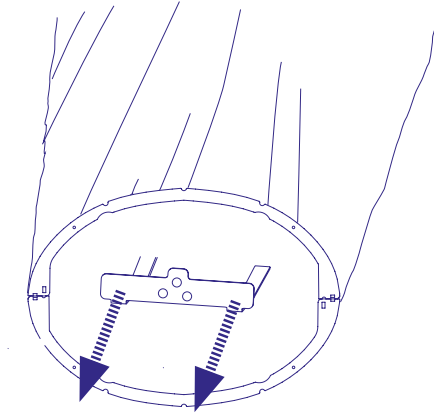

6.

