

# Simon Says No/Yes/Maybe Pendant Fixture

May 2022

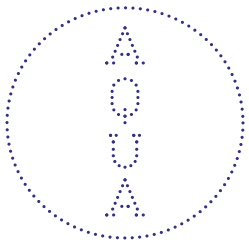

Aqua Creations  
Light that matters

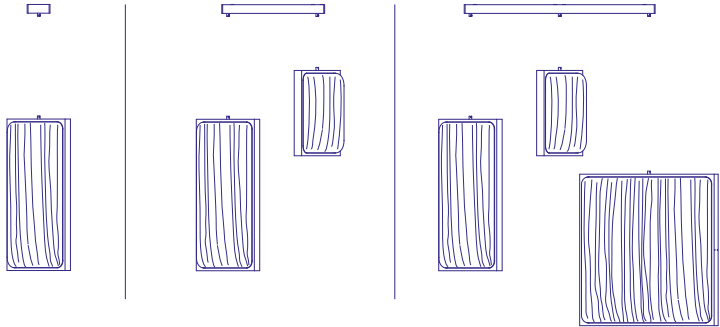

**Silk Lighting Maintenance:** All Lampshades in the Silk Lighting Collections are made of hand dyed, treated crushed silk that is resistant to mold and fire. The silk is sculpted over a metal structure. For optimal maintenance, vacuum the silk frequently and avoid direct sunlight or smoke. To remove stains use upholstery foam cleaner. (As these vary depending on manufacturer, testing the product on a hidden spot is recommended)

- 1 Install ceiling plate using the supplied bolts.

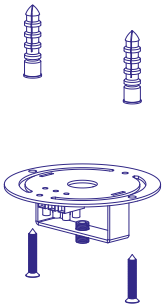

- 2 Thread the power cord through all the parts as shown and connect Power to terminal block.

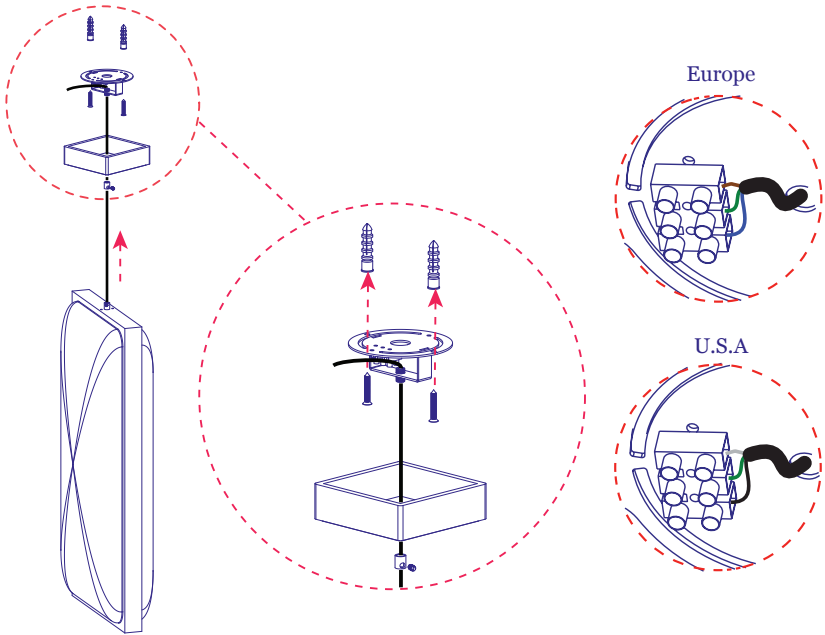

- 3 a. Screw the Stainless steel nipple to the box.  
b. Set the fixture height and tighten the plastic screw.

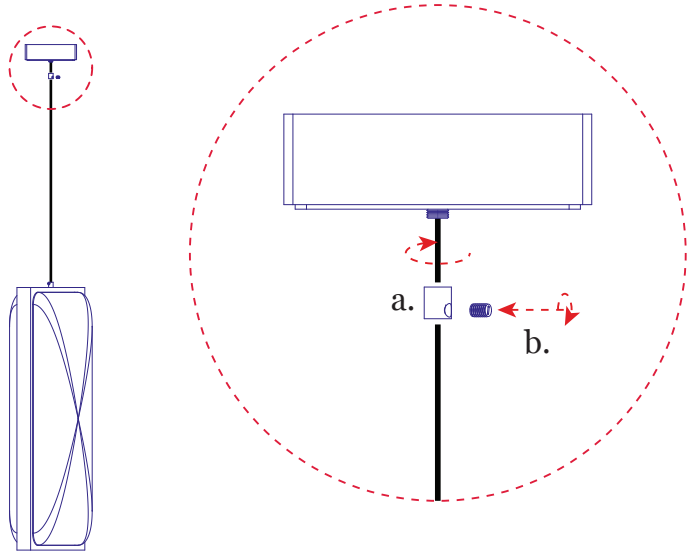

# Simon Says No/Yes/Maybe

## Pendant Fixture

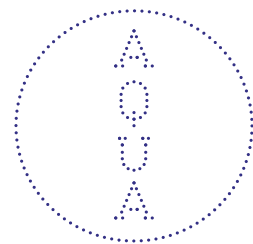

Aqua Creations  
Light that matters

### Says No

Frame option:  
Mahogany or oak wood frame

220-240 V Model  
4X 18 Watt LED Boards. Approx 32W.  
Type A dimming (Triac).  
CE Certified.

100V-120V Model  
4X 18 Watt LED Boards. Approx 32W.  
Type A dimming (Triac).  
UL Pending

Package  
Volume: 73 x 73 x 16cm, 29 x 29 x 6 in  
Weight: 8kg / 17.6lb

Dimensions

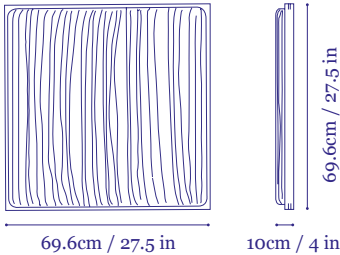

### Says Yes

Frame option:  
Mahogany or oak wood frame

220-240 V Model  
2X 9 Watt LED Boards. Approx 32W.  
Type A dimming (Triac).  
CE Certified.

100V-120V Model  
2X 9 Watt LED Boards. Approx 32W.  
Type A dimming (Triac).  
UL Pending

Package  
Volume: 42 x 36 x 16cm, 16 x 14 x 6 in  
Weight: 2.5kg / 5.5lb

Dimensions

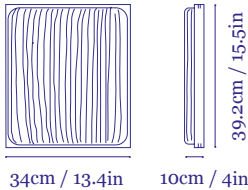

### Says Maybe

Frame option:  
Mahogany or oak wood frame

220-240 V Model  
2X 18 Watt LED Boards. Approx 32W.  
Type A dimming (Triac).  
CE Certified.

100V-120V Model  
2X 18 Watt LED Boards. Approx 32W.  
Type A dimming (Triac).  
UL Pending

Package  
Volume: 73 x 36 x 16cm, 29 x 14 x 6in  
Weight: 5.5kg / 12lb

Dimensions

