

ASSEMBLY INSTRUCTIONS

ITEM DESCRIPTION:

ITEM NO.: GADWC03 NAME: GLAZE SCULPTURAL SCONCE

MATERIAL TYPE: METAL FINISH:ANTIQUE BRASS

SOCKET TYPE: G9 SOCKET QTY:5PCS

BULB WATTAGE: 6W LED

VOLTAGE: 120V ITEM NET WEIGHT: 13.9LBS

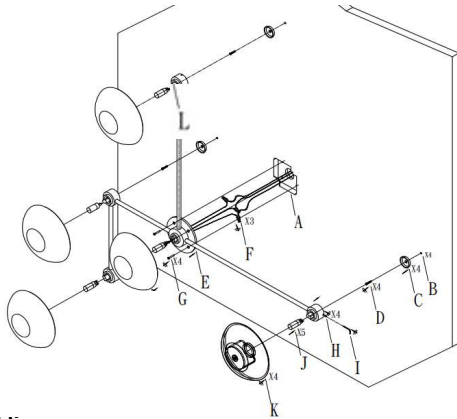

PARTS INCLUDED:

| | | | |
|----------------------|-------------------|----------------|--------|
| Anchor (B) | Qty: 4 | Metal Plate(L) | Qty: 4 |
| Mounting Plate(C) | Qty: 4 | | |
| Strengthen Screws(D) | Qty: 4 | | |
| Fixture(E) | Qty: 1 | | |
| Wire Cap(F) | Qty: 3 | | |
| Canopy Screw(G) | Qty: 4 | | |
| Set Screw(H) | Qty: 4 | | |
| Allen Wrench(I) | Qty: 1 | | |
| Bulb(J) | Qty: Not included | | |
| Ceramic Shade(K) | Qty: 5 | | |

HARDWARE INCLUDED:

| | | | |
|-----------------|--------|------------------|--------|
| Mounting Screws | Qty: 3 | Plastic Wire cap | Qty: 3 |
|-----------------|--------|------------------|--------|

TOOLS NEEDED (Not Included):

1 Screwdriver

These instructions are provided for safety. It is very important that they are read carefully and completely before beginning installation.

We strongly suggest that all hard-wired fixtures must be installed by a professional electrician.

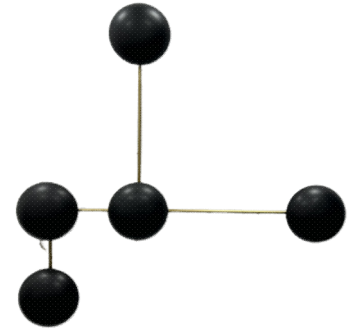

TO ASSEMBLE:

1. Shut off the main electrical supply from the main fuse box/circuit breaker.
2. Position the fixture in the desired location on the wall. The fixture features (4) holes for screw mounting. Mark these spots on the ceiling with a pencil to drill holes. Drill 4 holes at these spots and insert anchors (B) into the drilled holes.
3. Attach 4pcs mounting plate (C) to the drilled holes using the enclosed Strengthen screws (D) and tighten screws with a screwdriver.
3. Connect ground wire from wall to ground wire from lamp using wire caps(F).
4. Attach house wire to lamp wires as shown. Fasten the pairs together with a wire caps(F).
- DO NOT REVERSE THE HOT AND NEUTRAL CONNECTIONS OR SAFETY WILL BE COMPROMISED.
5. Fix the fixture (E) to the wall by using the enclosed 4 canopy screws (G) and tighten screws with a screwdriver.
6. Attach the metal plate (L) to the mounting plate (C) by using the Set Screw(H) and tighten screws with Allen Wrench (I).
7. Install 5 light bulbs into each socket (G9 LED 6W - bulbs not included).
8. Screw the ceramic shades (K) to Metal Plate(L) one by one.

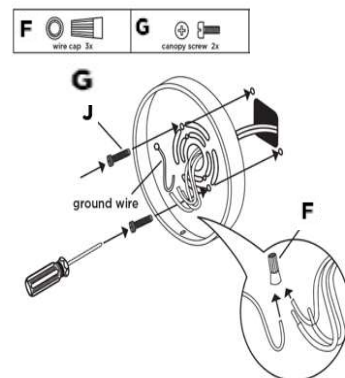

CARE INSTRUCTIONS:

Wipe with a soft, dry cloth. To protect finish, avoid the use of chemicals and household cleaners.

For customer service questions call 1-800-338-2150

ARTERIO RS