

## ASSEMBLY INSTRUCTIONS

### ITEM DESCRIPTION:

ITEM NO.:DWC101	NAME: ALICIA WALL SCONCE
MATERIAL TYPE: IRON, ONYX	FINISH: WHITE, ANTIQUE BRASS
SOCKET TYPE: : LED	SOCKET QTY: 1
BULB WATTAGE: 10W	
VOLTAGE: 100V-120V	ITEM NET WEIGHT: 7 LBS

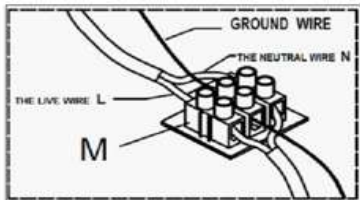

**PLEASE IGNORE THIS DEVICE  
ON THE BACK PLATE.**

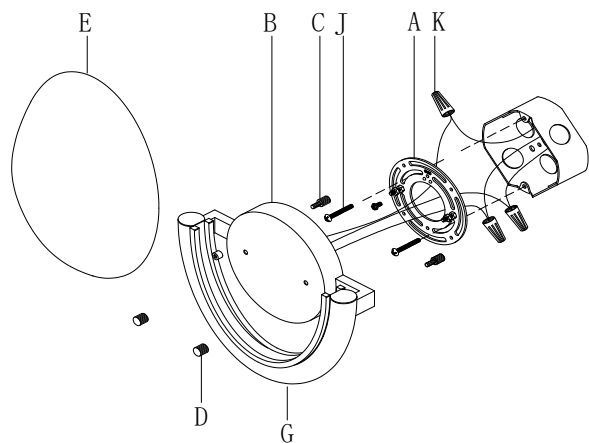

### PARTS INCLUDED:

Mounting Plate(A)	Qty: 1PC
Back Plate(B)	Qty: 1PC
Screw(C)	Qty:2PCS
Thumb Screw (D)	Qty:2PCS
Onyx Shade(E)	Qty:1PC
Lamp body (G)	Qty:1PC
Mounting Screw(J)	Qty:2PCS

### HARDWARE INCLUDED:

Green Ground Screw	Qty: 1PC
Wire Cap(K)	Qty:3PCS

### TOOLS NEEDED (Not Included):

1 Screwdriver

These instructions are provided for safety. It is very important that they are read carefully and completely before beginning installation.

We strongly suggest that all hard-wired fixtures must be installed by a professional electrician.

For customer service questions call 1-800-338-2150



### TO ASSEMBLE:

1. Shut off the main electrical supply from the main fuse box/circuit breaker.
  2. Carefully unpack all fixture parts and hardware and lay them on a soft surface for assembly.
  3. Remove mounting plate(A) from the Back Plate(B) by loosening the finial (D).
  4. Place the mounting plate(A) over the center of the junction box.
  5. Align the holes in the mounting plate (A) with the holes in the junction box and secure it with two mounting screws (J). Secure the screws using a Phillips head screwdriver.
  6. Connect ground wire from wall to ground wire from lamp using wire caps (K).
  7. Attach house wire to lamp wires as shown. Fasten the pairs together with a wire caps.
- DO NOT REVERSE THE HOT AND NEUTRAL CONNECTIONS OR SAFETY WILL BE COMPROMISED.
8. PLEASE PAY SPECIAL ATTENTION THAT YOU DO NOT NEED TO CONNECT THE TERMINAL BLOCK(M) . IT IS USED FOR THE WIRE CONNECTION FOR EURO-MARKET.
  9. Gently tuck the wire cap(K) neatly into the junction box.
  10. Attach the back Plate(B) onto the mounting plate (A) and secure it with 2 thumb screws(D).
  11. Put the onyx shade (E) in the lamp body (G) using 2 set screws (C), and tighten them.
  12. Restore power to junction box and test fixture.

Precaution: This product is suitable for TRIAC dimmer switch, switch model recommended:

LUTRON #DVL-153P  
LUTRON #DVELV-300P

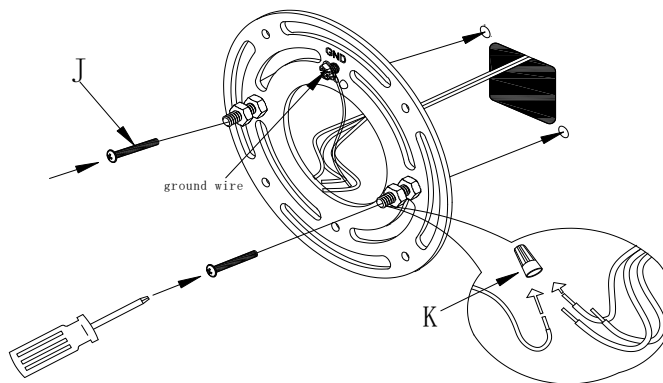

### CARE INSTRUCTIONS:

Wipe with a soft, dry cloth. To protect finish, avoid the use of chemicals and household cleaners.

ARTERIOS

# **WARNING:**

**INSTALL BEFORE RESTORING  
POWER AT THE BREAKER**

---

**LOW VOLTAGE LED DRIVER INSIDE.**

**DO NOT APPLY POWER AT THE BREAKER  
OR SWITCH UNTIL FIXTURE IS FULLY INSTALLED.  
FAILURE TO FOLLOW INSTRUCTIONS MAY RESULT  
IN MALFUNCTION AND WILL VOID WARRANTY.**