

ASSEMBLY INSTRUCTIONS

ITEM DESCRIPTION:

ITEM NO.: GADWC10 NAME: INSET OUTDOOR SCNCE

MATERIAL TYPE: METAL, GLASS FINISH: MARINE GRADE ENGLISH BRONZE,MATTE OPAL

SOCKET TYPE:LED SOCKET QTY:1

BULB WATTAGE: 20W / 2700K / 90+CRI

VOLTAGE:100V-130V ITEM NET WEIGHT:7.7LBS

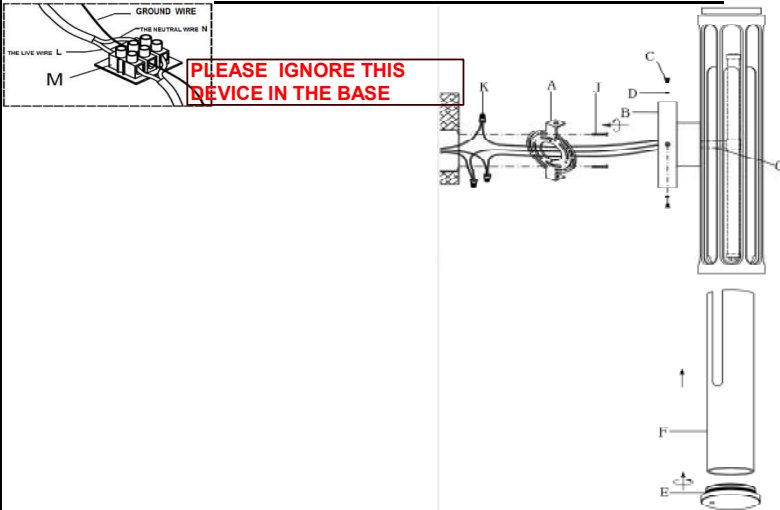

PARTS INCLUDED:

Mounting Plate (A)	Qty:1Pc	Metal Cap (E)	Qty:1Pc
Back Plate (B)	Qty:1Pc	Glass Tube (F)	Qty:1Pc
Back Plate Screw (C)	Qty:2Pcs	Metal Holder (G)	Qty:1Pc
Rubber Washer (D)	Qty:2Pcs		

HARDWARE INCLUDED:

Mounting Screws (J)	Qty: 2Pcs
Plastic Wire Cap (K)	Qty: 3Pcs

TOOLS NEEDED (Not Included):

1 Screwdriver

These instructions are provided for safety. It is very important that they are read carefully and completely before beginning installation.

We strongly suggest that all hard-wired fixtures must be installed by a professional electrician.

For customer service questions call 1-800-338-2150



TO ASSEMBLE:

1. Shut off the main electrical supply from the main fuse box/circuit breaker.
2. Carefully unpack all fixture parts and hardware and lay them on a soft surface for assembly.
3. Put the glass tube(F) through the metal holder(G) carefully, then secure with the metal cap (E) by turning into a clockwise direction. Make sure to be gentle when doing the glass assembly.
4. Attach mounting plate(A) to wall or junction box by using the mounting screws (J).
5. Please pay special attention that you do not need to connect the terminal block(M) in the base. It is used for the wire connection for EURO-market.
6. Connect ground wire from wall to ground wire from lamp by using wire caps (K).
7. Attach house wire to lamp wires as shown. Fasten the pairs together with a wire caps(K) DO NOT REVERSE THE HOT AND NEUTRAL CONNECTIONS OR SAFETY WILL BE COMPROMISED.
8. Attach back plate (B) to mounting plate (A) by using enclosed back plate screw(C) and rubber washer(D). Then tighten screws with screwdriver. Please be sure the rubber washer(D) is on top threading of the plate screws(C). **NOTES: The leaking hole is placed at bottom.**
9. Use the outdoor silicone caulking compound to caulk completely along the rim of back plate(B) where it meets the wall surface, but leaving a space without the caulking compound at the bottom of back plate to allow the water to seep out if water entered into the J-Box by accident. See more details on extra page.
10. Restore power to junction box and test fixture.

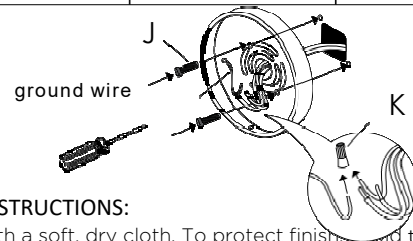
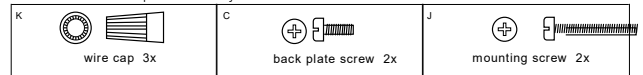

CARE INSTRUCTIONS:

Wipe with a soft, dry cloth. To protect finish, avoid the use of chemicals and household cleaners.

ARTERIO RS

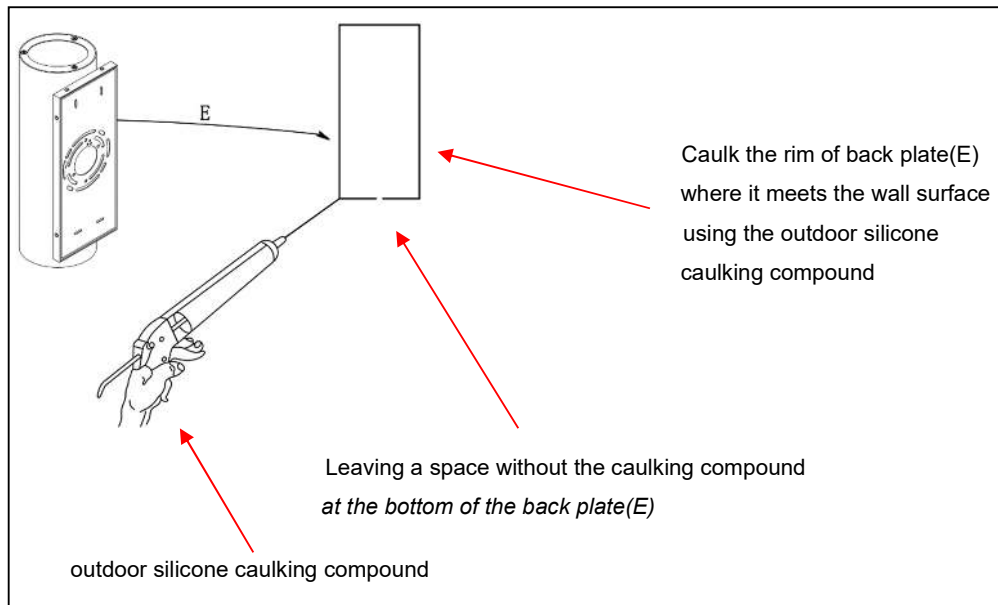

To prevent the water from entering the J-box and causing a short circuit, use the outdoor silicone caulking compound to caulk completely along the rim of back plate(E) where it meets the wall surface, but leaving a space without the caulking compound at the bottom of back plate(E).

NOTE: Mounting surface should be clean, dry, flat, and a 1/4 inch larger than the back plate(E) on all sides.

OUTDOOR INSTALLATION

Use silicone caulk to seal fixture where the mounting plate meets the surface to prevent water from seeping in.