

## ASSEMBLY INSTRUCTIONS

### ITEM DESCRIPTION:

ITEM NO.: DWC69	NAME:ITZIA SCONCE
MATERIAL TYPE: METAL	FINISH: ANTIQUE BRASS
SOCKET TYPE:E12	SOCKET QTY: 4
BULB WATTAGE: 40W or /CFL 9W or /LED 4W	
VOLTAGE:110V-120V	ITEM NET WEIGHT:3.74LBS

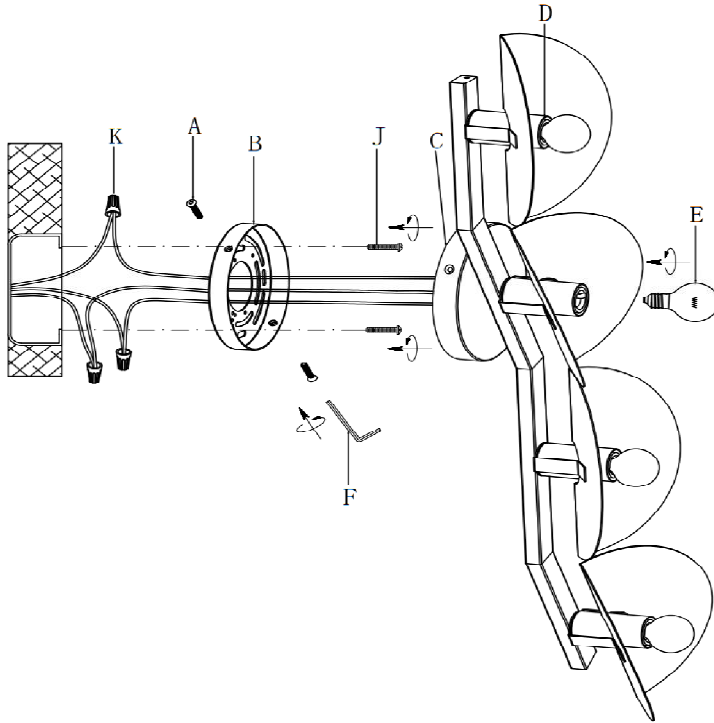

### PARTS INCLUDED:

Canopy Screw (A)	Qty: 2 Pcs
Mounting Plate (B)	Qty: 1 Pc
Back Plate (C)	Qty: 1 Pc
Socket (D)	Qty: 4 Pcs

### HARDWARE INCLUDED:

Mounting Screws (J)	Qty: 2 Pcs
Plastic Wire Cap (K)	Qty: 3 Pcs
Allen Wrench (F)	Qty: 1 Pc

### TOOLS NEEDED (Not Included):

1 Screwdriver

These instructions are provided for safety. It is very important that they are read carefully and completely before beginning installation.

We strongly suggest that all hard-wired fixtures must be installed by a professional electrician.

## TO ASSEMBLE:

1. Shut off the main electrical supply from the main fuse box/circuit breaker.
2. Attach mounting plate(B) to wall or junction box using mounting screws (J).
3. Connect ground wire from wall to ground wire from lamp using the wire caps (K).
4. Attach house wire to lamp wires as shown. Fasten the pairs together with a wire caps(K) . DO NOT REVERSE THE HOT AND NEUTRAL CONNECTIONS OR SAFETY WILL BE COMPROMISED.
5. Attach back plate (C) to mounting plate (B) by inserting canopy screws (A) through predrilled holes.Then tighten by using allen wrench(F).
6. Insert 4 TYPE-G 40W or/CFL 9W or /LED 4W bulb (not included) into socket (D).  
**DO NOT EXCEED SPECIFIED WATTAGE OF SCONCE.**
7. Restore power to junction box and test fixture.

### CARE INSTRUCTIONS:

Wipe with a soft, dry cloth. To protect finish, avoid the use of

For customer service questions call 1-800-338-2150

ARTERIO RS