

## ASSEMBLY INSTRUCTIONS

ITEM NO.: FDI07 NAME: Maddock Dining Table

MATERIAL TYPE: Mango Wood / Bone

FINISH: Ebony / Gray

ITEM NET WEIGHT: 141 LBS

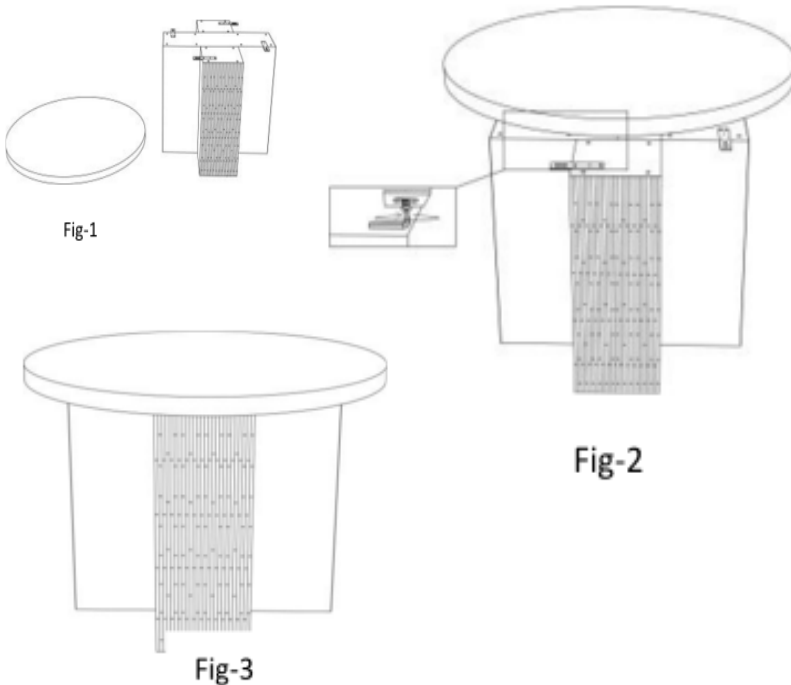

### PARTS INCLUDED:

Top	Qty: 1 Pc
Base	Qty: 1 Pc
Allen Key	Qty: 1 Pc
Bolt And Washer	Qty: 4 Pcs

Note: Hardware may get lose over the time and needs to tight



### PRE ASSEMBLY

- Open the box on the soft flat surface.
- Do not throw away packaging materials until assembly is complete

### TO ASSEMBLE:

1. Firstly, Place the wooden base and wooden top on the floor, as shown in the Fig-1
2. Position the top onto the base, aligning the threaded screw on the top with the hole on the base as illustrated in FIG.2. Secure the bolt tightly using the allen key from underneath.
3. Your dining table is now assembled, as shown in Fig-3.
4. Place it in your desired location.

### CARE INSTRUCTIONS:

Wipe with a soft, dry cloth. To protect finish, avoid the use of chemicals and household cleaners.

Avoid use of sharp object over the wooden Top

For customer service questions call 1-800-338-2150

A R T E R I O R S