

# DIAGRAM OF INSTALLATION STRUCTURE

SKU No. :CE1009080 Product Size: L10"\*W3.9"\*H23"

Light Source: E12 Bulb

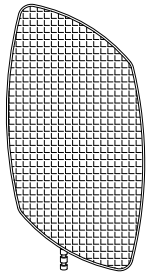
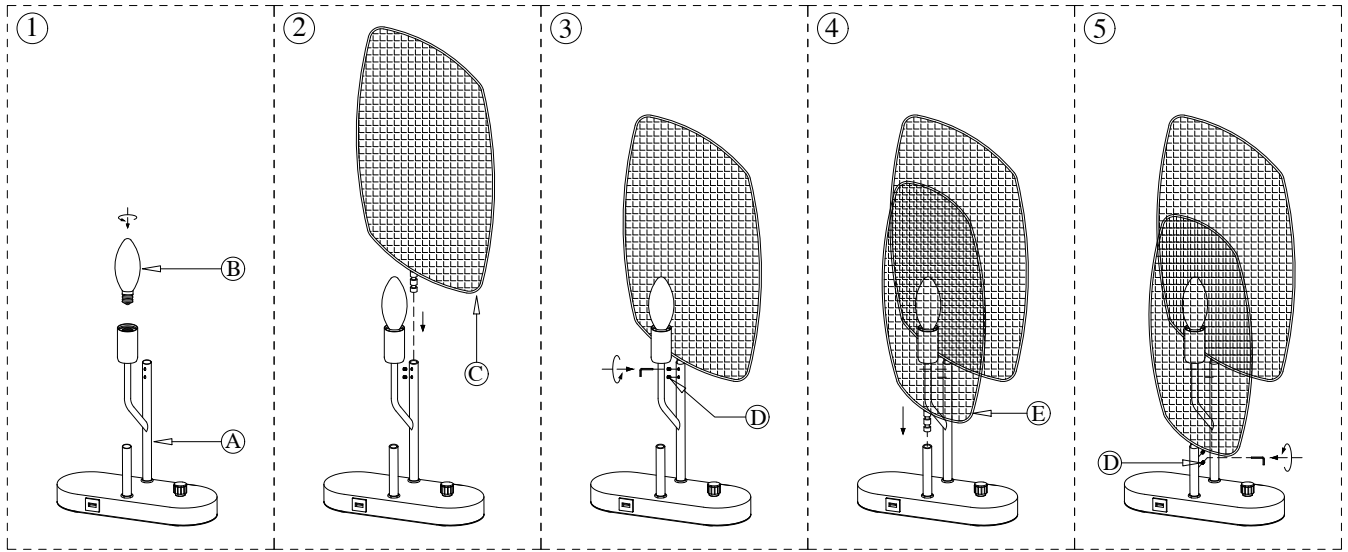

Bamboo Fan Plate-A

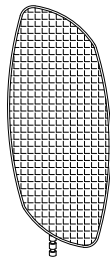

Bamboo Fan Plate-B

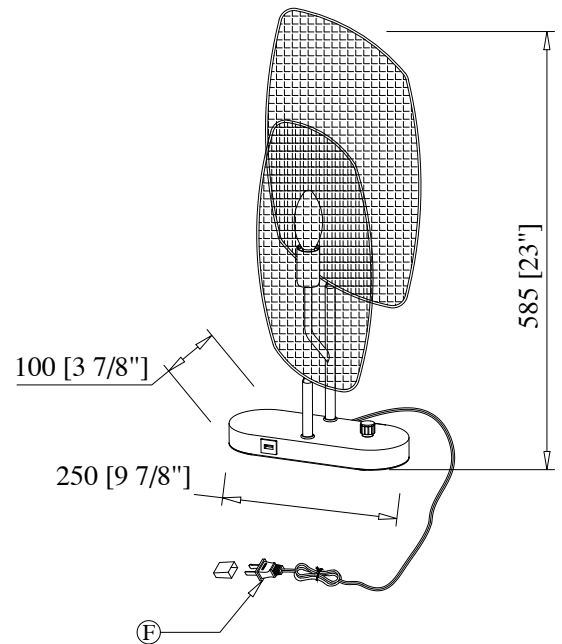

(A) Fixture Body

(B) E12 Bulb

(C) Bamboo Fan Plate-A

(D) Hex Headless Screw

(E) Bamboo Fan Plate-B

(F) UL Plug

## Installation instruction

- 1.Unpack and take out the fixture / accessory bag, then screw E12 bulb(B) into the fixture body(A).
- 2.Insert the bamboo fan plate-A(C) into the long tube of fixture body(A), and secure it with hex headless screw(D) as the shown.
- 3.Insert the bamboo fan plate-B(E) into the short tube of fixture body(A), and secure it with hex headless screw(D) as the shown.
- 4.Insert the UL plug(F) into power socket, then turn on the power.