



VIDALITE

# DIAGRAM OF INSTALLATION STRUCTURE

SKU No.: CE1009390

Product Size: W15 1/4" \* H18 1/2" \* Ext 8 1/4"

Light Source: B10 E12 Bulb

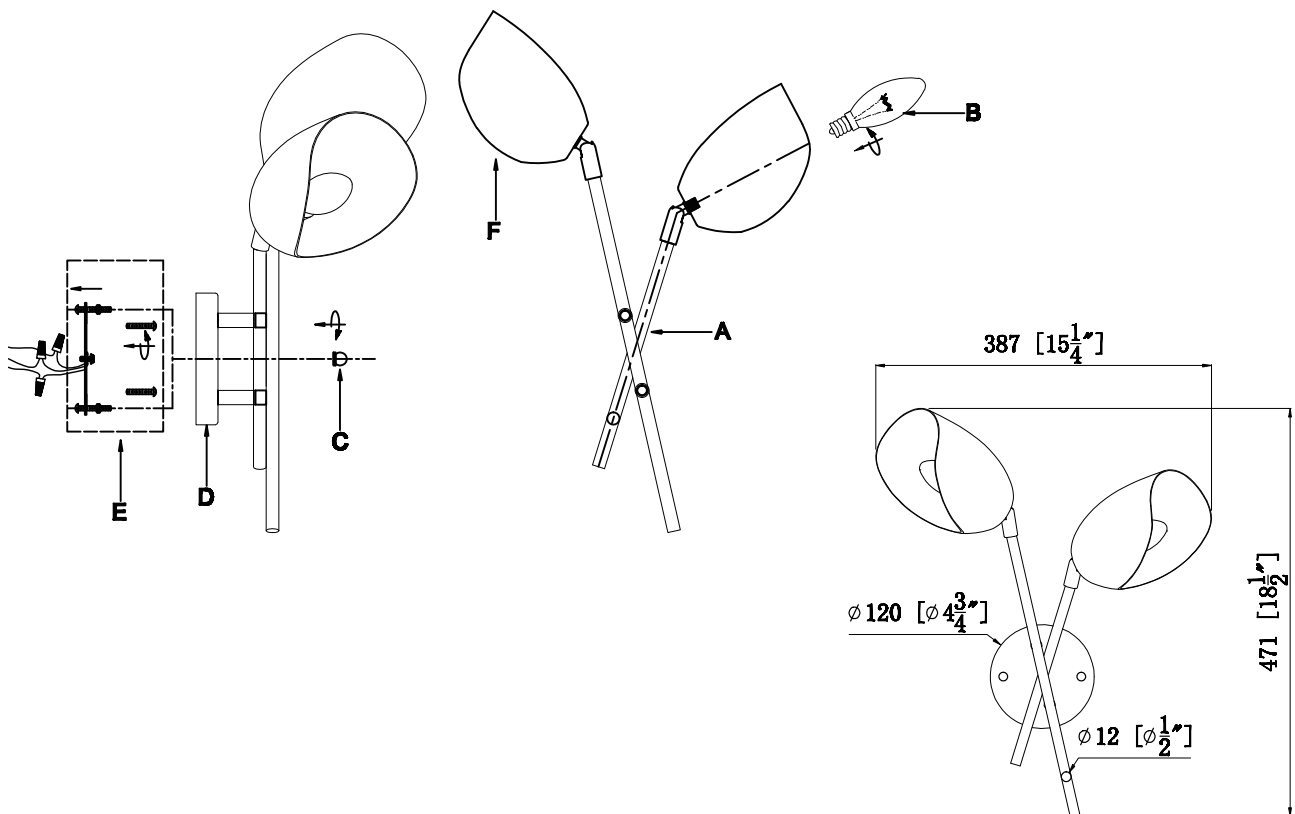

- A: Fixture
- B: B10 E12 Bulb(Not Included)
- C: Mounting caps
- D: Backplate
- E: Mounting hardware
- F: Shades

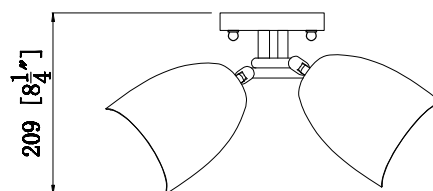

## Installation Instruction

1. Turn off the power.
2. Fasten mounting hardware(E) to junction box with machine screws.
3. Raise the fixture(A) over to the wall and do the wire connection.
4. Tighten mounting caps (C) to secure fixture(A) to wall.
5. Screw recommended bulbs(B) ( B10 E12 bulb type, not included) into socket.
6. Adjust the shades to the desired angle.
7. After finish the installation, turn on the power.