

TOILET ROLL HOLDER / CAST
INSTALLATION MANUAL

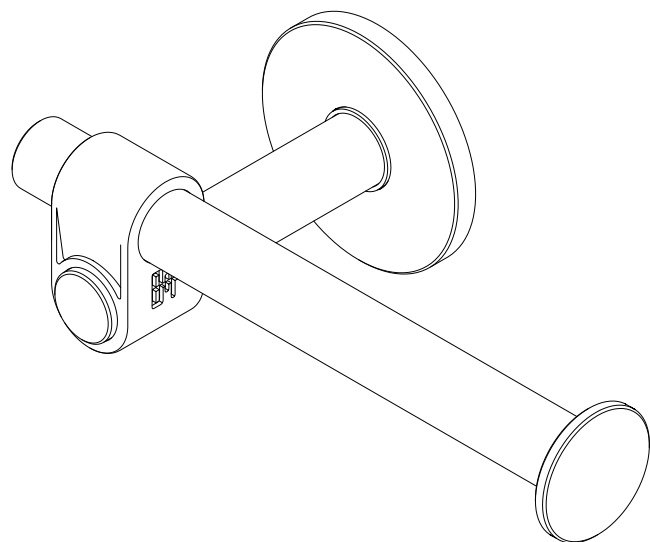

CONTENTS
NOT TO SCALE

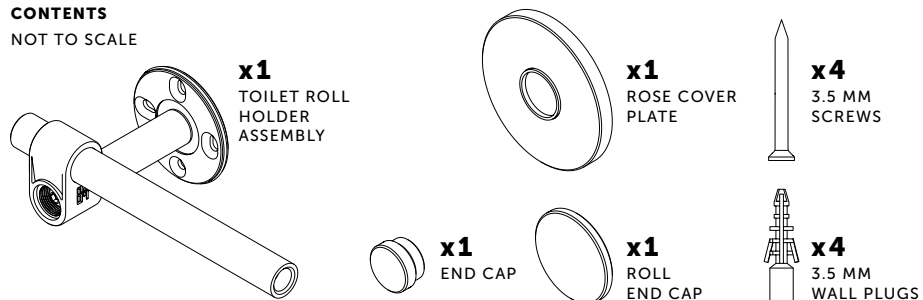

1 DISASSEMBLE TOILET ROLL HOLDER ASSEMBLY.

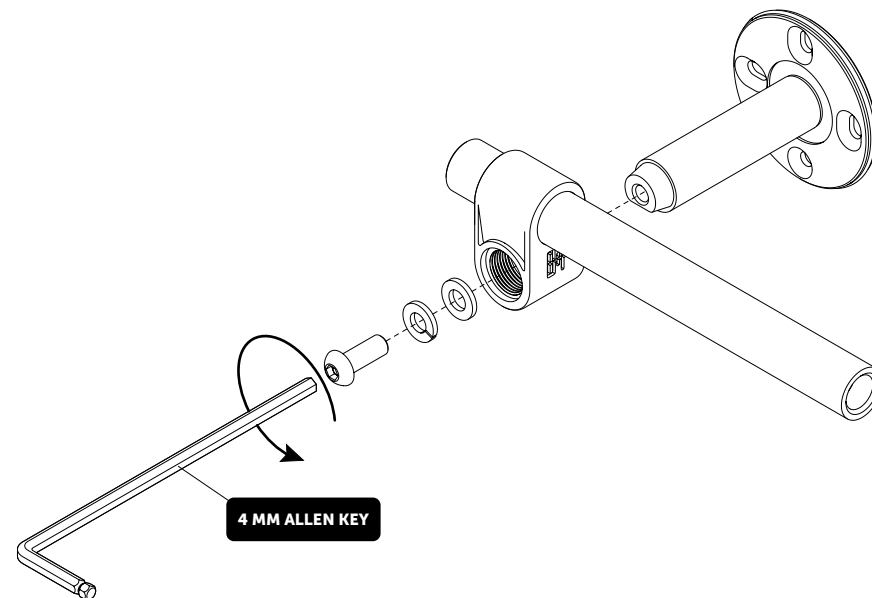

2 MARK FIXING HOLES.

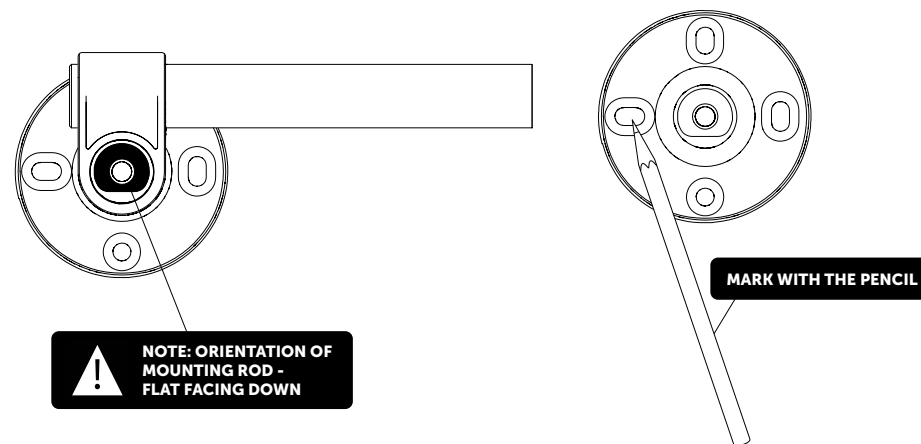

3 DRILL HOLES IN WALL / SURFACE AND INSERT WALL PLUGS.

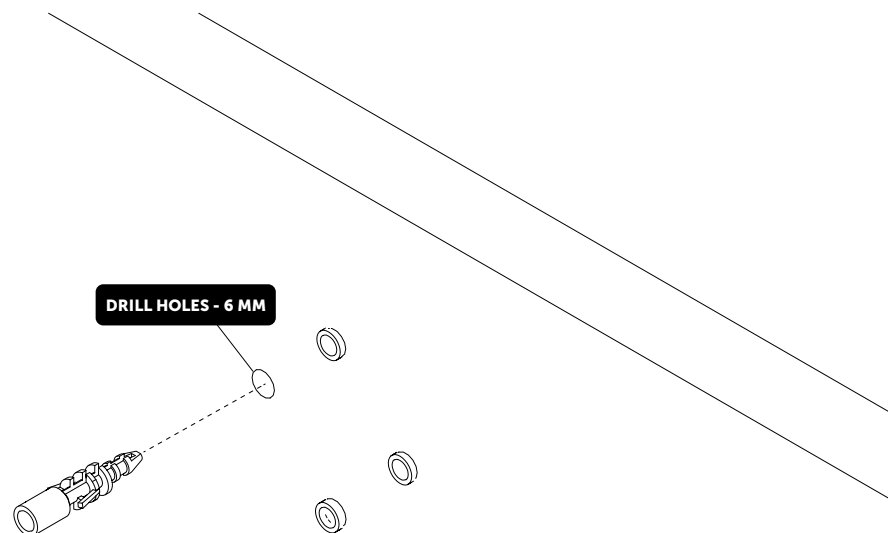

4 SCREW FIXING ROSE TO WALL.

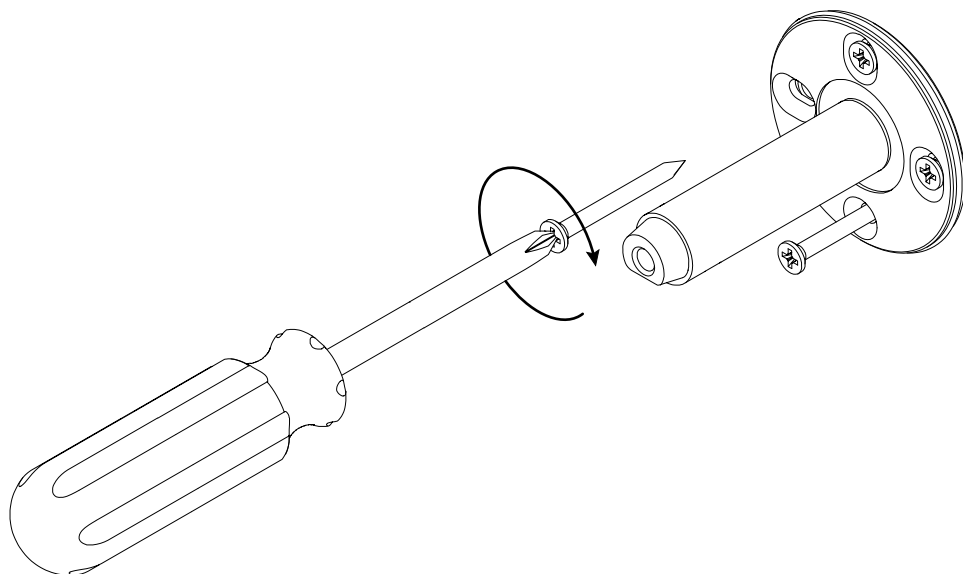

5 FIT COVER PLATE TO FIXING ROSE.

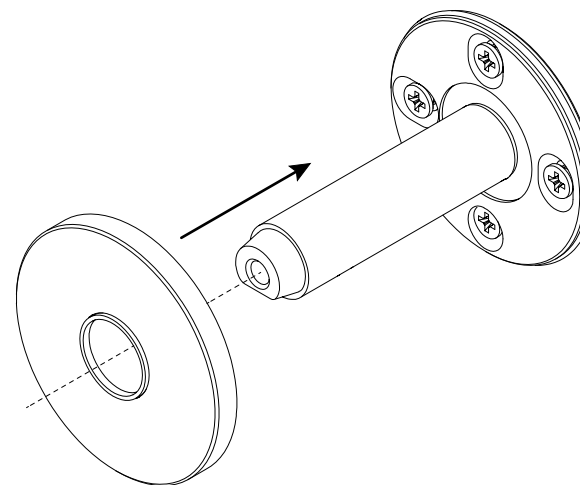

6 ATTACH TOILET ROLL HOLDER.

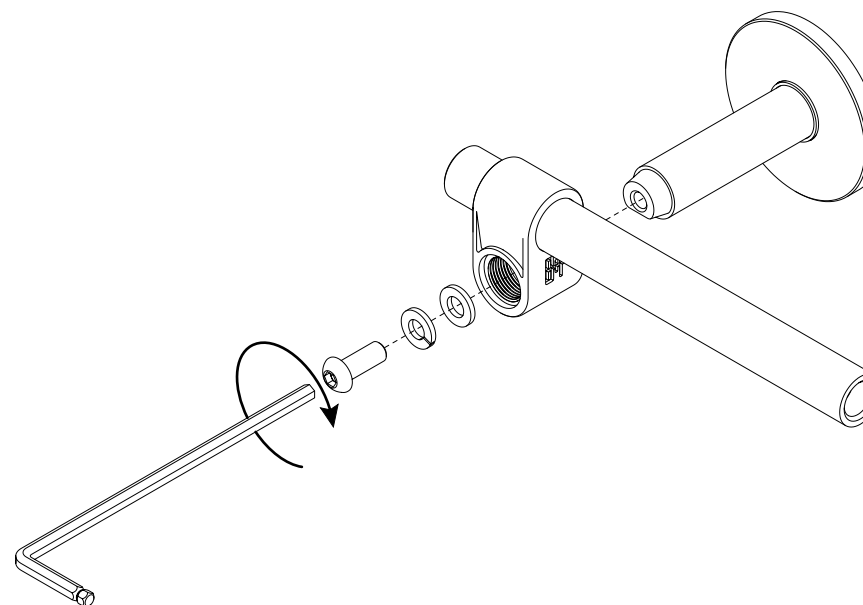

7 SCREW IN END CAPS.

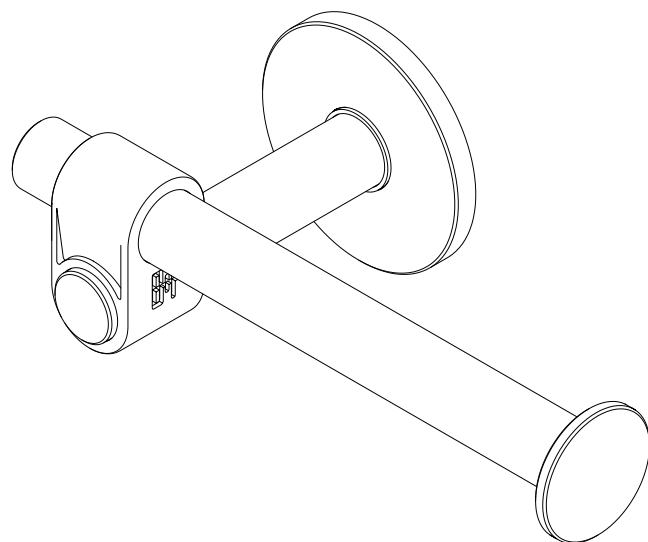
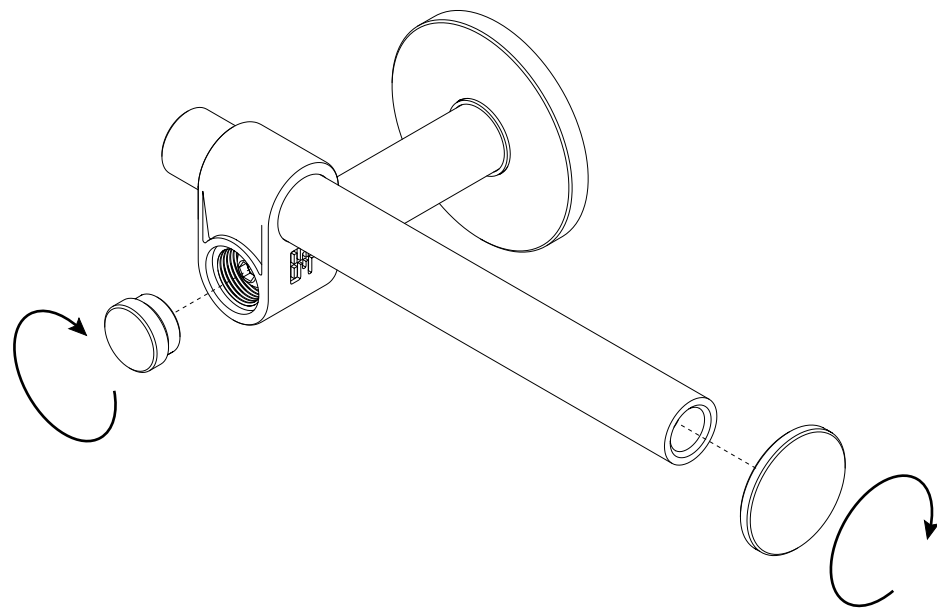

[end. **ORDINARY**]