

MIRROR / CAST
SMALL / LARGE

INSTALLATION MANUAL

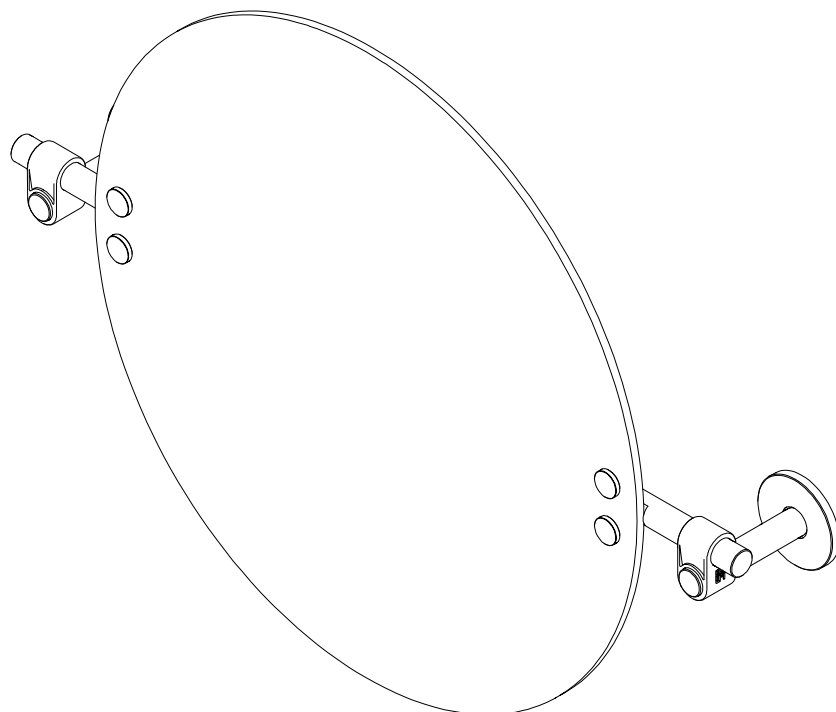

CONTENTS
NOT TO SCALE

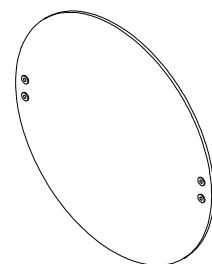

x1
MIRROR
ASSEMBLY

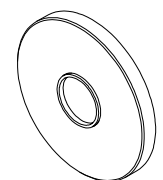

x2
ROSE COVER
PLATES



x2
END CAP



x2
MIRROR
BOLTS



x8
3.5 MM
SCREWS

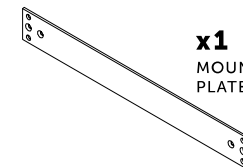

x1
MOUNTING
PLATE



x8
3.5 MM
WALL
PLUGS

x2
MOUNTING
BRACKETS

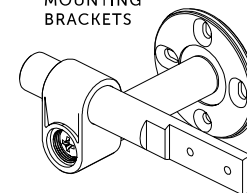

x4
M4 X 10
BOLTS



x4
M5 WASHERS



x4
M5 NUTS

1 DISASSEMBLE MOUNTING BRACKETS.

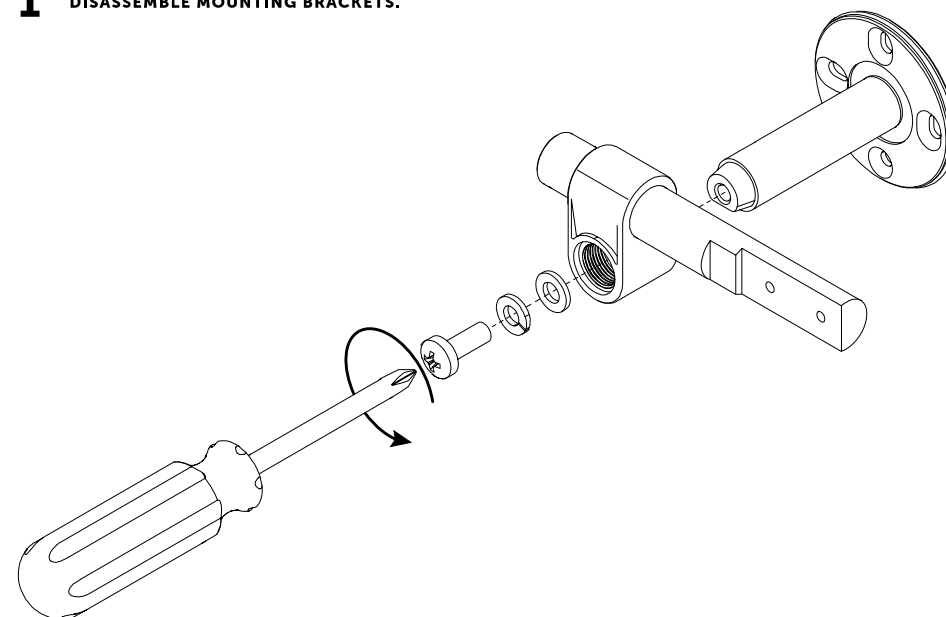

2 MEASURE AND MARK FIXING HOLES.

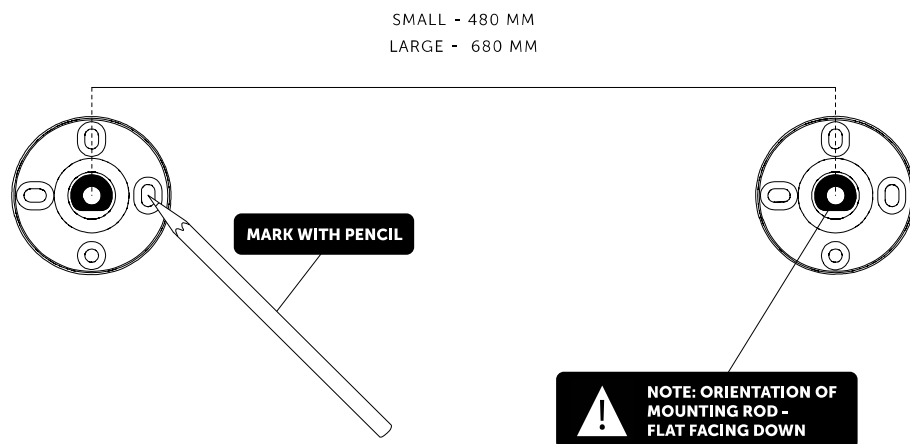

3 DRILL HOLES IN WALL / SURFACE AND INSERT WALL PLUGS.

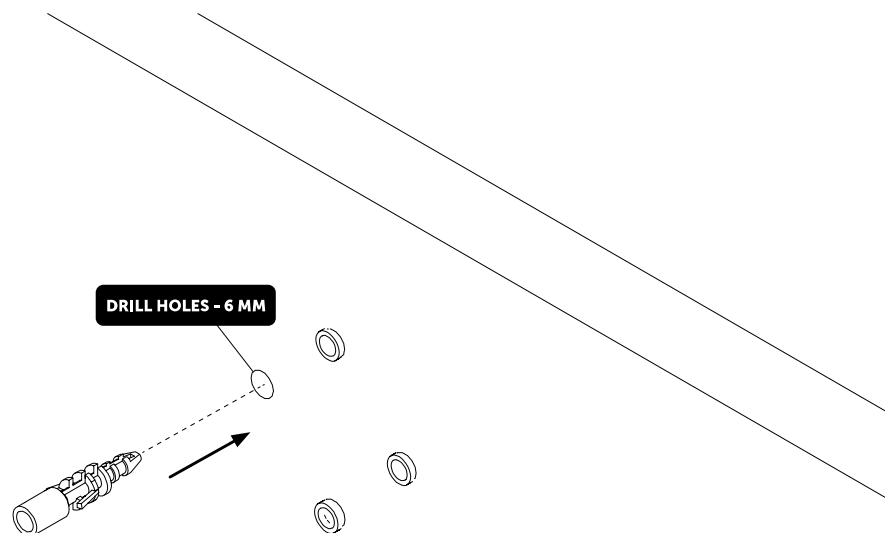

4 SCREW MOUNTING BRACKETS TO WALL.

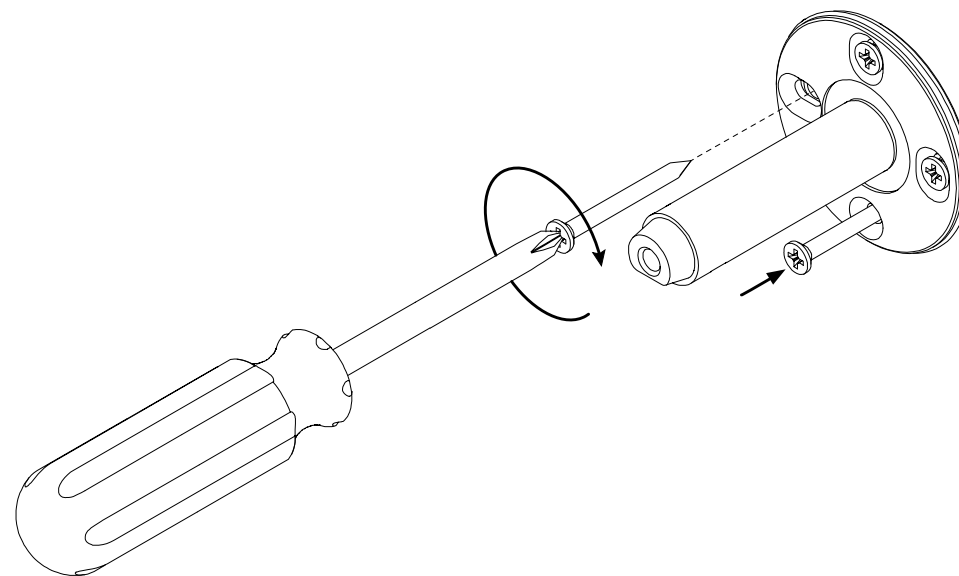

5 FIT ROSE COVER PLATES

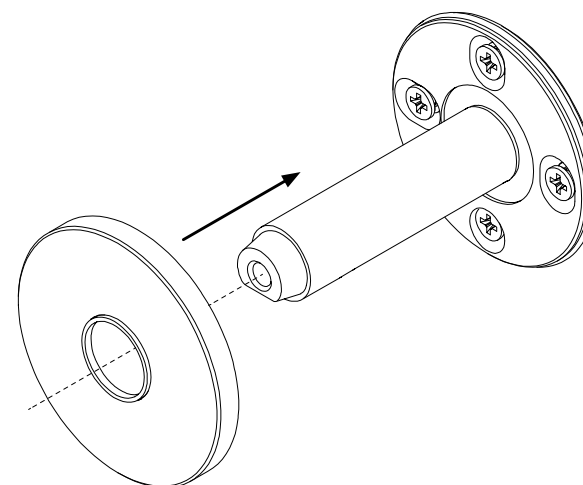

6 ATTACH MOUNTING BRACKETS.

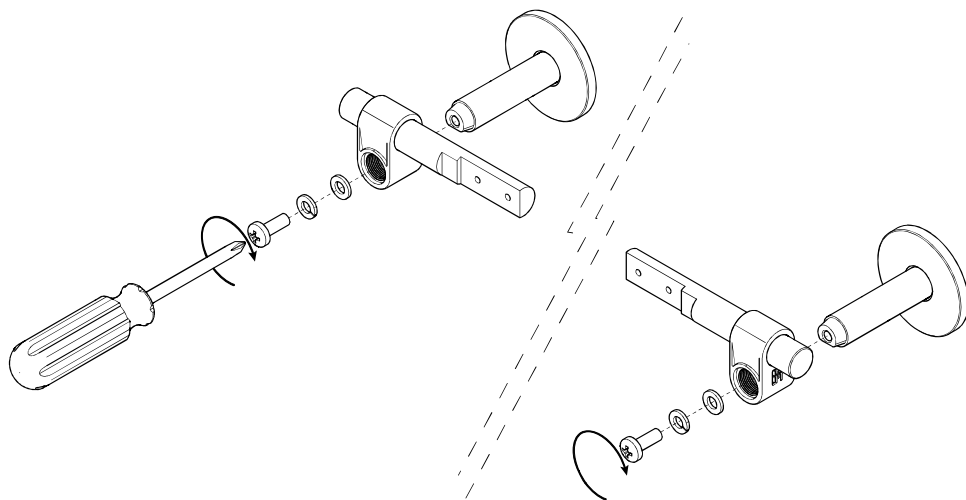

7 ATTACH MOUNTING PLATE.

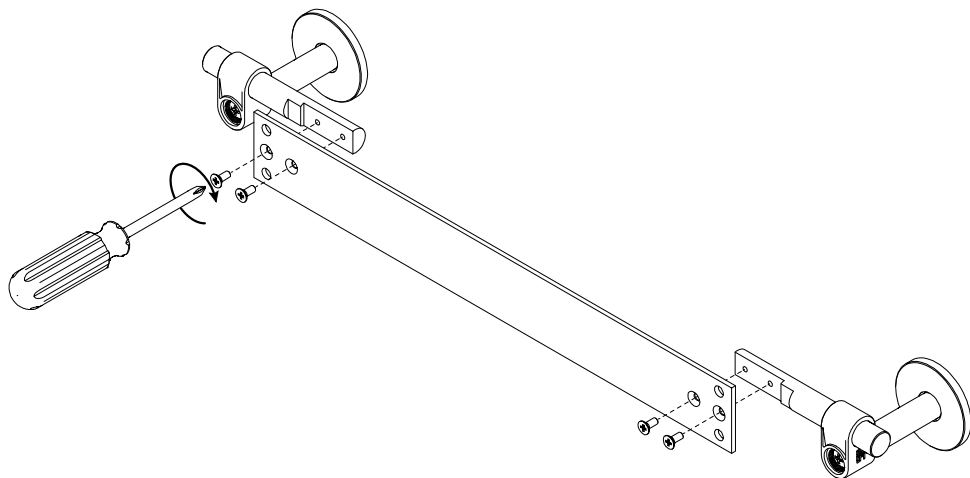

8 ATTACH MIRROR.

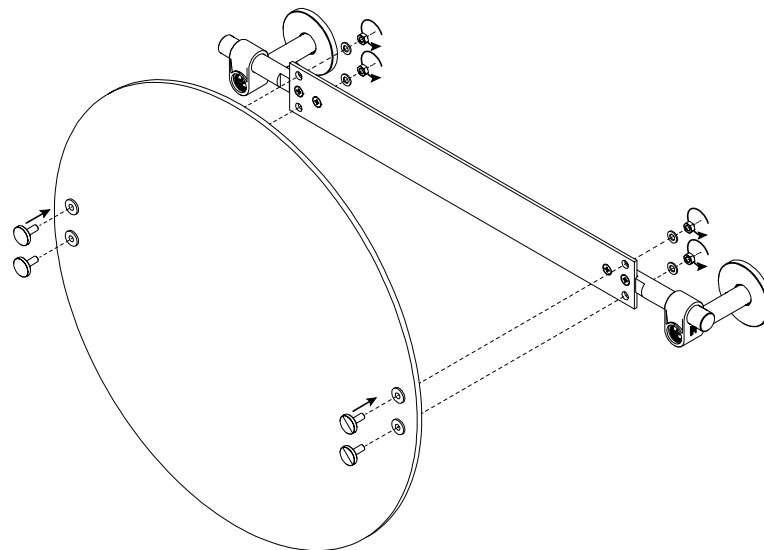

9 SCREW IN END CAPS.

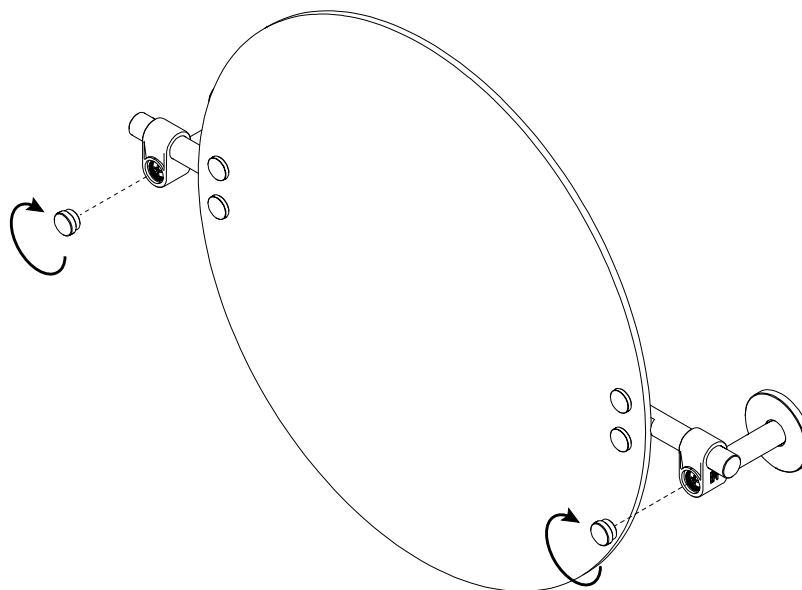

10 ADJUST MIRROR ANGLE.

