

Good Times Console Table

DESIGNED IN 2018

ASSEMBLY NOTES | REV 00

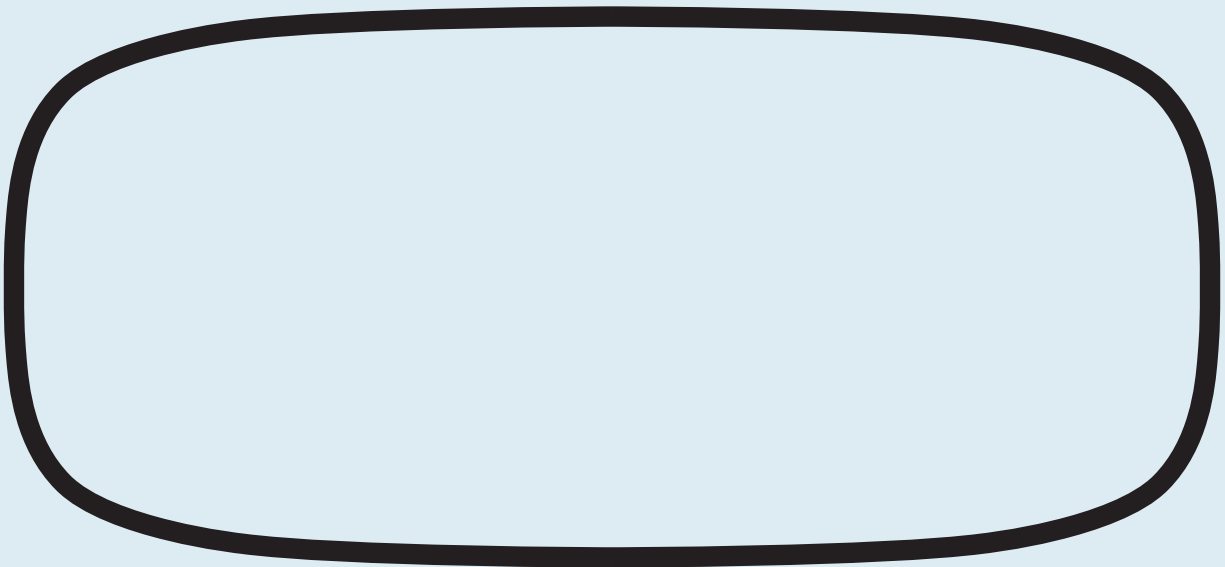
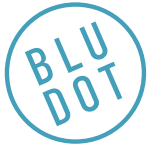

NEED A HAND?

Contact us at service@bludot.com or
844.425.8368 for assistance.

@BLUDOT

We design all our pieces in our Minneapolis studio. Follow
along on Instagram for some sneak peeks into the process.

Parts & Hardware

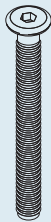

QTY 8
PT. 1684

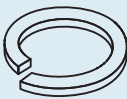

QTY 8
PT. 3005

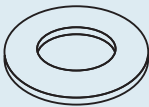

QTY 8
PT. 3006



QTY 1
PT. 9001



QTY 2
Pt. 1217

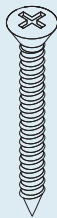

QTY 2
Pt. 1218

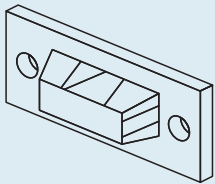

QTY 2
Pt. 8041

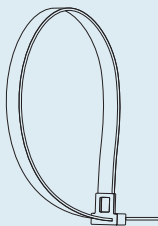

QTY 1
Pt. 8042

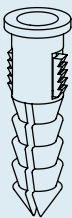

QTY 2
Pt. 8054

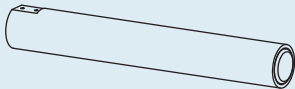

QTY 4
Leg



QTY 1
Table Top

Step 01

ATTACH LEGS.

Attach the legs to the table top as shown using the provided hardware. Periodically tighten the bolts to ensure that the connection remains strong over time.

Adjustable levelers are located at the bottom of each leg and adjusted by rotating.

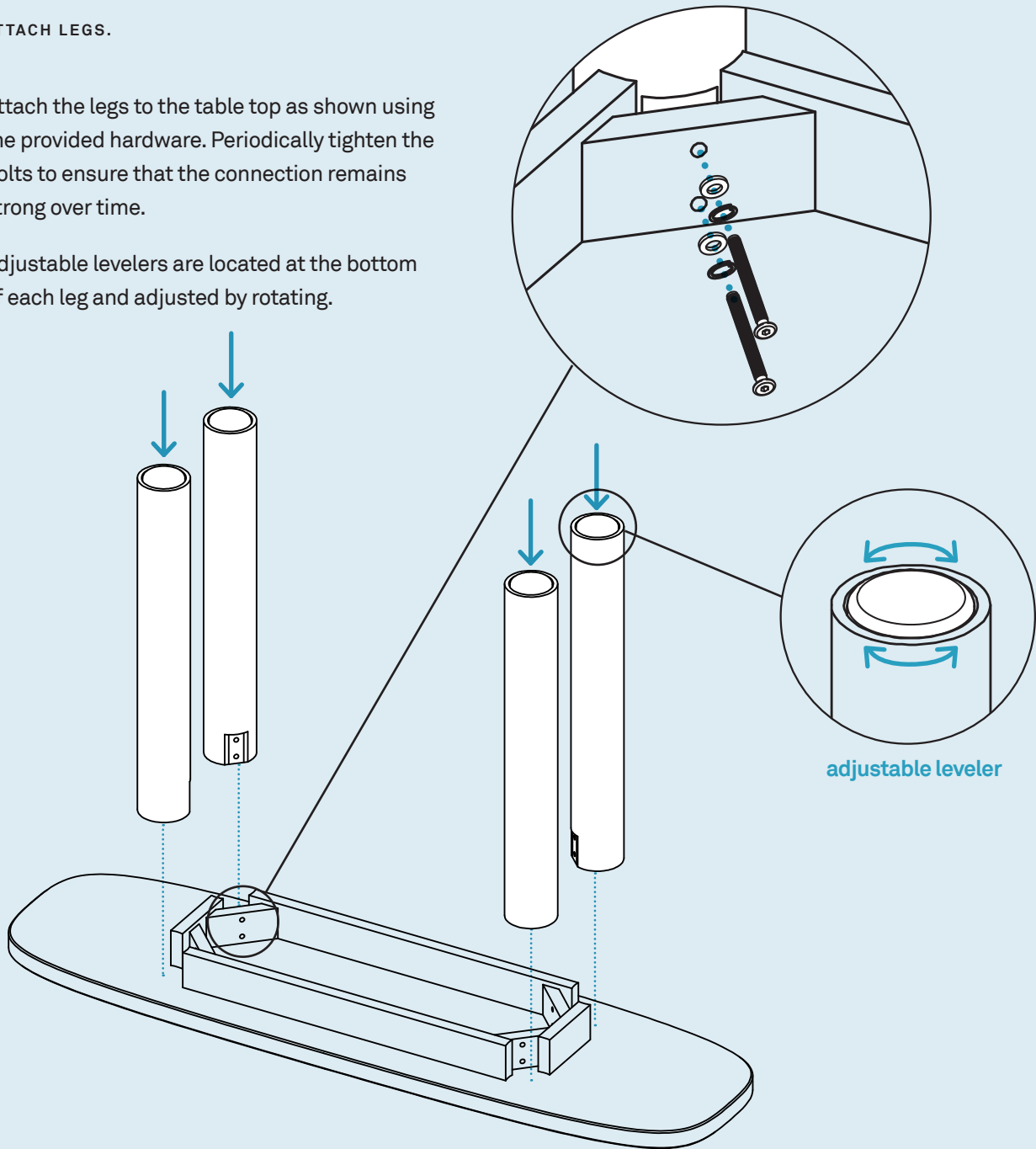

PT. 1684 x 8

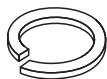

PT. 3005 x 8

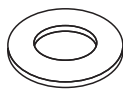

PT. 3006 x 8



PT. 9001 x 1

Step 02

ATTACH ANTI-TIP BRACKET TO TABLE.

Brackets may be installed to the back of the table top as shown to prevent tipping. In order to prevent damage, it is recommended that 3/32" pilot holes be drilled prior to installation.

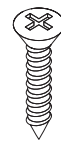
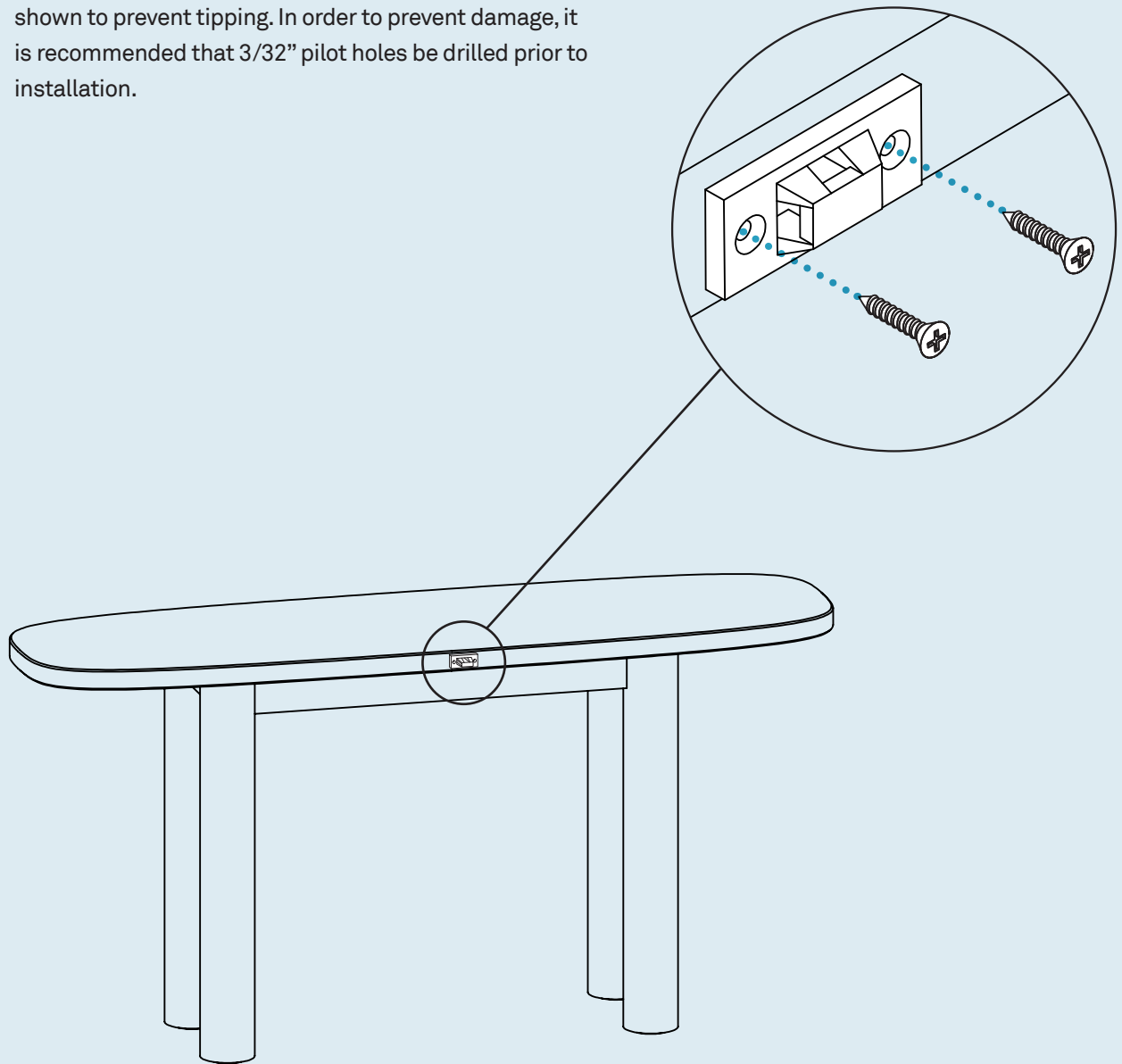

PT. 1217 x 2

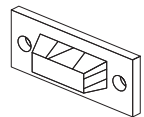

PT. 8041 x 1

Step 03

ATTACH ANTI-TIP BRACKET TO WALL.

Wall anchors and fasteners are included for installation into drywall. Please consult your local hardware professional to determine the hardware best suited for your wall type.

If the mounting locations are positioned on a stud, the installation of wall anchors may be skipped. Instead, drill $7/64$ " pilot holes in the marked positions and install anti-tip bracket with provided hardware as shown.

If the mounting locations are not positioned on a stud, drill $15/64$ " holes into the marked locations and press wall anchors into the drilled holes and install anti-tip bracket with provided hardware as shown.

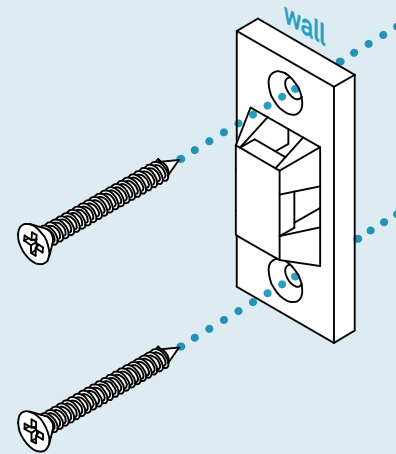
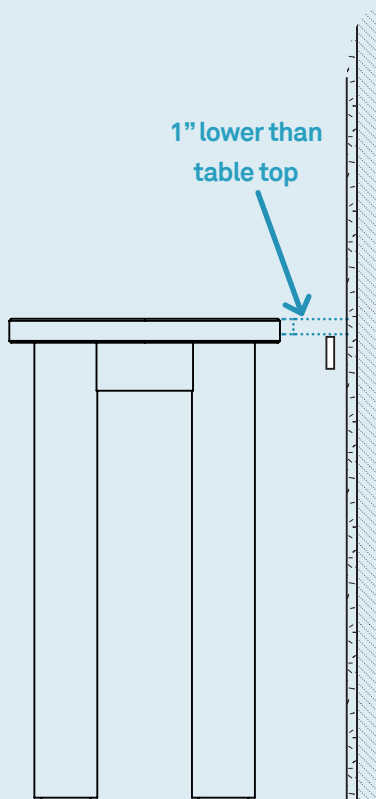

OR

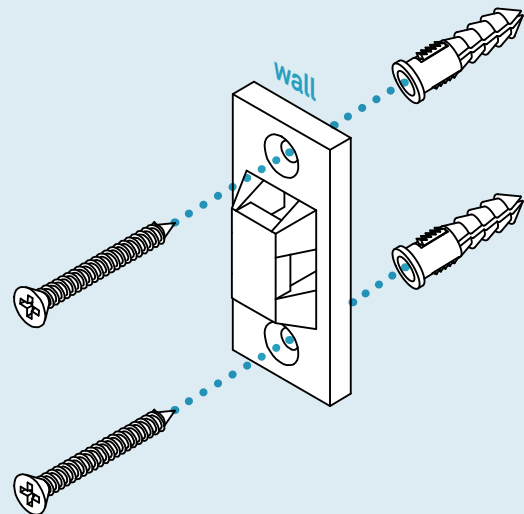

PT. 8054 x 2



PT. 1218 x 2

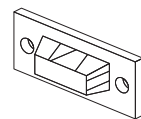

PT. 8041 x 1

Step 04

SECURE TABLE.

Install and tighten wall strap prior to using the product.
Adjust levelers at bottom of legs to ensure they are level prior to use.

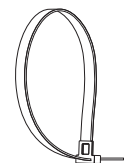
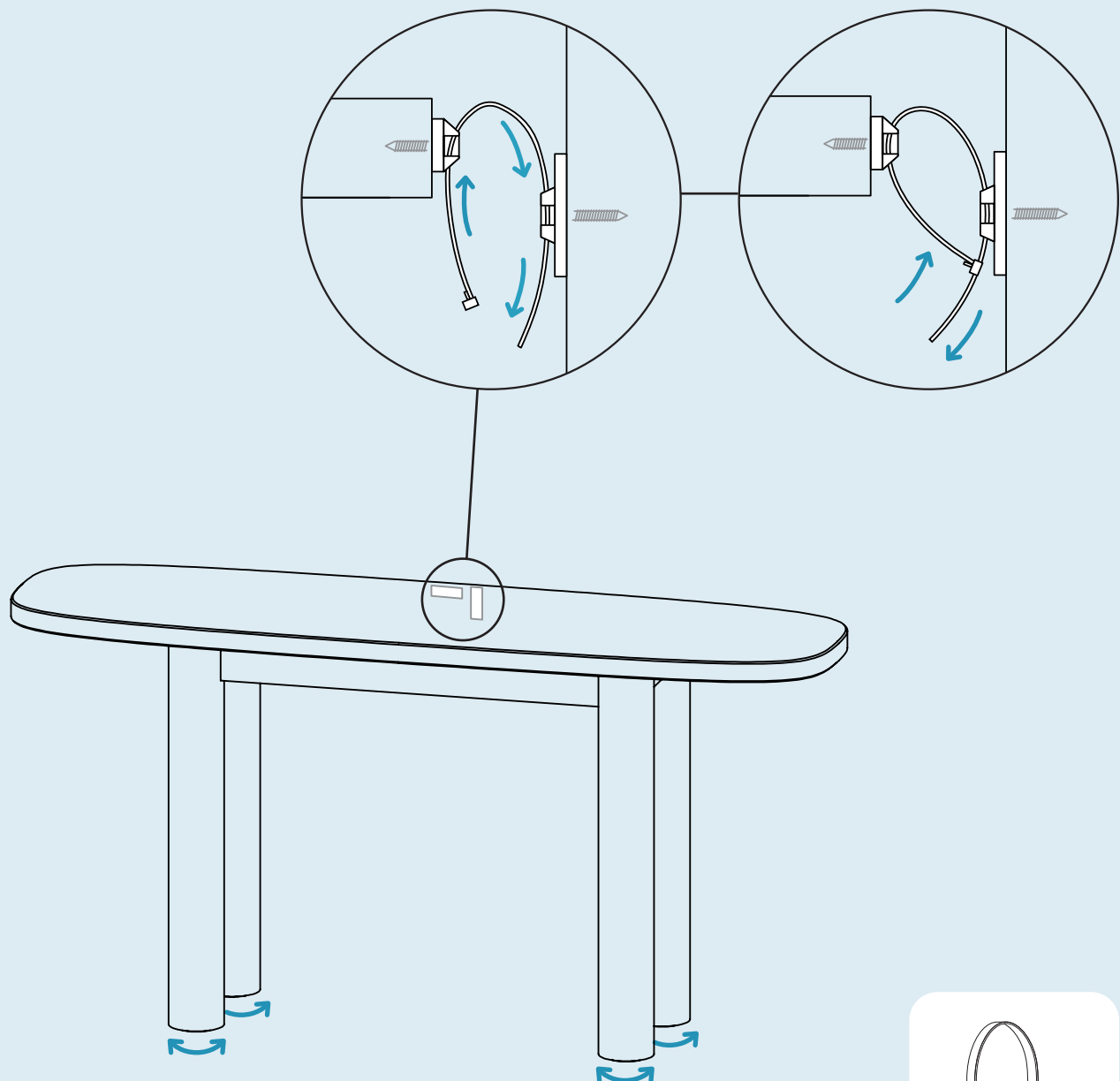

PT. 8042 x 1

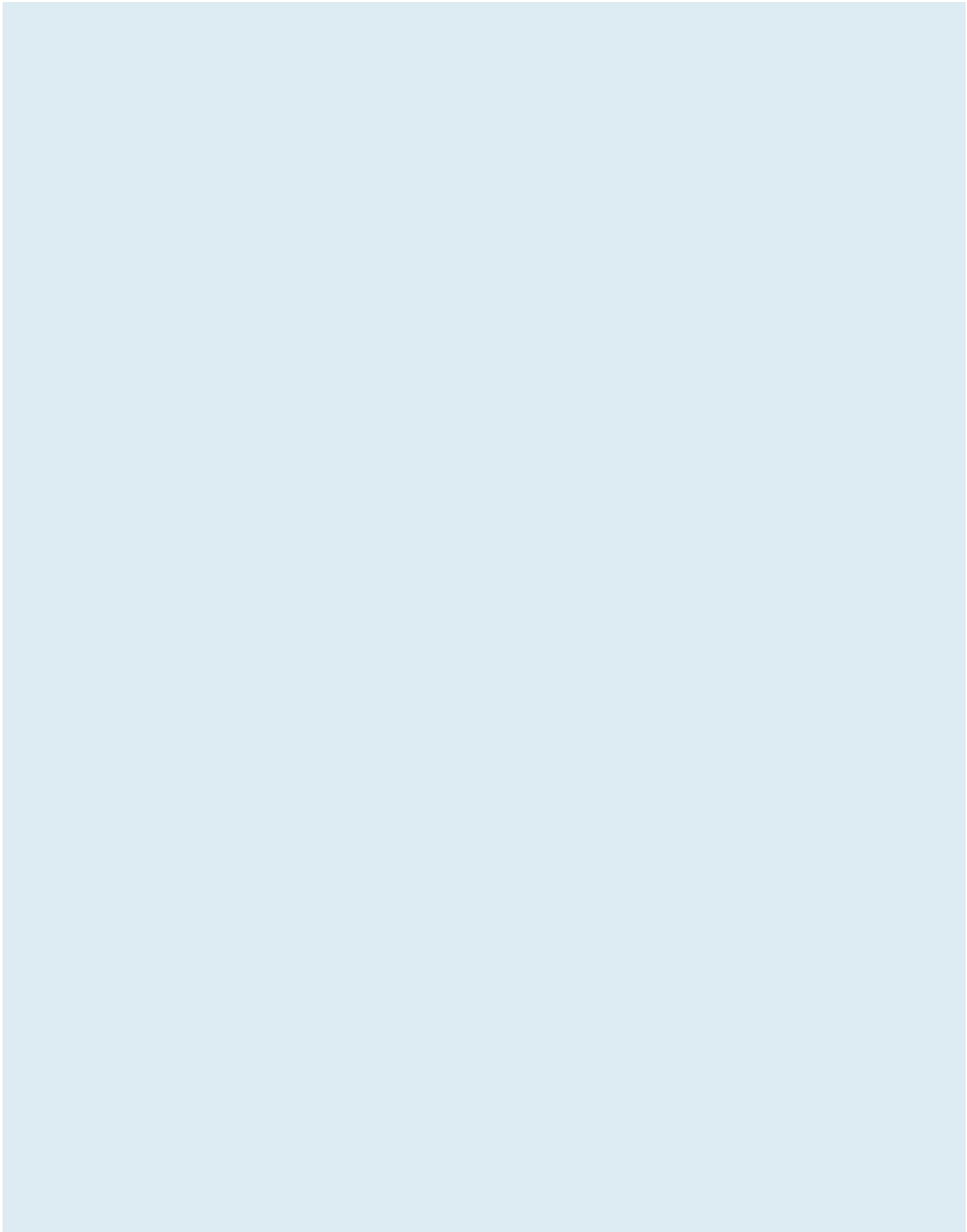

Additional Information

CLEAN

Clean with a slightly damp, soft cloth. To remove dirt and fingerprints, use a quality cleaner formulated for wood furniture. Wipe completely dry with a soft cloth in the direction of the wood grain.

WALNUT CARE

The walnut version of this table is finished with a Rubio® Monocoat Finish. We suggest treating the surface with Rubio® Monocoat Refresh every 12 to 24 months to extend the life of the finish as instructed:

After cleaning the surface, apply Rubio® Monocoat Refresh and spread with a cloth. Allow the product to react for 5 minutes before wiping the surface dry with a cloth or paper towel. Polish until the surface feels completely dry. Work in zones that can be fully wiped dry within 15 minutes. The surface will be completely dry and useable after 5 hours.

Rubio® is a registered trademark of Muylle-Facon.

