

Mode Large Mirror

DESIGNED IN 2022

ASSEMBLY NOTES | REV 01

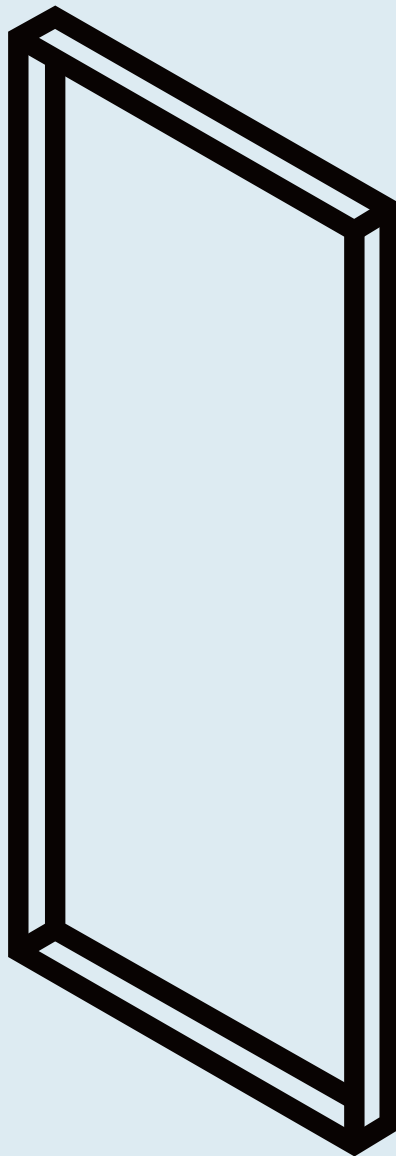
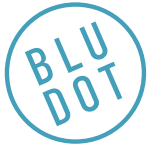

NEED A HAND?

Contact us at service@bludot.com or
844.425.8368 for assistance.

@BLUDOT

We design all our pieces in our Minneapolis studio. Follow
along on Instagram for some sneak peeks into the process.

Parts & Hardware

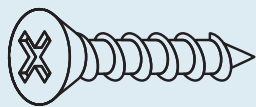

QTY 2

PT. 1216



QTY 2

PT. 1204

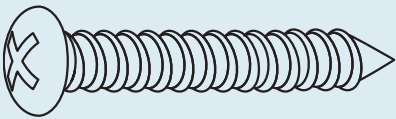

QTY 6

PT. 1230

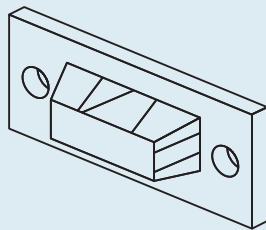

QTY 2

PT. 8041



QTY 2

PT. 8052

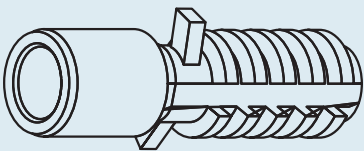

QTY 6

PT. 8036

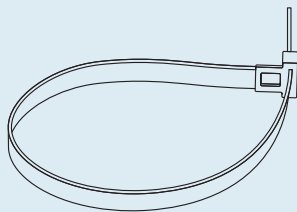

QTY 1

PT. 8042

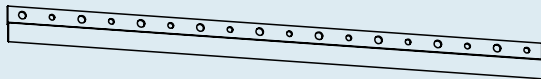

QTY 2

Wall Cleat

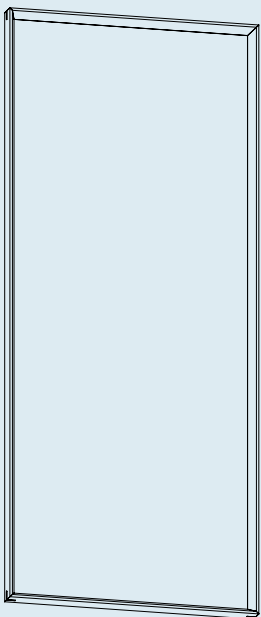

QTY 1

Mirror

These are the instructions for wall hanging. Skip to page 5 for instructions for leaning the mirror.

Step 01

ATTACH WALL CLEAT.

Wall anchors and fasteners are included for installation. Please consult your local hardware professional to determine the hardware best suited for your wall type.

The mirror can be oriented vertically or horizontally. Position the top of the wall cleat 4" lower than your desired height of the mirror and mark mounting locations with a pencil. Use a leveling device to ensure the cleat is level. Horizontal orientation will require attaching 2 wall cleats with the correct distance in between as shown below.

If the mounting locations are not positioned on a stud, drill a $23/64$ " hole in the marked location and insert wall anchor. If the mounting locations are located on a stud, this step of installing an anchor may be skipped. Instead, drill a $3/32$ " pilot hole in the marked position.

Attach wall cleat using provided fasteners as shown.

Vertical Orientation:

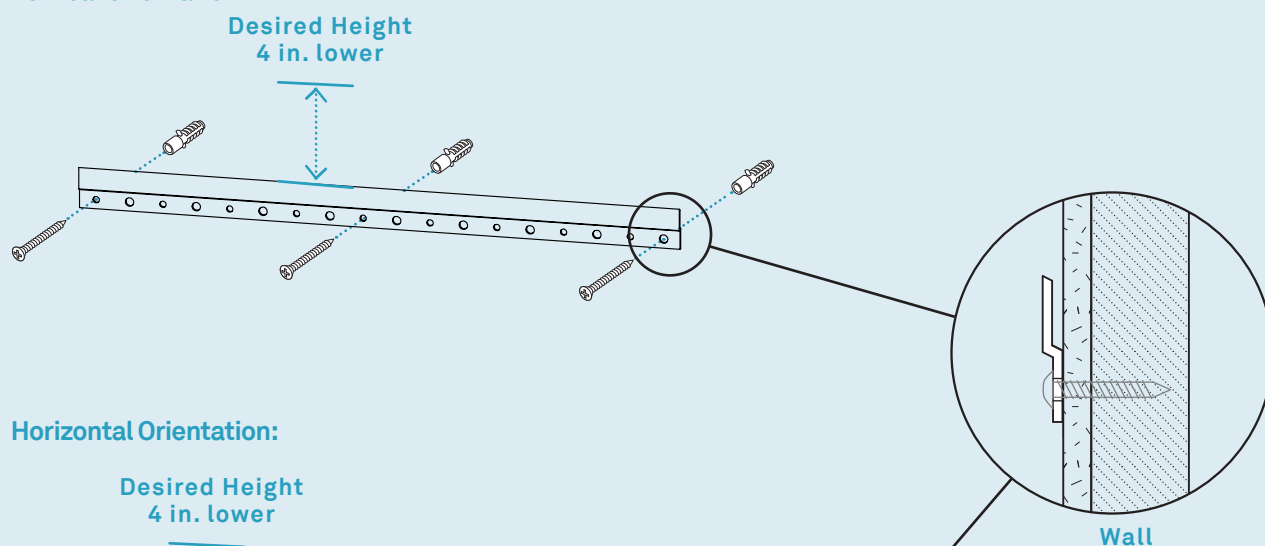

Horizontal Orientation:

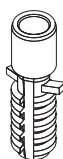
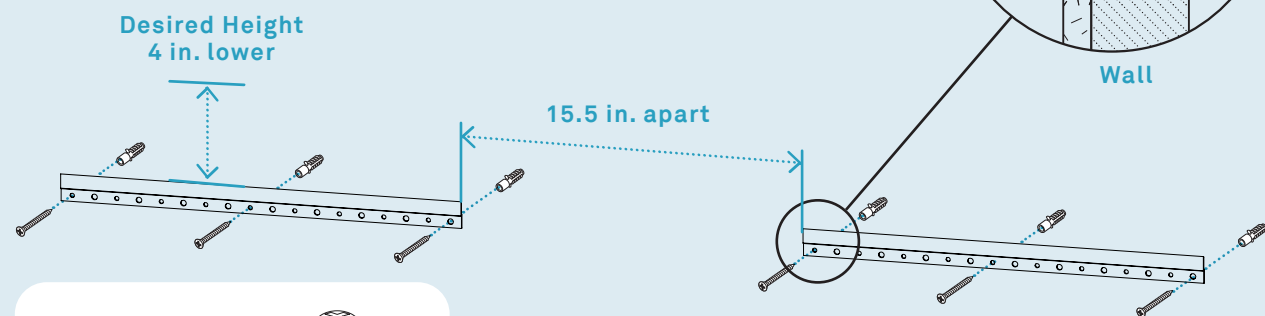

PT. 8036 x
3 or 6*

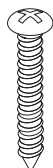

PT. 1230 x
3 or 6

Step 02

HANGING THE MIRROR.

Place mirror against the wall above the wall cleat with the help of another individual. Carefully slide mirror down along the wall until it engages with the wall cleat as shown to complete assembly.

See last page for care instructions.

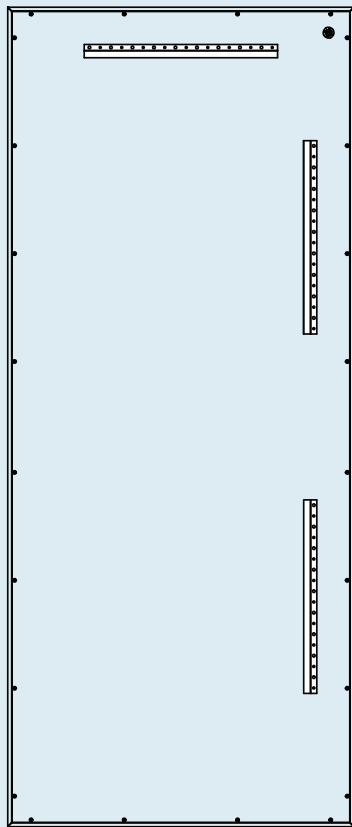

Rear View



Side View

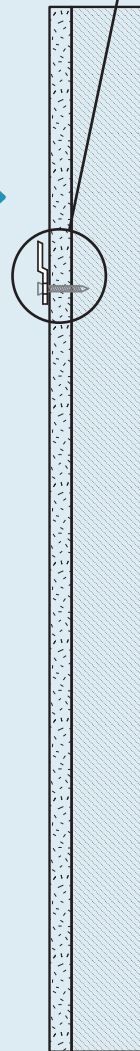
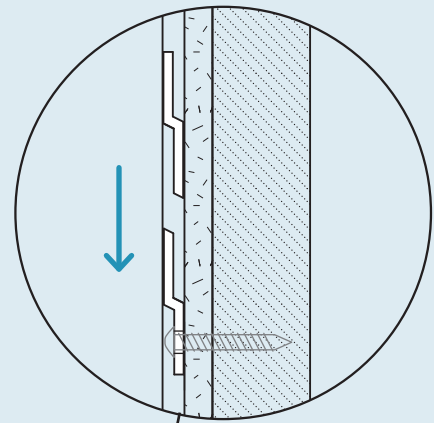

Wall

These are the instructions for leaning the mirror. Return to page 3 for instructions for hanging the mirror.

Step 01

ATTACH ANTI-TIP BRACKET TO MIRROR.

Mirrors that are leaned against the wall should have anti-tip brackets installed to prevent tipping. Have another individual help for safe assembly.

Position the the anti-tip bracket at the top of the mirror and mark the hole location. In order to prevent damage, it is recommended that **3/32"** pilot holes be drilled prior to installation.

Note: Ensure that the depth of the pilot hole does not exceed **1/2"**. A deeper pilot hole may damage the mirror.

Attach the bracket with the provided hardware as shown.

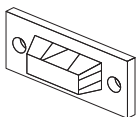
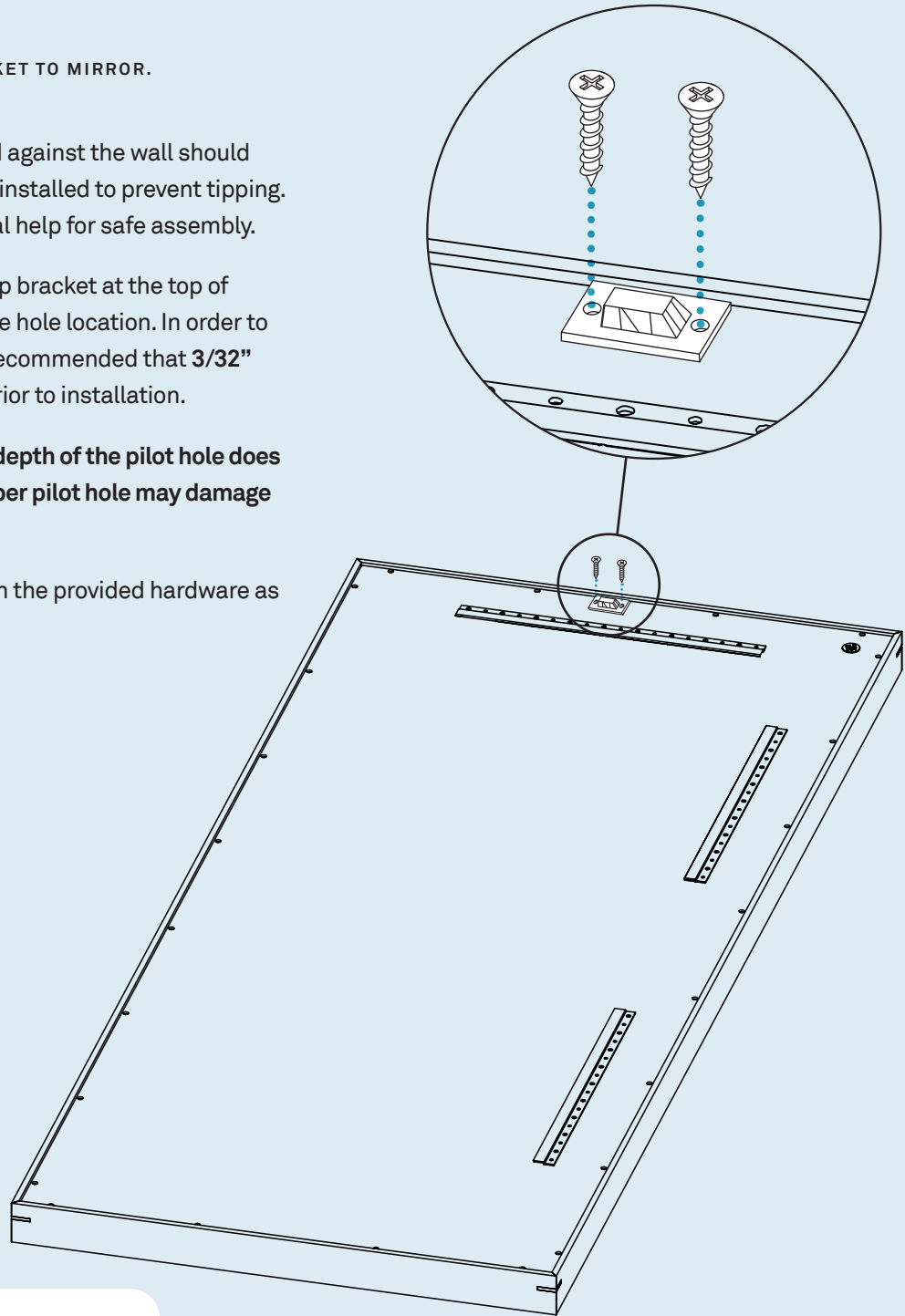

PT. 8041 x 1



PT. 1216 x 2

Step 02

ATTACH ANTI-TIP BRACKET TO WALL.

Wall anchors and fasteners are included for installation into drywall. Please consult your local hardware professional to determine the hardware best suited for your wall type.

Install the wall anchors 1" below the anti-tip bracket that was attached in the previous step.

If the mounting locations are positioned on a stud, the installation of wall anchors may be skipped. Instead, drill $\frac{3}{32}$ " pilot holes and install wall bracket with provided hardware as shown.

If the mounting locations are not positioned on a stud drill $\frac{17}{64}$ " holes and press wall anchors into the drilled holes, then install wall bracket with provided hardware as shown.

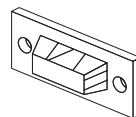
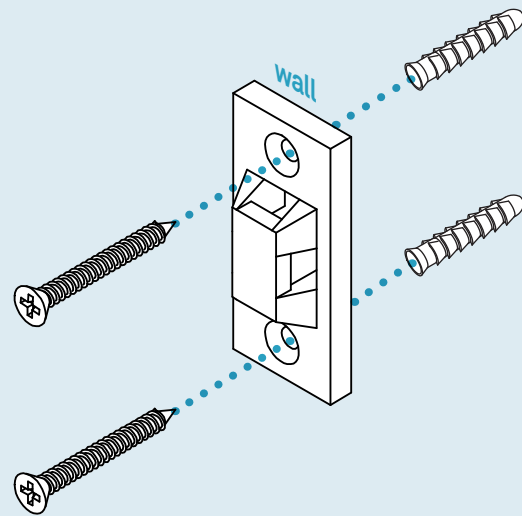
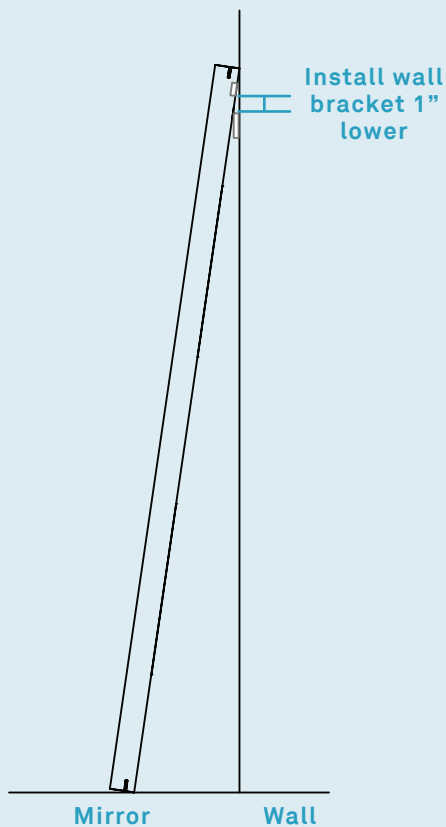

PT. 8041 x 1



PT. 8052 x 2*



PT. 1204 x 2

Step 03

SECURE MIRROR TO WALL.

Install and tighten wall strap prior to using the product.

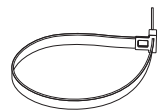
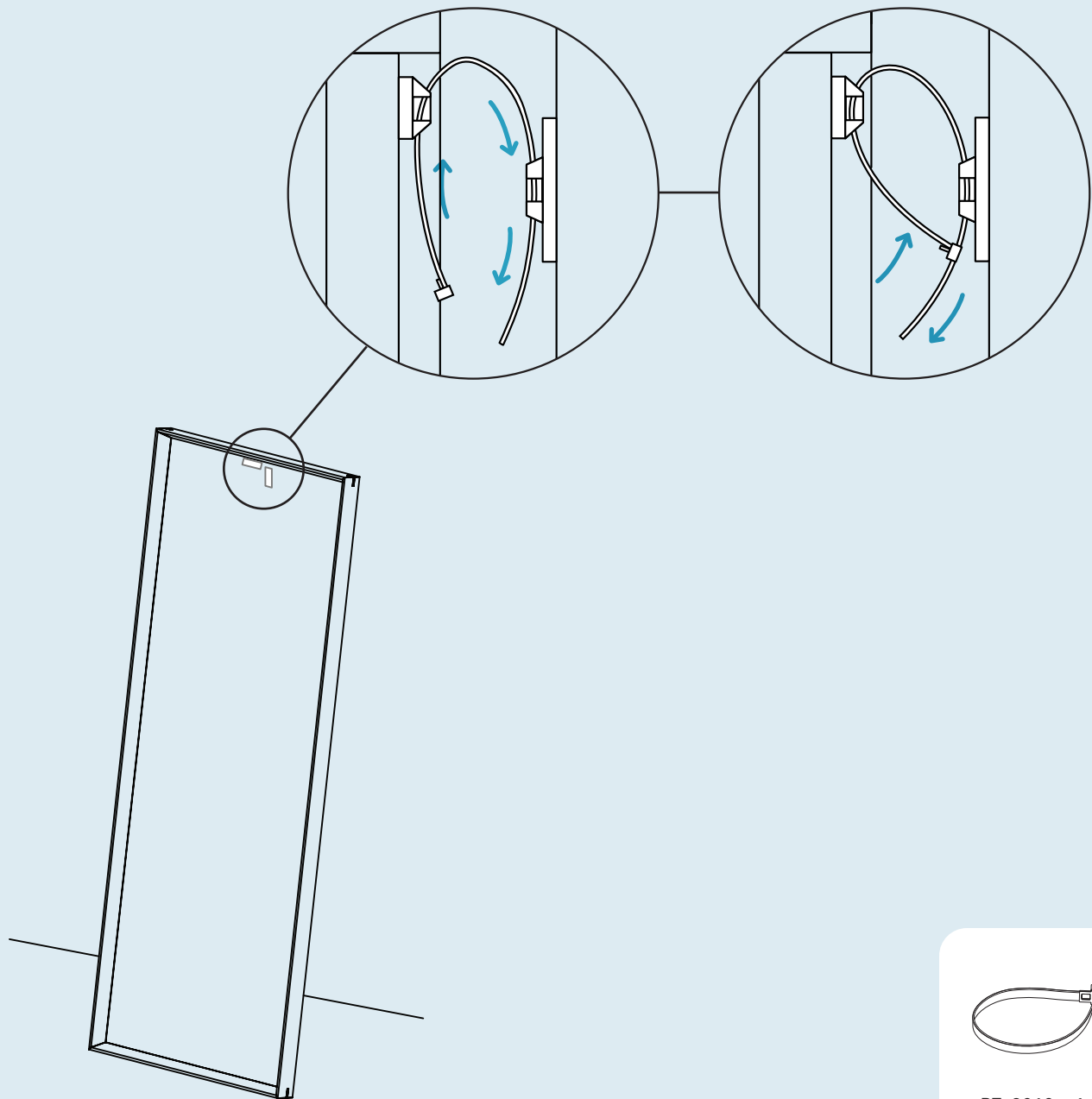

PT. 8042 x 1

Additional Information

CLEAN

Clean with a slightly damp, soft cloth. To remove dirt and fingerprints, use a quality cleaner formulated for glass and wood furniture. Wipe completely dry with a soft cloth in the direction of the wood grain.

