

Vector Vanity

VEC-24V, VEC-36V



CAUTION

TURN OFF THE MAIN POWER AT THE CIRCUIT BREAKER BEFORE INSTALLING THE FIXTURE IN ORDER TO PREVENT POSSIBLE SHOCK

IF YOU ARE UNFAMILIAR WITH PROPER ELECTRICAL WIRING CONNECTIONS, OBTAIN THE SERVICES OF A QUALIFIED ELECTRICIAN

GENERAL

- Read all instructions carefully for safe operation and installation.
- All electrical connections must be in accordance with local and national electrical code (N.E.C) standards.
- Remove the fixture and the mounting package from the box and make sure that no parts are missing by referencing the illustrations on the installation instruction. Please contact Blackjack if any parts are missing or damaged.
- This product is suitable for damp locations.

INSTALLATION

Preparation

1. Remove the fixture and all the parts from the box.
2. Remove the fixture pan/acrylic lens assembly (12)(13) from the back panel(11) by loosening the two mounting screws.
3. Select the proper CCT color temperature by adjusting the CCT switch(1) on the inside of the back panel(11).

Electrical Connections

4. Using the wire connectors(9), connect the white supply wire(2) to the white fixture wire(3); connect the black supply wire(4) to the black fixture wire(5); and connect the house ground wire(6) to the fixture ground wire(7).
5. Carefully tuck all the wires back into the outlet box(8). (As shown in Fig.2).
6. Connect the white male micro connector(17) from the back panel(11) to the female micro connector(18) from the fixture pan(12).

Mounting

7. Place the back panel(11) over the outlet box(1). Carefully insert the body of the driver(16) into the junction box(8). Insert the mounting screws(12) through the slots on the back panel(11). Then tighten them into the outlet box(8).
8. Align the holes on the side of the back panel (11) with the holes on the side of the fixture pan(12). Then insert and tighten the two mounting screws(10) to secure them together.

Dimming

9. Fixture requires a 120V input current and can dim with a TRIAC Dimmer. Can be upgraded to 120–277V driver with universal dimming (TRIAC, ELV, 0–10V dimmable).

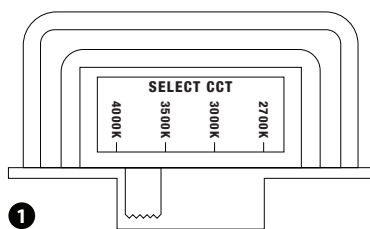
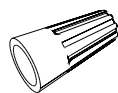

Figure 1

HARDWARE



Wire Connector (#9)
3 Included



Mounting Screws (#10)
2 Included

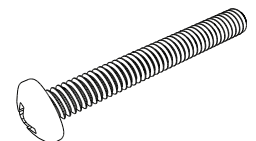

Mounting Screws (#12)
2 Included

Vector Vanity

VEC-24V, VEC-36V

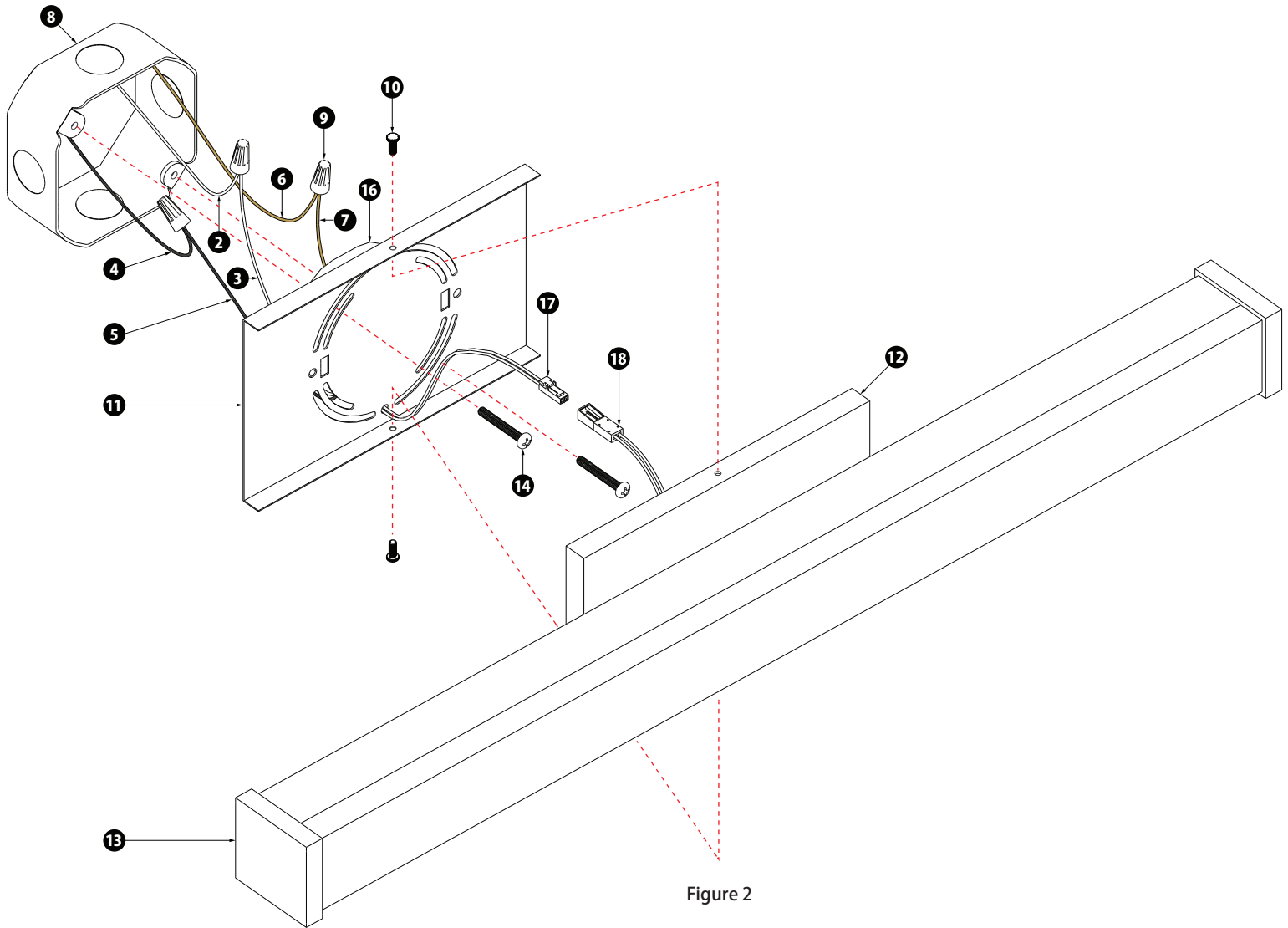

Figure 2

- | | | |
|-------------------------|--------------------------|--------------------------|
| ① 4 POSITION CCT SWITCH | ⑦ FIXTURE GROUND WIRE | ⑬ FIXTURE ASSEMBLY |
| ② WHITE SUPPLY WIRE | ⑧ OUTLET BOX (by others) | ⑭ MOUNTING SCREWS |
| ③ WHITE FIXTURE WIRE | ⑨ WIRE CONNECTOR | ⑮ ACRYLIC DIFFUSER |
| ④ BLACK SUPPLY WIRE | ⑩ MOUNTING SCREWS | ⑯ DRIVER |
| ⑤ BLACK FIXTURE WIRE | ⑪ BACK PANEL | ⑰ MALE MICRO CONNECTOR |
| ⑥ HOUSE GROUND WIRE | ⑫ FIXTURE PAN | ⑱ FEMALE MICRO CONNECTOR |