

CAUTION

Turn off the main power at the circuit breaker before installing the fixture in order to prevent possible shock. If you are unfamiliar with proper electrical wiring connections, obtain the services of a qualified electrician.

GENERAL

Read all instructions carefully for safe operation and installation.

All electrical connections must be in accordance with local and National Electrical Code (N.E.C.) standards.

Remove the fixture and mounting package from the box. Make sure no parts are missing by referencing the illustrations on these Installation Instructions. Please contact Blackjack Lighting at 847-941-0588 if any parts are missing or damaged.

This product is suitable for DAMP locations.

PREPARATION

1. Remove the fixture from its box. Unpack the bundled wire packages, be careful not to bend or kink wires when unpacking. Remove additional packaging for white glass globe pendants(26).
2. Remove the canopy backplate(5) from the canopy faceplate(10) by loosening the two decorative finials(13).

SURFACE MOUNTING - (Center-Feed, Canopy-Mounted Driver)

3. Use two ceiling anchors(11, by others) and two ceiling anchor screws (12, by others) to mount the ceiling plate(15) onto the junction box(1). Mount ceiling plate(15) to canopy backplate(16) with two small screws and nuts, included with the ceiling plate(15).
4. Mount canopy backplate(16) to canopy faceplate(10) by inserting the two threaded mounting studs(17) into the rear of canopy backplate(16). Attach nuts(18) and tighten it firmly from the inside.

CONNECT ELECTRICITY (Center Feed)

5. Attach Low voltage white and black supply wires(2,4) coming from the back of canopy backplate(16) to the low voltage wires coming through the junction box(1) from integral driver(19). Splice the wires using supplied wire connectors(20).

CONNECT THE INTERNAL CHANNEL WIRING CONNECTIONS

6. Attach the low voltage white and black wires(3,5) coming from the fixture to the wire harness with the white connectors(27) to transfer power to each pendant wire assembly. Once all the low voltage connections are made you can then suspend the canopy faceplate(10) from the internal suspension wires(21) (located inside the fixture).

CONNECT THE CANOPY COVER TO THE BACKPLATE

7. Make sure all wires are carefully placed inside canopy faceplate(10). Secure the canopy faceplate(10) to the canopy backplate (16) by tightening the two decorative finials(13).

INSTALLING YOKE(25) BETWEEN SOCKETS(24) AND PENDANTS(26)

8. Remove plastic/protective wrapping of yoke(25).
9. Position five holes of yoke(25) over five threaded sockets(24).
10. Gently screw on five white glass globes(26) onto threaded sockets(24). Yoke should be held securely in place.

WIRE STRAIGHTENING AND DETERMINING LEVEL OF YOKE

11. Use a level to determine horizontal balance of yoke and note where minor adjustments may be needed.
12. On each cable wire, press the small barrel of the gripper(22) upward. This will release the wire tension and allow the suspended wire to be pulled through gripper(22). Push the excess wire up into the canopy and roll it into a small loop inside the canopy. Wrap the supplied Velcro strap around this loop to keep the excess wire from falling outside the canopy faceplate(10).
13. Check level of yoke(25). Check for any remaining bends or kinks in the cable(23); kinks can be straightened by bending cable(23) by hand while heating the cord up with the warm air from a hair dryer or heat gun.

DIMMING

Fixture Dimming Type: TRIAC or ELV dimming. For recommended dimmers see blackjacklighting.com.

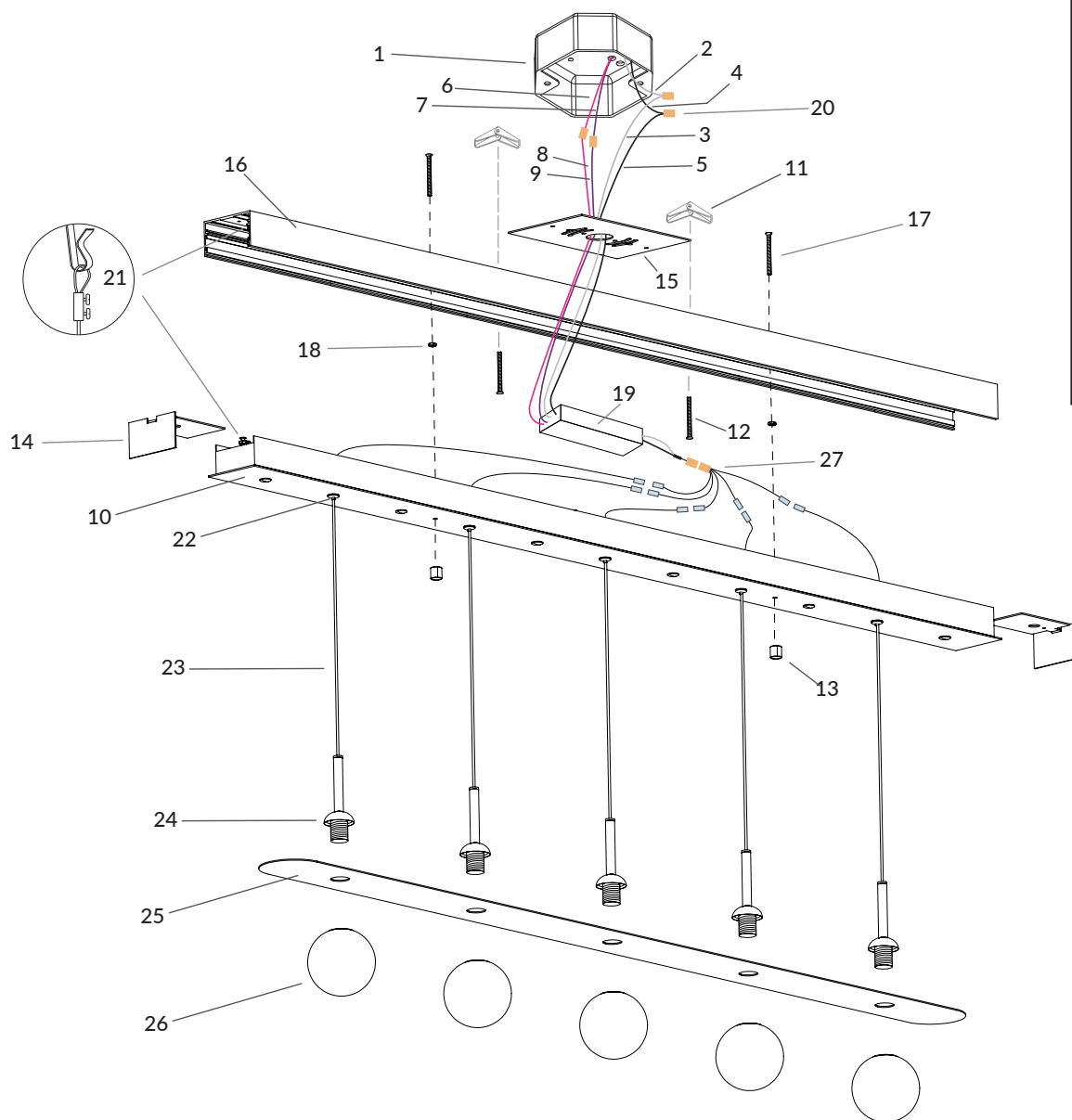

HARDWARE



Wire Connector (#8)
(4) Included



Mounting Screw (#17)
(2) Included

- | | | |
|---|--------------------------------------|---|
| 1. JUNCTION BOX (by others) | 10. CANOPY FACEPLATE | 21. INTERNAL SUSPENSION WIRES LOOP & HOOK |
| 2. WHITE SUPPLY WIRE | 11. CEILING ANCHOR (by others) | 22. PENDANT GRIPPER |
| 3. WHITE FIXTURE WIRE | 12. CEILING ANCHOR SCREW (by others) | 23. WIRE CABLE |
| 4. BLACK SUPPLY WIRE | 13. DECORATIVE FINIAL | 24. THREADED SOCKETS |
| 5. BLACK FIXTURE WIRE | 14. CANOPY ENDCAP | 25. YOKE |
| 6. PINK HOUSE DIMMING WIRE (optional) | 15. CEILING PLATE | 26. WHITE GLASS GLOBE PENDANTS |
| 7. PURPLE HOUSE DIMMING WIRE (optional) | 16. CANOPY BACKPLATE | 27. WIRE HARNESS WITH WHITE CONNECTORS |
| 8. PINK FIXTURE DIMMING WIRE (optional) | 17. THREADED MOUNTING STUDS | |
| 9. PURPLE FIXTURE DIMMING WIRE (optional) | 18. MOUNTING SCREW NUT | |
| | 19. INTEGRAL DRIVER | |
| | 20. WIRE CONNECTOR | |