

### CAUTION

Turn off the main power at the circuit breaker before installing the fixture in order to prevent possible shock. If you are unfamiliar with proper electrical wiring connections, obtain the services of a qualified electrician.

### GENERAL

Read all instructions carefully for safe operation and installation.

All electrical connections must be in accordance with local and national electrical code (N.E.C.) standards.

Remove the fixture and mounting package from the box. Make sure no parts are missing by referencing the illustrations on these Installation Instructions. Please contact Blackjack Lighting at 847-941-0588 if any parts are missing or damaged. This product is suitable for DAMP locations.



### IMPORTANT

- For factory pre-set option, customer to select pattern and provide distance of longest pendant. Signoff on Blackjack-generated configuration drawing or designer-supplied submittal drawing required. Pendants are pre-installed and pre-configured by Blackjack per signed submittal drawing. Customized installation instructions are supplied as necessary.
- For customer-set (DIY) option, pendants are installed in canopies with approximately 6' cable exposed. Customer to connect canopies and make adjustments to cable length in-field as desired.
- Standard 8' total of field-adjustable cable is included with each pendant (unless otherwise specified); no cutting or splicing required should adjustments need to be made in the field.
- Appropriate number of joiners and spacers included to complete configuration installation.
- Individual canopies with pendants can weigh as much as 50 pounds. Canopies and system must be mounted to rigid ceiling material (e.g., sheet rock, fire-rated plywood or similar) that can support system weight and accept drywall anchors, expandable fasteners or similar structural fasteners.

## **INSTALLATION FOR STJ PENDANT - REMOTE DRIVER**

### **(DRIVER SEPARATE FROM CANOPY)**

#### **PREPARATION**

1. Carefully remove the fixture from its box, and carefully unpack the bundled wire packages. Be careful not to bend or kink wires when unpacking. Remove the additional package with decorative light guides (14). Separate the ceiling plate (7) from the face plate (8) by loosening the four decorative finials (9).

#### **MOUNTING**

2. This fixture must be mounted into a rigid ceiling material (sheet rock, fire-rated plywood or similar) that can support the weight of the fixture and accept drywall anchors, expandable fasteners or similar structural fasteners (by others).

3. Place the ceiling plate (7) on specified position. It is recommended to start over a junction box (If applicable.) For a custom-made modular assembly, each fixture has an orientation and a specific location for installation. During installation, align all the orientation arrows located on the inside of the custom fixtures, to face the same direction. Drill eight support holes in the ceiling material using an appropriately sized drill bit. Insert ceiling anchors (16) (by others) into the holes. First screw the anchor screws halfway into the ceiling anchors (15); when the ceiling plate (7) is properly aligned in the installation, fully tighten all anchor screws (16). (see Figure 5)

4. Take the supply wires (2 & 3) and the house ground wire (4) to the driver (17) inside the remote housing (1) and attach 0-10V dimming wires (18, 19) to the driver (17) (optional.)

#### **INSTALL SPACERS AND JOINERS**

5. For runs that will use fixture spacers (23) and joiner kit(s) (21), first install the female side of the spacers (23) into fixture ceiling plate (7). Thread the male screws (24) through the spacer holes from inside of the ceiling plate (7) housing. Tighten them securely into the spacers (23) to secure.

6. Push out large center knock-out from first ceiling plate's (7) mating side. Remove the knurled ring (22) from either side of the joiner (21) and insert one end of threaded tube into the knock-out opening. Re-tighten the knurled ring (22) on one side. (See Figure 1)

a. To mount the second fixture, push out large center knock-out from second ceiling plate (7). Install the second ceiling plate (7) into the side with the fixture spacers and joiner kit. Insert fixture until it is securely aligned by the threaded rods of fixture spacers. Mark and drill eight support holes using the appropriately sized drill bit into a rigid ceiling material. Insert ceiling anchors (by others) into the holes. First screw the anchor screws (16) halfway into the ceiling anchors (15); when properly aligned with the joining ceiling plate (7), fully tighten all anchor screws (16) (see figure 5). Place knurled ring (22) over the end of the joiner bracket (21), and place the hex nuts (25) over exposed thread on the fixture spacers (23), and tighten. (See Figures 1 and 3)

#### **FINAL ASSEMBLY**

7. Adjust the pendant cable (17) to the desired length (if in doubt about exact length needed, leave a little extra cable until the final installation of the canopy cover (12)). Push the excess cable (17) up into the canopy cover (12) by pressing the small barrel of the gripper(14) upward. This will release the cable tension and allow the suspended cable to be pulled through gripper (14).

a. Wind the excess cable inside the canopy cover (12). Wrap the supplied Velcro strap to keep the excess cable from falling outside of the canopy.

b. Attach the low voltage power feed by plugging in the female connector(15) coming from the driver (7) to the male connector coming from the pendant cable (17).

8. Secure canopy cover (12) to the ceiling plate(10) by first aligning the canopy cut outs with the ceiling plate (10) tabs then pushing the canopy cover (12) up over the ceiling plate (10) and twisting to the right. Secure them together with the thumbscrew (13).

9. Align the light guide (21) with socket cap (19) and fixture shade support (20) then screw in the light guide (21) to secure in place.

FIGURE 1

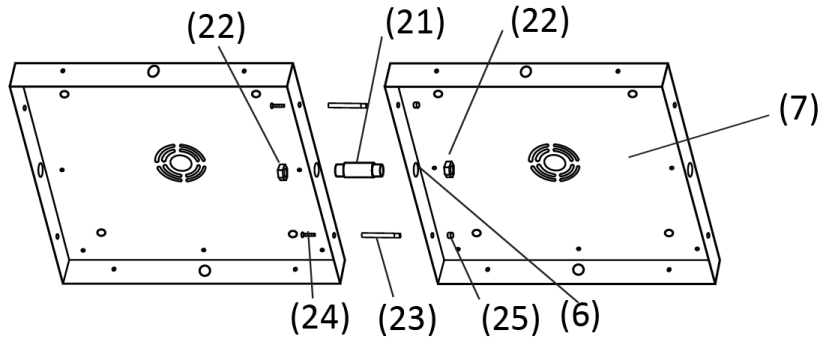

For additional connected modules in this first row, repeat the procedure above until single row is completed.

**Note:** Ensure orientation is correctly squared before proceeding to next row.

For additional rows of fixtures use spacer kits (23-25) to correctly space fixtures from one another.

**10.** Install spacers (23) with male threaded side pointing toward the first row, and leaving the female side of the spacers (23) with the male threaded side pointing toward the first row, and leaving the female side of the spacer to face the newly installed row. (See Figure 2)

FIGURE 2

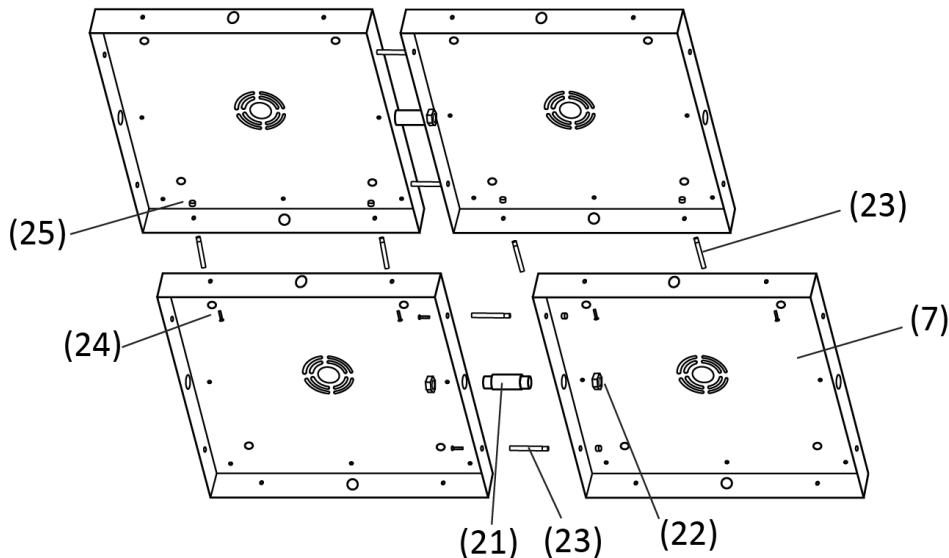

**11.** Suspend the from face plate (8) from ceiling plate (7) by attaching three support loops (11) to their mating hooks (10).

**12.** Make sure all wires are carefully placed inside face plate (8) and make sure all of the orientation arrows are aligned. Secure the canopy cover (8) to the ceiling plate (7) by aligning the holes in the canopy cover with the threaded standoffs (20), then tighten the four decorative finials (9) onto the threaded standoffs (20). If needed, adjust to preferred length by pushing the end of the gripper (12).

## ELECTRICAL CONNECTIONS

13. Attach house black (3) and white (2) 120-27V supply wires to driver.
14. Attach house ground wire (4) to fixture ground wire (5). (See Figures 3 and 4)
15. Attach House 0-10V dimming wire to drivers 0-10V - negative (18) and + positive (19) wires.
16. Attach the 2-pole male connector (29) to the end of the low voltage 24V wires and pull them through to the next canopy in the line. Plug the 2-pole male connector (29) into the female 2 -pole connector (28) and plug the start of the next low voltage 24V wire into the 2-pole female connector (28.) Repeat these steps until all fixtures are connected. (in case of multiple drivers connect all the canopies for that single driver and repeat the previous steps for the next driver (17).)
17. When connecting the faceplates (8) of the canopies, connect the drivers (17) low voltage 24V wires to a 2-pole male connector (29) and plug into the first female 2-pole connector (28) to complete the canopy wiring. Repeat these steps for the rest of the canopies in the line.

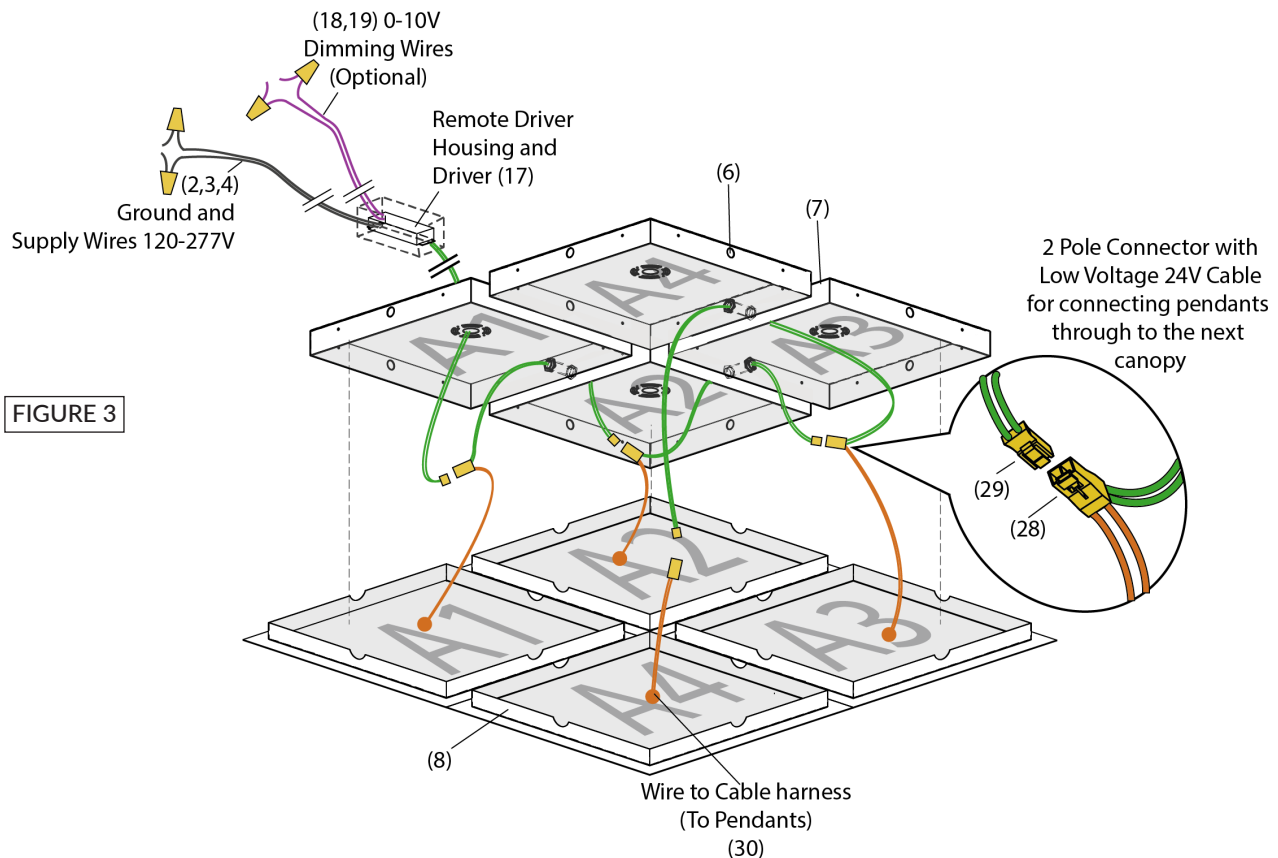

## FINAL ASSEMBLY

11. Assemble light guides and socket (13, 14) and adjust cord lengths before attaching the face plate (8) ceiling plate (7)
- Note: If fixture is preconfigured, skip to step 13.
- a. To install a decorative light guide (14) simply screw the threaded top of the light guide diffuser (14) into a socket (13). (See Figure 5)
  - b. Determine the approximate length of each suspension wire. If in doubt about exact length needed, leave a little extra wire until final installation of face plate (8). Push the excess wire into the canopy by pressing the small barrel of the gripper (12) upward. This will release the wire tension and allow the suspended wire to be pulled through the gripper (12). Roll excess wire into a small loop inside the canopy. Use supplied velcro strap, attached to each wire in the face plate (8). (See Figure 4)

### SINGLE REMOTE DRIVER OPTION

FIGURE 4

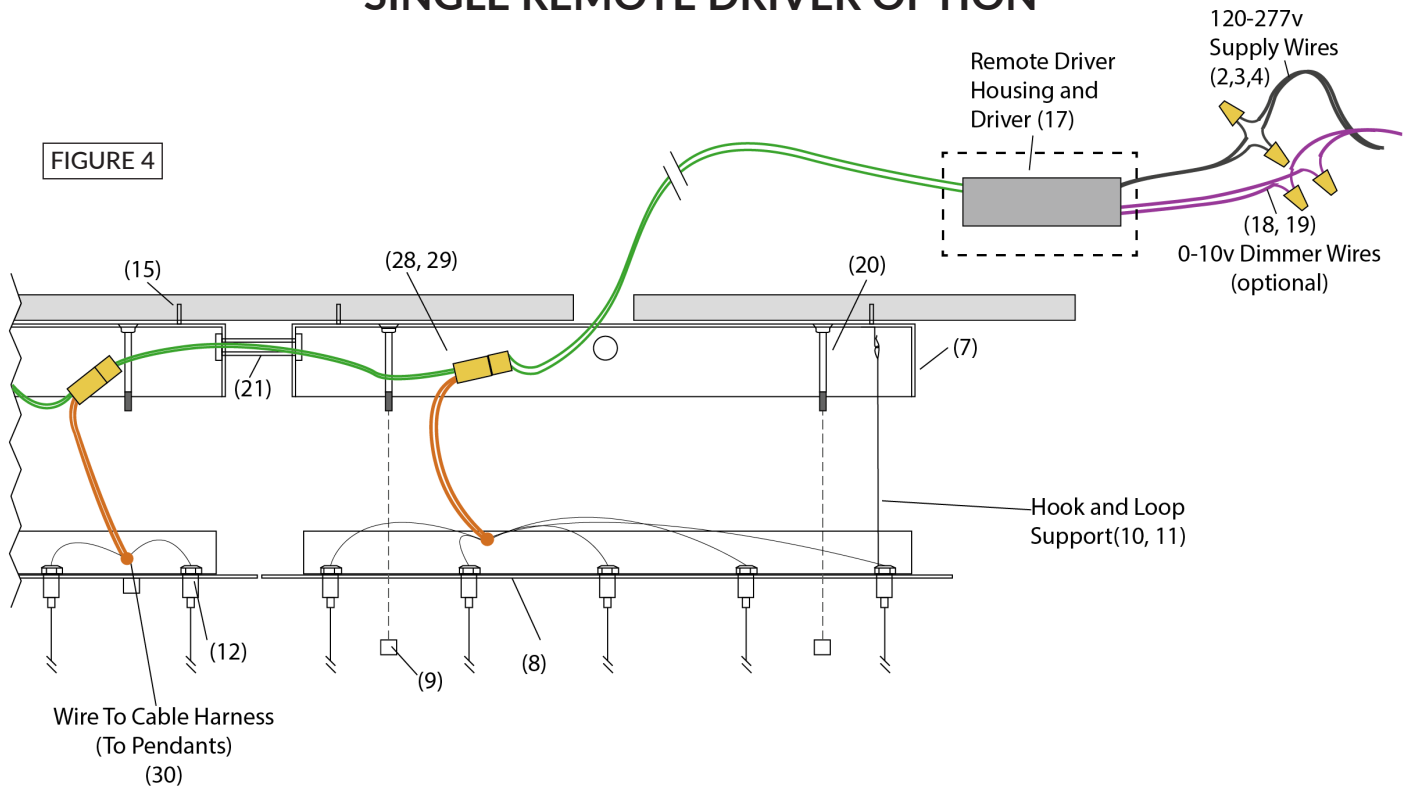

### MULTIPLE REMOTE DRIVERS OPTION

FIGURE 5

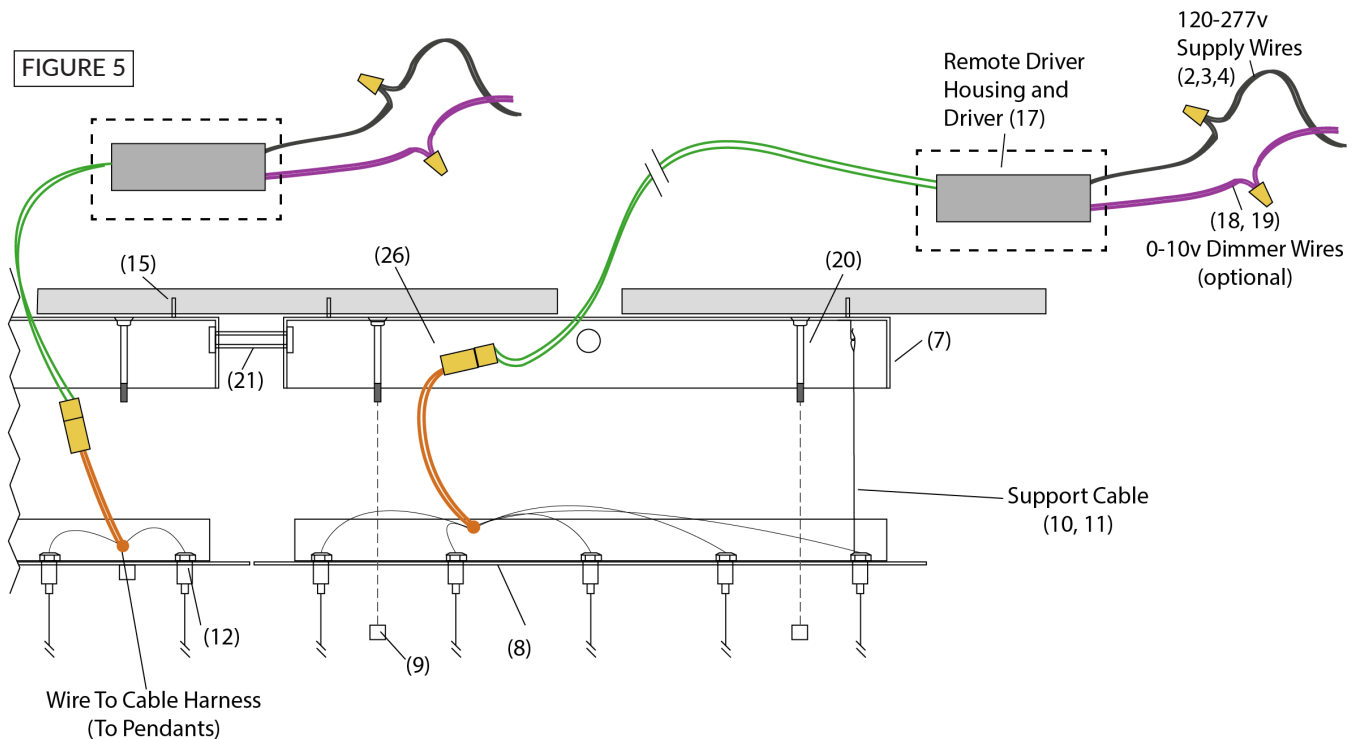

**Fine tuning:** Once the length of each wire has been established, any remaining bends or kinks in the wire can be straightened by bending out the kinks by hand while heating the cord with the warm air from a hair dryer or heat gun. Or contact BlackJack Lighting for a handheld wire straightener.

## DIMMING

- Fixture Dimming Type: TRIAC, ELV, or 0-10V dimmable.
- For recommended dimmers see <https://www.blackjacklighting.com>

## HARDWARE PER FIXTURE

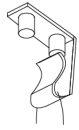

### Hook and Loops (#10, 11)

[ 3 Included ]



### Decorative Finial (#9)

[ 4 Included ]



### Anchor Screw (#16)

[ By Others ]

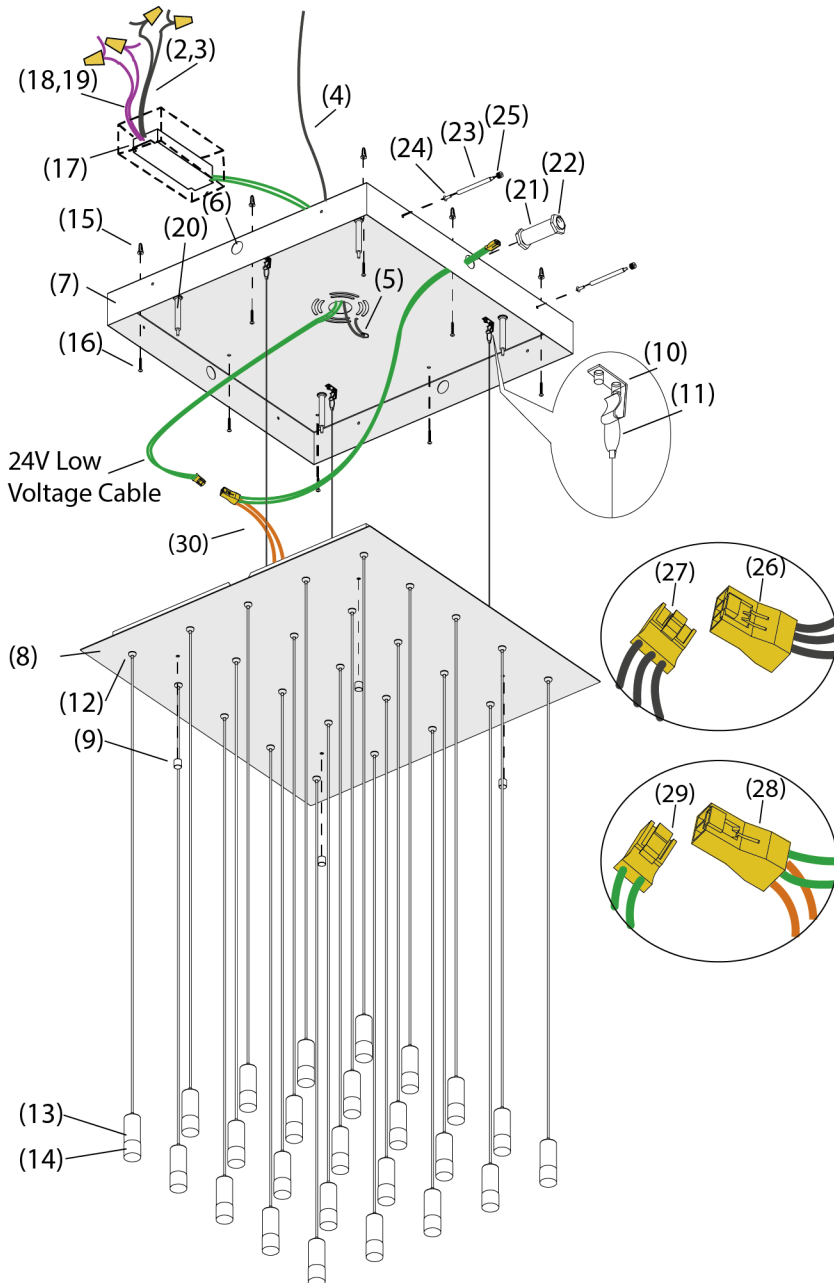

1. Remote Driver Housing (by others)
2. White Supply Wire
3. Black Supply Wire
4. House Ground Wire
5. Fixture Ground Wire
6. Joiner Kit Knock Out
7. Ceiling Plate
8. Face Plate
9. Decorative Finial
10. Hook
11. Loop
12. Gripper
13. Socket
14. Light Guide
15. Ceiling Anchor (by others)
16. Anchor Screw
17. Driver
18. 0-10V Dimming + (optional)
19. 0-10V Dimming - (optional)
20. Threaded Standoff
21. Joiner
22. Knurled Ring
23. Spacer
24. Male Spacer Screw
25. Spacer Hex Nut
26. 3 Pole 120-277V Connector Female
27. 3 Pole 120-277V Connector Male
28. 2 Pole 24V Connector Female
29. 2 Pole 24V Connector Male
30. Wire Harness Cable