

SLG-AL-03-XX-XXK-3W-XXX • SLG-MU-02-XXX-XXK-3W-XXX • SLG-SF-01-XX-XXK-3W-XXX  
SLG-TC-01-XX-XXK-3W-XXX • SLG-TF-01-XX-XXK-3W-XXX



### CAUTION

Turn off the main power at the circuit breaker before installing the fixture in order to prevent possible shock. If you are unfamiliar with proper electrical wiring connections, obtain the services of a qualified electrician.

### GENERAL

Read all instructions carefully for safe operation and installation. All electrical connections must be in accordance with local and national electrical code (N.E.C.) standards. Remove the fixture and mounting package from box. Make sure no parts are missing by referencing these Installation Instructions. Please contact Blackjack Lighting at 847-941-0588 if any parts are missing or damaged. This product is suitable for DAMP locations.

### HARDWARE



Wire Connector Caps (#5)  
(3 included)



Back Plate  
Mounting Screw (#13)  
(2 included)



Thumbscrew (#15)  
(1 included)

## INSTALLATION FOR SP2 CANOPY:

**NOTE:** Fixture must be mounted to rigid ceiling material (sheet rock, fire rated plywood or similar) that can support the weight of the fixture and accept drywall anchors, expandable fasteners or similar structural fasteners.

**NOTE:** Recommended hole diameter for the ceiling hole is 1/2" but not bigger than 3/4".

1. Each pendant has two mounting screws(5) that require an anchor(4) to be mounted into the ceiling material (screws and anchors to be provided by final installer).
2. Ceiling top plate(3) has two holes for mounting with threads on the sides, to be used to mount the bottom housing(1).
3. Install the gripper(7) in the mounting hole in the canopy cover. Pull the coaxial cable through the gripper to determine the desired height of pendant.
4. The bottom housing(1) screws onto the top ceiling plate(3).
5. Each pendant has at least 8' of wire to connect to the remote driver (no cutting/splicing required).
6. Each pendant has a male modular plug(6) located at the end, to be plugged into the wire harness attached to the remote driver.

**DIMMING:** TRIAC or ELV dimming. For more information, see [blackjacklighting.com](http://blackjacklighting.com).

### EXPLODED VIEW OF SP2 CANOPY (REMOTE DRIVER with 2.5" CANOPY)

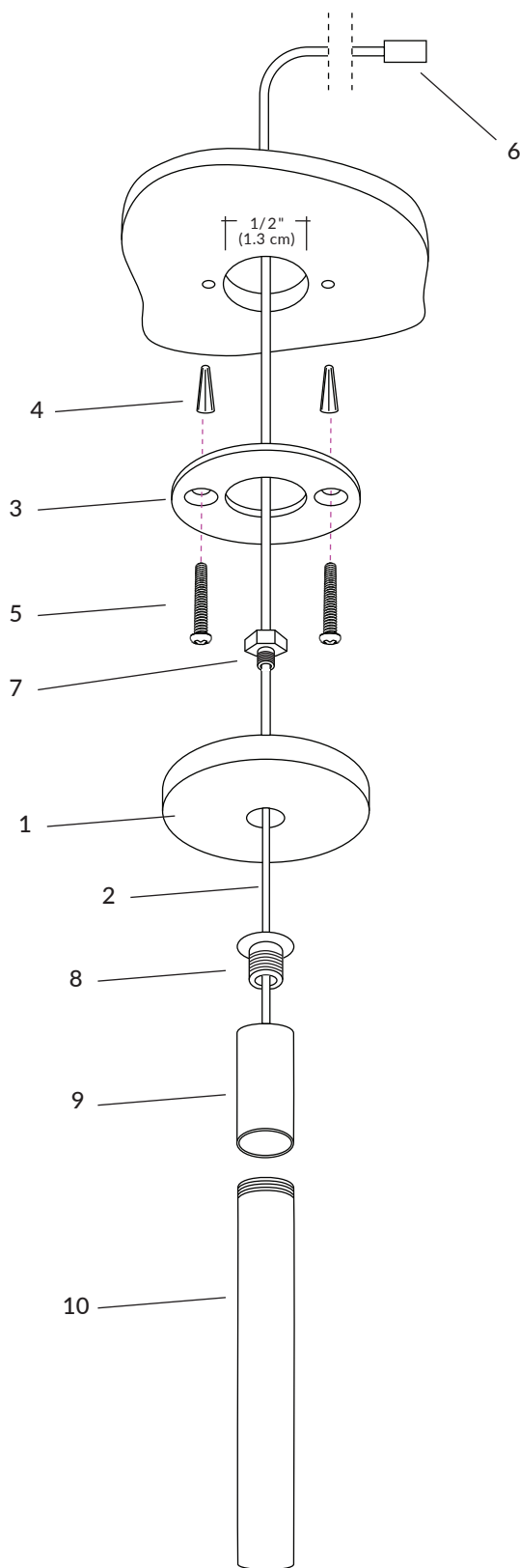

1. BOTTOM HOUSING
2. WIRE/CABLE
3. CEILING TOP PLATE
4. ANCHORS (BY OTHERS)
5. MOUNTING SCREWS
6. MALE MODULAR PLUG
7. GRIPPER
8. SOCKET TOP
9. SOCKET
10. LIGHT GUIDE/  
DIFFUSER/PENDANT

## GENERAL WIRING DIAGRAM FOR SP2 CANOPY (REMOTE DRIVER with 2.5" CANOPY)

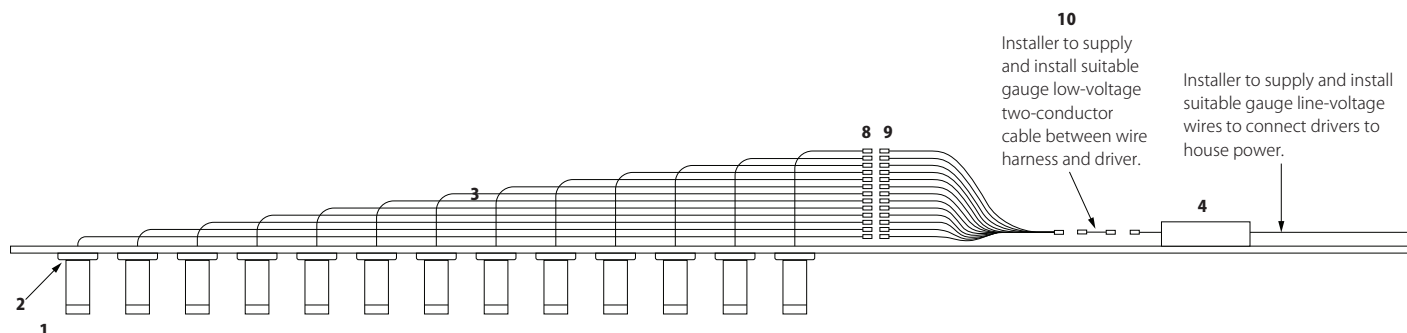

**1** - Pendant

**2** - Fascia Canopy

**3** - Each pendant has 12' of wire to connect to the remote driver and suspend the pendant.

**4** - Universal 96W Driver inside of a remote housing (120–277V, TRIAC, ELV, and 0–10V dimming) driver located in remote housing.

**8** - Power disconnect. Each pendant has a power disconnect located at the end, to be plugged into the wire harness attached to the driver.

**9** - 13-port or 9-port wire harness.

**10** - Two-conductor low voltage cable (provided by others)  
(see [blackjacklighting.com](http://blackjacklighting.com) for Voltage Drop Chart)

## INSTALLATION FOR SP5 CANOPY:

### PREPARATION

1. Carefully remove the fixture from its box.
2. Screw the light guide pendant(24) into the socket(23).
3. To remove the ceiling backplate(10) from the canopy faceplate(20) first loosen the thumbscrew(15), then push the canopy faceplate(20) up and twist to the left.
4. Pull the supply wires (2&3) and house ground wire(4) from the outlet box(1).

### MOUNTING

5. Once all the wires are connected carefully wind them up and secure with the included twist ties. Then place the wires back into the outlet box(1). Secure the ceiling backplate(10) to the outlet box(1) by sliding the mounting screws(13) through the holes in the ceiling backplate(10) and screwing them into the outlet box(1). Secure the bracket(19) to the ceiling backplate(10) with the included thumbscrew(15).

### FINAL ASSEMBLY

6. Pull up the pendant cable wire to so that the socket is flush with the canopy faceplate(20). Push the excess wire up into the canopy by pressing the small barrel of the hex nipple(22) upward. This will release the wire tension and allow the suspended wire to be pulled through hex nipple(22). Roll excess wire into a small loop inside the canopy. Wrap the supplied Velcro strap around this loop to keep the excess wire from falling outside of it.

### CONNECTING WIRES

7. Connect the white driver wire connector(16) to the white fixture wire connector(17); and the house ground wire(4) to the fixture ground wire(9).
8. Secure the canopy faceplate(20) to the ceiling backplate(10) by first pushing the canopy housing up over the ceiling backplate(10) and twisting to the right. Then secure with the thumbscrew(15).

### DIMMING

- Fixture Dimming Type: TRIAC
- For recommended dimmers see [blackjacklighting.com](http://blackjacklighting.com)

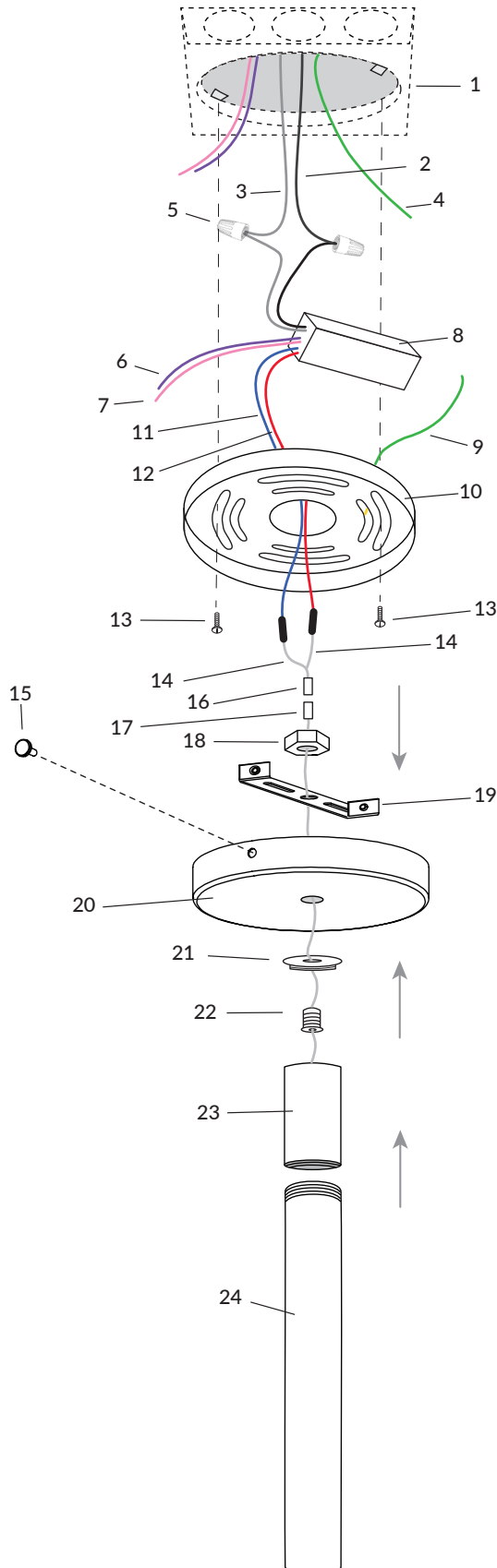

1. OUTLET BOX (*by others*)
2. WHITE SUPPLY WIRE
3. BLACK SUPPLY WIRE
4. HOUSE GROUND WIRE
5. WIRE CONNECTOR CAPS
6. PURPLE DIMMING WIRE
7. PINK DIMMING WIRE
8. DRIVER
9. FIXTURE GROUND WIRE
10. CEILING PLATE/BACKPLATE
11. BLUE POWER WIRE
12. RED POWER WIRE
13. MOUNTING SCREWS
14. WHITE FIXTURE WIRE(S)
15. THUMBSCREW
16. WHITE DRIVER WIRE CONNECTOR
17. WHITE FIXTURE WIRE CONNECTOR
18. HEX NIPPLE NUT
19. BRACKET
20. CANOPY FACEPLATE
21. SOCKET TOP
22. HEX NIPPLE
23. SOCKET
24. LIGHT GUIDE PENDANT