



CAUTION

Turn off the main power at the circuit breaker before installing the fixture in order to prevent possible shock. If you are unfamiliar with proper electrical wiring connections, obtain the services of a qualified electrician.

GENERAL

Read all instructions carefully for safe operation and installation.

All electrical connections must be in accordance with local and national electrical code (N.E.C.) standards.

Remove the fixture and mounting package from the box. Make sure no parts are missing by referencing the illustrations on these Installation Instructions. Please contact Blackjack Lighting at 847-941-0588 if any parts are missing or damaged. This product is suitable for DAMP locations.

PREPARATION

1. Carefully remove the fixture from its box.
2. Align socket threads with holes in pendant yoke.
3. Screw the white glass globes(31) into the stem sockets(29) with the yoke(30) fitting securely in between.
4. To remove the ceiling plate(16) from the canopy cover(26) first loosen the thumbscrew(25), then push the canopy housing up and twist to the left.
5. Pull the black and white supply wires(4,5) and the house ground wire(2) from the outlet box(1).

ELECTRICAL CONNECTIONS

6. Using the wire connectors(12), connect the white supply wire(4) to the white fixture wire(6); connect the black supply wire(5) to the black fixture wire(7); and connect the house ground wire(2) to the fixture ground wire(3) .

MOUNTING

7. Once all the wires are connected carefully wind them up and secure with the included twist ties. Then place the wires back into the outlet box(1). Secure the ceiling plate(16) to the outlet box(1) by inserting the mounting screws(19) through the holes in the ceiling plate(16) and screwing them into the outlet box(1).

FINAL ASSEMBLY

8. Adjust the pendant cables(28) to the desired length (if in doubt about exact length needed, leave a little extra cable until the final installation of the canopy cover(26)). Push the excess cable up into the canopy by pressing the small barrel of the gripper(27) upward. This will release the wire tension and allow the suspended cable to be pulled through gripper(26). Wind the excess cable(28) around the canopy bracket(23) located in the canopy cover(26). Wrap the supplied Velcro™ strap around this loop to keep the excess cable from falling outside of it. Then attach low voltage power feed by plugging in the WAGO connector(14) from the driver(17) to the male connector(22) from the pendant cable(28). Secure the wiring barrier plate(18) to the canopy cover(26) with the included screws(19).
9. Secure the canopy cover(26) to the ceiling plate(16) by first aligning the canopy(11) cut outs with the ceiling plate(16) tabs then pushing the canopy cover(26) up over the ceiling plate(16) and twisting to the right. Lastly secure them together with the thumbscrew(25).

HARDWARE INCLUDED:



Wire Connector (#12)

Qty. Included: 2



Mounting Screw (#19)

Qty. Included: 2



Small Screw (#20)

Qty. Included: 2



Canopy Thumbscrew (#25)

Qty. Included: 3



Velcro™ Twist Ties

Qty. Included: 2

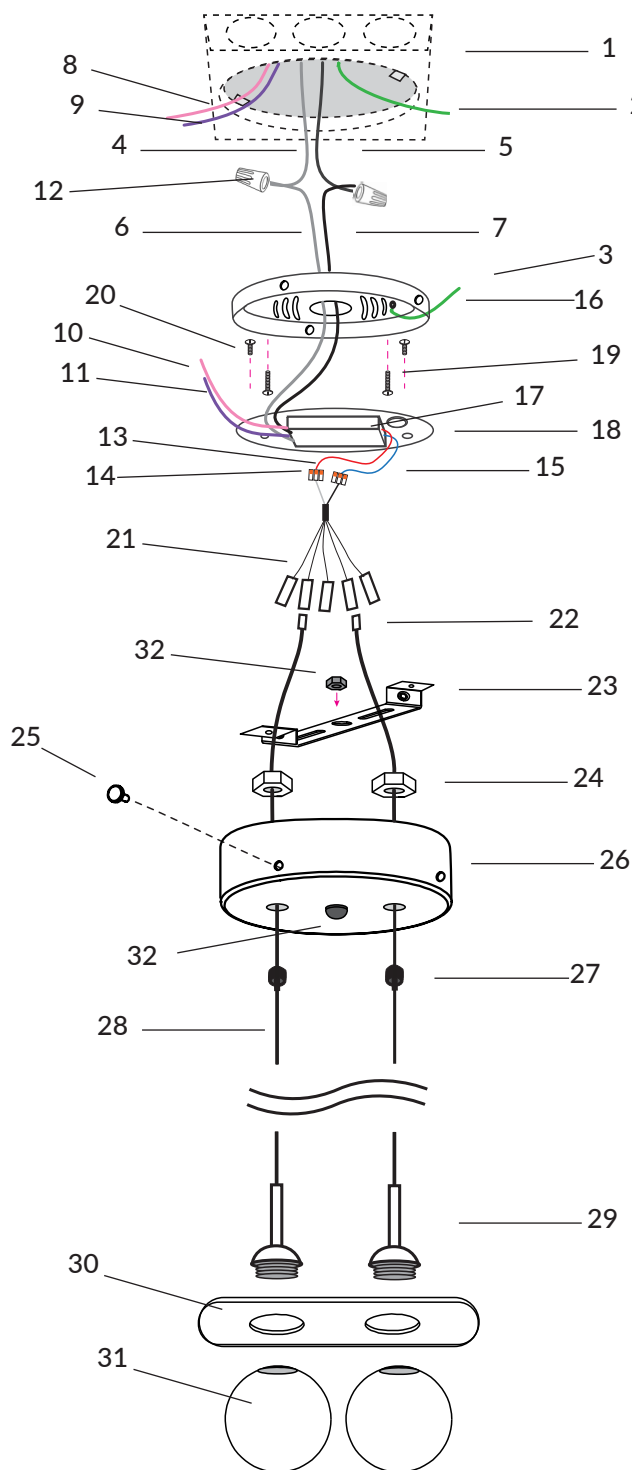

1. JUNCTION BOX
(not supplied by BJL)
2. HOUSE GROUND WIRE
3. FIXTURE GROUND WIRE
4. WHITE SUPPLY WIRE
5. BLACK SUPPLY WIRE
6. WHITE FIXTURE WIRE
7. BLACK FIXTURE WIRE
8. PINK HOUSE DIMMING WIRE
9. PURPLE HOUSE DIMMING WIRE
10. PINK FIXTURE DIMMING WIRE
11. PURPLE FIXTURE DIMMING WIRE
12. WIRE CONNECTORS
13. RED DRIVER WIRE
14. WAGO CONNECTORS
15. BLUE DRIVER WIRE
16. CANOPY CEILING PLATE
17. DRIVER
18. WIRE BARRIER PLATE
19. MOUNTING SCREWS
20. SMALL MOUNTING SCREWS
21. WIRE HARNESS
22. MICRO-CONNECTORS
23. CANOPY BRACKET
24. STRAIN RELIEF NUTS
25. CANOPY THUMBSCREWS
26. CANOPY COVER
27. GRIPPERS
28. CABLE
29. STEM / THREADED SOCKETS
30. YOKE
31. WHITE GLASS GLOBES
32. DECORATIVE FINIAL AND NUT