

RDD PENDANT INSTALLATION INSTRUCTIONS

RDD-010P-XX-27U-XXK

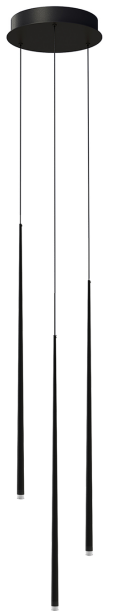

CAUTION

Turn off the main power at the circuit breaker before installing the fixture in order to prevent possible shock. If you are unfamiliar with proper electrical wiring connections, obtain the services of a qualified electrician.

GENERAL

Read all instructions carefully for safe operation and installation.

All electrical connections must be in accordance with local and national electrical code (N.E.C.) standards. Remove the fixture and mounting package from the box. Make sure no parts are missing by referencing the illustrations on these Installation Instructions. Please contact Blackjack Lighting at 847-941-0588 if any parts are missing or damaged.

This product is suitable for DAMP locations.

PREPARATION

1. Remove the fixture from its box. Carefully unpack the bundled wire packages. Be careful not to bend or kink wires when unpacking. Remove the additional package with the short cone pendants(20).
2. Remove the ceiling plate(11) from the canopy cover(13) by loosening the three thumbscrews(14).

MOUNTING

3. Pull the supply wires(3,6) and the house ground wire(8) out of the junction box(1) and thread them through the large center hole in ceiling plate(11).
4. Place the ceiling plate(11) over the junction box(1). Then insert the mounting screws(12) through the slots in the ceiling plate(11), then tightly secure the mounting screws(12) into the junction box(1).
5. Temporarily suspend the canopy cover(13) from the ceiling plate(11) by attaching the support wire loops(21) to the mating hooks(22).

ELECTRICAL CONNECTIONS

6. Connect the white supply wire(3) to the white fixture wire(4); connect the black supply wire(6) to the black fixture wires(5); and connect the house ground wire(8) to the fixture ground wire(9). Carefully tuck all the wires back into the junction box(1).

FINAL ASSEMBLY

7. Pendants are set at factory to pre-determined length. If different lengths are desired, and if needed, push any excess cable up into the canopy by pressing the small barrel of the gripper(15) upward. This will release the cable tension and allow the suspended cable to be pulled through gripper(15). Roll the excess cable into a small loop inside the canopy. Wrap the supplied Velcro strap around the cable loop to keep the excess cable from falling outside of the canopy cover (13).
8. Make sure all of the cables are carefully placed inside canopy cover (13). To secure the canopy cover(13) to the ceiling plate(11) align the holes on the side of the canopy cover(13) with the holes on the side of the ceiling plate(11). Then insert and tighten the three thumbscrews(14).
9. Once assembled, any remaining bends or kinks in the wire can be straightened by bending out the kinks by hand while heating the cord up with the warm air from a hair dryer or heat gun.

DIMMING: TRIAC or ELV dimming. For more information, see blackjacklighting.com.

Questions? Please contact Blackjack Lighting at 847-941-0588.

HARDWARE



Wire Connector (#9)
(1) Included



Mounting Screw (#11)
(2) Included



Thumbscrew (#13)
(1) Included



Globe Thumbscrews (#24)
(3) Included

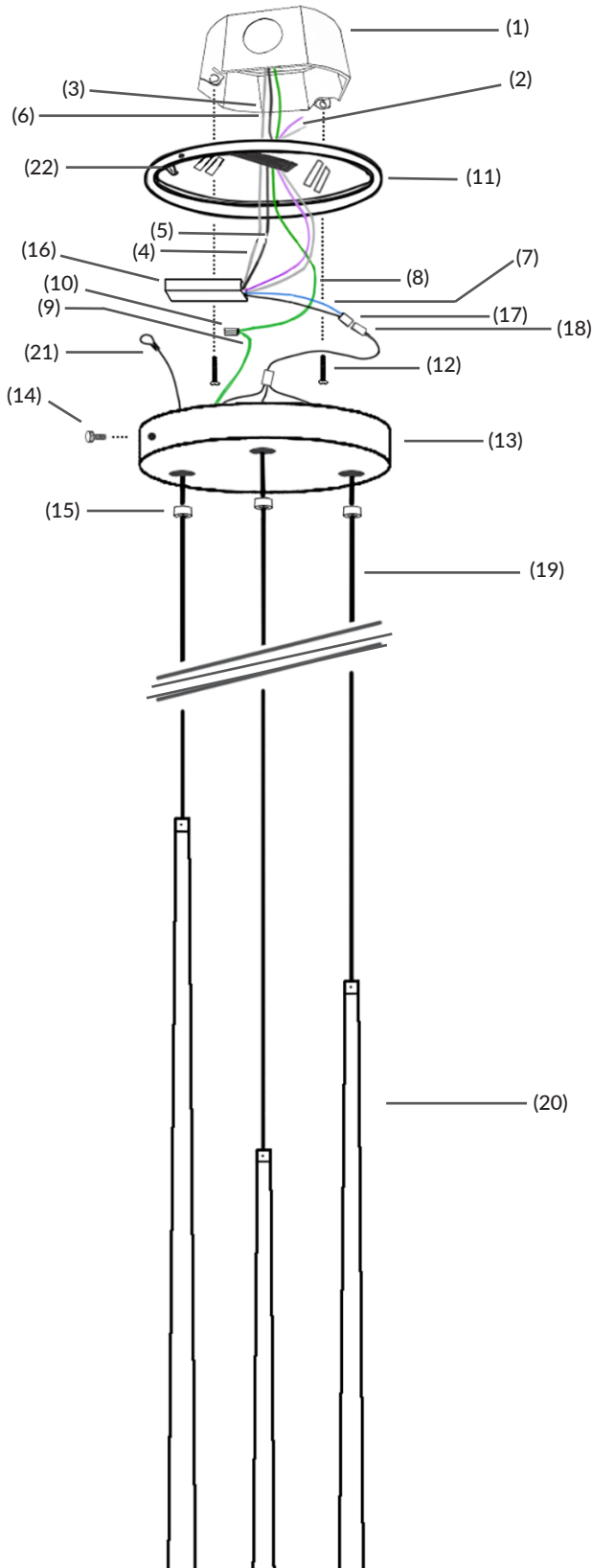

1. JUNCTION BOX (By Others)
2. 0-10V CONTROL INPUT WIRES (Optional)
3. WHITE SUPPLY WIRE
4. (FLAT) WHITE FIXTURE WIRE
5. BLACK FIXTURE WIRE
6. BLACK SUPPLY WIRE
7. GRAY & BLUE FIXTURE WIRES
8. HOUSE GROUND WIRE
9. FIXTURE GROUND WIRE
10. WIRE CONNECTOR
11. CEILING PLATE
12. MOUNTING SCREWS
13. CANOPY COVER
14. THUMBSCREW
15. GRIPPER
16. DRIVER
17. LOW VOLTAGE MODULAR CONNECTOR (From Driver)
18. LOW VOLTAGE MODULAR CONNECTOR (From Pendant)
19. SUSPENDED CABLE
20. SHORT CONE PENDANT
21. SUPPORT WIRE LOOPS
22. SUPPORT WIRE LOOP MATING HOOKS