

How to Install a Ceiling Fan

Hunter

While installing or replacing a ceiling fan might seem complicated, ceiling fan installation is a relatively straightforward process. With a few basic tools and materials, you can learn how to hang a ceiling fan in just a few steps. Refer to your owner's manual for detailed installation instructions.

SKILL LEVEL

DIY Friendly



DURATION

1-2 Hours



TOOLS & SUPPLIES



Wire strippers



Pliers



Screwdriver



9/64" Drill Bit



Wire Tester



Electric drill



Ladder

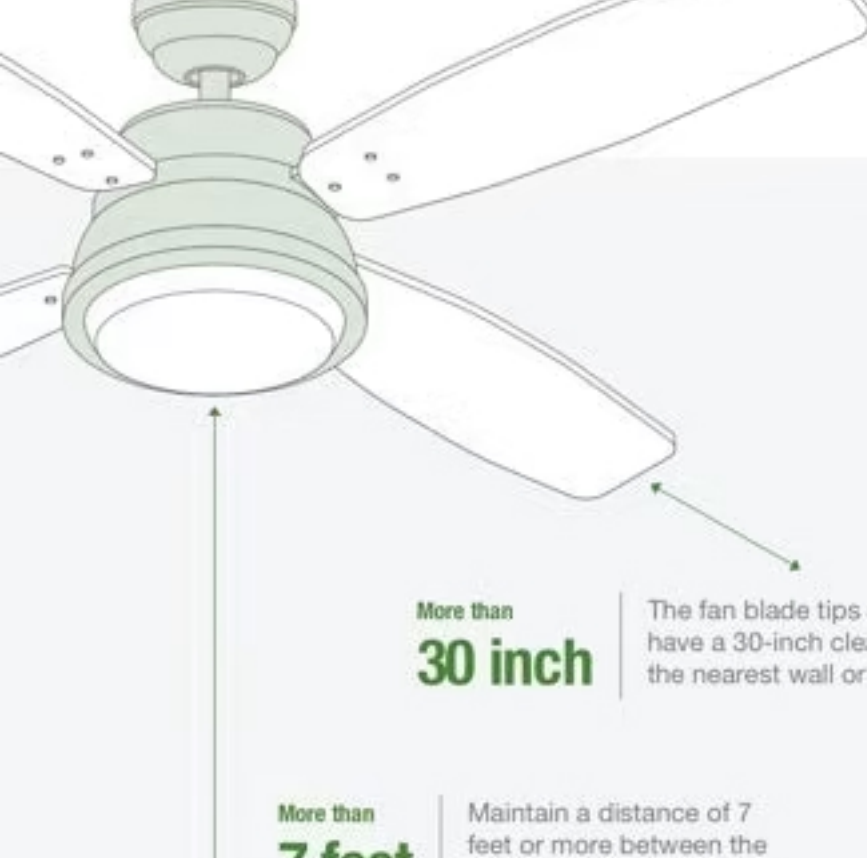

GETTING STARTED



Turn off Power

Shut off power at the circuit breaker and light switch before starting and leave it off until the project is complete.

1

Uninstall and Remove an Existing Fixture

SWITCH OFF

Turn off power at the wall light switch.



VERIFY

Use a circuit tester to verify the power is off.



REMOVE

Disconnect the existing fixture's wires and screws.



After uninstalling the existing fixture, verify that the electrical box is ceiling fan-rated. The ceiling fan box should be able to support 70 pounds.

2

Install the Ceiling Bracket



For downrod fans

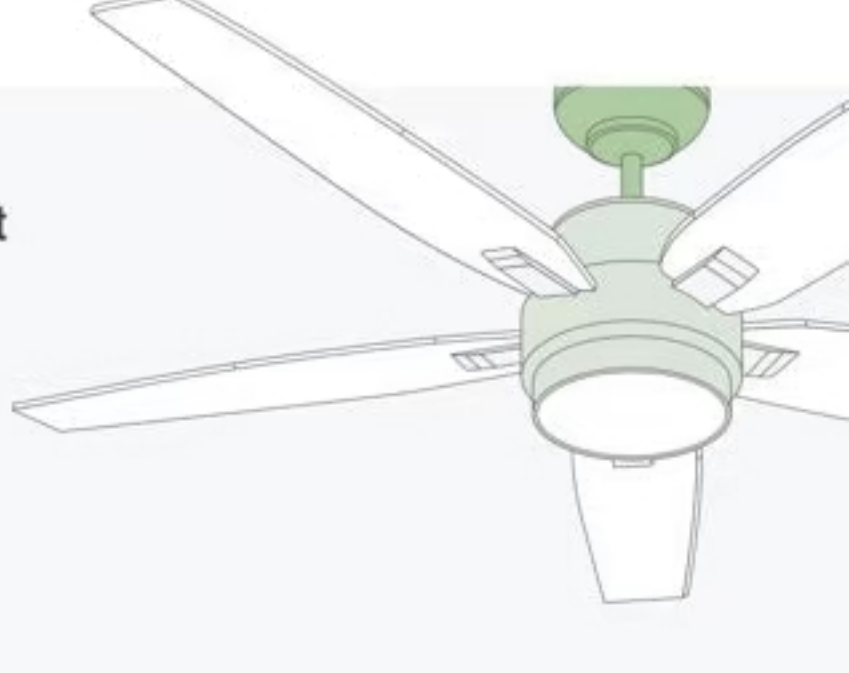

For low profile fans

4

Finish Installing the Canopy or Motor Housing



Canopy

Fans with a Downrod



Motor Housing

Low Profile Ceiling Fan

3

Wire the Ceiling Fan

These are the three most common ceiling fan wiring instances. Refer to your manual for specific wiring instructions.



Standard Pull-Chain

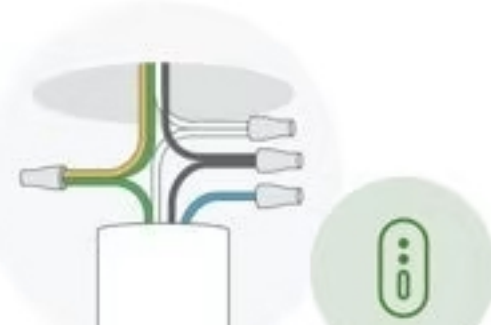

Pre-Installed Receiver



Remote Receiver



WARNING: All Wiring Must Be in Accordance with National and Local Electrical Codes ANSI/NFPA 70.

5

Install the Blades

There are three common blade installation methods for Hunter ceiling fans.

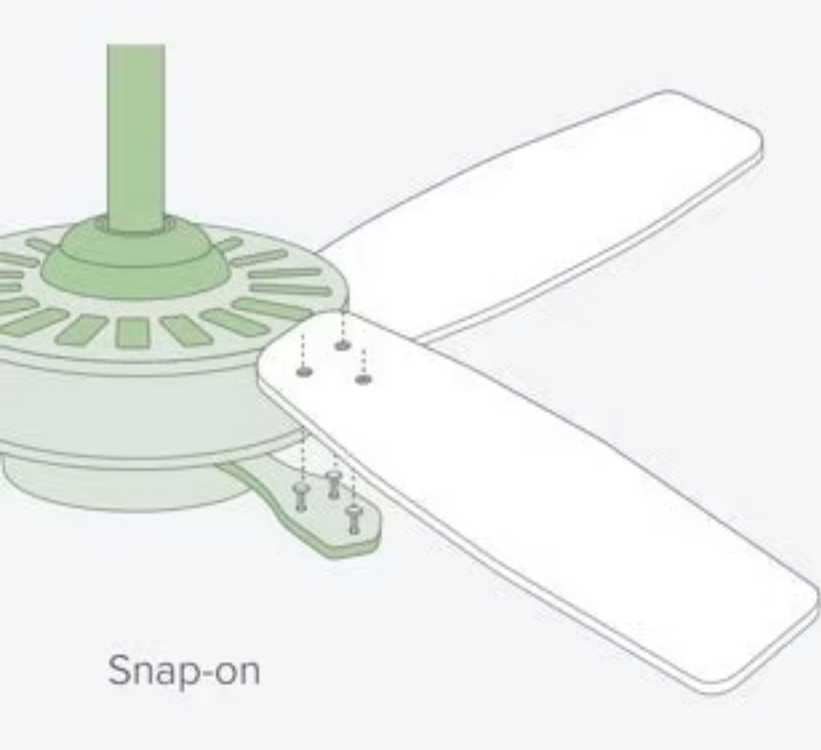

Snap-on

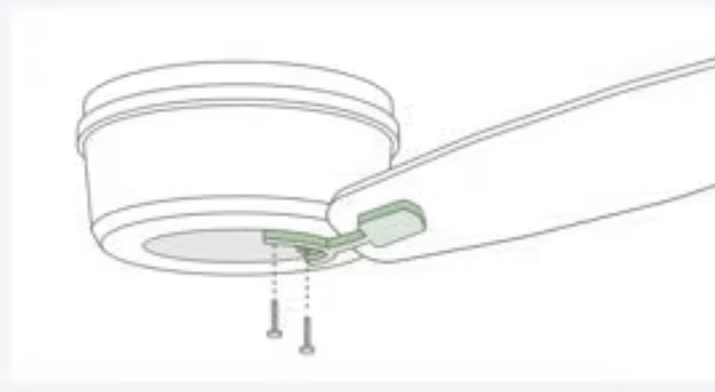

Ceiling Fans with Blade Irons

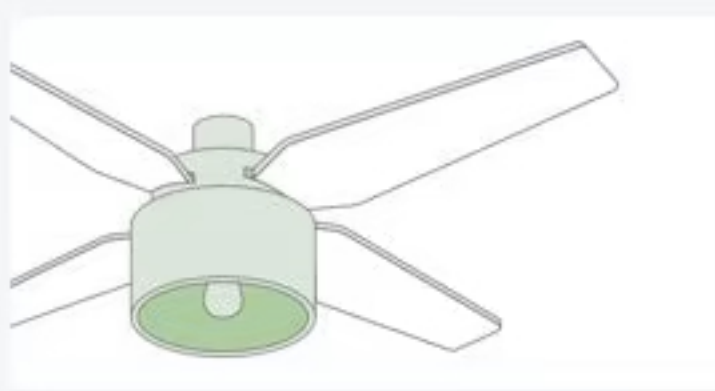

Ceiling Fans with Mid-Body Blade

6

Install the Lighting

Refer to your owner's manual for lighting instructions.

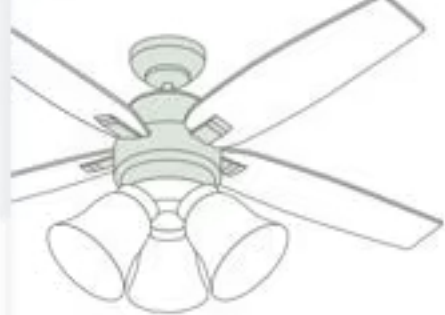

Multi Arm



Integrated



Bowl

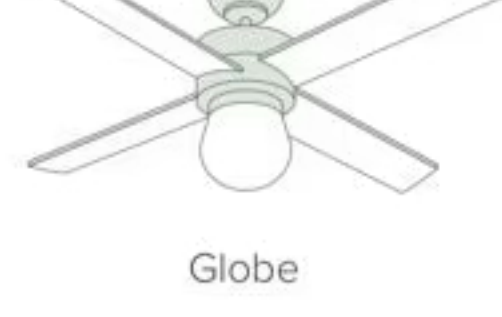

Globe

7

Use the Remote Controls

Hunter offers a variety of controls that make it simple to adjust your fan's features. Most remotes and wall controls are already pre-paired to the ceiling fan.



Wall Control

Installed at the wall switch to be easily found and used



Remote Control

Convenient control of your fan from anywhere in the room.



Smart Home

Use your smart device to control the fan with voice commands or the tap of a button

Visit hunterfan.com to find your perfect ceiling fan.

Hunter