

NEED HELP?
Call or Email us first

Our service team is ready to answer your questions...
1-800-265-1833 (English) / 1-800-567-2513 (French)
IN CANADA - ressaiescanada@canarmna.ca - IN USA - ressaiesusa@canarmna.ca

Monday – Friday
8 AM - 5 PM EST.



INSTRUCTIONS PERTAINING TO RISK OF FIRE OR INJURY TO PERSONS
READ ALL INSTRUCTIONS

IMPORTANT SAFETY INSTRUCTIONS SAVE THESE INSTRUCTIONS

TOOLS AND MATERIALS REQUIRED:



Phillips
Screwdriver



Wire Cutters



Pliers



Wrench

Wiring supplies
as required by
local electrical
code

SAFETY PRECAUTIONS:

1. TURN OFF ELECTRICAL POWER BEFORE STARTING INSTALLATION OF LIGHT FIXTURE.
2. THIS PRODUCT MUST BE INSTALLED IN ACCORDANCE WITH THE APPLICABLE INSTALLATION CODE BY A PERSON FAMILIAR WITH THE CONSTRUCTION AND OPERATION OF THE PRODUCT AND THE HAZARDS INVOLVED.
3. CONNECT THE GROUND WIRES (BARE COPPER OR GREEN) FROM YOUR FIXTURE TO THE GROUND WIRE (BARE COPPER OR GREEN) OR GROUND SCREW IN THE ELECTRICAL BOX.
4. TO CLEAN THE FIXTURE, TURN OFF THE POWER, WAIT FOR IT TO COOL, AND WIPE THE FIXTURE WITH A CLEAN, SOFT CLOTH.

NOTE: Product may not look exactly as shown in figures.

INSTALLATION:

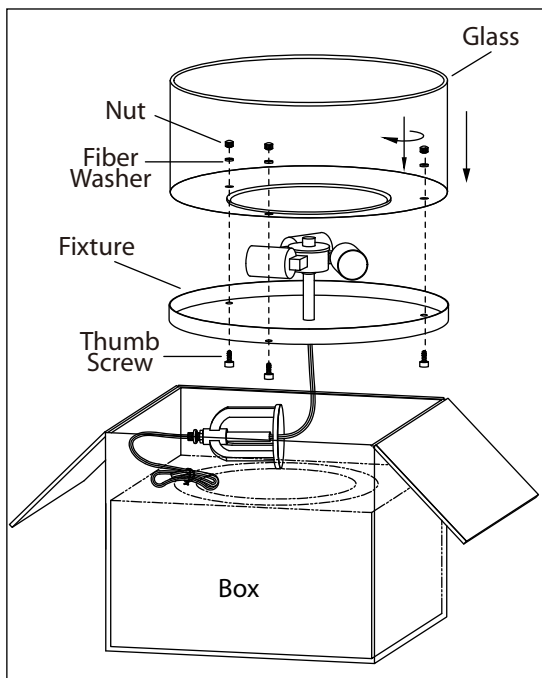

1. Turn the fixture up-side-down and use the box to hold the fixture. Tighten the glass to the fixture by the thumb screws, fiber washers and nuts.

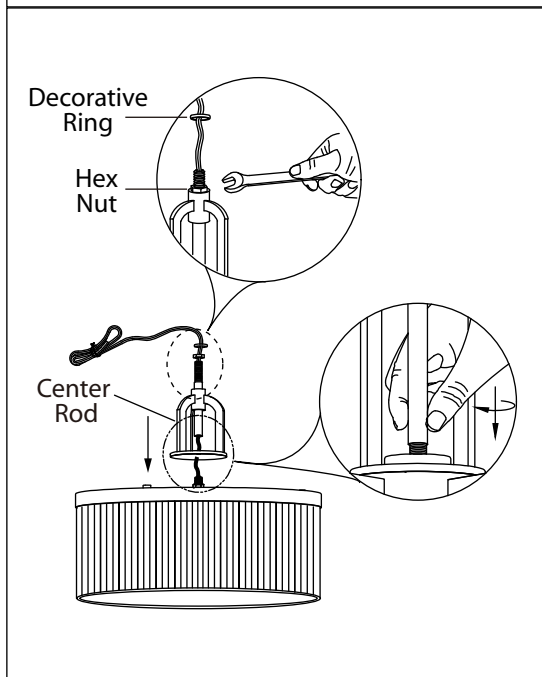

2. Turn the fixture up-side-down for further installation. Assemble the fixture by screwing the center rod to the threaded tube in the center of the fixture.

3. Tighten the hex nut to the center rod. Position the decorative ring in place above the hex nut.

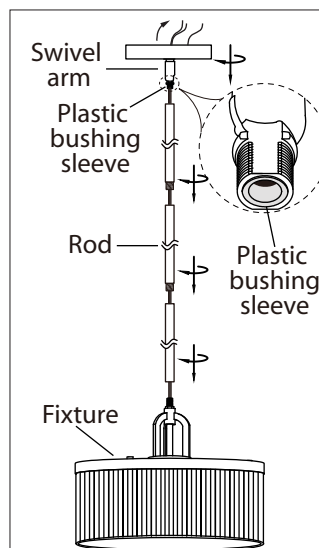

Note: Determine desired mounting option prior to proceeding with installation.

4. A. INSTALLATION FOR PENDANT MOUNT

- i. Install the length of rod that is required by threading wire through the rod and screwing it to the fixture. Install swivel to the rod, ensuring that the plastic bushing sleeve is at the swivel.

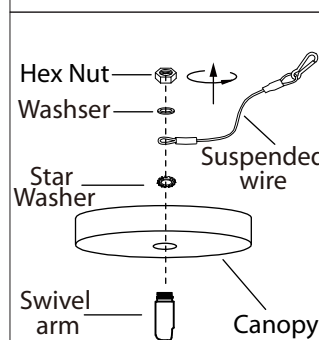

B. INSTALLATION FOR SEMI FLUSH MOUNT

- i. Remove the swivel arm from the canopy by unscrewing the hex nut, washer, suspended wire and star washer.

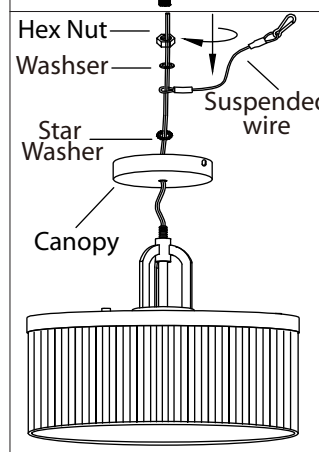

- ii. Place the canopy over the nipple on the fixture and secure in place with the star washer, suspended wire, washer and hex nut.

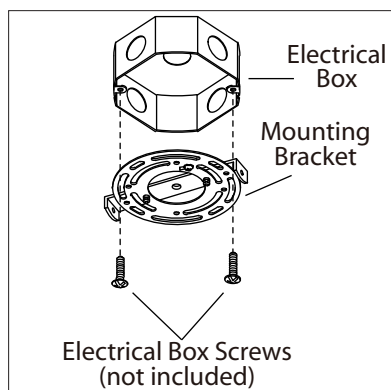

5. Mount the mounting bracket to electrical box using electrical box screws (not included).

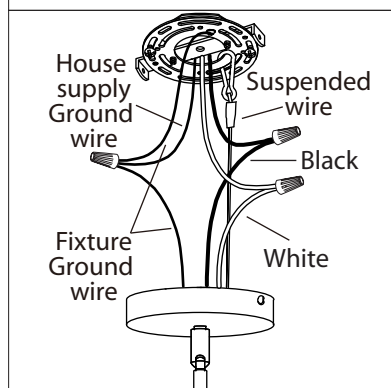

6. Use the suspended wire to hang the fixture as shown for wiring connection.

7. Connect the ground wires (bare copper or green) from your fixture to the ground wire (bare copper or green) or ground screw in the electrical box. Connect the black wire (or wire with marking) from the fixture to the black wire in the electrical box and connect the white wire from the fixture to the white wire in the electrical box.

8. Once connections of wires are completed, carefully tuck wires and wire nuts into the electrical box making sure no bare wire (on the black and white) is visible at the wire nuts.

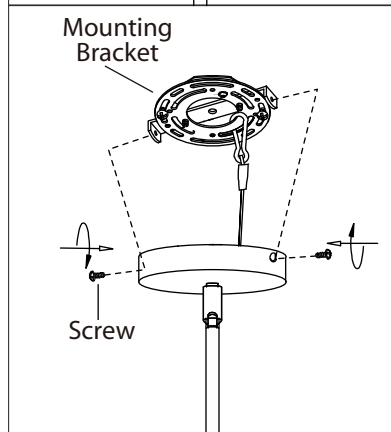

9. Attach fixture to mounting bracket by tightening the 2 screws.

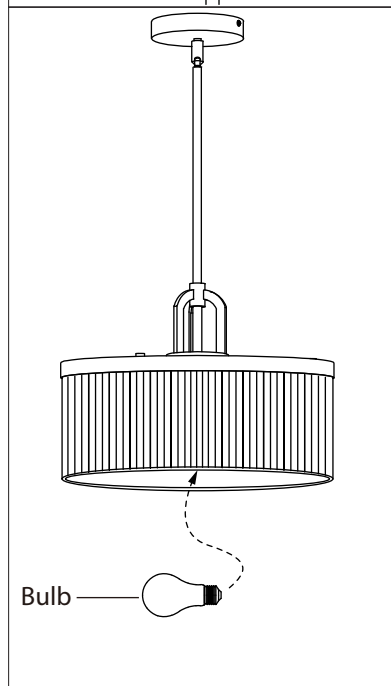

10. Install specified bulb type and wattage (not included).