

INSTALLING INSTRUCTIONS

ISTRUZIONI DI MONTAGGIO

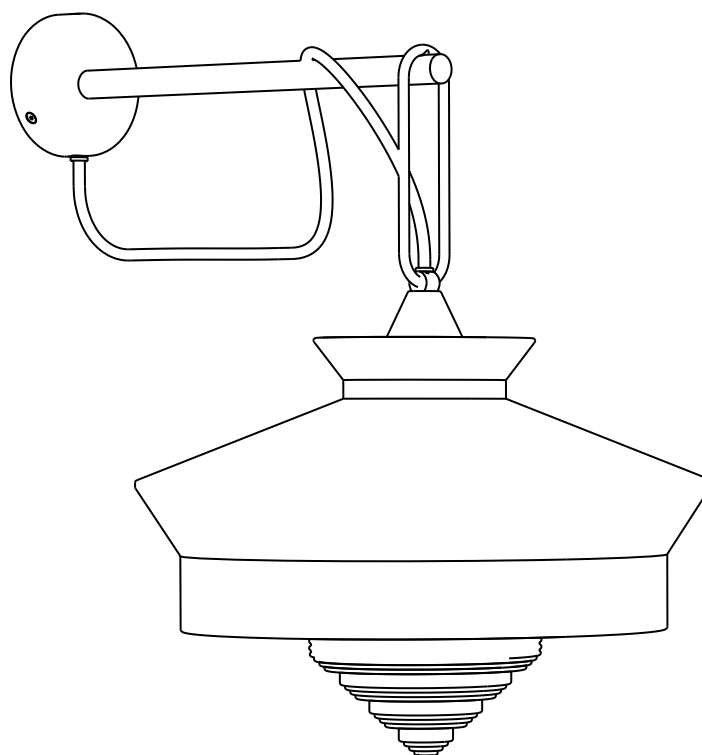

- 1 Fix the bracket on the wall
(use appropriate anchors
depending on the type of wall).

Fissare la staffa a parete
(utilizzare tasselli appropriati
in base al tipo di muro).

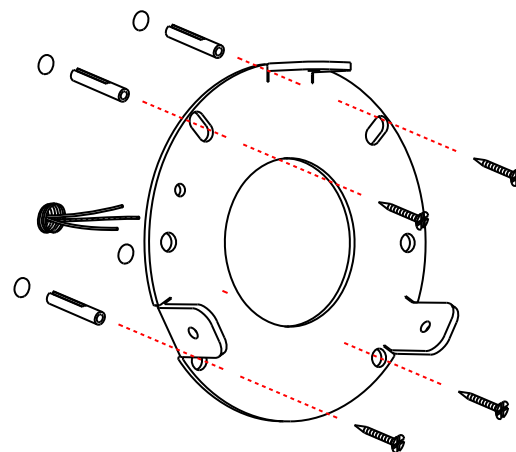

- 2 Connect the current cables
following the sketch
(connector provided by Contardi).

Connettere i cavi della corrente
seguendo lo schema
(connettore fornito da Contardi).

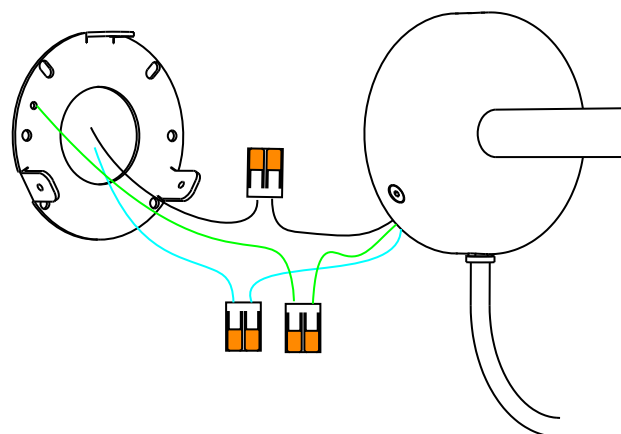
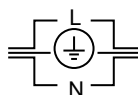

- 3 Fix the lamp to the bracket
using the screws provided.

Fissare la lampada alla staffa
usando le viti fornite.

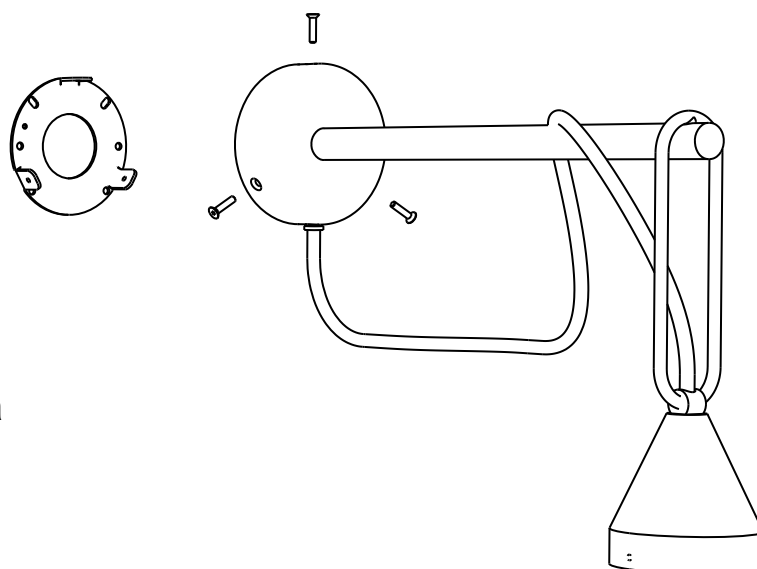

- 4 Remove the screws from the cone.

Rimuovere le viti dal cono.

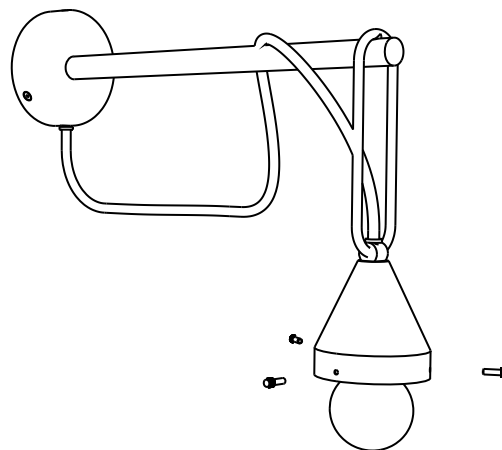

- 5 Insert the shade and keep it lifted up

Infilare il paralume e mantenerlo sollevato

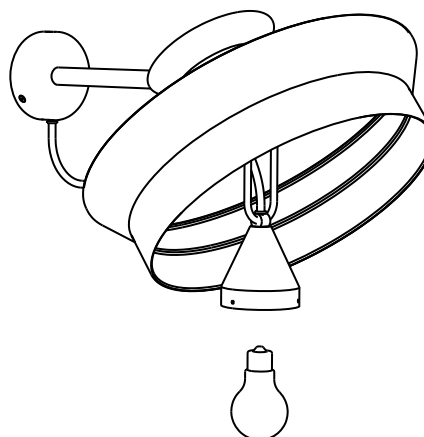

- 6 Screw the bulb

Avvitare la lampadina

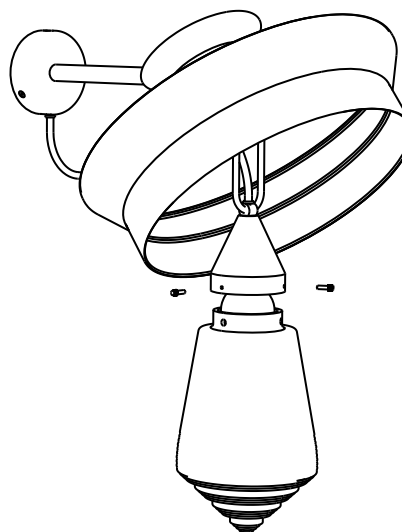

- 7 Insert the glass bell and tighten the screws.

Infilare la campana di vetro e stringere le viti.

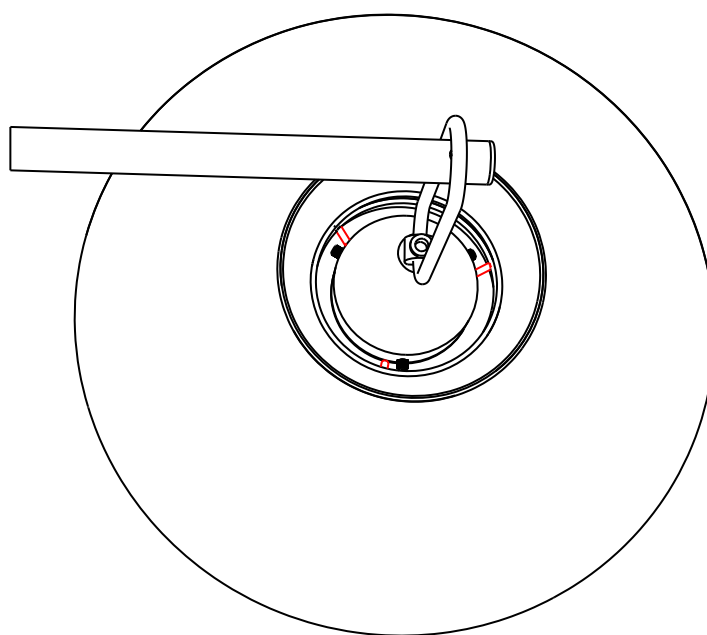
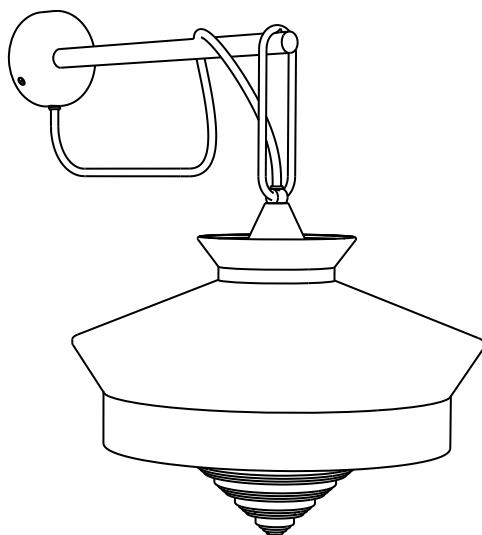

8

Place the lampshade making sure that the rubber pads of the disc lean against the glass bell.

Riposizionare il paralume assicurandosi che gommini del disco si appoggino alla campana di vetro.