

# Care Instructions

Pala Chest of Drawers – designed by Studio Böttger.

To prolong the life of the product and retain its appearance and functionality, we would like to give you some relevant information and care advice:

This product is manufactured using solid and veneered Oak or black Walnut.

Craftsmen manufacture this product and there is variety between each unit. Wood is a natural product so colour and grain variations are inevitable.

Natural Timber is affected by sunlight; this can cause the wood colour to darken. For this reason (especially if placed in direct sunlight) it is recommended that placing objects for long periods in the same position is avoided. This colour adjustment becomes less relevant as the product ages.

It is recommended that no abrasive cleaners or solvents are used to clean the unit, please only use proprietary furniture polishes or warm water with diluted detergent.

We thank you for purchasing this product and wish you many years of enjoyable and functional use.

For more related products please visit: [casefurniture.com](https://casefurniture.com)

# Pala Chest of Drawers

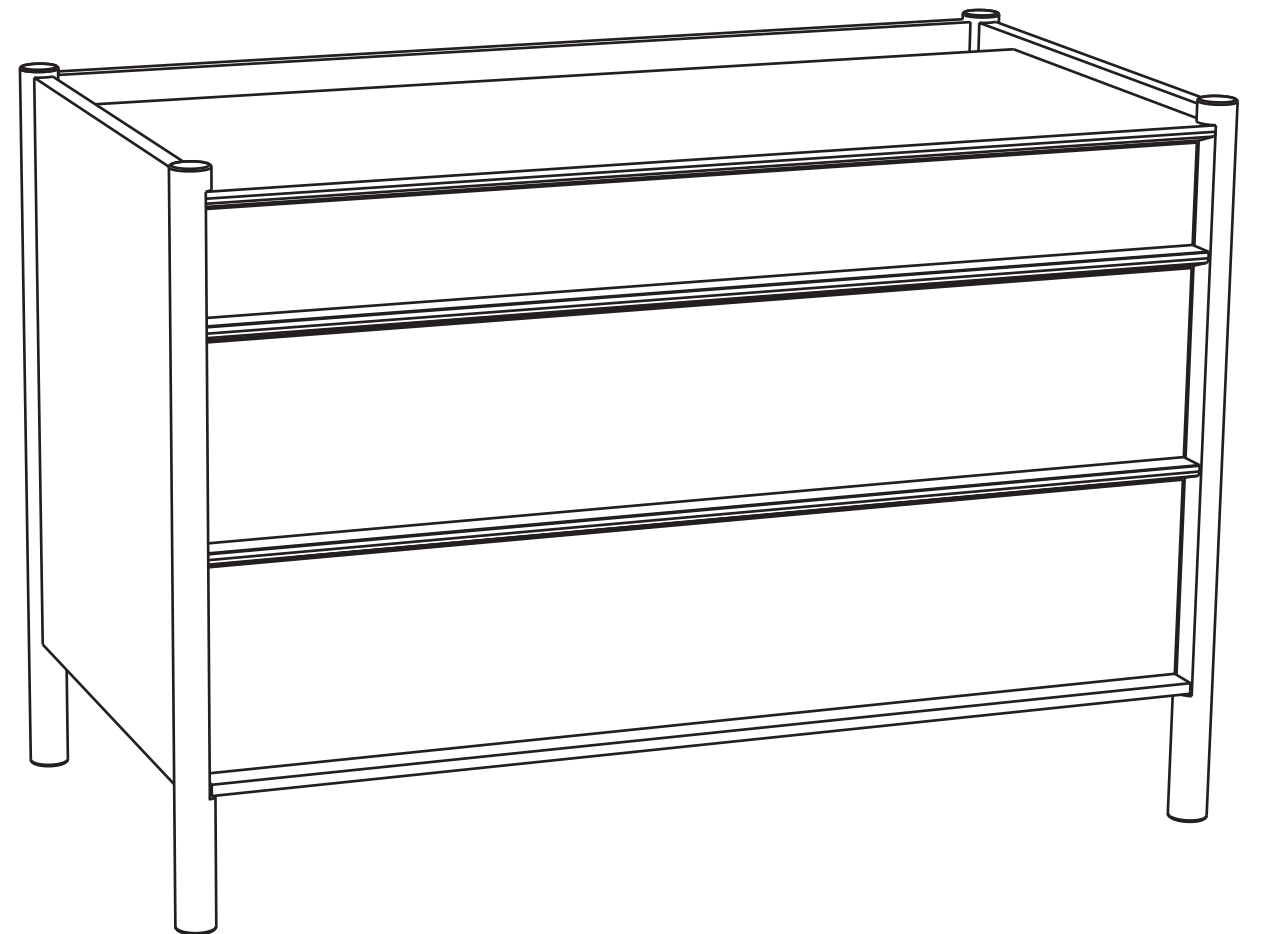

# Assembly Instructions

1

To secure the wall tie (if required).  
Take the wall tie (B) and the bolt (C) and  
secure one end into the threaded insert on  
the centre back of the carcass.  
Tighten fully with the Allen key supplied (A).

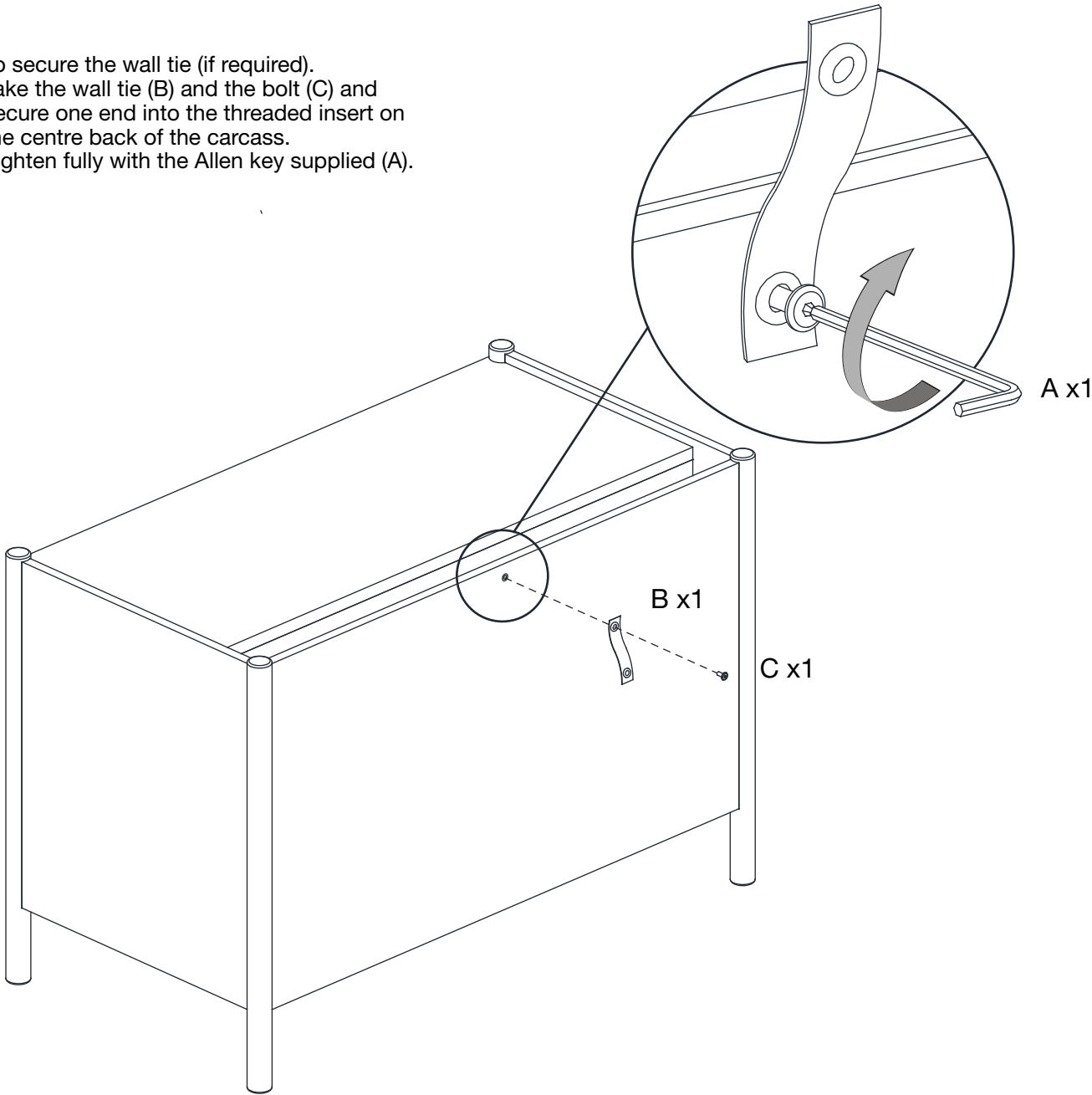

2

Take your preferred screw and wall fitting  
(not supplied) for your wall type and screw  
through the other end of the wall tie.  
the unit will now be secured into position.

