

Ella Swivel Lounge Chair
designed by Matthew Hilton

To prolong the life of the product and retain its appearance and functionality, we would like to give you some relevant information and care advice:

This unit comes with a fabric seat; with the option of stainless or black powder coated steel.

General Care

Upholstered items professionally cleaned when needed (we recommend around once per year).

Place furniture out of direct sunlight to help prevent fading. Avoid placing furniture near fireplaces or radiators.

Remove gum or wax by freezing it with a small plastic bag of ice until it hardens, then gently chip away. Repeat as necessary and blot with a damp, clean cloth to remove any stain left behind.

Prevent spills from turning into stains by blotting them immediately with a clean dry cloth. Always blot from the outer edge of a spill inward to help avoid a stain ring from forming. Do not use water to remove oil-based stains.

Use clear, cool water to help blot up resistant spills. Never use hot water, which tends to set stains.

Use a soft, clean cloth with a mild detergent to clean the leg frame.

Fabric Cleaning

Do not use cleaning solvents of any kind.

Never let water saturate fabric or pool in seams.

Brush pile fabrics lightly with a stiff bristle brush to remove minor stains and to regain original appearance.

Do not rub or use excessive force when brushing.

We thank you for purchasing this product and wish you many years of enjoyable and functional use.

For more related products please visit: casefurniture.com

Ella Swivel Lounge Chair

Matthew Hilton



Assembly Instructions

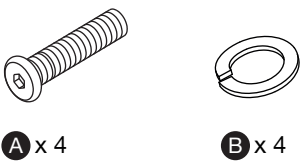

Required:

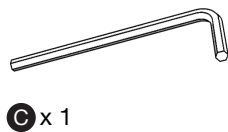

Step 01

Remove the shell from the box and place it gently on a soft surface as illustrated. Using the provided Allen key C tighten the bolts labeled A (x4) and spring washers B (x4) to secure the base plate to the shell. Make sure the base plate is oriented correctly, following the positioning shown in the illustration.

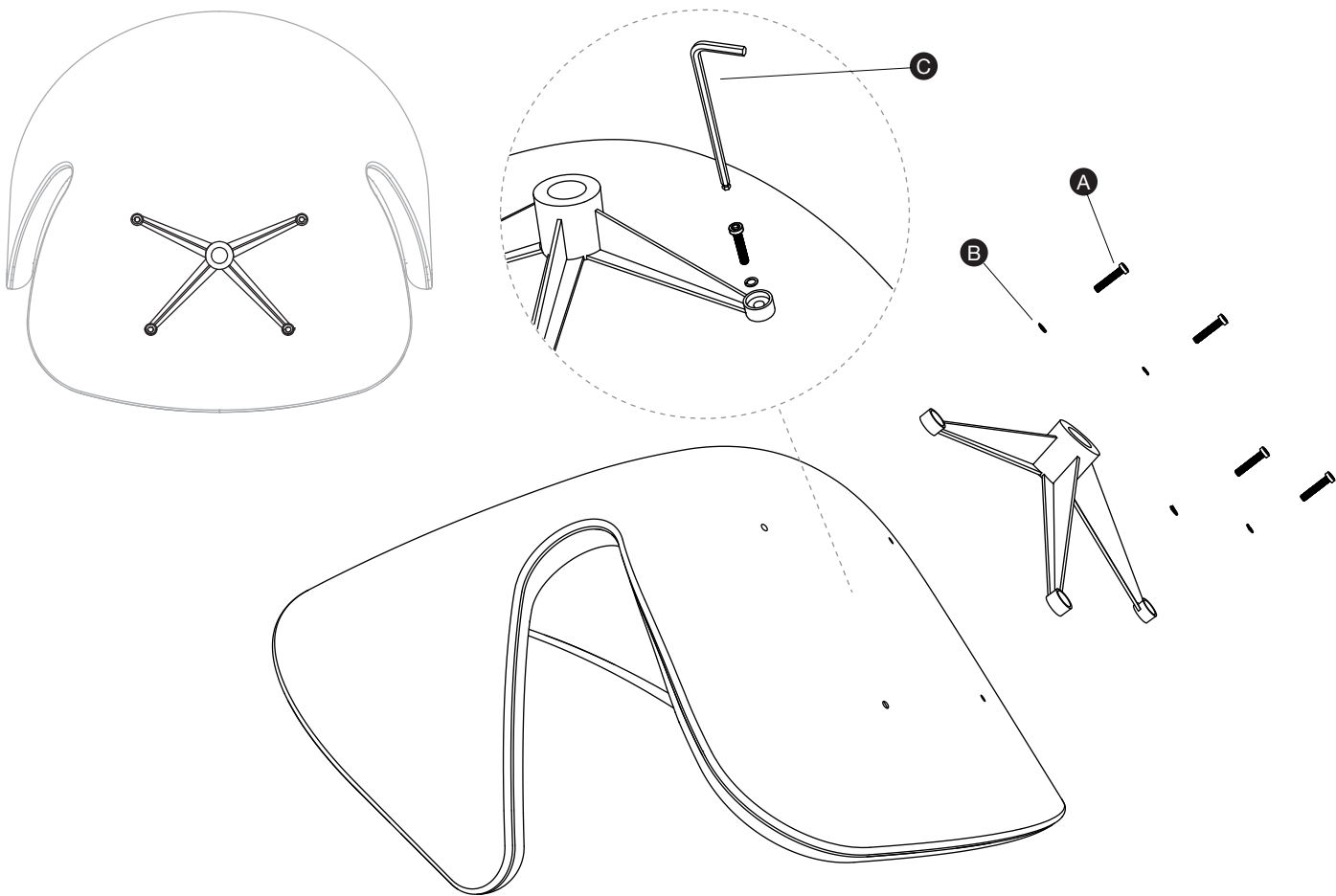

Step 02

Once the base plate is securely attached to the shell, turn the shell over and carefully slide it onto the base, ensuring proper alignment as shown in the illustration.

