

**Assembly Instruction Sheet #IS-8031W5C**  
**For Style 8031W5C**

**Tools Required:** Flathead screwdriver, Phillips screwdriver, pliers, wire cutters, wire strippers, electrical tape, safety glasses.

**Light Source: (2) E12 Base Bulb 60W Maximum(Not Include).**

**Preparation:** Identify and inspect all parts before beginning installation. Check package content list and diagrams below to be sure all parts are present. If any parts are missing or damaged, do not attempt to assemble, install, or operate the fixture. Contact customer service for replacement parts.

## Warnings and Cautions

Turn off electricity at circuit breaker or main fuse box before installation. Consult a licensed electrician if in doubt. These instructions are provided for your safety. It is very important you read them completely before installing the fixture. We strongly recommend that a licensed, professional electrician perform the installation.

Disconnect fixture from power source before replacing bulbs. Make sure bulbs are given sufficient time to cool before removal.

## Package Contents

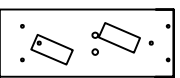

22mmx8PCS

63mmx1PCS

## 1 Crystal X6

22mm\*9PCS

0  
0  
+  
2  
0  
0

B	Metal frame x1
---	----------------

## 2 Crystal X7

30mm x 1PCS

### 3 Crystal X6

**C** Metal frame x1

## Hardware Contents

PART	DESCRIPTION	QUANTITY
BB	Electrical Marrets	2pcs
CC	Outlet Box Screw	2pcs

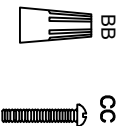

### STEP 1- Release Crossbar from Ceiling Canopy .

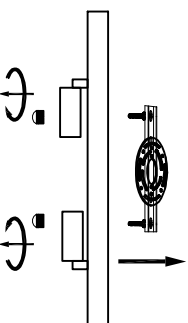

**Figure 1**

## STEP 2 - Install Metal frame

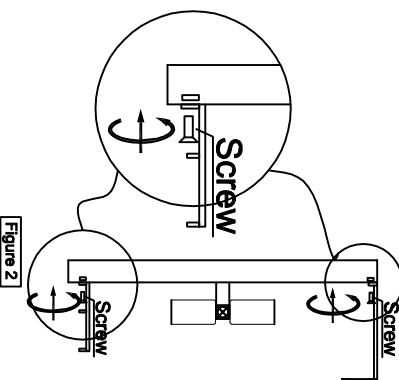

**Figure 2**

### STEP 3 – Attach Crossbar to Outlet Box

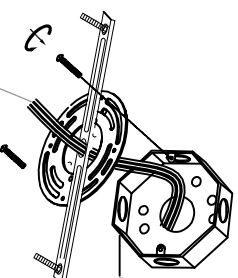

### Supply Wires with Outlet Box Screws Ground Wire

Figure 3

## STEP 5 - Install Backplate to wall

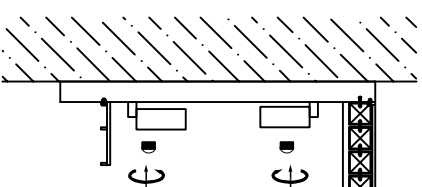

Figure 5

## STEP 4 - Wire Connections

A. Use standard wire connectors to make all wire connections. Twist connectors until wires are tightly joined together. Wrap each connection with approved electrical tape and carefully stuff all the connected wires into the Outlet Box.

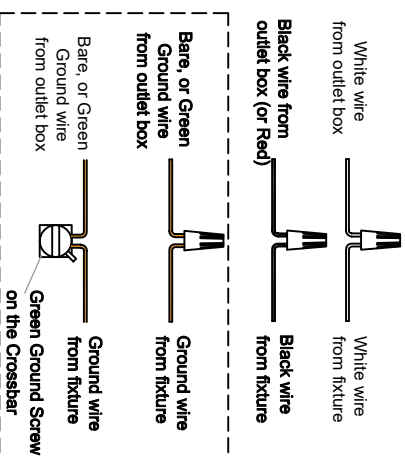

Figure 4

## STEP 6 – Install bulb And Crystal .

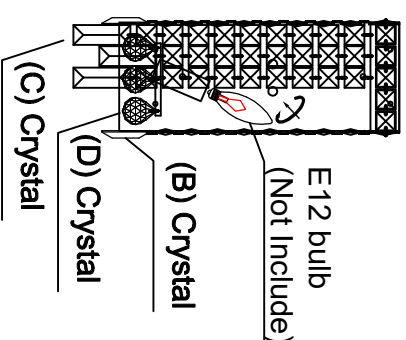

Figure 6