

## COMPONENTS AND HARDWARES :

All components and parts must be coded with stickers.

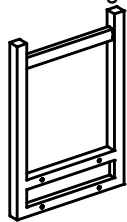

2 Wooden legs



1 Upper box

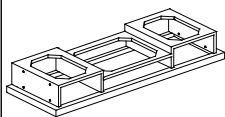

3 Drawer

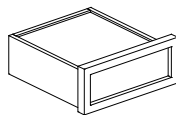

1 Stretcher



12 Allen key



1 Allen key

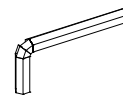

## ASSEMBLY STEPS

1. Remove the drawer from the upper box
2. Set wooden legs on the side of Upper box as coded with sticker as shown.
3. Set Allen bolts to join wooden legs and Upper box, then fasten allen bolt with allen key.
4. Set wooden Stretcher on the side of Wooden legs as coded with sticker as shown.

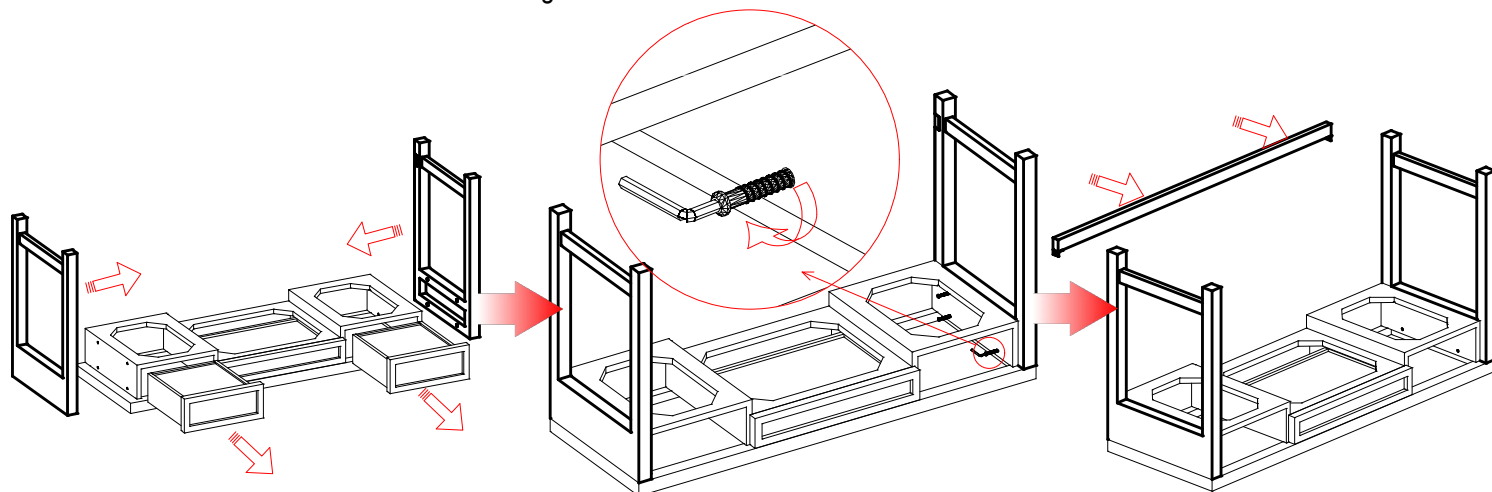

5. Set Allen bolts to join wooden legs and Wooden stretcher, then fasten allen bolt with allen key.
6. Flip over the product, Set the drawer in the Upper box.
7. The table is ready to use.

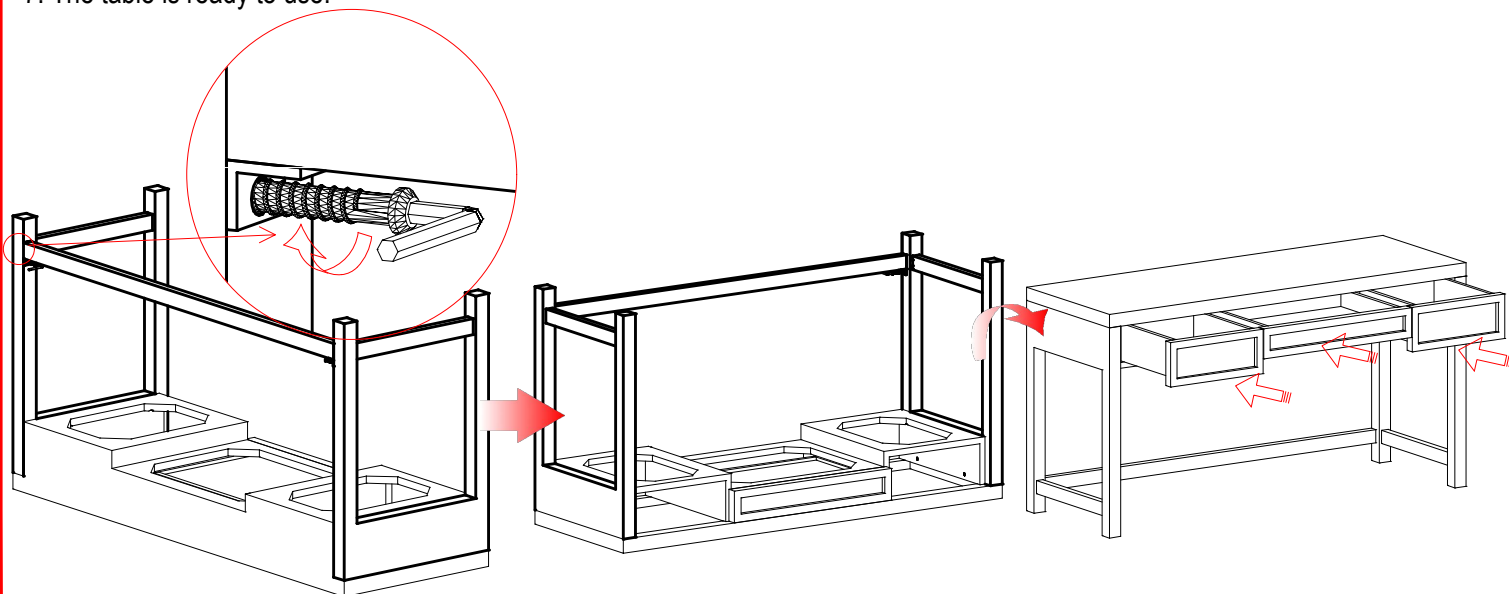

CHECKED BY :



Warning !

1. This item is knocked down. please DON'T slide this item, Lift it to avoid damage .
2. Do not over tighten. It will cause the screw to break or get loose.
3. assembly is done by a minimum of 2 strong people