

OAK BOK TABLE TOP ASSEMBLY INSTRUCTION FOR TABLE TOP INSTALLATION

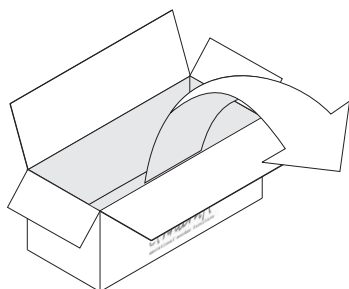

IN YOUR PACKAGE :

ASSEMBLY INSTRUCTION
HARDWARE (AS LISTED ABOVE)

PARTS TO BE INSTALLED

1. TABLE TOP

- 51515 / 51520 OAK BOK TABLE TOP 140
- 51516 / 51521 OAK BOK TABLE TOP 170
- 51517 / 51522 OAK BOK TABLE TOP 200

2. LEG BASE

- 59216 / 59219 METAL ADJUSTABLE TABLE BASE - EU
- 59217 / 59220 METAL ADJUSTABLE TABLE BASE - UK
- 59218 / 59221 METAL ADJUSTABLE TABLE BASE - US

HARDWARE ENCLOSED

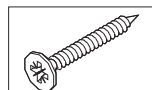

SCREW (16 pcs)
included in the
leg base packaging

TOOL

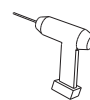

DRILLING MACHINE
(not included in package)

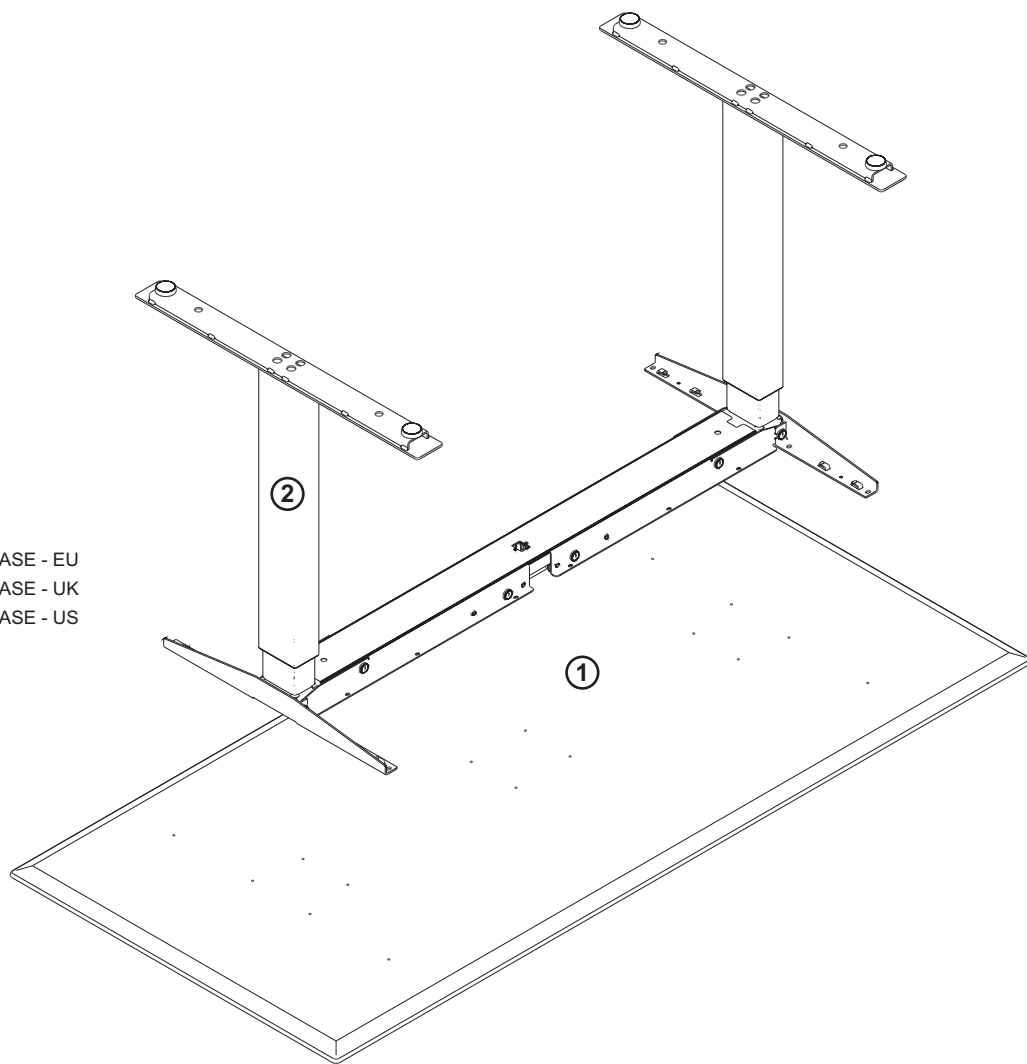

SYMBOLS



DIRECTION

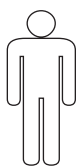

NUMBER OF
PERSON NEEDED



USE HAND

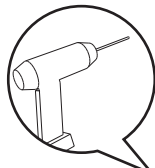

USE DRILLING MACHINE
TO TIGHTEN

NOTICE

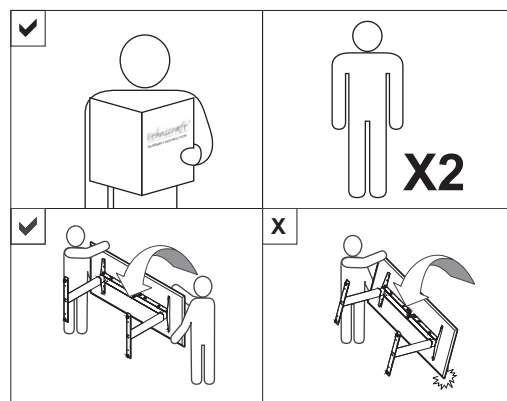

OAK BOK TABLE TOP ASSEMBLY INSTRUCTION FOR TABLE TOP INSTALLATION

A. EXTEND LEG BASE

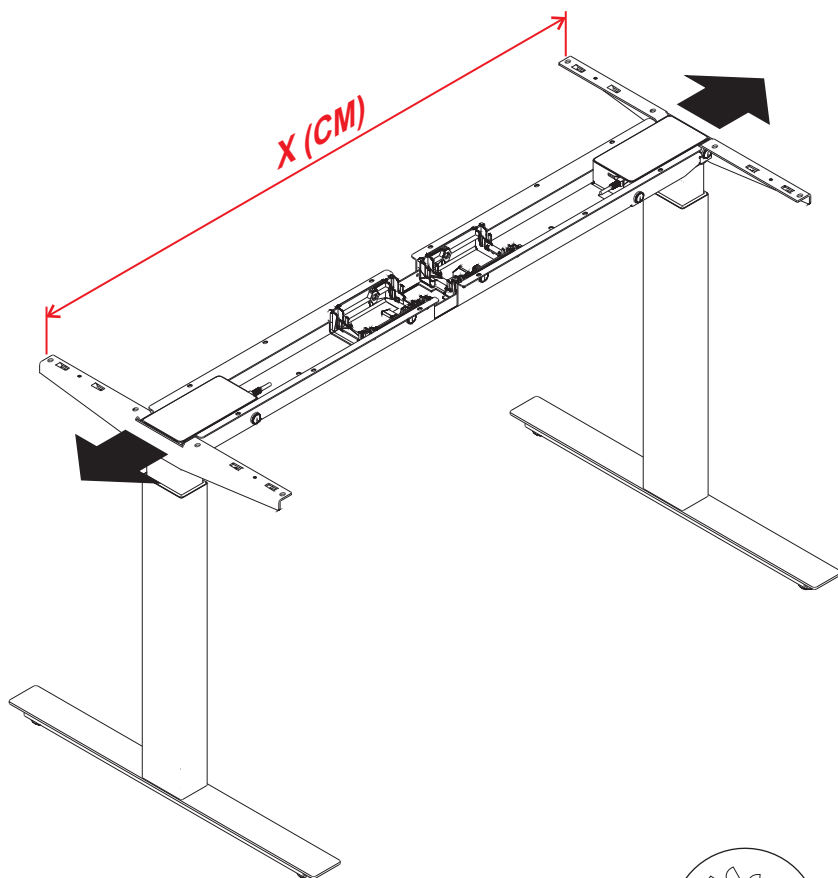
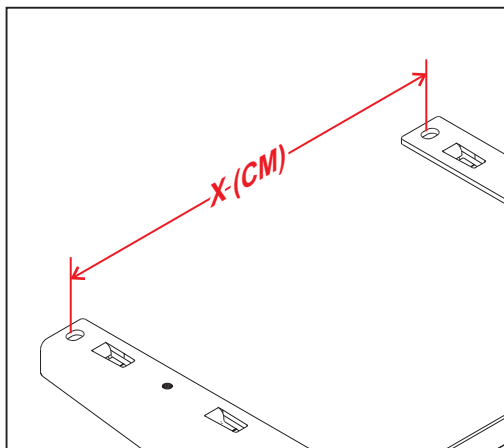
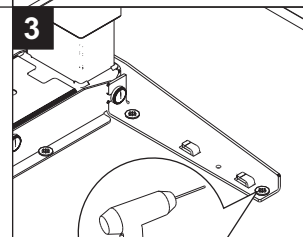
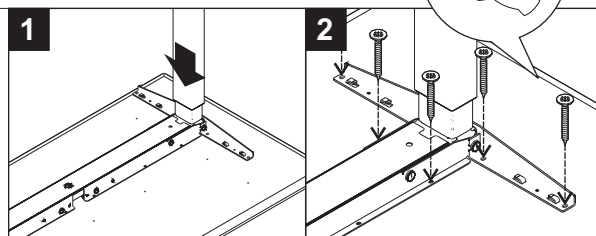
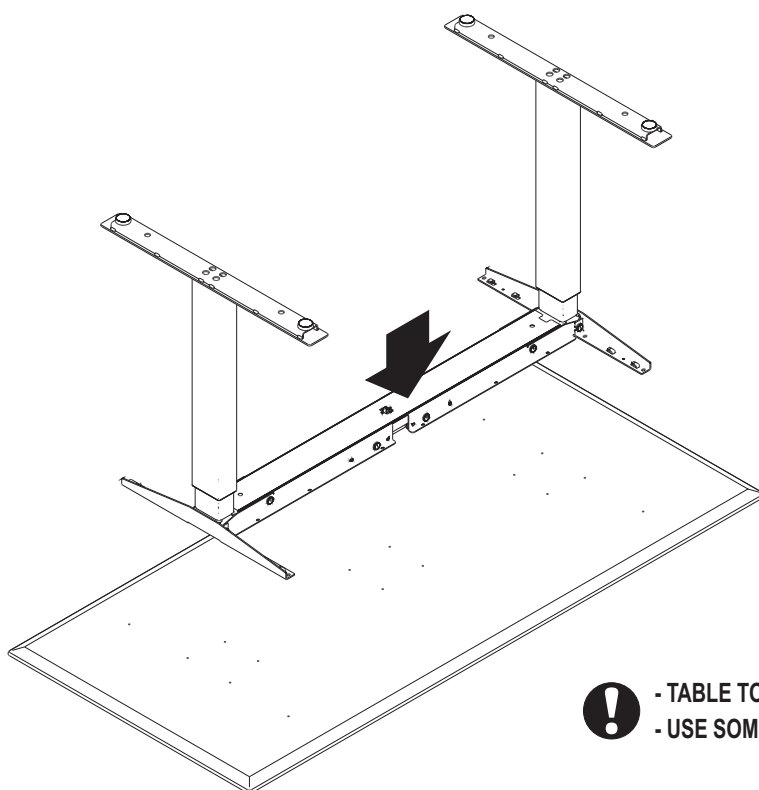

TABLE TOP SIZE (CM)	X (CM) (distance between pre-drilled holes)
140 x 72	112,4
170 x 80	131,4
200 x 88	155,4

B. INSTALLING LEG BASE TO TABLE TOP



! TIGHTEN FULLY



- TABLE TOP WITH PRE-DRILLED HOLES
- USE SOMETHING SOFT AS BASE TO PROTECT TABLE TOP FROM SCRATCHES