

STRING LIGHT SPHERE 12 mt APP CONTROL

Designed by Michale Anastassiades, 2021

F6488009



STRING LIGHT SPHERE 12 mt APP CONTROL

EN

F6488009

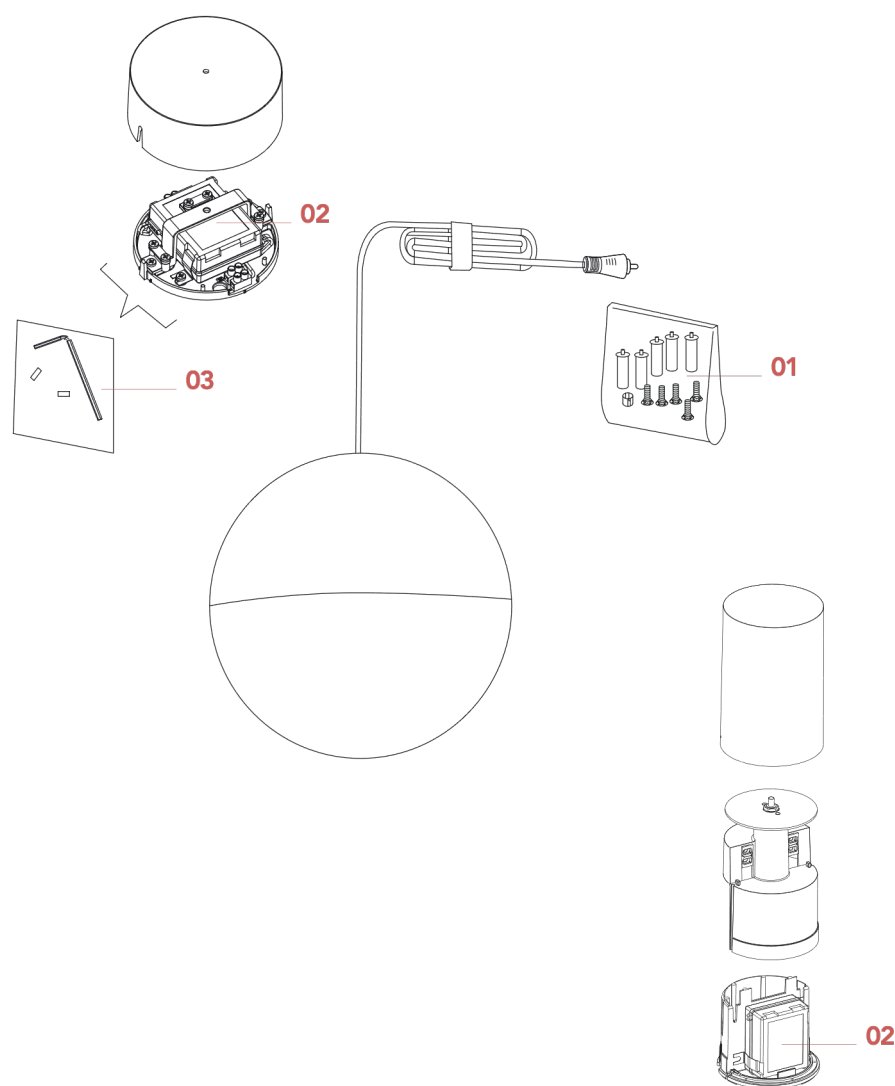

- 01. RF6480109 – Kit with white hooks and white cable clamps
- 02. RF22934 – Power supply unit for LED
- 03. RF6480200 – Kit with allen key and screws for ceiling rose assembly

STRING LIGHT SPHERE 12 mt APP CONTROL

F6488009

EN

RF6480109

KIT WITH WHITE HOOKS AND WHITE CABLE CLAMPS

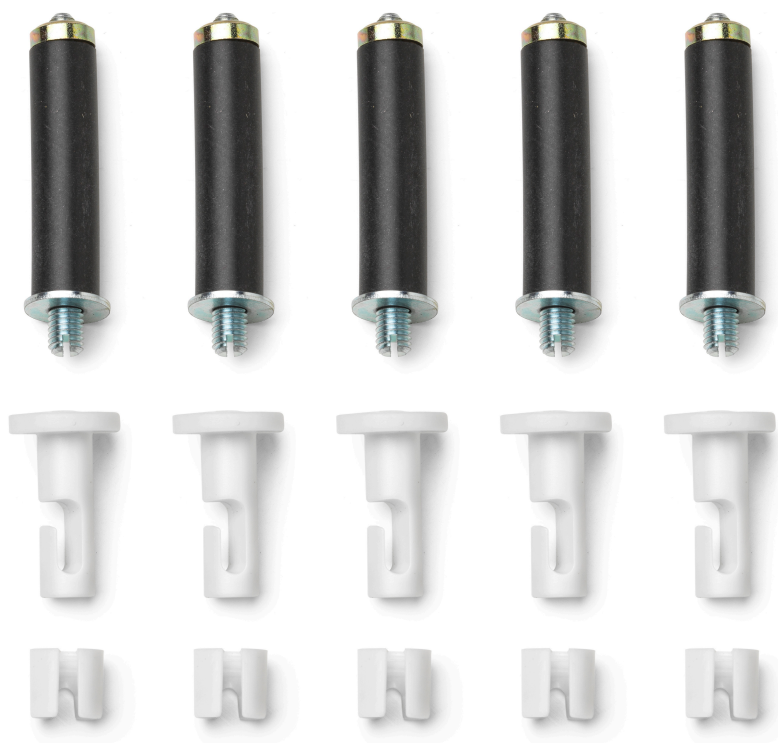

All String Light
Cone Versions



All String Light
Sphere Versions

WARNING! When installing and whenever acting on the appliance, ensure that the power supply has been switched off. For the installation of the spare-part, it is necessary to consult a qualified electrician.

STRING LIGHT SPHERE 12 mt APP CONTROL

F6488009

EN

RF6480109

KIT WITH WHITE HOOKS AND WHITE CABLE CLAMPS

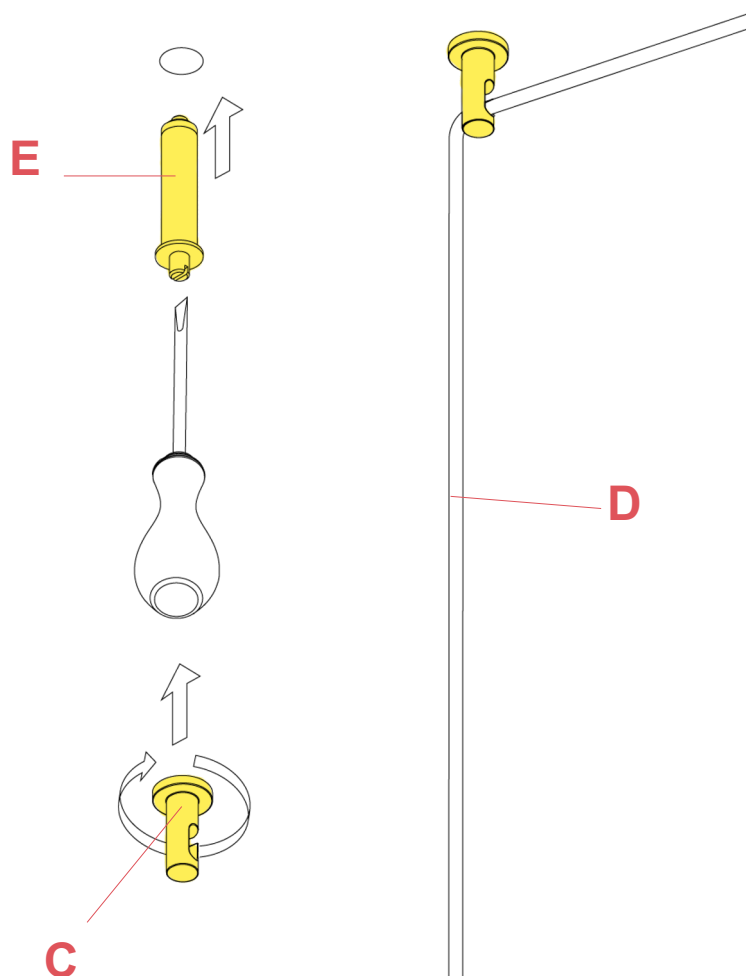

Fig.1

HOOK INSTALLATION

Drill a hole in the wall/ceiling and insert the anchor screw (E). Screw in with a flat headed screwdriver and then screw the hook (C) onto the protruding pin of the anchor screw. Lay the cable (D) so that it is sitting in the hook. **NOTE:** Select and employ screw anchor which is suited to the surface where the appliance is to be installed.

CABLE CLAMP INSTALLATION

The cable clamp system is normally utilized for the floor String Light version and is collocated in proximity of the pedal switch.

Drill a hole in the wall/ceiling and insert the anchor screw (E). Screw in with a flat headed screwdriver and then screw the hook (C) onto the protruding pin of the anchor screw.

NOTE: Select and employ screw anchor which is suited to the surface where the appliance is to be installed.

WARNING! When installing and whenever acting on the appliance, ensure that the power supply has been switched off. For the installation of the spare-part, it is necessary to consult a qualified electrician.

STRING LIGHT SPHERE 12 mt APP CONTROL

F6488009

RF6480109

KIT WITH WHITE HOOKS AND WHITE CABLE CLAMPS

EN

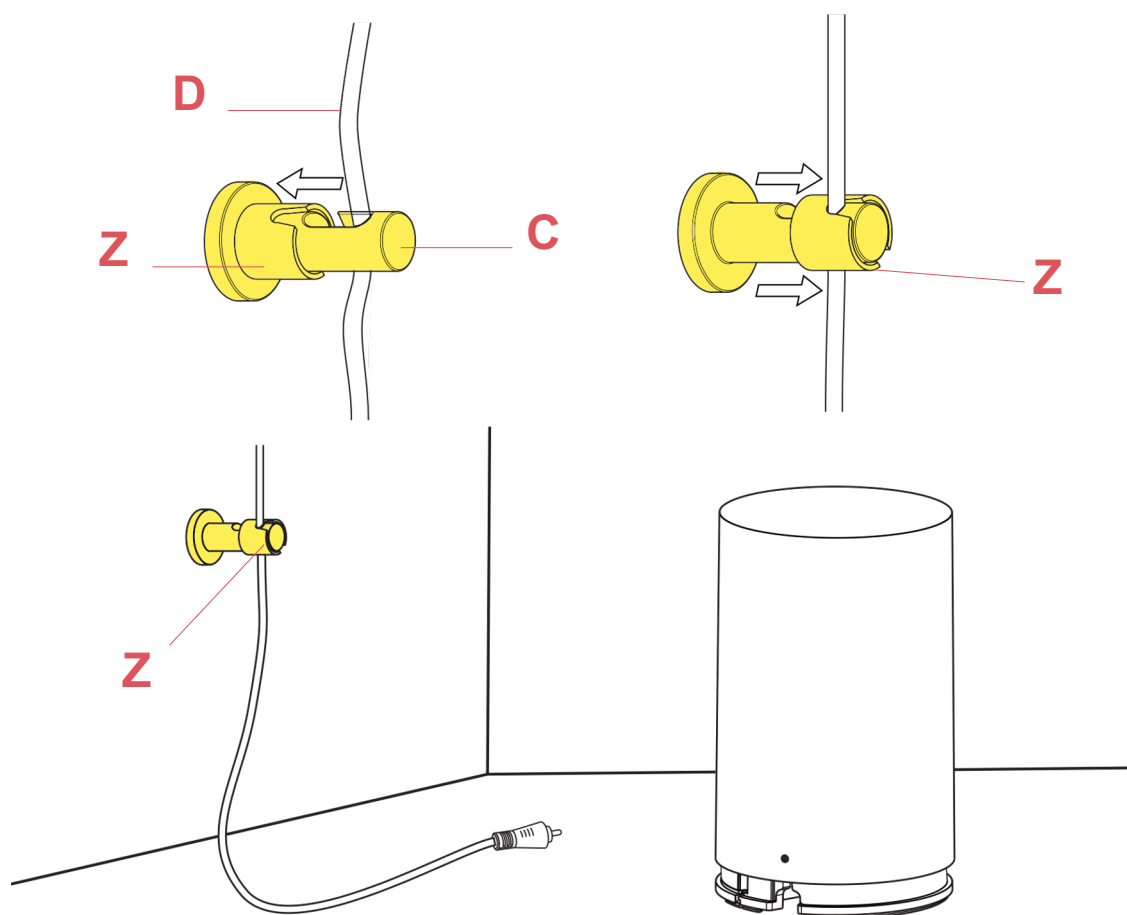

Fig.2

Fit the lock (Z) firmly on the hook (C). Introduce the cable (D) along to the last hook (C) before the floor switch, then lock the cable in position by pulling forward cable clamp (Z).

WARNING! When installing and whenever acting on the appliance, ensure that the power supply has been switched off. For the installation of the spare-part, it is necessary to consult a qualified electrician.

STRING LIGHT SPHERE 12 mt APP CONTROL

F6488009

RF22934

POWER SUPPLY UNIT FOR LED

EN



All String Light
Cone Versions



All String Light
Sphere Versions

WARNING! When installing and whenever acting on the appliance, ensure that the power supply has been switched off. For the installation of the spare-part, it is necessary to consult a qualified electrician.

STRING LIGHT SPHERE 12 mt APP CONTROL

F6488009

RF22934

POWER SUPPLY UNIT FOR LED

EN

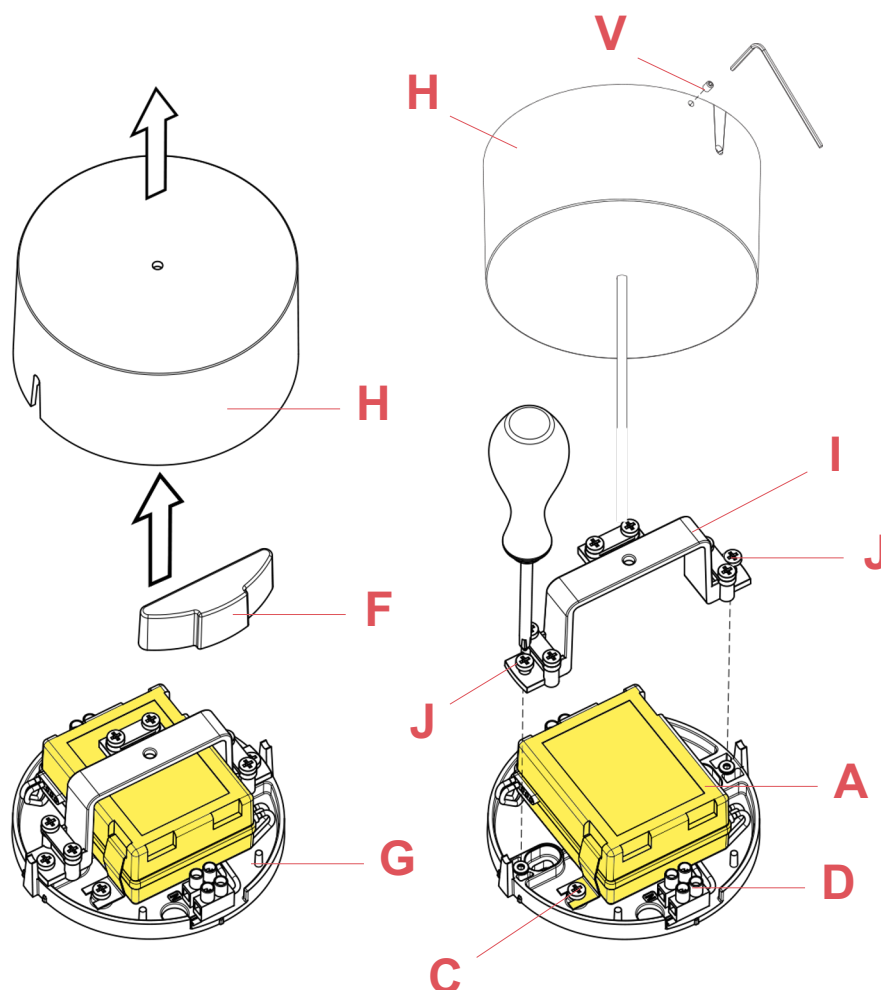

Fig.1

Unfasten the screws (V), remove the rose (H) from the ceiling/wall attachment (G) and the cover (F) from its housing so that you uncover the terminal block where the main cables are. Then unfasten the two screws (J) from the support (I) in a way to have access to replace the power supply unit.

Disconnect the wires from the terminals (D): primary and secondary, unfasten the fixing screw (C) and remove the power supply unit (A).

Proceed in replacing the power supply unit.

WARNING! When installing and whenever acting on the appliance, ensure that the power supply has been switched off. For the installation of the spare-part, it is necessary to consult a qualified electrician.

STRING LIGHT SPHERE 12 mt APP CONTROL

F6488009

RF22934

POWER SUPPLY UNIT FOR LED

EN

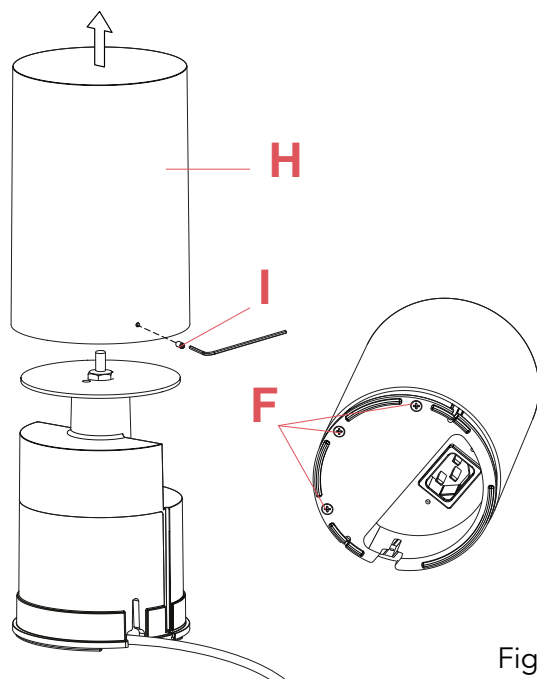

Fig.2

Remove the cover (H) by unfastening the screw (I). Turn upside-down the pedal switch and unfasten the 3 screws (F).

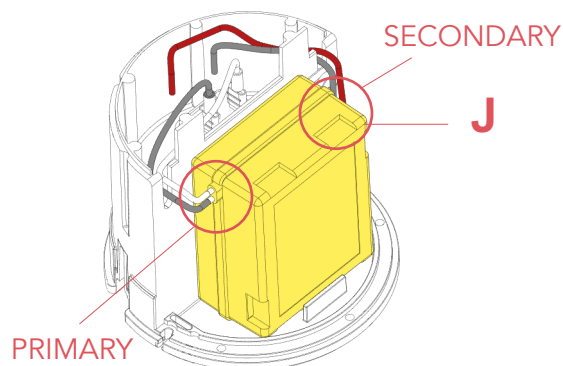
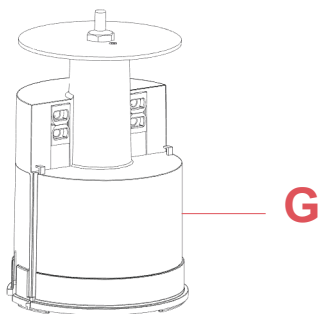

Fig.3

Remove the housing (G). Cut the primary (white & Black) and secondary (Red & Black) wires near the damaged power supply unit (J). Refer to the two circles in the image on the left hand side.
Remove the damaged power supply unit.

WARNING! When installing and whenever acting on the appliance, ensure that the power supply has been switched off.
For the installation of the spare-part, it is necessary to consult a qualified electrician.

STRING LIGHT SPHERE 12 mt APP CONTROL

F6488009

RF22934

POWER SUPPLY UNIT FOR LED

EN

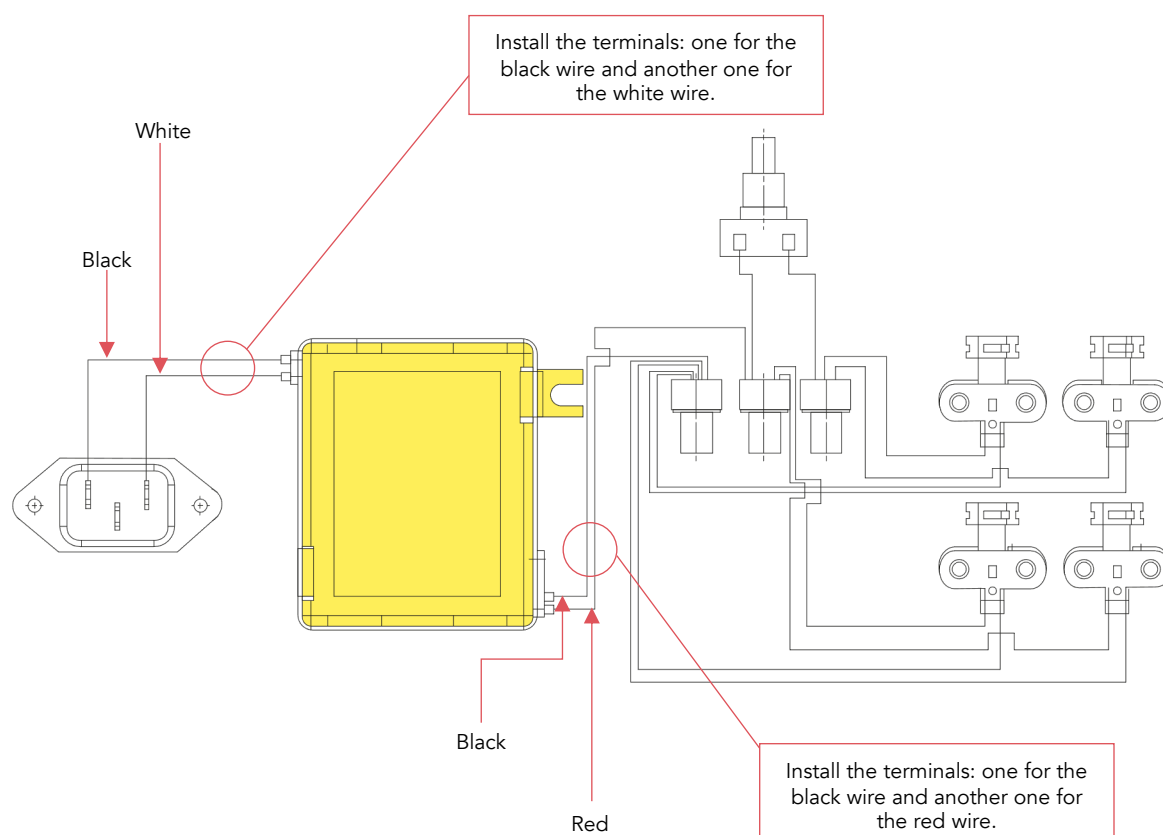

Fig.4

Assemble now the new spare-part:

Strip the wires. Connect the wires primary and secondary of the power unit to the wires of the old power supply unit. Connect them by utilizing terminals (not supplied with the spare-part). Please refer to the electrical connection drawing above.

Collocate the housing (G) back in a way that covers the power supply (J). (fig.3 page 11)

Fasten back the 3 screws (F) (fig.2 page 11)

WARNING! When installing and whenever acting on the appliance, ensure that the power supply has been switched off. For the installation of the spare-part, it is necessary to consult a qualified electrician.

STRING LIGHT SPHERE 12 mt APP CONTROL

F6488009

RF22934

POWER SUPPLY UNIT FOR LED

EN

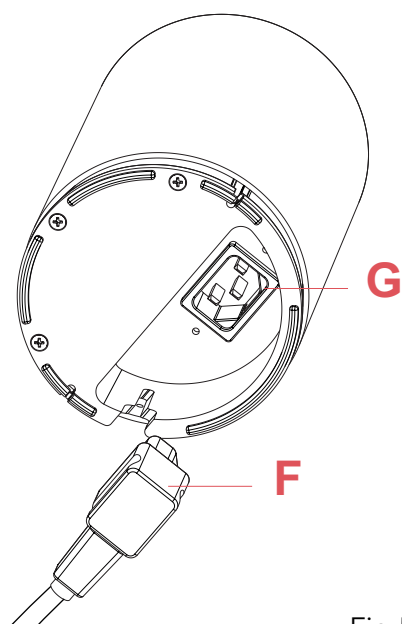

Fig.5

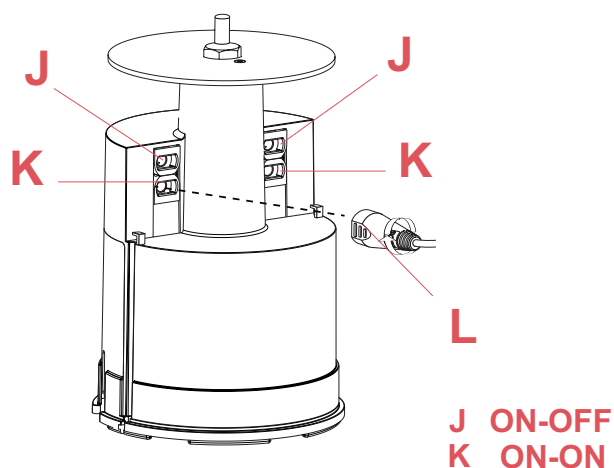

Fig.6

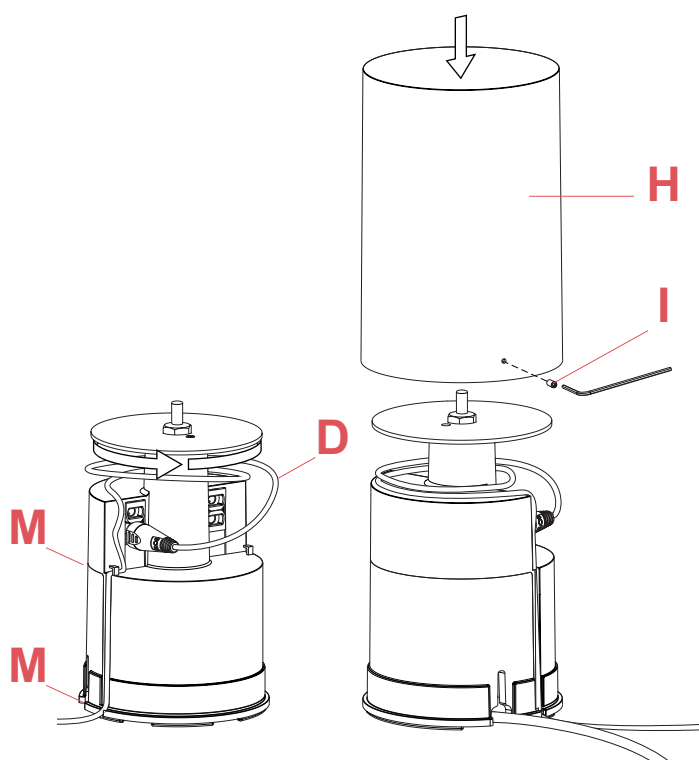

Fig.7

Insert the plug (F) into the socket (G) on the base.

Insert the coaxial connector (L) of the cable into the appropriate sockets (J-K) according to the desired function.

NOTE: The upper sockets (J) are used to control the device with "floor switch", the lower sockets (K) prevent you being able to turn off the device with "floor switch".

Wrap up the excess cable (D). Insert the part of the cable, that need to be inserted the channel and hooks (M). Position the cover (H) and fasten the grub screw (I).

WARNING! When installing and whenever acting on the appliance, ensure that the power supply has been switched off. For the installation of the spare-part, it is necessary to consult a qualified electrician.

STRING LIGHT SPHERE 12 mt APP CONTROL

F6488009

EN

RF6480200

KIT WITH ALLEN KEY AND SCREWS FOR CEILING ROSE ASSEMBLY



All String Light
Cone Versions



All String Light
Sphere Versions

WARNING! When installing and whenever acting on the appliance, ensure that the power supply has been switched off.
For the installation of the spare-part, it is necessary to consult a qualified electrician.

STRING LIGHT SPHERE 12 mt APP CONTROL

F6488009

EN

RF6480200

KIT WITH ALLEN KEY AND SCREWS FOR CEILING ROSE ASSEMBLY

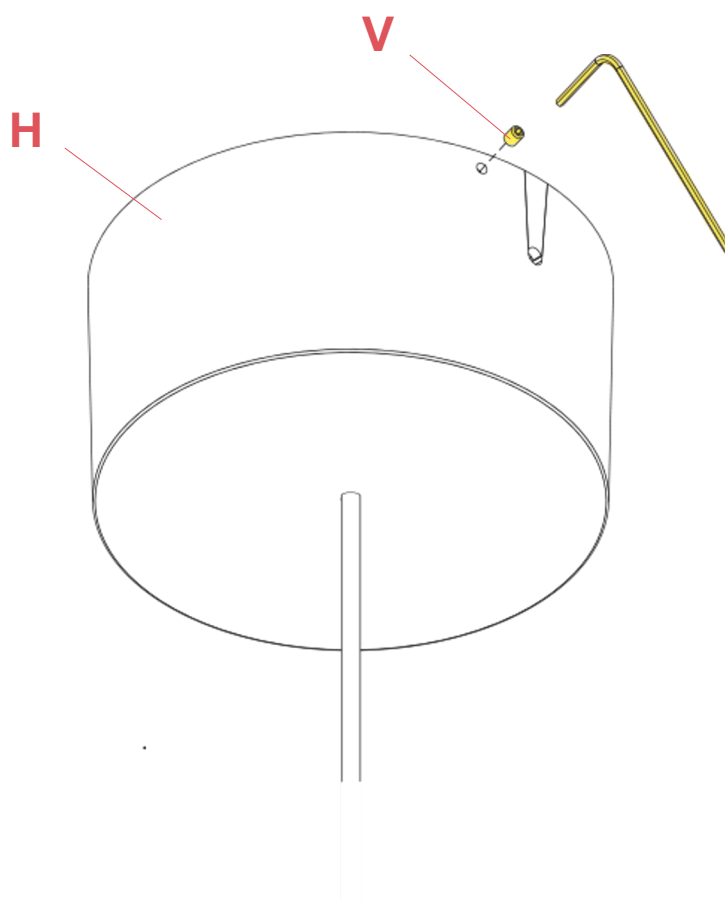

Fig.1

Place the ceiling rose (H) and fasten the screws (U) by utilizing the Allen key.

WARNING! When installing and whenever acting on the appliance, ensure that the power supply has been switched off.
For the installation of the spare-part, it is necessary to consult a qualified electrician.

©2021 Flos - All rights reserved - www.flos.com
Flos reserves the right to introduce any changes to its own models, without prior notice.