

# PARENTESI 50

Designed by Achille Castiglioni and Pio Manzù, 1971

F5601075

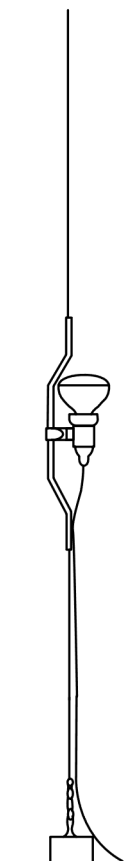

## PARENTESI 50

F5601075

EN

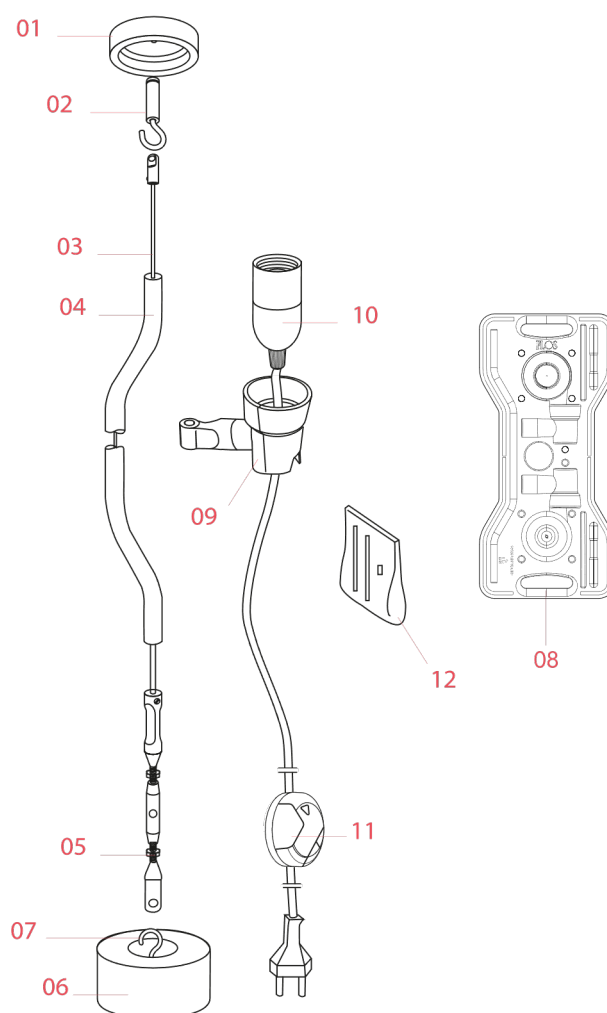

- 01. RF5601100 – Complete Orange signal rose
- 02. RF06745 – Open expansion hook
- 03. RF01442 – Steel cable 4 mt.
- 04. RF31332 – Orange signal tube
- 05. RF01438 – Turnbuckle with grub screw
- 06. RF5601200 – Complete Orange signal base
- 07. RF31358 – Hook + nut
- 08. RF5601500 – Blister Parentesi/D/50
- 09. RF06068 – Rubber support group
- 10. RF31753 – Electric wiring assembly Led rondò
- 11. RF28045 – Led 220/240V 40-250W 4-100W Rondò dimmer
- 12. RF5600200 – Kit with wire ties and screw

PARENTESI 50 F5601075

EN

## RF5601100

COMPLETE ORANGE SIGNAL ROSE



WARNING! When installing and whenever acting on the appliance, ensure that the power supply has been switched off.  
For the installation of the spare-part, it is necessary to consult a qualified electrician.

©2021 Flos - All rights reserved - [www.flos.com](http://www.flos.com)  
Flos reserves the right to introduce any changes to its own models, without prior notice.

PARENTESI 50 F5601075

EN

**RF5601100**

COMPLETE ORANGE SIGNAL ROSE

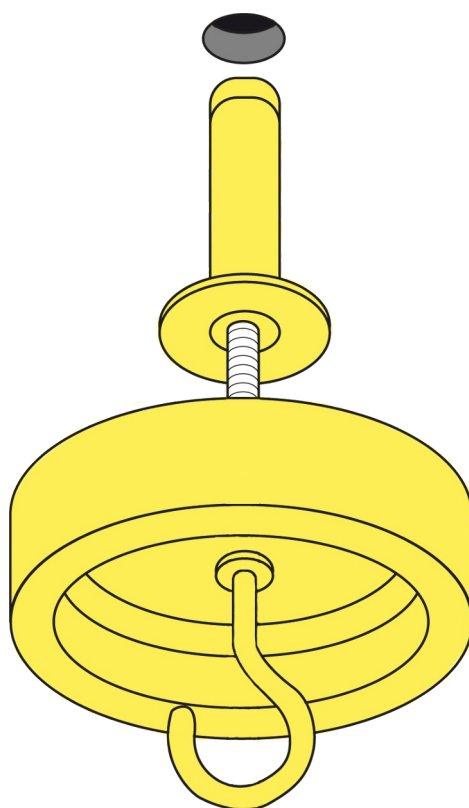

Fig.1

Unscrew hook from expansion bolt, pass the hook through ceiling rose.  
drill a hole in the ceiling and insert the expansion bolt with hook.  
Tighten the hook screw to fix the ceiling rose.

**REMARKS!** Select and employ screw plugs which are suited to the  
surface where the appliance is to be installed.



**PARENTESI 50** F5601075

**EN**

## RF06745

ANCHOR HOOK SCREW



Parentesi  
p.05



Parentesi D  
p.05



Parentesi  
50  
p.05

**WARNING!** When installing and whenever acting on the appliance, ensure that the power supply has been switched off.  
For the installation of the spare-part, it is necessary to consult a qualified electrician.

PARENTESI 50 F5601075

EN

## RF06745

ANCHOR HOOK SCREW

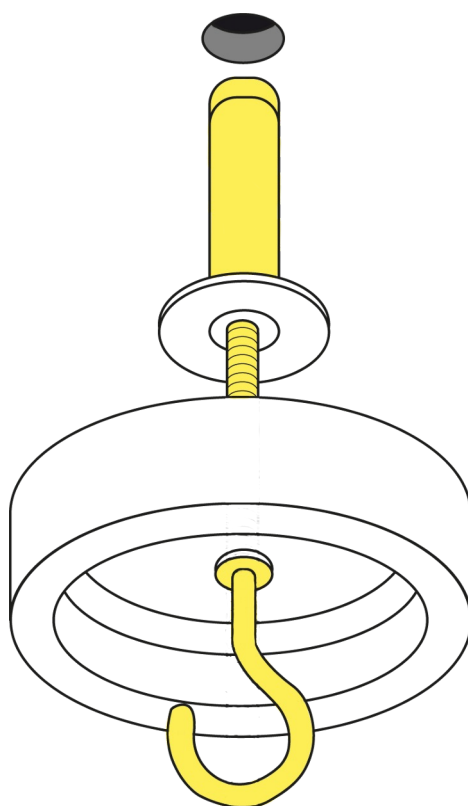

Fig.1

Unscrew hook from expansion bolt, pass the hook through ceiling rose.  
drill a hole in the ceiling and insert the expansion bolt with hook.  
Tighten the hook screw to fix the ceiling rose.

**REMARKS!** Select and employ screw plugs which are suited to the surface where the appliance is to be installed.

PARENTESI 50 F5601075

EN

## RF01442

STEEL CABLE 4 MT



Parentesi  
p.07



Parentesi D  
p.07



Parentesi  
50  
p.07

WARNING! When installing and whenever acting on the appliance, ensure that the power supply has been switched off. For the installation of the spare-part, it is necessary to consult a qualified electrician.

PARENTESI 50 F5601075

EN

**RF31332**

ORANGE SIGNAL TUBE



WARNING! When installing and whenever acting on the appliance, ensure that the power supply has been switched off.  
For the installation of the spare-part, it is necessary to consult a qualified electrician.

©2021 Flos - All rights reserved - [www.flos.com](http://www.flos.com)  
Flos reserves the right to introduce any changes to its own models, without prior notice.

PARENTESI 50 F5601075

EN

**RF31332**

ORANGE SIGNAL TUBE

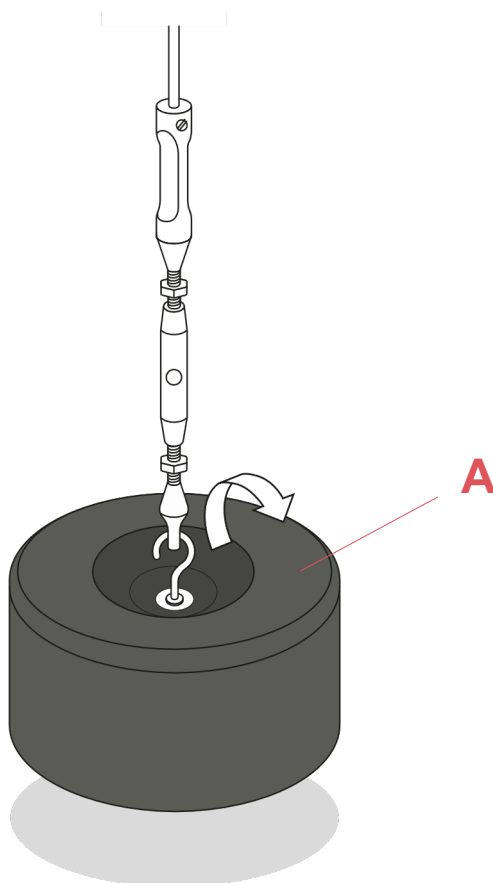

Fig.1

Unhook the counterweight (A) from the turnbuckle (B).  
**WARNING!** Lifting up the counterweight will cause mechanical tension loss of the suspension wire, causing the tube and lamp support to fall down.

WARNING! When installing and whenever acting on the appliance, ensure that the power supply has been switched off.  
For the installation of the spare-part, it is necessary to consult a qualified electrician.

PARENTESI 50 F5601075

EN

**RF31332**

ORANGE SIGNAL TUBE

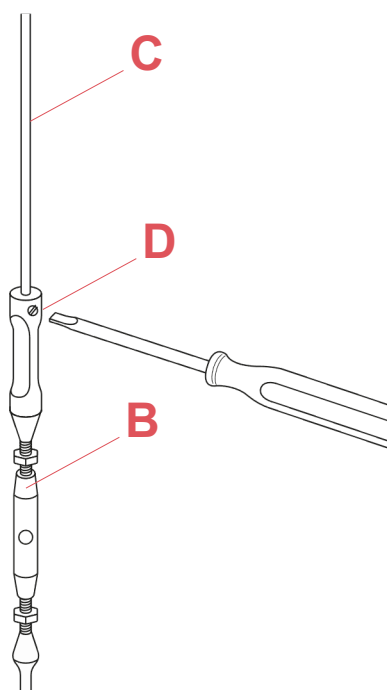

Fig.2

Remove the turnbuckle (B) from the suspension cable by unfastening the locking screw (C).

WARNING! When installing and whenever acting on the appliance, ensure that the power supply has been switched off. For the installation of the spare-part, it is necessary to consult a qualified electrician.

PARENTESI 50 F5601075

EN

## RF31332

ORANGE SIGNAL TUBE

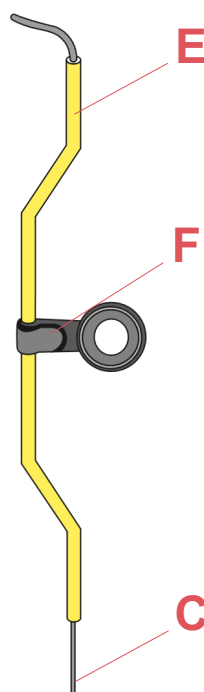

Fig.3

Slide off the suspension cable (C), the damaged Parentesi tube (E) and the rubber support (F).

Take off the rubber support (F) from the damage Parentesi tube (E).

Assemble now the new spare-part:

Slide the rubber support (F) through the new Parentesi tube (E).

Insert and slide the suspension cable (C) through the Parentesi tube (E).

Insert the end point of the steel suspension cable (C) into the upper hole of the turnbuckle (B) and then fasten the locking screw (D). (Fig.2 page 10)

Hook the turnbuckle (B) to the counterweight (A).

Regulate the turnbuckle (B) in a way that the counterweight (A) almost touches the floor and then fasten the locking bolts.

Verify that the suspension wire is perpendicular.

**WARNING!** Lifting up the counterweight will cause mechanical tension loss of the suspension wire, causing the tube and lamp support to fall down. (Fig.1 page 9)

WARNING! When installing and whenever acting on the appliance, ensure that the power supply has been switched off. For the installation of the spare-part, it is necessary to consult a qualified electrician.

PARENTESI 50 F5601075

EN

**RF31332**

ORANGE SIGNAL TUBE

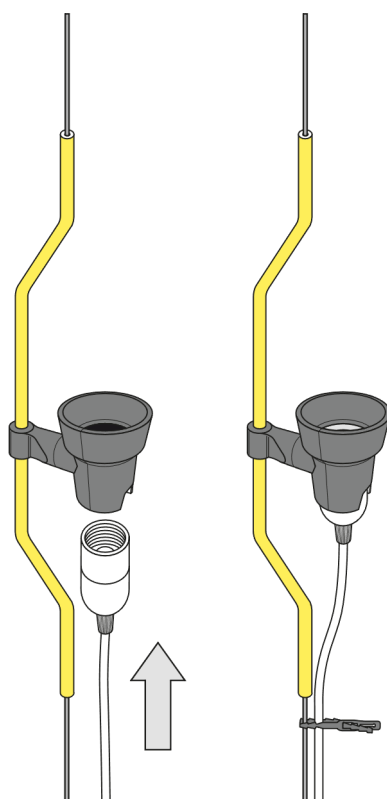

Fig.4

Pass through the hard rubber support the lamp holder push it to the limit of the cooling fins.

**WARNING!** Whilst installing the lamp-bulb ensure that the lamp bulb neck, sticks out from the rubber support. The bulb of the lamp must not be attached to the rubber support.



PARENTESI 50 F5601075

EN

## RF01438

TURNBUCKLE WITH GRUB SCREW



Parentesi  
p.14



Parentesi D  
p.14



Parentesi  
50  
p.13

WARNING! When installing and whenever acting on the appliance, ensure that the power supply has been switched off.  
For the installation of the spare-part, it is necessary to consult a qualified electrician.

©2021 Flos - All rights reserved - [www.flos.com](http://www.flos.com)  
Flos reserves the right to introduce any changes to its own models, without prior notice.

PARENTESI 50 F5601075

EN

**RF01438**

TURNBUCKLE WITH GRUB SCREW

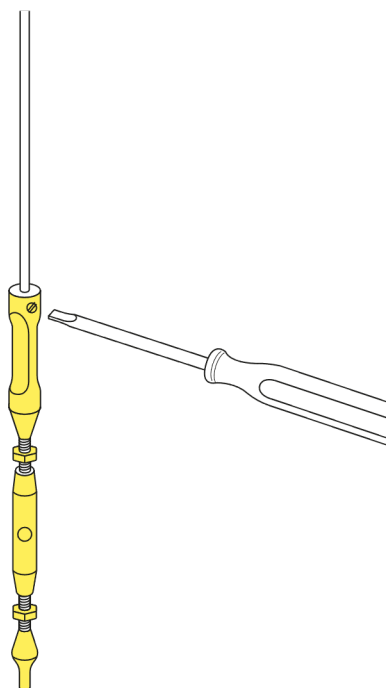

Fig.1

Insert the end point of the steel cable into the upper hole of the turnbuckle and then fasten the locking screw.

WARNING! When installing and whenever acting on the appliance, ensure that the power supply has been switched off.  
For the installation of the spare-part, it is necessary to consult a qualified electrician.

PARENTESI 50 F5601075

EN

## RF01438

TURNBUCKLE WITH GRUB SCREW

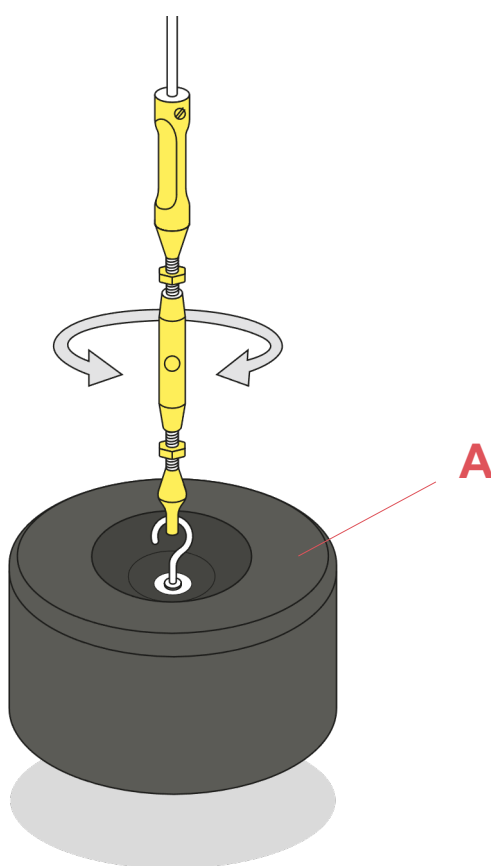

Fig.2

Hook the turnbuckle to the counterweight (A).  
Regulate the turnbuckle in a way that the counterweight (A) almost touches the floor and then fasten the locking bolts.  
Verify that the suspension wire is perpendicular.

**WARNING!** Lifting up the counterweight will cause mechanical tension loss of the suspension wire, causing the tube and lamp support to fall down.

PARENTESI 50 F5601075

EN

**RF5601200**

COMPLETE ORANGE SIGNAL BASE



WARNING! When installing and whenever acting on the appliance, ensure that the power supply has been switched off.  
For the installation of the spare-part, it is necessary to consult a qualified electrician.

©2021 Flos - All rights reserved - [www.flos.com](http://www.flos.com)  
Flos reserves the right to introduce any changes to its own models, without prior notice.

PARENTESI 50 F5601075

EN

## RF5601200

COMPLETE ORANGE SIGNAL BASE

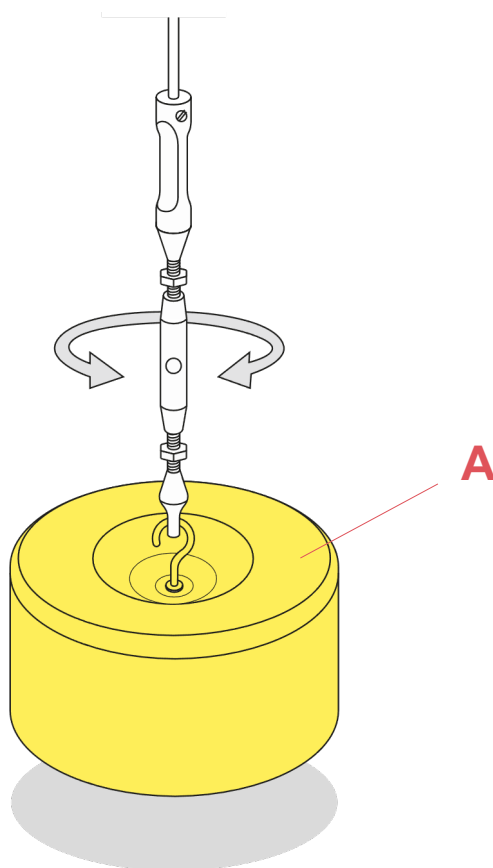

Fig.2

Hook the turnbuckle to the counterweight (A).  
Regulate the turnbuckle in a way that the counterweight (A) almost touches the floor and then fasten the locking bolts.  
Verify that the suspension wire is perpendicular.

**WARNING!** Lifting up the counterweight will cause mechanical tension loss of the suspension wire, causing the tube and lamp support to fall down.

WARNING! When installing and whenever acting on the appliance, ensure that the power supply has been switched off.  
For the installation of the spare-part, it is necessary to consult a qualified electrician.

©2021 Flos - All rights reserved - [www.flos.com](http://www.flos.com)  
Flos reserves the right to introduce any changes to its own models, without prior notice.

PARENTESI 50 F5601075

EN

## RF31358

HOOK + NUT

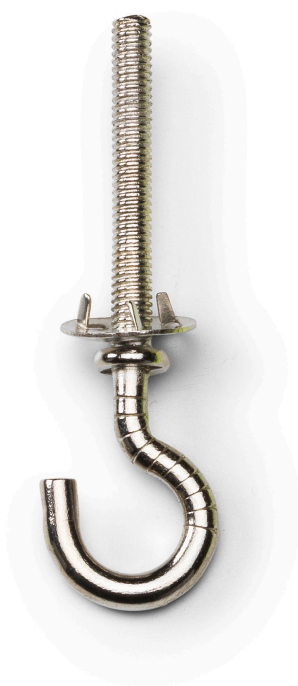

WARNING! When installing and whenever acting on the appliance, ensure that the power supply has been switched off.  
For the installation of the spare-part, it is necessary to consult a qualified electrician.

©2021 Flos - All rights reserved - [www.flos.com](http://www.flos.com)  
Flos reserves the right to introduce any changes to its own models, without prior notice.

PARENTESI 50 F5601075

EN

**RF31358**

HOOK + NUT



Fig.1



Fig.2

Remove the pad (B) from underneath the counterweight (A).

WARNING! When installing and whenever acting on the appliance, ensure that the power supply has been switched off. For the installation of the spare-part, it is necessary to consult a qualified electrician.

©2021 Flos - All rights reserved - [www.flos.com](http://www.flos.com)  
Flos reserves the right to introduce any changes to its own models, without prior notice.

PARENTESI 50 F5601075

EN

## RF31358

HOOK + NUT

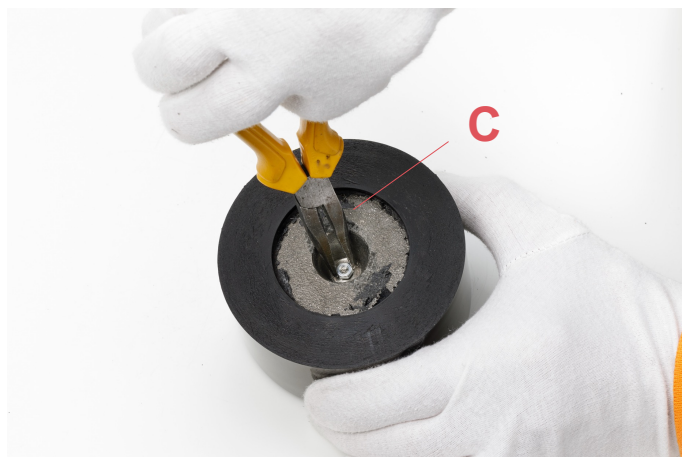

Fig.3



Fig.4



Fig.5

By utilizing a pair of pliers (C), unfasten the nut (D).

Remove the damage hook (E) from the counterweight (A).

**WARNING!** When installing and whenever acting on the appliance, ensure that the power supply has been switched off. For the installation of the spare-part, it is necessary to consult a qualified electrician.

©2021 Flos - All rights reserved - [www.flos.com](http://www.flos.com)  
Flos reserves the right to introduce any changes to its own models, without prior notice.



PARENTESI 50 F5601075

EN

## RF31358

HOOK + NUT

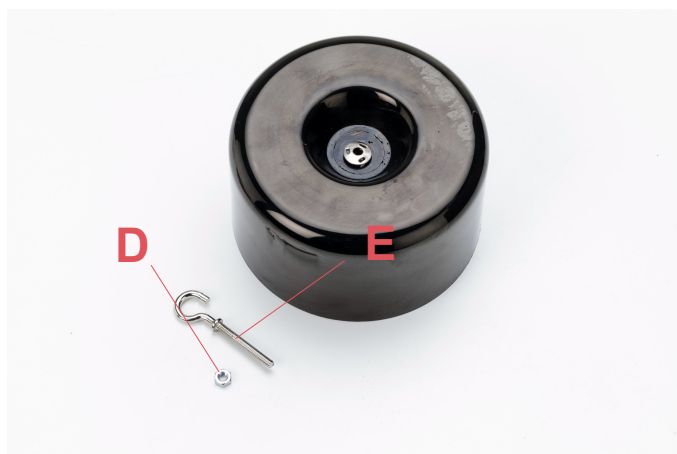

Fig.6



Fig.7

Assemble now the new spare-part:

Verify on the new spare part that the nut (D) is unfastened from the hook (E).  
Insert the hook (E) through the counterweight (A).

**WARNING!** When installing and whenever acting on the appliance, ensure that the power supply has been switched off.  
For the installation of the spare-part, it is necessary to consult a qualified electrician.

©2021 Flos - All rights reserved - [www.flos.com](http://www.flos.com)  
Flos reserves the right to introduce any changes to its own models, without prior notice.

PARENTESI 50 F5601075

EN

## RF31358

HOOK + NUT



Fig.8



Fig.9

Fasten the nut (D) by utilizing the pliers (C).  
Glue the pad (B) and onto the counterweight (A).

**WARNING!** When installing and whenever acting on the appliance, ensure that the power supply has been switched off.  
For the installation of the spare-part, it is necessary to consult a qualified electrician.

©2021 Flos - All rights reserved - [www.flos.com](http://www.flos.com)  
Flos reserves the right to introduce any changes to its own models, without prior notice.

PARENTESI 50 F5601075

EN

**RF31358**

HOOK + NUT

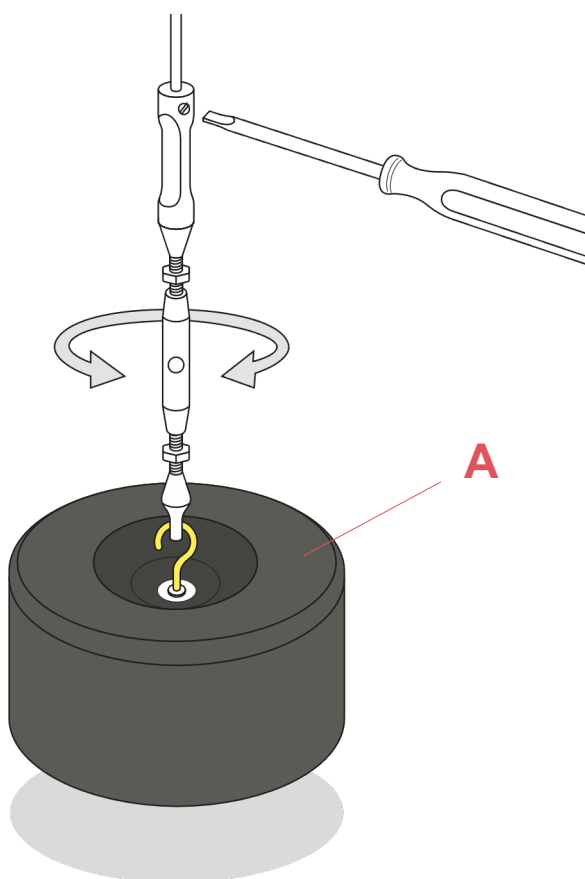

Fig.10

Hook the turnbuckle to the counterweight (A).

Regulate the turnbuckle in a way that the counterweight almost touches the floor and then fasten the locking bolts.

Verify that the suspension wire is perpendicular.

**WARNING!** Lifting up the counterweight will cause mechanical tension loss of the suspension wire, causing the tube and lamp support to fall down.

**PARENTESI 50** F5601075

**EN**

## **RF5601500**

BLISTER PARENTESI D/50

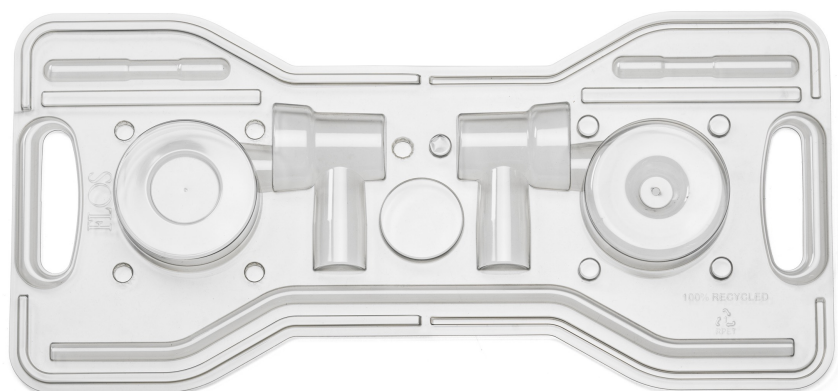

**WARNING!** When installing and whenever acting on the appliance, ensure that the power supply has been switched off.  
For the installation of the spare-part, it is necessary to consult a qualified electrician.

©2021 Flos - All rights reserved - [www.flos.com](http://www.flos.com)

Flos reserves the right to introduce any changes to its own models, without prior notice.

**PARENTESI 50** F5601075

**EN**

## RF06068

RUBBER SUPPORT



Parentesi  
p.27



Parentesi D  
p.25



Parentesi  
50  
p.25

**WARNING!** When installing and whenever acting on the appliance, ensure that the power supply has been switched off. For the installation of the spare-part, it is necessary to consult a qualified electrician.

©2021 Flos - All rights reserved - [www.flos.com](http://www.flos.com)  
Flos reserves the right to introduce any changes to its own models, without prior notice.

PARENTESI 50 F5601075

EN

**RF06068**

RUBBER SUPPORT

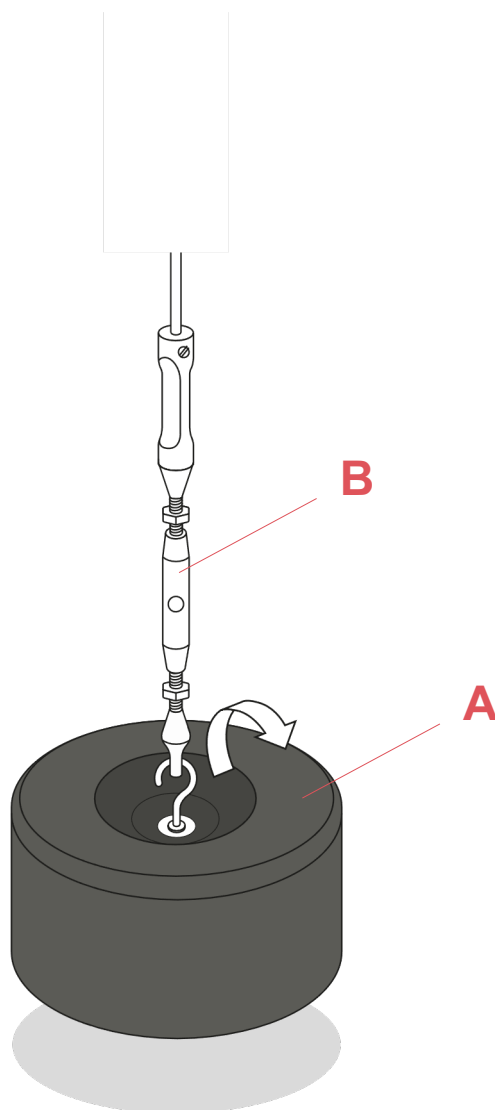

Fig.1

Unhook the counterweight (A) from the turnbuckle (B).  
**WARNING!** Lifting up the counterweight will cause mechanical tension loss of the suspension wire, causing the tube and lamp support to fall down.

WARNING! When installing and whenever acting on the appliance, ensure that the power supply has been switched off.  
For the installation of the spare-part, it is necessary to consult a qualified electrician.

PARENTESI 50 F5601075

EN

**RF06068**

RUBBER SUPPORT

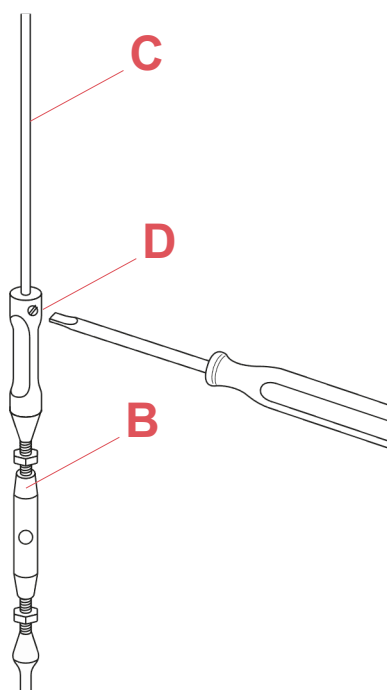

Fig.2

Remove the turnbuckle (B) from the suspension cable by unfastening the locking screw (C).

WARNING! When installing and whenever acting on the appliance, ensure that the power supply has been switched off. For the installation of the spare-part, it is necessary to consult a qualified electrician.

PARENTESI 50 F5601075

EN

**RF06068**

RUBBER SUPPORT

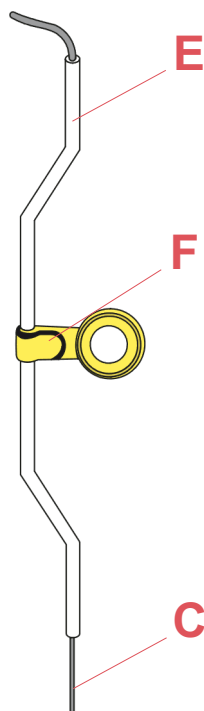

Fig.3

Slide off the suspension cable (C), the damaged Parentesi tube (E) and the rubber support (F).

Take off the rubber support (F) from the damage Parentesi tube (E).

Assemble now the new spare-part:

Slide the rubber support (F) through the new Parentesi tube (E).

Insert and slide the suspension cable (C) through the Parentesi tube (E).

Insert the end point of the steel suspension cable (C) into the upper hole of the turnbuckle (B) and then fasten the locking screw (D). (Fig.2 page 27)

Hook the turnbuckle (B) to the counterweight (A).

Regulate the turnbuckle (B) in a way that the counterweight (A) almost touches the floor and then fasten the locking bolts.

Verify that the suspension wire is perpendicular.

**WARNING!** Lifting up the counterweight will cause mechanical tension loss of the suspension wire, causing the tube and lamp support to fall down. (Fig.1 page 26)

WARNING! When installing and whenever acting on the appliance, ensure that the power supply has been switched off.  
For the installation of the spare-part, it is necessary to consult a qualified electrician.



PARENTESI 50 F5601075

EN

**RF06068**

RUBBER SUPPORT

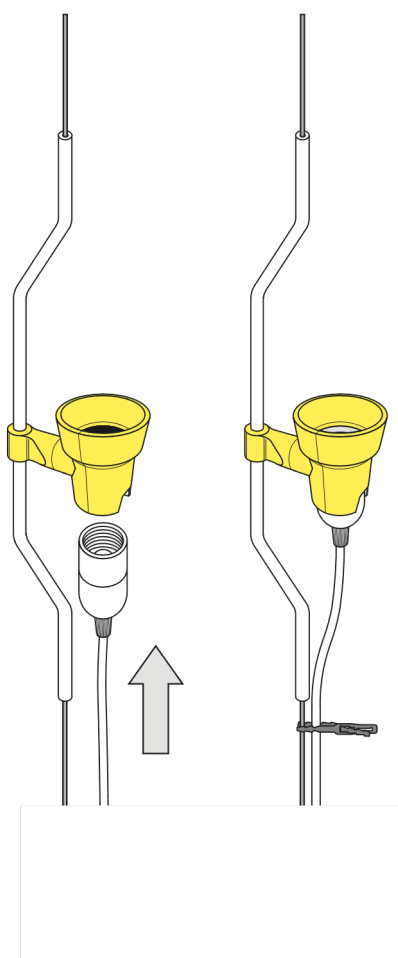

Fig.4

Pass through the hard rubber support the lamp holder push it to the limit of the cooling fins.

**WARNING!** Whilst installing the lamp-bulb ensure that the lamp bulb neck, sticks out from the rubber support. The bulb of the lamp must not be attached to the rubber support.

WARNING! When installing and whenever acting on the appliance, ensure that the power supply has been switched off. For the installation of the spare-part, it is necessary to consult a qualified electrician.

PARENTESI 50 F5601075

EN

## RF31753

ELECTRIC WIRING ASSEMBLY WITH LED RONDÒ DIMMER



Parentesi D  
p.30



Parentesi  
50  
p.30

WARNING! When installing and whenever acting on the appliance, ensure that the power supply has been switched off. For the installation of the spare-part, it is necessary to consult a qualified electrician.

PARENTESI 50 F5601075

EN

**RF31753**

ELECTRIC WIRING ASSEMBLY WITH LED RONDÒ DIMMER

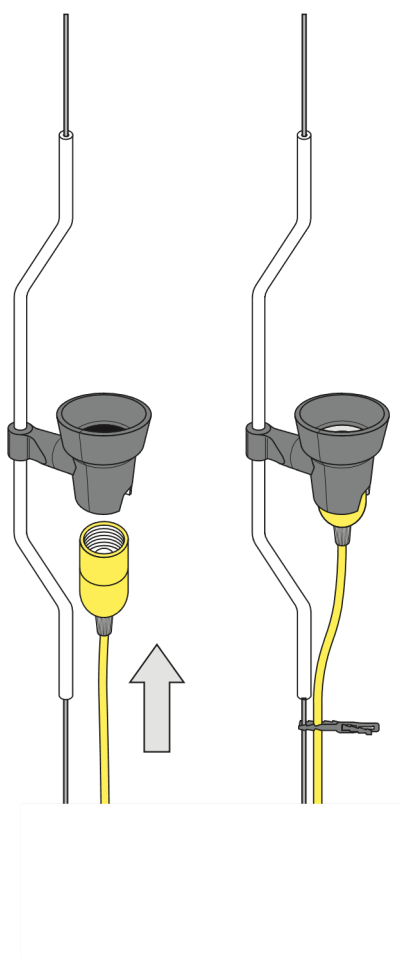

Fig.1

Pass through the hard rubber support the lamp holder push it to the limit of the cooling fins.

**WARNING!** Whilst installing the lamp-bulb ensure that the lamp bulb neck, sticks out from the rubber support. The bulb of the lamp must not be attached to the rubber support.

PARENTESI 50 F5601075

EN

## RF28045

LED 220/240V 40-250W 4-100W RONDÒ DIMMER



Bibliotheque  
Nationale  
p.05



Glo-ball  
F1  
p.05



Glo-ball  
F2  
p.05



Glo-ball  
F3  
p.05



Ic F1  
p.05



Ic F2  
p.05



Ktribe  
F2  
p.05



Ktribe  
F3  
p.05



Lounge  
Gun  
p.13

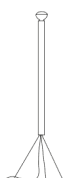

Luminator  
Dim  
p.05



Parentesi D  
p.32



Parentesi  
50  
p.32



Ray  
F1  
p.17



Ray F2  
p.17



Romeo  
Moon F  
p.44



Romeo  
Soft  
p.33



Spun  
Light F  
p.09



Toio  
Led  
p.38

WARNING! When installing and whenever acting on the appliance, ensure that the power supply has been switched off.  
For the installation of the spare-part, it is necessary to consult a qualified electrician.

PARENTESI 50 F5601075

EN

## RF28045

LED 220/240V 40-250W 4-100W RONDÒ DIMMER



Fig.1



Fig.2

Open the box of the damaged dimmer.

For the opening, it is necessary to remove the rubber pad from underneath the dimmer box;

Unfasten the screw that locks the triangle terminal cover;

**WARNING!** When installing and whenever acting on the appliance, ensure that the power supply has been switched off.  
For the installation of the spare-part, it is necessary to consult a qualified electrician.

©2021 Flos - All rights reserved - [www.flos.com](http://www.flos.com)  
Flos reserves the right to introduce any changes to its own models, without prior notice.

PARENTESI 50 F5601075

EN

## RF28045

LED 220/240V 40-250W 4-100W RONDÒ DIMMER



Fig.3

Turn the dimmer box and remove the terminal cover;



Fig.4

Unfasten the three screws of the cable clamps;

**WARNING!** When installing and whenever acting on the appliance, ensure that the power supply has been switched off.  
For the installation of the spare-part, it is necessary to consult a qualified electrician.

©2021 Flos - All rights reserved - [www.flos.com](http://www.flos.com)  
Flos reserves the right to introduce any changes to its own models, without prior notice.

PARENTESI 50 F5601075

EN

## RF28045

LED 220/240V 40-250W 4-100W RONDÒ DIMMER



Fig.5



Fig.6

Remove the cable clamp (refer to fig. 5) and disconnect the cables from the green terminal box.

Assemble now the new dimmer:  
Connect the cables respecting the polarities, lock the wires by positioning the cable clamp and then fasten the three screws, cover the green terminal box with the triangle cover, turn the dimmer box, fasten the screw and stick-on the rubber pads.

**WARNING!** When installing and whenever acting on the appliance, ensure that the power supply has been switched off.  
For the installation of the spare-part, it is necessary to consult a qualified electrician.

©2021 Flos - All rights reserved - [www.flos.com](http://www.flos.com)  
Flos reserves the right to introduce any changes to its own models, without prior notice.

PARENTESI 50 F5601075

EN

## RF5600200

KIT WIRE TIES AND SCREW



Parentesi  
p.32



Parentesi D  
p.36



Parentesi  
50  
p.36

WARNING! When installing and whenever acting on the appliance, ensure that the power supply has been switched off.  
For the installation of the spare-part, it is necessary to consult a qualified electrician.



PARENTESI 50 F5601075

EN

**RF5600200**

KIT WIRE TIES AND SCREW

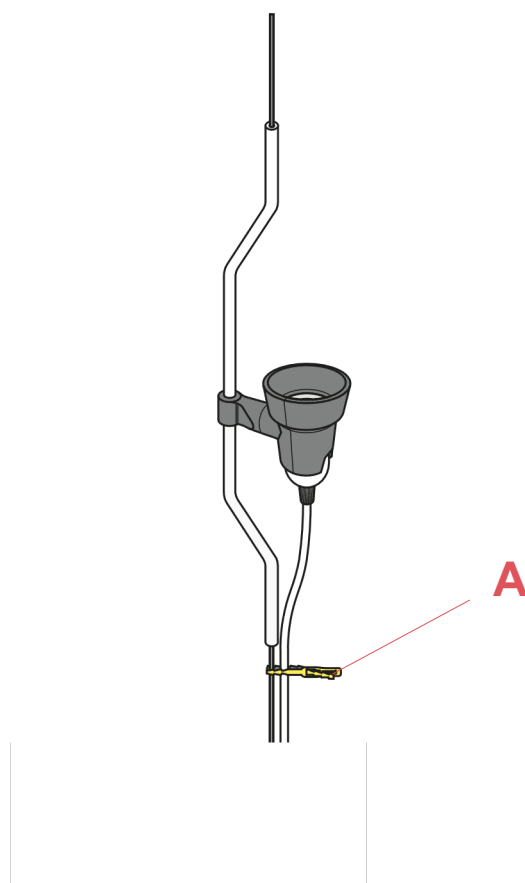

Fig.1

Install the wire tie (A) in a way that you keep together the electrical cable and tube.

WARNING! When installing and whenever acting on the appliance, ensure that the power supply has been switched off.  
For the installation of the spare-part, it is necessary to consult a qualified electrician.

PARENTESI 50 F5601075

EN

**RF5600200**

KIT WIRE TIES AND SCREW

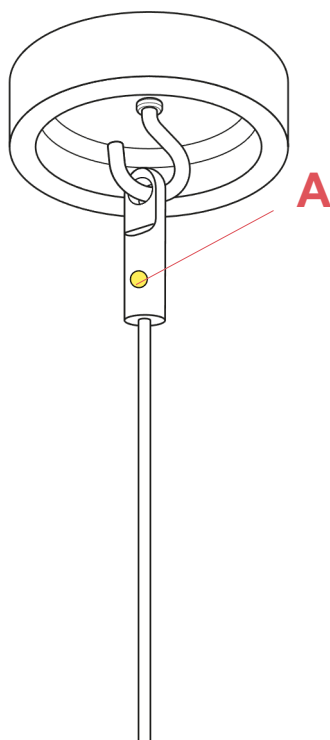

Fig.2

Fasten the screw (A) and slip the end of the steel cable on the hook.

WARNING! When installing and whenever acting on the appliance, ensure that the power supply has been switched off.  
For the installation of the spare-part, it is necessary to consult a qualified electrician.

©2021 Flos - All rights reserved - [www.flos.com](http://www.flos.com)  
Flos reserves the right to introduce any changes to its own models, without prior notice.