

POCHETTE LED UP/DOWN

Designed by Rodolfo Dordoni, 2003

F9705057



POCHETTE LED UP/DOWN

F9705057

EN

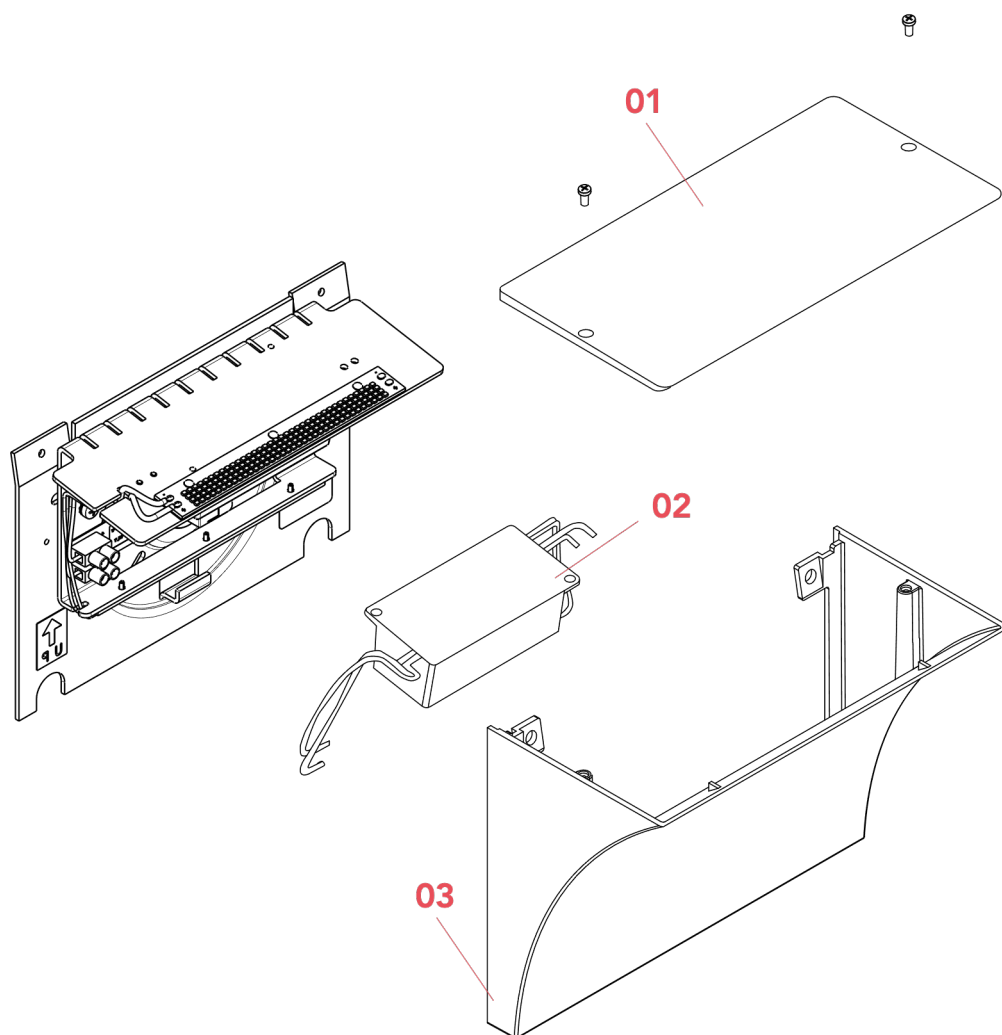

01. RF25606 – Up transparent diffuser

02. RF25062 – LED Power Supply

03. RF25617 – Chrome body

POCHETTE LED UP/DOWN
F9705057

EN

RF25606

UP TRANSPARENT DIFFUSER



Pochette
Led
p.03



Pochette
up-down
p.03

WARNING! When installing and whenever acting on the appliance, ensure that the power supply has been switched off.
For the installation of the spare-part, it is necessary to consult a qualified electrician.

©2021 Flos - All rights reserved - www.flos.com
Flos reserves the right to introduce any changes to its own models, without prior notice.

POCHETTE LED UP/DOWN
F9705057

EN

RF25606
UP TRANSPARENT DIFFUSER

Fig.1

Put the transparent diffuser on the holes of the lamp body and then screw the screws using an allen wrench.

WARNING! When installing and whenever acting on the appliance, ensure that the power supply has been switched off.
For the installation of the spare-part, it is necessary to consult a qualified electrician.

POCHETTE LED UP/DOWN
F9705057

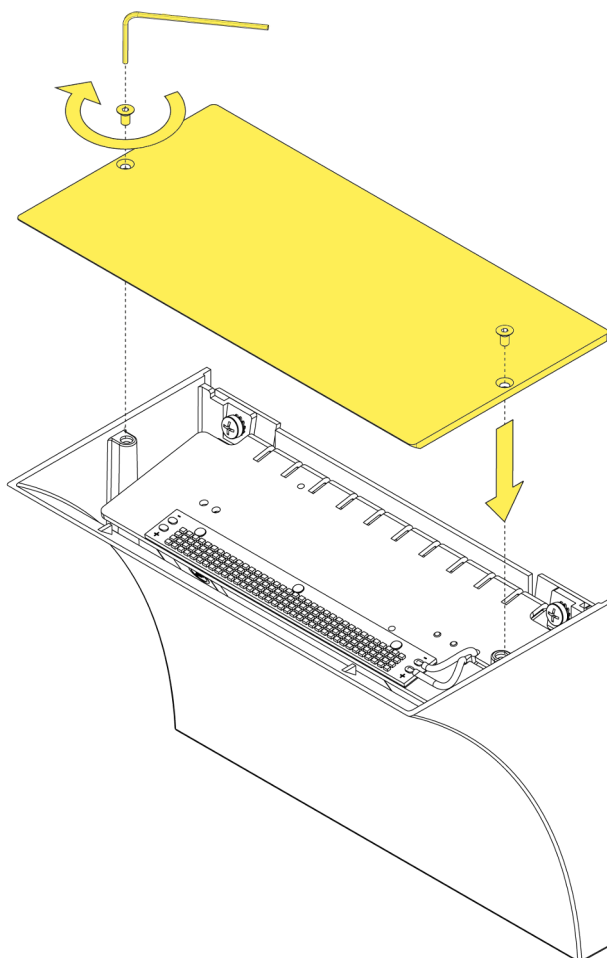
EN

RF25062
LED POWER SUPPLY

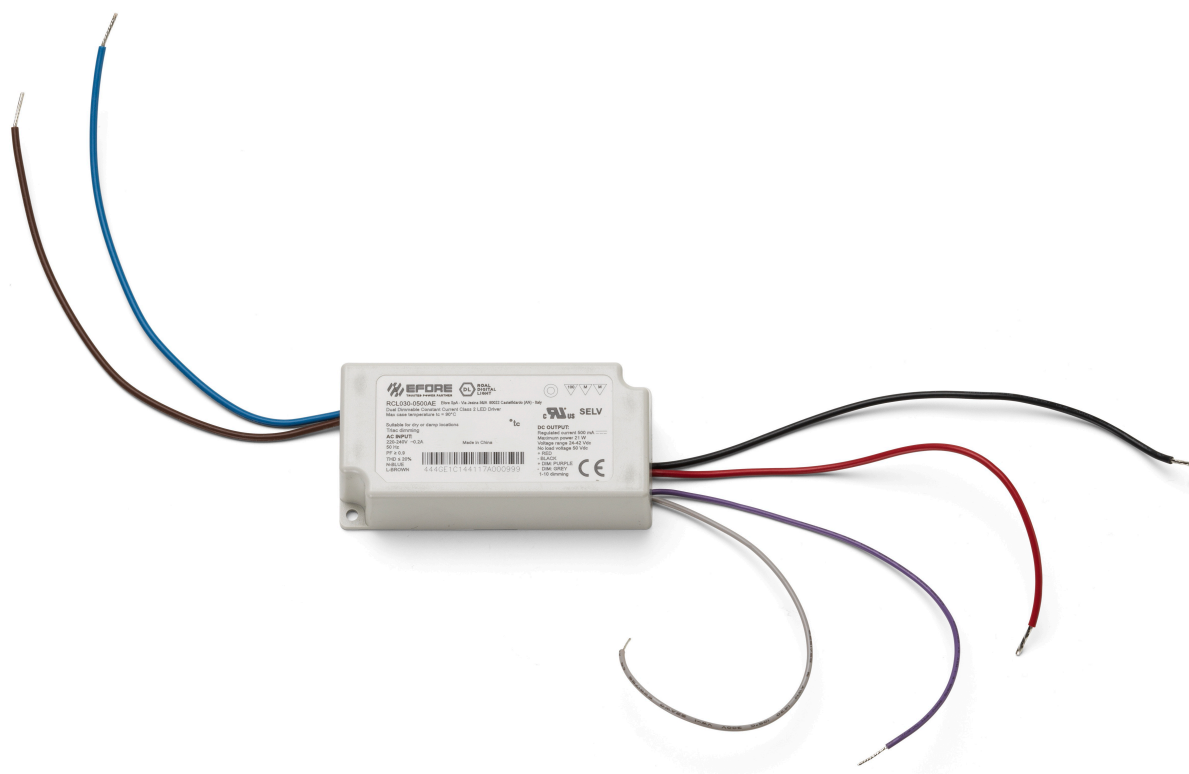

Pochette
Led
p.05



Pochette
up-down
p.05

WARNING! When installing and whenever acting on the appliance, ensure that the power supply has been switched off.
For the installation of the spare-part, it is necessary to consult a qualified electrician.

POCHETTE LED UP/DOWN
F9705057

EN

RF25617

CHROME LAMP BODY



WARNING! When installing and whenever acting on the appliance, ensure that the power supply has been switched off.
For the installation of the spare-part, it is necessary to consult a qualified electrician.

©2021 Flos - All rights reserved - www.flos.com
Flos reserves the right to introduce any changes to its own models, without prior notice.

POCHETTE LED UP/DOWN
F9705057

EN

RF25617
CHROME LAMP BODY

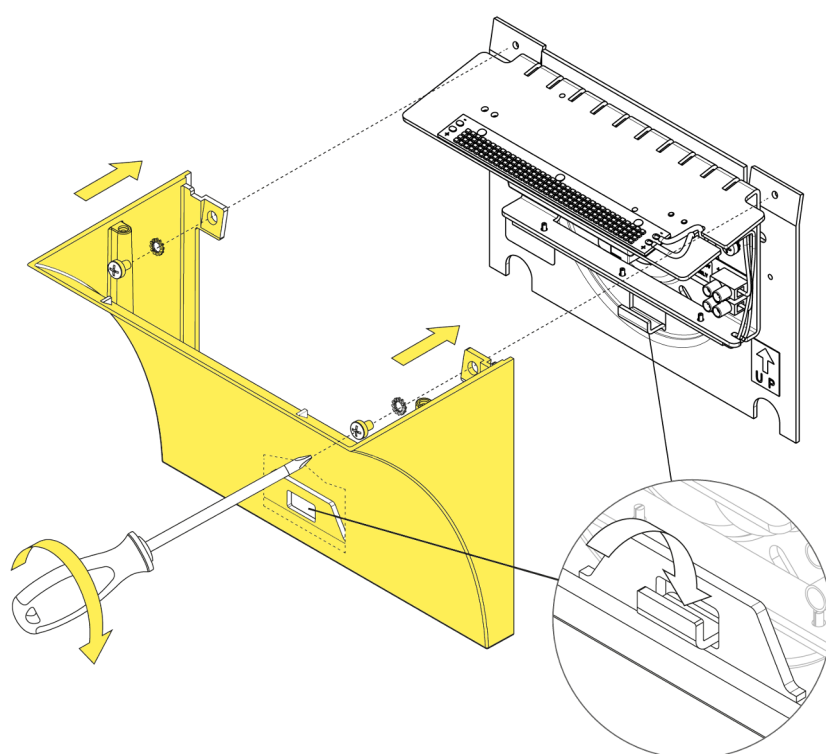

Fig.1

Install the lamp body (A) onto the wall attachment (C) and fasten the screws (B).

WARNING! When installing and whenever acting on the appliance, ensure that the power supply has been switched off. For the installation of the spare-part, it is necessary to consult a qualified electrician.