

SCINTILLA – WALL

Livio Castiglioni, Pietro Maria Castiglioni

The absolutely novel Scintilla system combines the essential versatility of a decorative lamp and a lighting capacity comparable to a technical system. The great success of this system persuaded the company to design a free-standing version in the early eighties, with the main structure fastened to the base and stem in metal.



SCINTILLA - WALL - CHROME, LARGE

SPECIFICHE TECNICHE

Material	Glass,Metal
Switching	Dimmerable
Emission	Diffused light
Total power	230W
Light source	R7s/115
Tension	110 V
IP	20

SKU

FP30050250CRNU

NOTES

Wall lamp with diffused and dimmable light. Chromed metal frame. The lamp is supplied with two different diffusers: one in clear borosilicate glass and the other in sandblasted borosilicate glass. Available separately a reflector made of anodized aluminum that produces indirect light. Bulb not included.

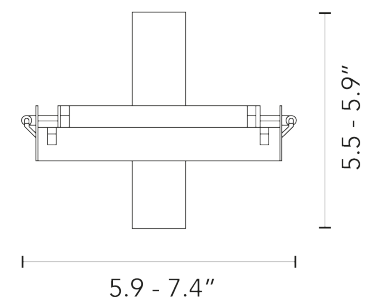

SCINTILLA - WALL - BRUSHED NICKEL, LARGE

SPECIFICHE TECNICHE

Material	Glass,Metal
Switching	Dimmerable
Emission	Diffused light
Total power	230W
Light source	R7s/115
Tension	110 V
IP	20

SKU

FP30050250CRNU

NOTES

Wall lamp with diffused and dimmable light. Chromed metal frame. The lamp is supplied with two different diffusers: one in clear borosilicate glass and the other in sandblasted borosilicate glass. Available separately a reflector made of anodized aluminum that produces indirect light. Bulb not included.

