

Slope Table

Assembly manual



ferm
L I V I N G

Box Content



1 x
Top board

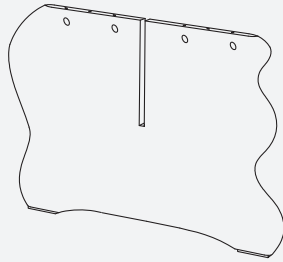

1 x
Leg

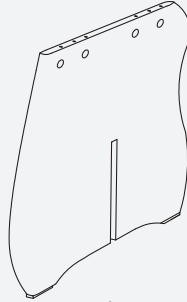

1 x
Leg



8 x
Screw



8 x
Connect cam



4 x
Dowel



8 x
Connect rod



2 x
Cross iron

Needed Tools



Phillips head screwdriver
(Not included)

Assembly Process

1

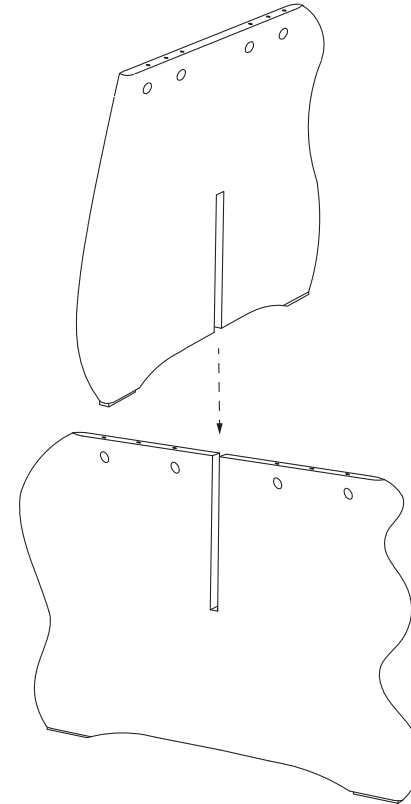

Assemble 2 legs together.

Assembly Process

2

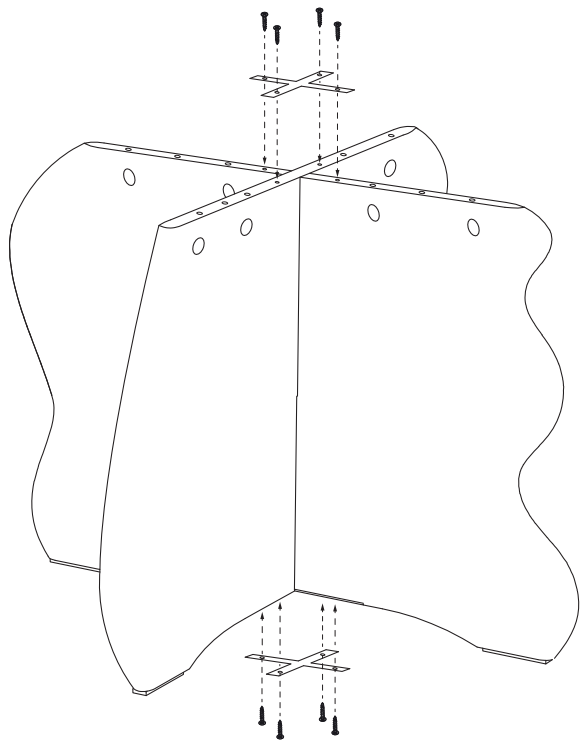

Screw 2 metal plates with 8 screws.

Assembly Process

3

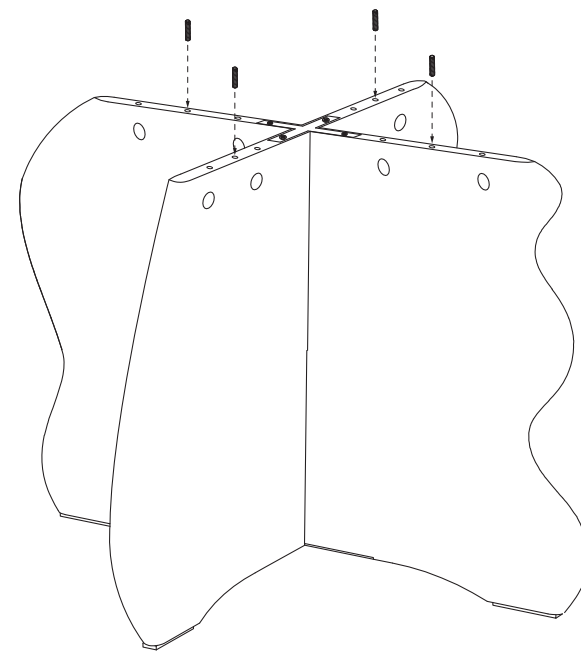

Insert 4 dowels into 2 legs.

Assembly Process

4

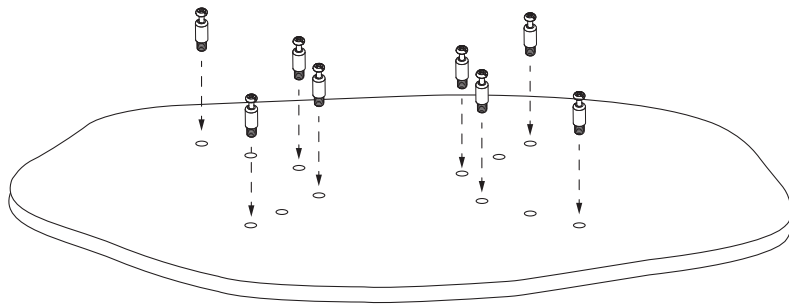

Screw connect rod into top board.

Assembly Process

5

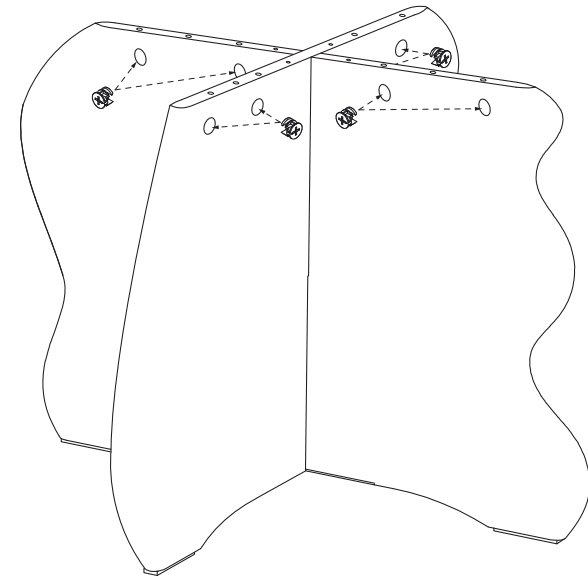
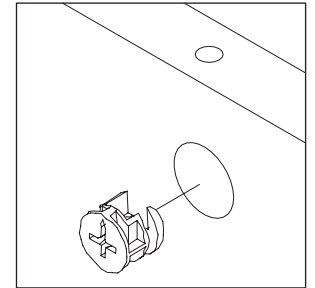

Insert the connect cams in the holes on the sides, ensure the arrow is directed toward the top.

Assembly Process

6

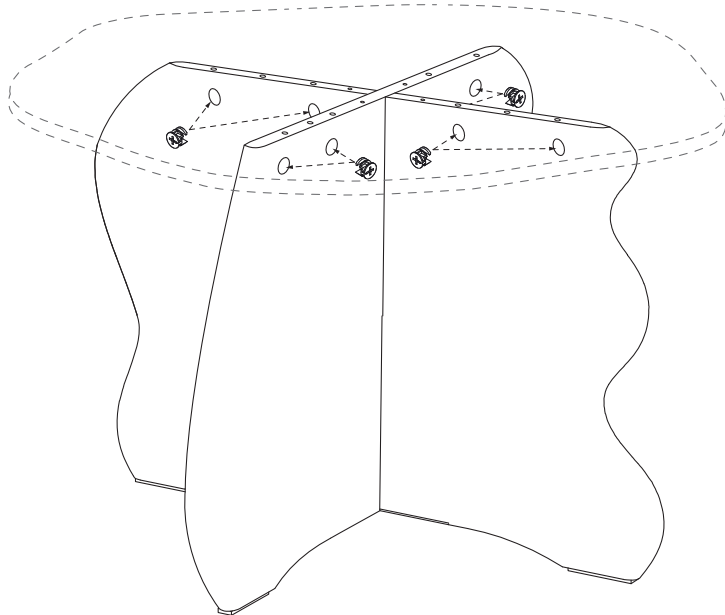
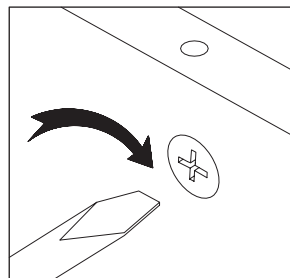

Place the top board on the legs and fasten securely by rotating the connect cams clock-wise.

fermliving.com