

GUBI

ASSEMBLY INSTRUCTIONS

for

Private Dining Table

This assembly requires at least 2 people

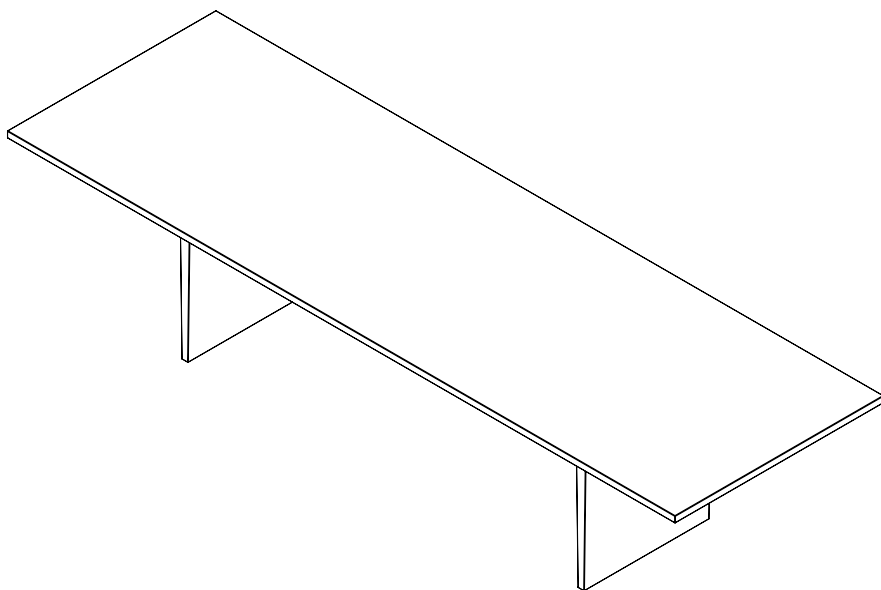

CONTENTS

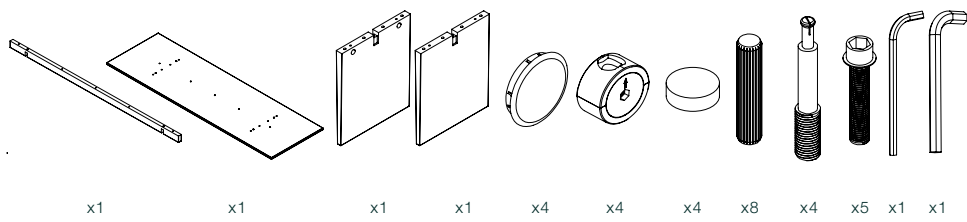

1.

Place the beam on top of the legs; (ensure holes on legs are placed inwards).
Insert the screws and tighten using the Allen key.

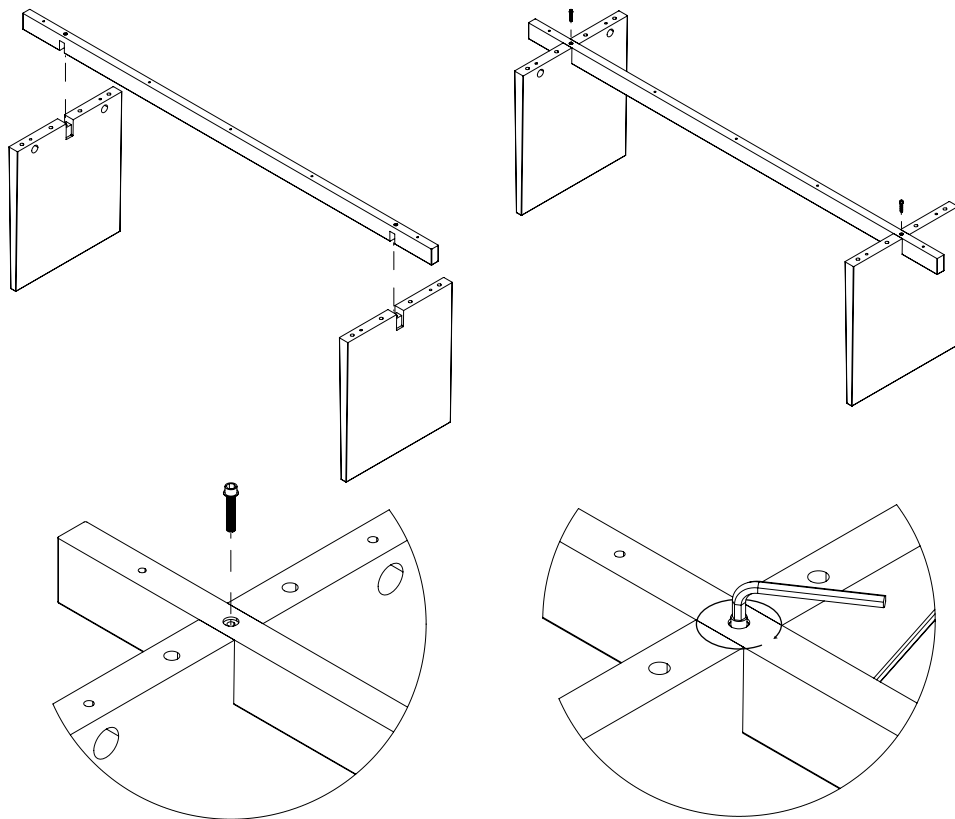

2.

Insert the dowels as illustrated below.

Fully insert the disc; in the right direction as shown in the figure.

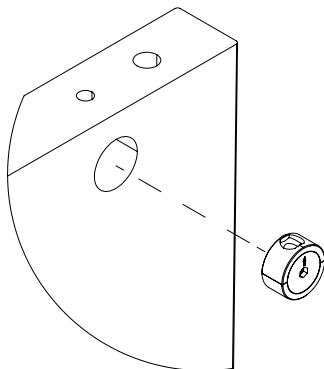
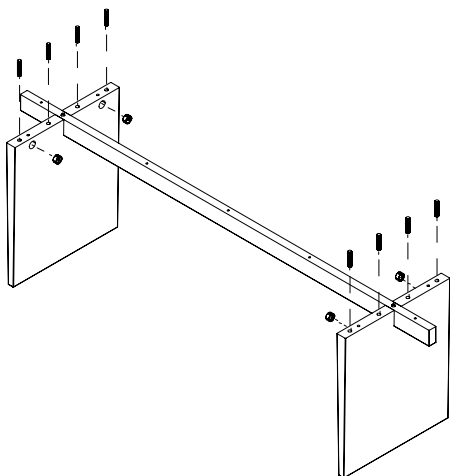

Make sure the dowels are pressed all the way into the leg.
A mallet can be used to secure the end have been reached.

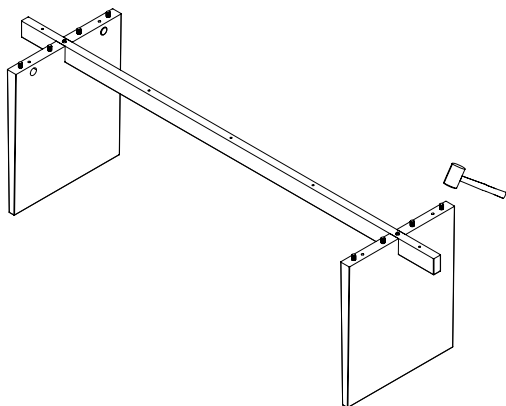
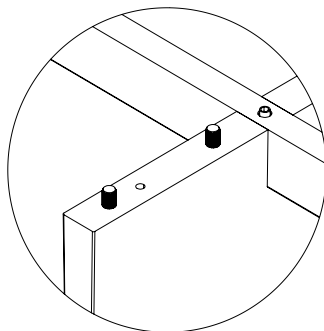

3.

Put down a layer of protection on the floor, it can be a blanket, foam or cardboard.
Place the table top upside down and insert the pins. Tighten them, just by hand.

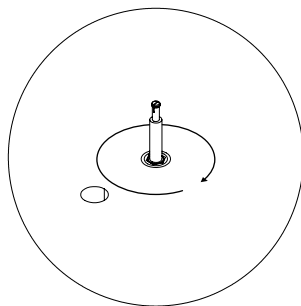
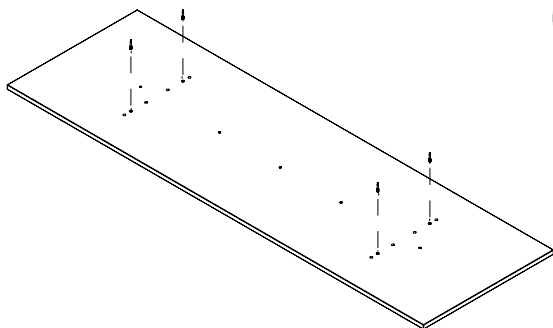

4.

Turn the base and place on top of the table top. Insert the pins in the correct place, and tighten the discs, until the base and table top are fully connected.

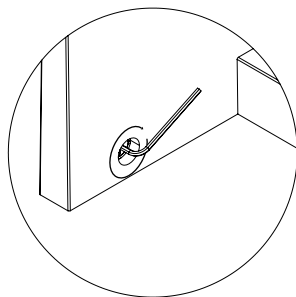
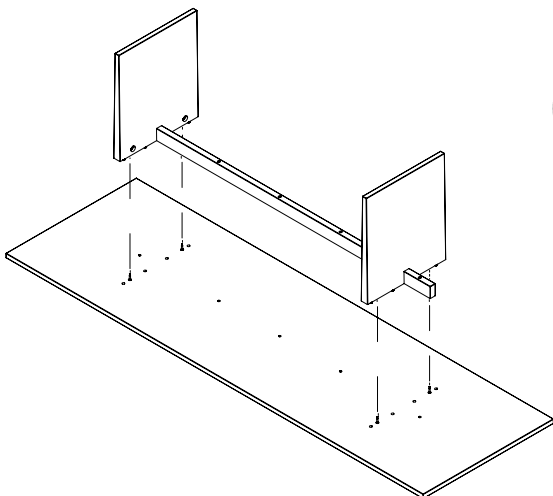

5.

Insert hexagon screws and tighten using the Allen key.

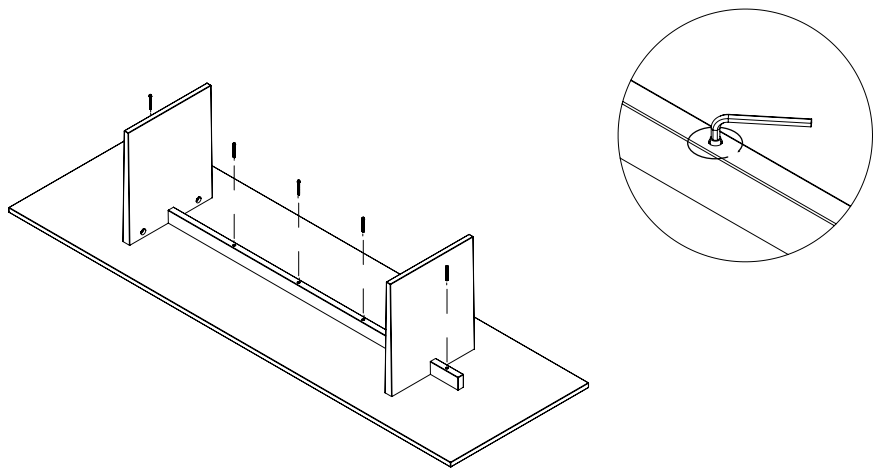

6.

Insert the covers for the discs, attach the felt gliders, and turn the table the right way up.

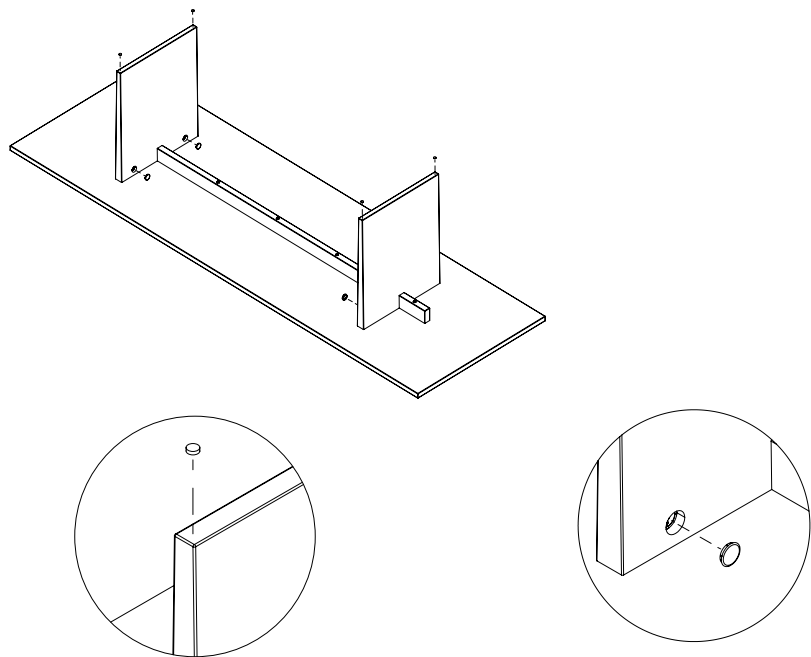

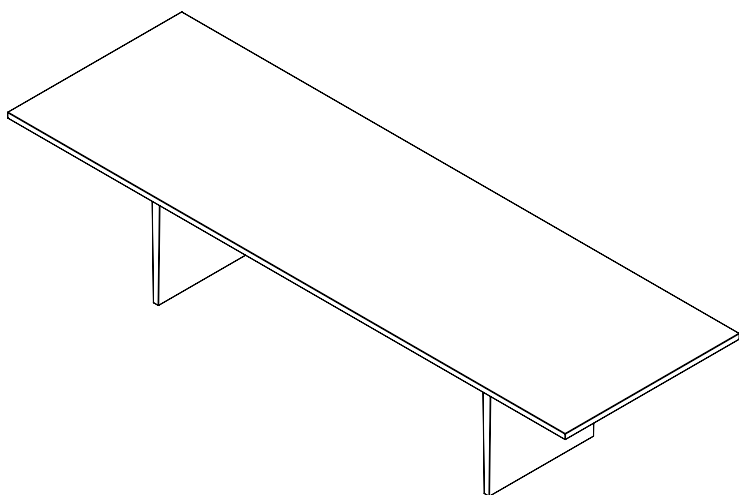



CARE INSTRUCTIONS

Daily cleaning of lacquered surfaces can be done by wiping the surface with a clean, dry cloth in the direction of the grains or slightly damp cloth. Should the surface need more attention use water and a light detergent or soap applied with a damp cloth. Wipe after with a clean dry cloth. Avoid any abrasive materials.

For the best maintenance of the product, protect it against sunlight and heat, and try to keep it away from moisture and grease. Furthermore, protect the surfaces against sharp objects and anything that might cause scratches. A hot object at must have at all times have a heat proof mat or trivet underneath, otherwise it will damage the lacquered surface.

VENEERED PRODUCTS

GUBI's veneered wood products are made of real wood veneer attached to MDF (Medium Density Fiberboard). The veneer is only 0.6-1,2 mm thick, so do not try to sand the product. Given that the product is made of real wood, color and structural differences will occur naturally. Furthermore, the color of the product will change over time due to sunlight and light in general. We therefore recommend that you frequently move the objects around that have been placed on top of the product, to ensure an even surface. Veneered products are protected by a clear lacquer but excessive use of water, or fluid left on the surface will penetrate the lacquer and result in damage to the veneer.



For enquiries contact GUBI A/S - CVR: 17940384
Orientkaj 18-20, 2150 Nordhavn, Copenhagen, Denmark
T +45 69 15 60 60 – order@gubi.com
GUBI.COM
