

ASSEMBLY & INSTALLATION INSTRUCTIONS

A629

Plume Pendant - 5 light - 135006

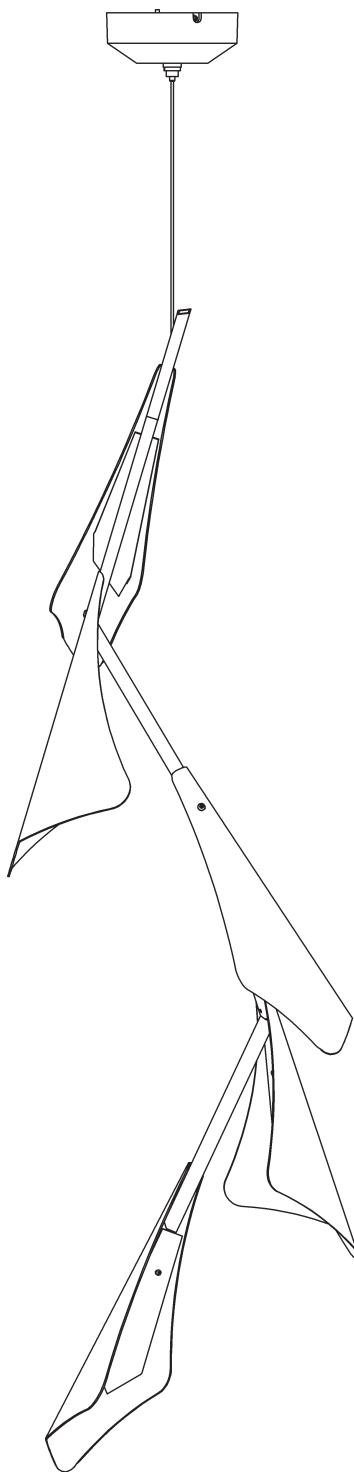

HUBBARDTON FORGE.

Component Parts

A	Crossbar
B	Ground Screw
C	Cupped Washer
D	Canopy
E	#8 Screws
F	Fixture
G	Canopy Gripper
H	Supply/Support Cable
K	Canopy Plate
L	Screws w/ Lockwashers
M	Support Cable
N	Anchor
O	#6 Screw
P	Cable Gripper



ASSEMBLY & INSTALLATION INSTRUCTIONS

A629

Plume Pendant - 5 light - 135006

CAUTION: FAILURE TO INSTALL THIS FIXTURE PROPERLY MAY RESULT IN SERIOUS PERSONAL INJURY OR DEATH AND PROPERTY DAMAGE. We recommend installation by a licensed electrician. This product must be installed in accordance with applicable installation code(s), by a person familiar with the construction and operation of the product and the hazards involved.*

Caution: Do not exceed maximum wattage noted on fixture. Use only recommended bulbs with fixture.

Please Note: After installation extra hardware and accessories are possible; our kits are used on multiple products.

To Install Fixture (Figures 1 & 2, last page)

CAUTION: BE SURE POWER IS OFF AT THE MAIN BREAKER BOX PRIOR TO INSTALLATION.

1. Carefully unpack the fixture (F) from the carton.
2. Crossbar (A) is shipped installed. Remove screws (E) from canopy (D) and save for later use. Remove crossbar (A).
3. Using two machine screws (not provided), fasten the crossbar (A) to the electric box. (Figure 1).

Note: A new electric box comes with screws. When replacing a fixture, retain the existing screws for use with the new fixture.

4. Height of fixture can be set before attaching the fixture to the ceiling. Remove screws w/lock washers (L) and canopy plate (K) from canopy (D). (Figure 2)

Note: Fixture is shipped at max height.

5. Loosen safety nut on canopy gripper (G) by twisting counter clockwise. Push supply/support cable (H) into canopy gripper (G) until desired height is reached.
6. Retighten safety nut on canopy gripper (G).
7. Coil supply/support cable (H) in canopy (D) and place canopy plate (K) in canopy (D). Re- install screws w/lock washers (L) to secure plate.
8. Hold canopy (D) close to ceiling. Using suitable wire connectors (not provided) connect fixture wires to supply wires (white to white, black to black). Run a pigtail lead from crossbar ground screw (B) and cupped washer (C) to the junction box and connect all ground wires (bare copper or green to bare copper or green). (Figure 1).

CAUTION: BE SURE NOT TO PINCH THE SUPPLY/SUPPORT CABLE IN BETWEEN THE CANOPY (D) AND THE CANOPY PLATE (K).

CAUTION: MAKE SURE WIRE CONNECTORS ARE TWISTED ON SECURELY AND NO BARE WIRE IS EXPOSED.

9. Raise canopy (D) up to ceiling. Align holes in canopy (D) with holes in crossbar (A) and secure with (2) #8 screws (E). Figure 1
10. If fixture needs to be lowered to achieve desired height, loosen safety nut, push up on canopy gripper (G) and gently pull down on supply/support cable (H). Retighten safety nut.



HUBBARDTON FORGE.

continued...

ASSEMBLY & INSTALLATION INSTRUCTIONS

A629

Plume Pendant - 5 light - 135006

11. If fixture is to be installed horizontally or at an angle see additional instructions on page 5.
12. Restore electricity at main breaker.

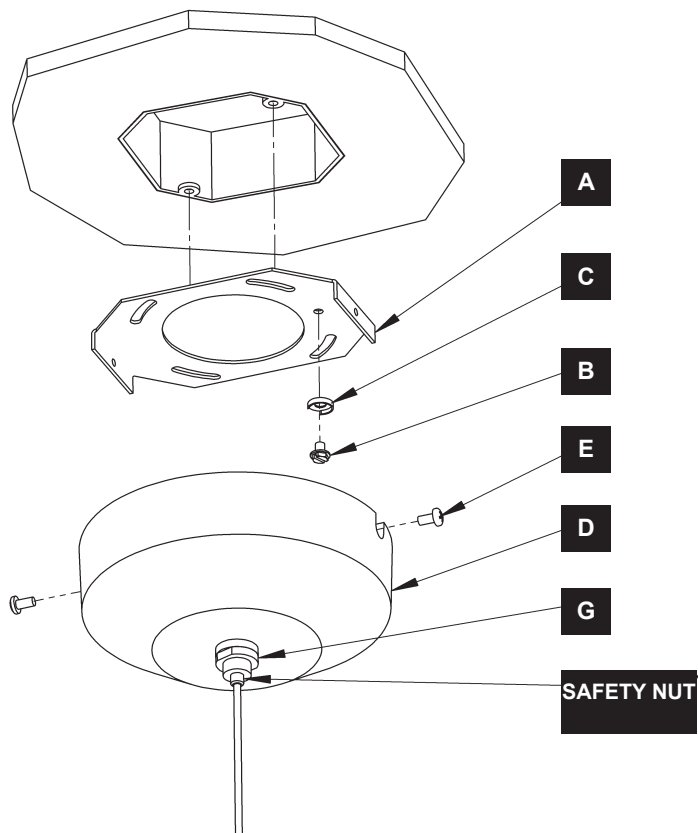

(Figure 1)

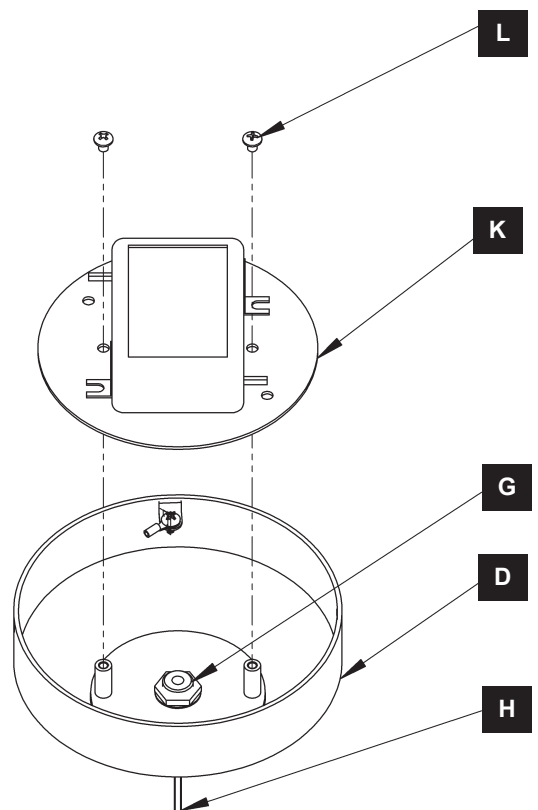

(Figure 2)



HUBBARDTON FORGE.

To Install Fixture Horizontally or Angled (Figures 3 & 4)

Note: Fixture may be oriented vertically or horizontally or any angle in between.

1. Locate fourth decorative shield from the canopy end of fixture. Remove hex head screw and gently move the decorative shield to gain access to keyhole. Insert barrel end of cable (M) into large end of keyhole and slide cable to small end of keyhole. Reattach decorative shield with hex head screw. (Figure 3).
2. Orient fixture to desired location and determine appropriate location for ceiling cable gripper (P). With a pencil, mark this location on the ceiling.
3. Drill 1/4" hole in the location marked on the ceiling. Place the tapered end of the anchor (N) into the hole and gently tap flush to the wall using a light weight hammer.
4. Unscrew gripper base from the cable gripper (P). Slip #6 screw (O) into gripper base and attach to ceiling by screwing into anchor (N).
5. Screw cable gripper (P) back on to gripper base. Insert support cable (M) into cable gripper. With the swivel portion of the cable gripper oriented horizontally adjust support cable to correct height. Using heavy duty cable cutters, cut excess support cable (M) short enough to allow swivel to rotate.

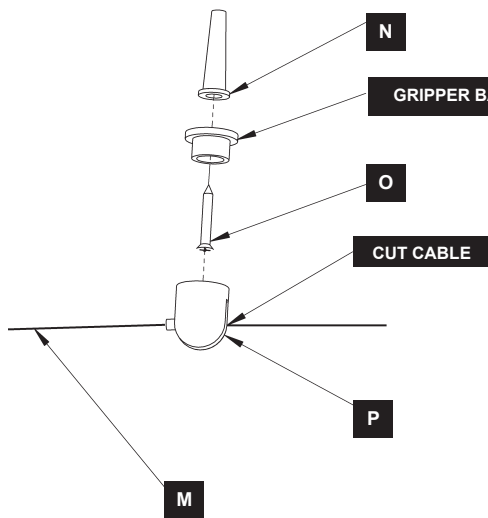

(Figure 3)

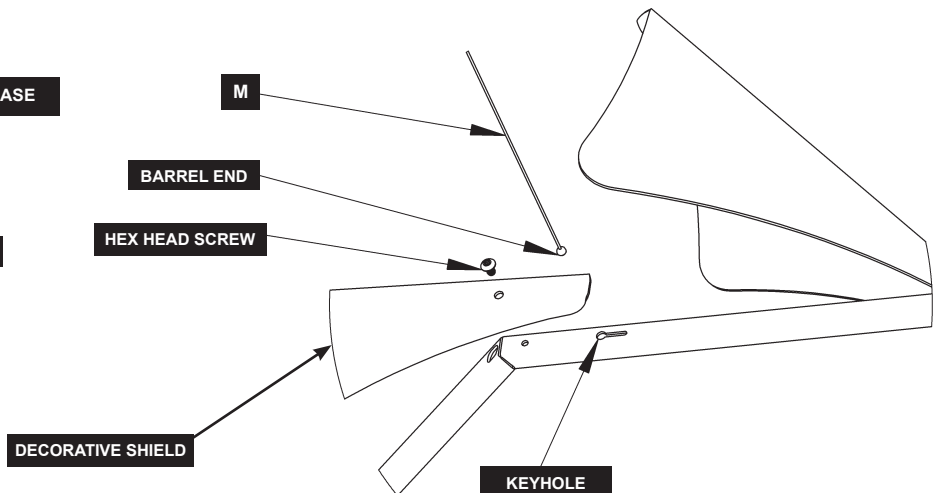

(Figure 4)

If you need further assistance, or find that you are missing any parts, please contact the dealer from which you purchased this product. We hope you enjoy your fixture!

*** Hubbardton Forge will not be liable for injury or damage caused by improper installation, lamping or use of this fixture.**

