

# ASSEMBLY & INSTALLATION INSTRUCTIONS

B210

Flora Sconce 203030

---

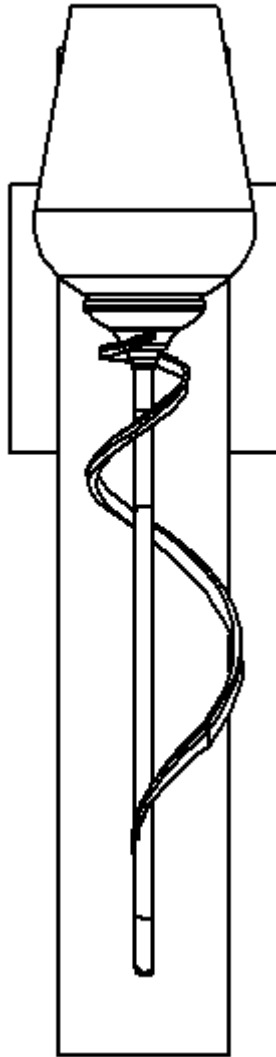

## Component Parts

- A. Crossbar**
- B. Nipple**
- C. Threaded Cap**
- D. Fixture assembly**
- E. Ground Screw**
- F. Lock Nut**
- G. Wall Plate**
- H. Cupped Washer**
- I. Ground Screw**
- J. Socket**
- K. Bulb (not included)**
- L. Glass**
- M. Retaining Ring**
- N. Socket Tool**

# ASSEMBLY & INSTALLATION INSTRUCTIONS

B210

Flora Sconce 203030

**CAUTION: FAILURE TO INSTALL THIS FIXTURE PROPERLY MAY RESULT IN SERIOUS PERSONAL INJURY OR DEATH AND PROPERTY DAMAGE.** We recommend installation by a licensed electrician. This product must be installed in accordance with applicable installation code(s), by a person familiar with the construction and operation of the product and the hazards involved.\*

**Please Note:** This fixture is designed to be mounted on a standard wall surface and may not be suitable for all applications. If installing in a non-wood frame application, we recommend consulting a qualified builder or electrician

**Please Note:** After installation extra hardware and accessories are possible due to our kits are used on multiple products and options.

## To Mount Fixture to Wall with Single Box (Figure 1)

**CAUTION: BE SURE POWER IS OFF AT THE MAIN BREAKER BOX PRIOR TO INSTALLATION.**

1. Carefully unpack the fixture from the carton.
2. Using two machine screws (not provided), fasten the crossbar (A) to the electric box making sure crossbar is level. **Note:** A new electric box comes with screws. When replacing a fixture, retain the existing screws for use with the new fixture.
3. Thread the nipple (B) into the crossbar (A) and secure with lock nut (F). Adjust the nipple to proper length to ensure the fixture will fit snugly to the wall.
4. Ground the crossbar (A) by securing a pigtail lead around ground screw (E).
5. Hold the fixture assembly (D) close to the wall and using suitable wire connectors (not provided) connect fixture wires and pigtail leads to supply wires (white to white or ribbed, black to black or smooth and green to green or bare).

**CAUTION: MAKE SURE WIRE CONNECTORS ARE TWISTED ON SECURELY AND NO BARE WIRES ARE EXPOSED.**

6. Carefully tuck all wires behind the fixture, place fixture firmly against the wall and fasten with threaded cap (C).
7. See instructions following to install wall plate.

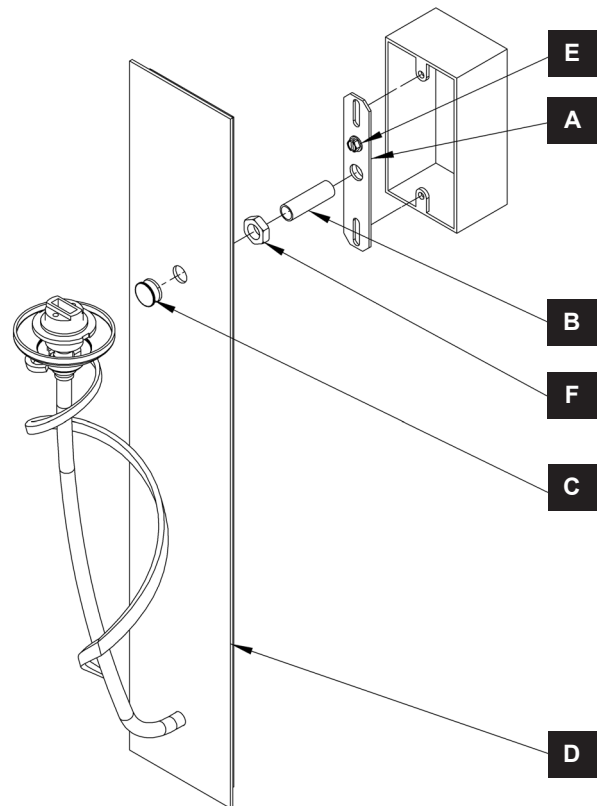

(Figure 1)

## To Mount Fixture to Wall with Standard 4" Box (Figure 2)

**CAUTION: BE SURE POWER IS OFF AT THE MAIN BREAKER BOX PRIOR TO INSTALLATION.**

1. Carefully unpack the fixture from the carton.
2. Using two machine screws (not provided), fasten the crossbar (A) to the electric box making sure crossbar is level. **Note:** A new electric box comes with screws. When replacing a fixture, retain the existing screws for use with the new fixture.
3. Thread the nipple (B) into the crossbar (A). Adjust the nipple to proper length to ensure the fixture will fit snugly to the wall.
4. Ground the crossbar (A) by securing a pigtail lead around ground screw (E).
5. Orient the wall plate (G) so that the bent tab is at the top and bent away from the wall and slip onto nipple (B). The tab will fit into the back of the fixture to facilitate alignment.
6. Run a pigtail lead using ground screw (I) and cupped washer (H).
7. Thread the pigtail lead and fixture wires through the large diameter hole at the bottom of the wall plate (G).
8. Hold the fixture assembly (D) close to the wall and using suitable wire connectors, not provided, connect fixture wires and pigtail leads to supply wires (white to white or ribbed, black to black or smooth and green to green or bare).

**CAUTION: MAKE SURE WIRE CONNECTORS ARE TWISTED ON SECURELY AND NO BARE WIRES ARE EXPOSED.**

9. Secure nipple (B) and wall plate (G) with lock nut (F).
10. Place fixture firmly against the wall and fasten with threaded cap (C).
11. See instructions following to install glass.

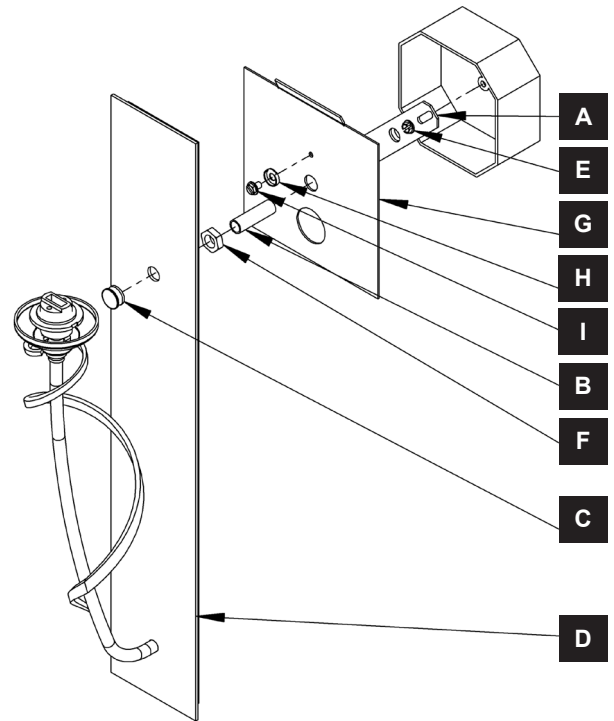

(Figure 2)

## To Install Glass (Figures 3)

1. Remove retaining ring (M) from socket (J). *Retaining ring is shipped installed.*
2. Install light bulb (K), (not included). *Be careful not to touch bulb with bare hands; oil from the hands will dramatically reduce bulb life*
3. Slip glass (L) over socket (J) and thread retaining ring (M) onto the socket (J) using provided socket tool (N).
4. Restore electricity at the main breaker. *If installing shade option wait to restore electricity until after shade is installed.*

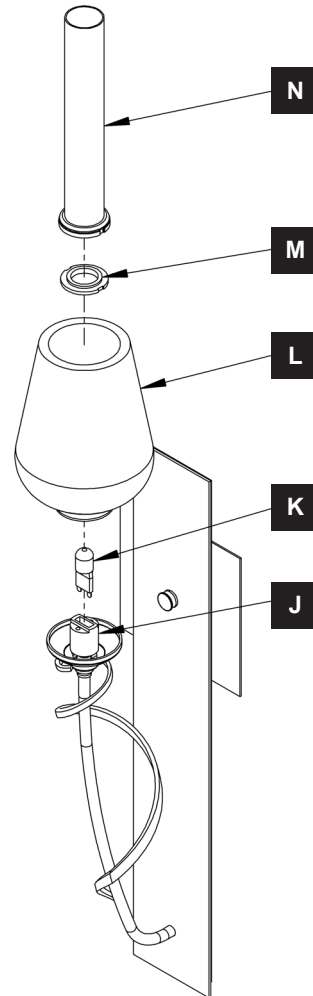

(Figure 3)

If you need further assistance, or find that you are missing any parts, please contact the dealer from which you purchased this product. We hope you enjoy your fixture!

**\* Hubbardton Forge will not be liable for injury or damage caused by improper installation, lamping or use of this fixture.**