

hollis+morris

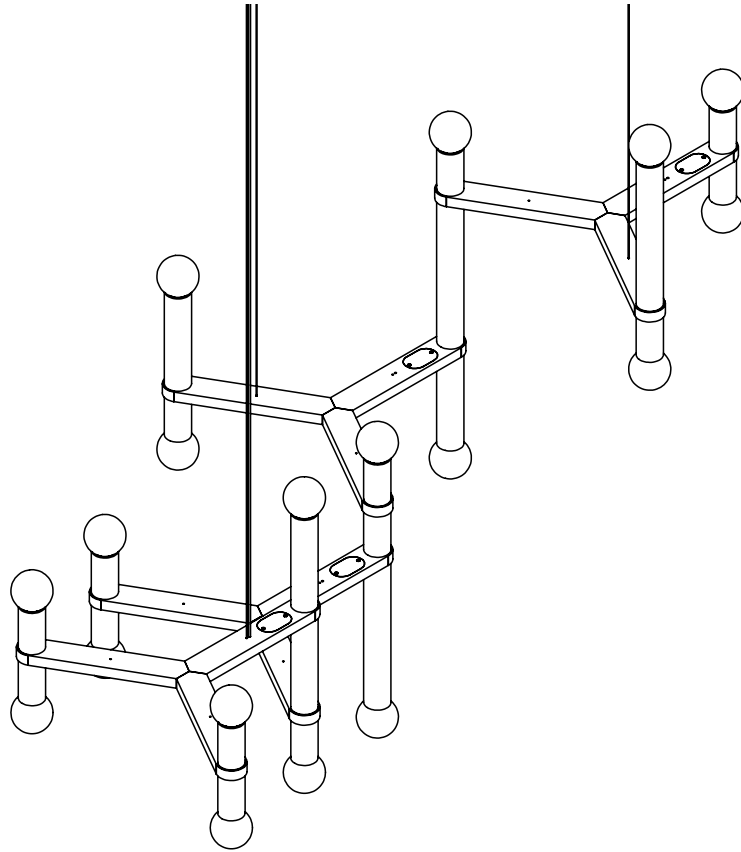

MOLECULE chandelier

product installation + specifications



MOLECULE chandelier

product code:

MOLCchandelier

materials:

- + solid wood
- + 12V LED bulbs
- + metal rec tube
- + hand blown glass
- + suspension hardware

finish:

- + hardwax oil
- + powder coated or plated steel
- + stainless steel hardware

input:

- + 120- 277V

driver:

- + 12V phase dimmable driver
- + L.T.F. TA60WA12LED65D010
ELV / 0-10V Dimmable
- + driver and canopy included

output:

- + 1Y: 15W, 2Y: 25W, 3Y: 35W,
4Y: 45W
- + 100 lumens / watt
- + 3000K with 90+ CRI

suspension:

- + cord length: 10' standard
(custom lengths available)
- + 3-point suspension
- + single canopy connection

certification:

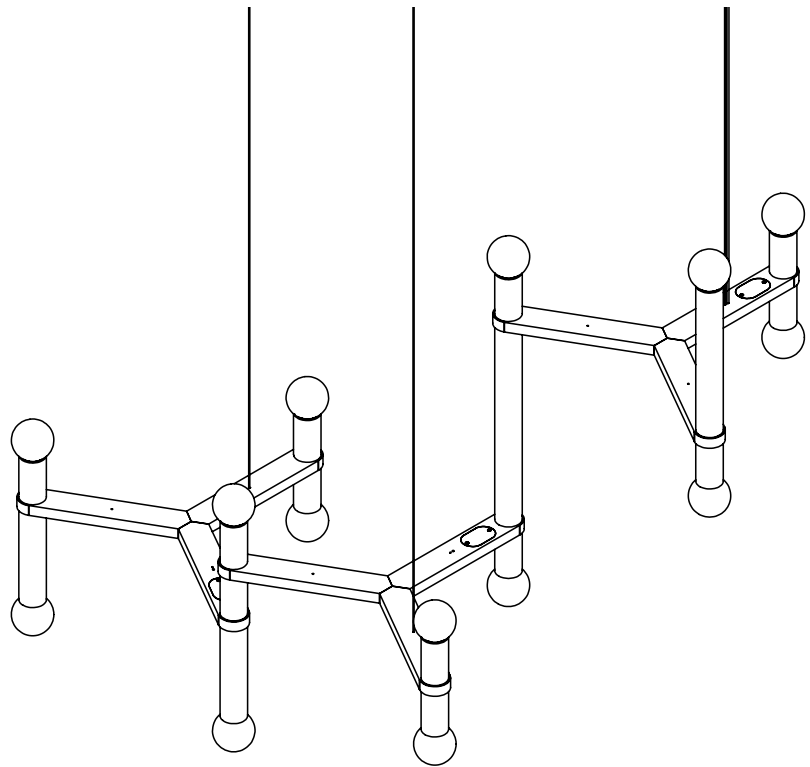

dimensions + installation

Top View

- ⊗ Power Connection + Suspension Point
- × Suspension Point

*note dimensions are referenced off edge of metal and to center of suspension point

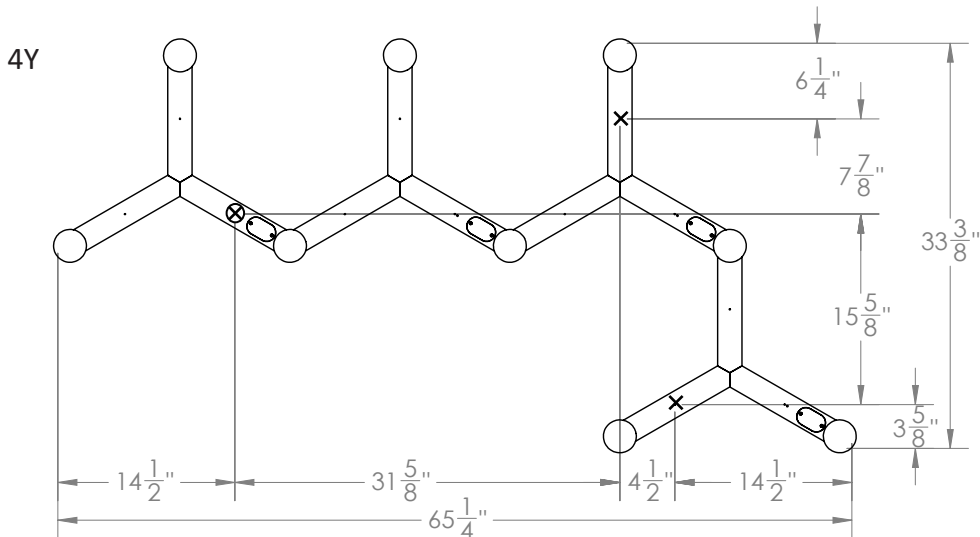
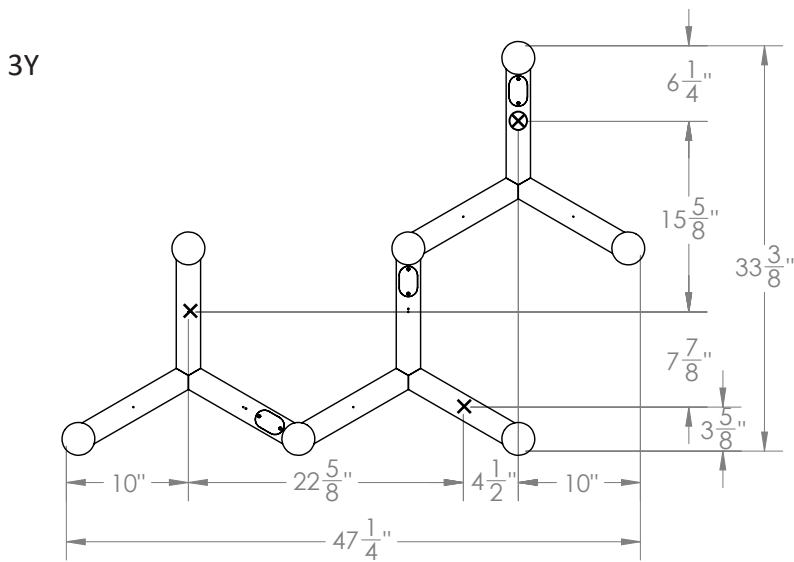
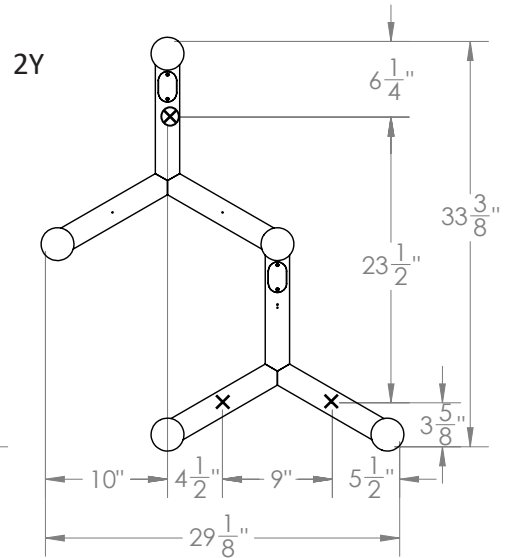
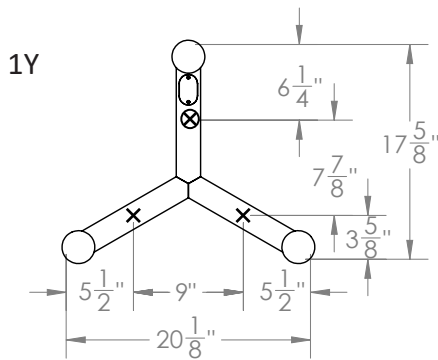

dimensions + installation

Elevation View - Canopy Connection

1. Locate desired canopy location on ceiling & have a certified electrician supply and connect driver to 120V power.
2. Feed suspension cable through the cable gripper on the canopy plate, and feed the coax cable through the designated hole in the canopy plate.
3. Connect the coax cable to the 12V driver. Then close the junction box with universal junction plate adapter followed by the canopy plate using the provided flat head screws.
4. Locate desired locations for suspension hardware and mount ceiling couplers to ceiling.
5. Feed additional suspension cables through cable grippers and screw cable gripper into ceiling coupler.
6. Adjust all cables to desired heights (standard length max = 120")

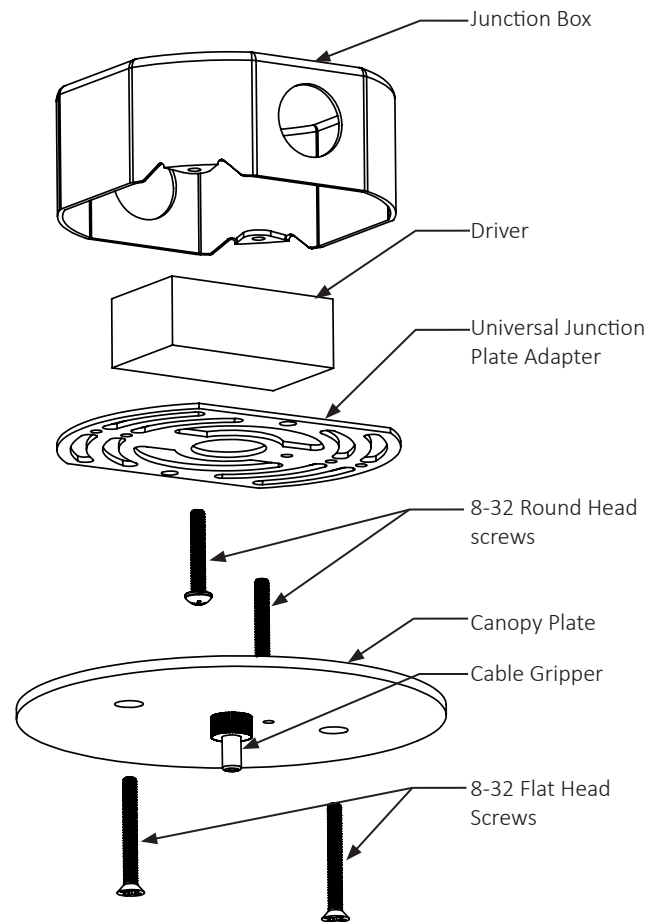

Suspension Hardware Assembly

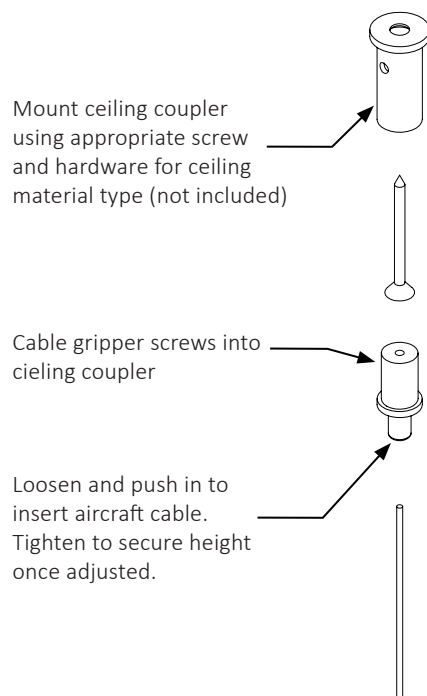

*** COAX CABLE

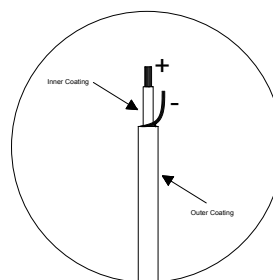

coax cable requires stripping of outer and inner coatings to access positive and negative connection wires

dimensions + installation

Option A - Support from canopy

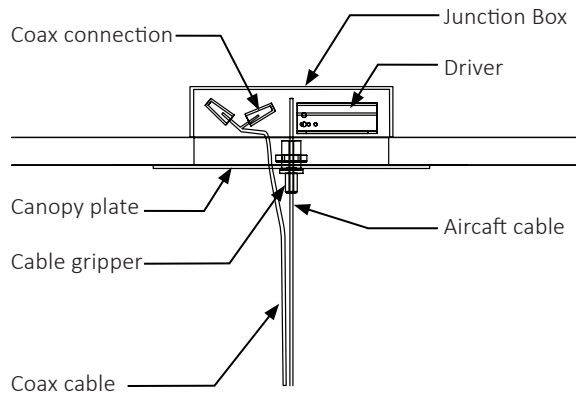

Option B - Support from ceiling

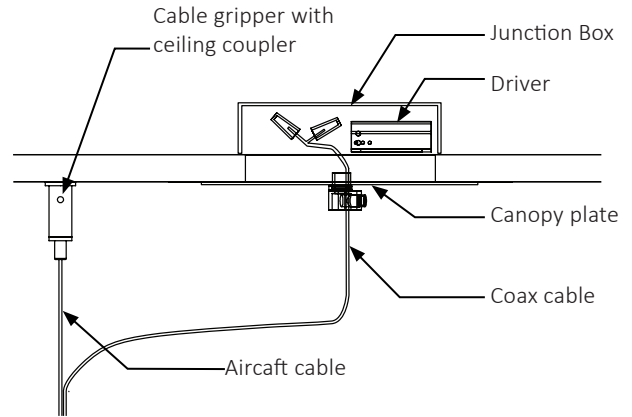

Canopy Plate Dimensions

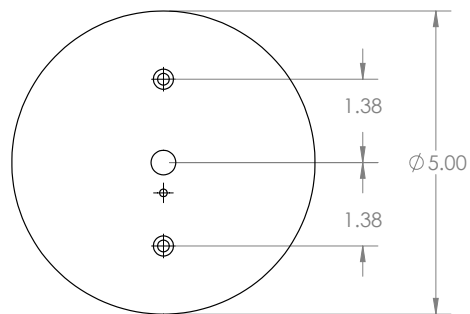

Bulb Installation

1. Insert G4 LED bulb into G4 socket before connecting to power.
2. Screw globe onto wood top.

