

**hollis+morris**

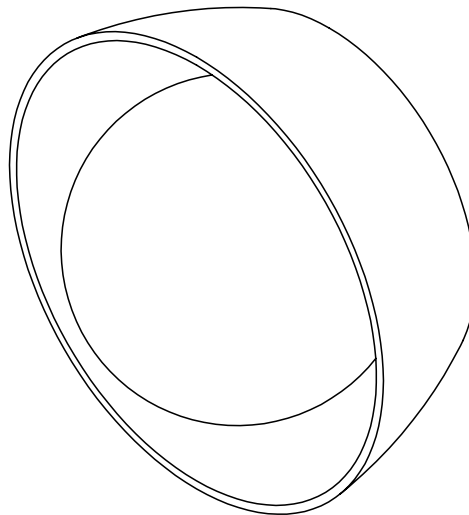

**berm  
sconce**

product installation + specifications



# berm sconce

product code:  
BERMsconce

**materials:**

- + solid wood
- + hand blown glass

**finish:**

- + hardwax oil

**input:**

- + 120V 50/60 Hz (Canada + US)

**driver:**

- + 35V driver
- + TRIAC / ELV / 0-10 dimmable

**output:**

- + 12W
- + 3000K with CRI of 95 or higher
- + 800 Lms

**mounting:**

- + junction- box connection

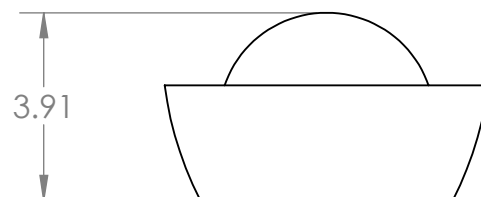
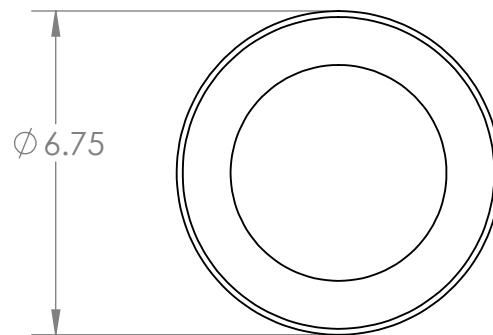

**certification:**



# hardware + installation

1. Feed wires through universal plate adaptor and have a certified electrician connect the fixture to the driver and the driver to 120V power.
2. Fasten the universal plate adaptor to the junction box using the round head 8-32 screws.
3. Mount the back plate to the universal plate adaptor using the flat head 8-32 screws.

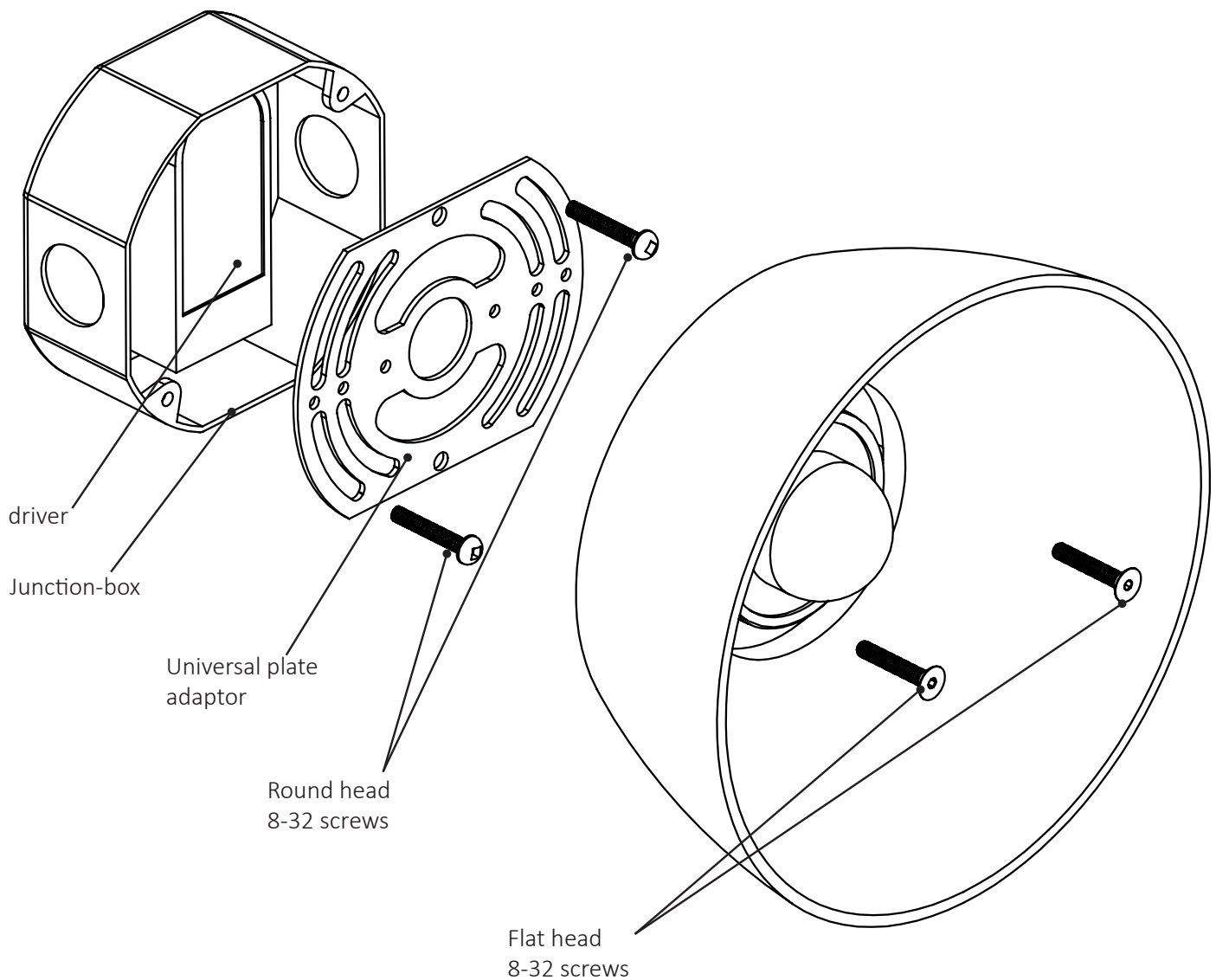

# hardware + installation

4. Twist the glass over the collar

