

# DIAGRAM OF INSTALLATION STRUCTURE

SKU No. :CE1009213/CE1009214/CE1009215

Product Size: L13.8"\*W13.8"\*H12.6"

Light Source: COB

4" Octagonal J-box(by others)

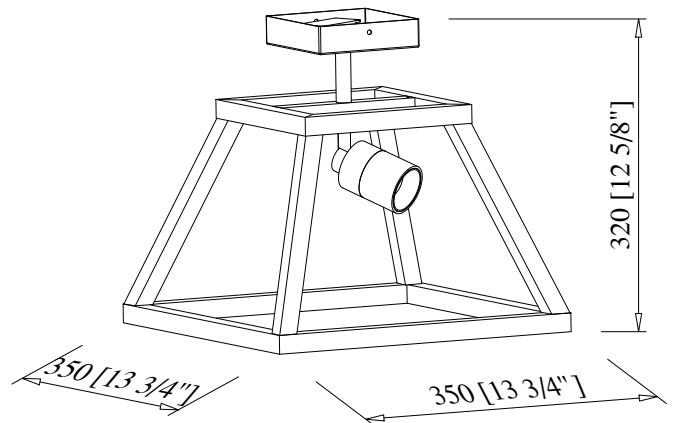
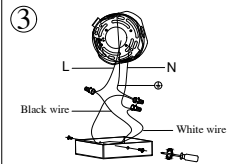
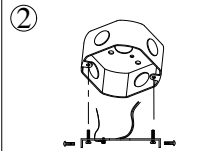
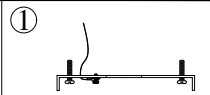
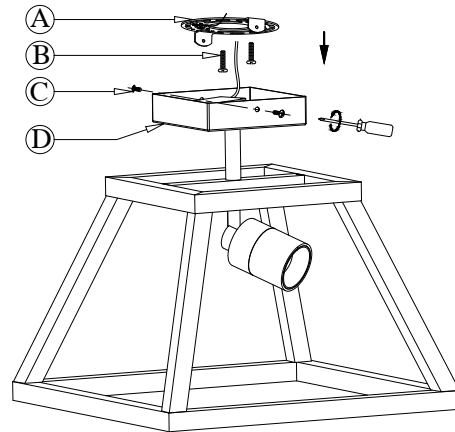

Ⓐ Mounting Bracket

Ⓑ Mounting Screw (2X)

Ⓒ Round Head Screw (2X)

Ⓓ Canopy

## Installation instruction

- 1.Unpack and take out the fixture / accessory bag, then turn off the power.
- 2.Dismantle mounting bracket subassembly as picture(1), then install mounting bracket(A) to J-Box with mounting screws(B).
- 3.Connect the fixture to a suitable ground in accordance with local electrical codes.
- 4.Connect the White wire to the neutral power line wire with a wire nut.
- 5.Connect the Black wire to the hot power line wire with a wire nut.
- 6.Neatly place all wires and wire nut connections inside the J-box.
- 7.Install canopy(D) to ceiling with round head screws(C).
- 8.Adjust the direction and angle of spotlight as the need.
- 9.After finish the installation, turn on the power.