

---

## MILE 01, 02, 03 220-240V

---

**Recessed canopy**

**Plenum (non insulated) or remote installation**

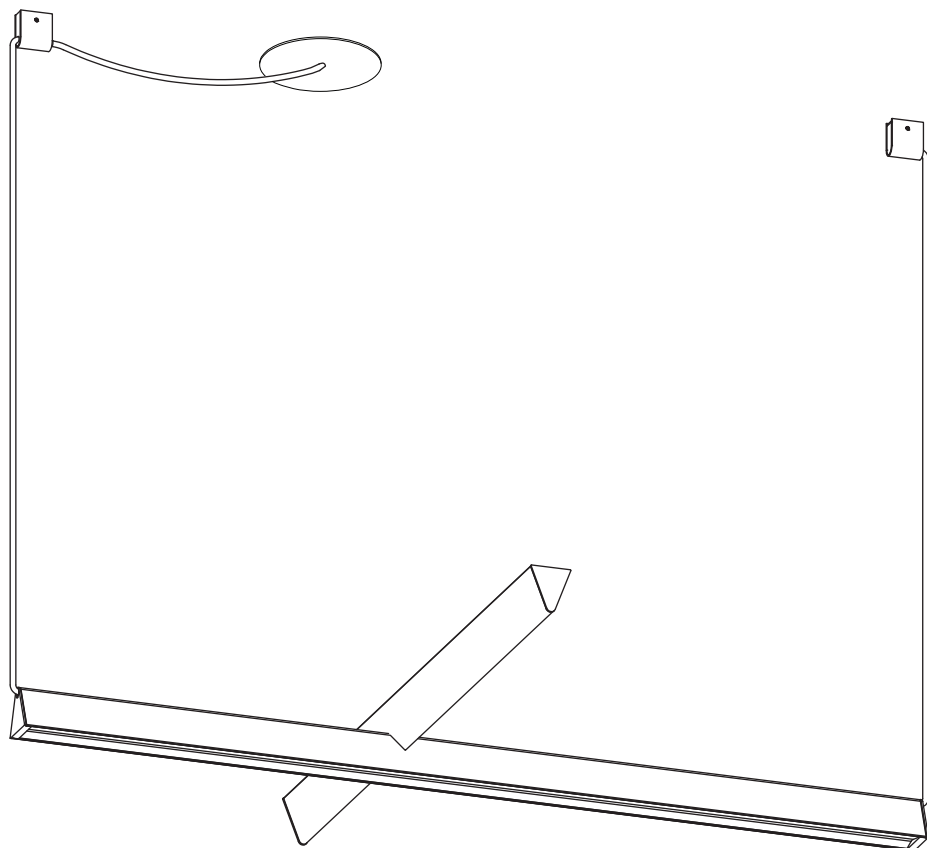

- Please read entire manual before beginning installation
- To be installed by an electrician
- Use appropriate screws and anchors where necessary
- Wear enclosed gloves when handling lamp
- Handle materials with care. Please consult lamp maintenance sheet on our web site



**Never turn on power supply  
until installation is completed**



**This is an example of the Mile 01.  
However, the Mile 02 and 03 follow  
the same installation process.**

1

Remove Octobox cover plate  
and strain relief plate. It is held in  
place by two screws.

Refer to:  
Annex (independent driver) - page 14

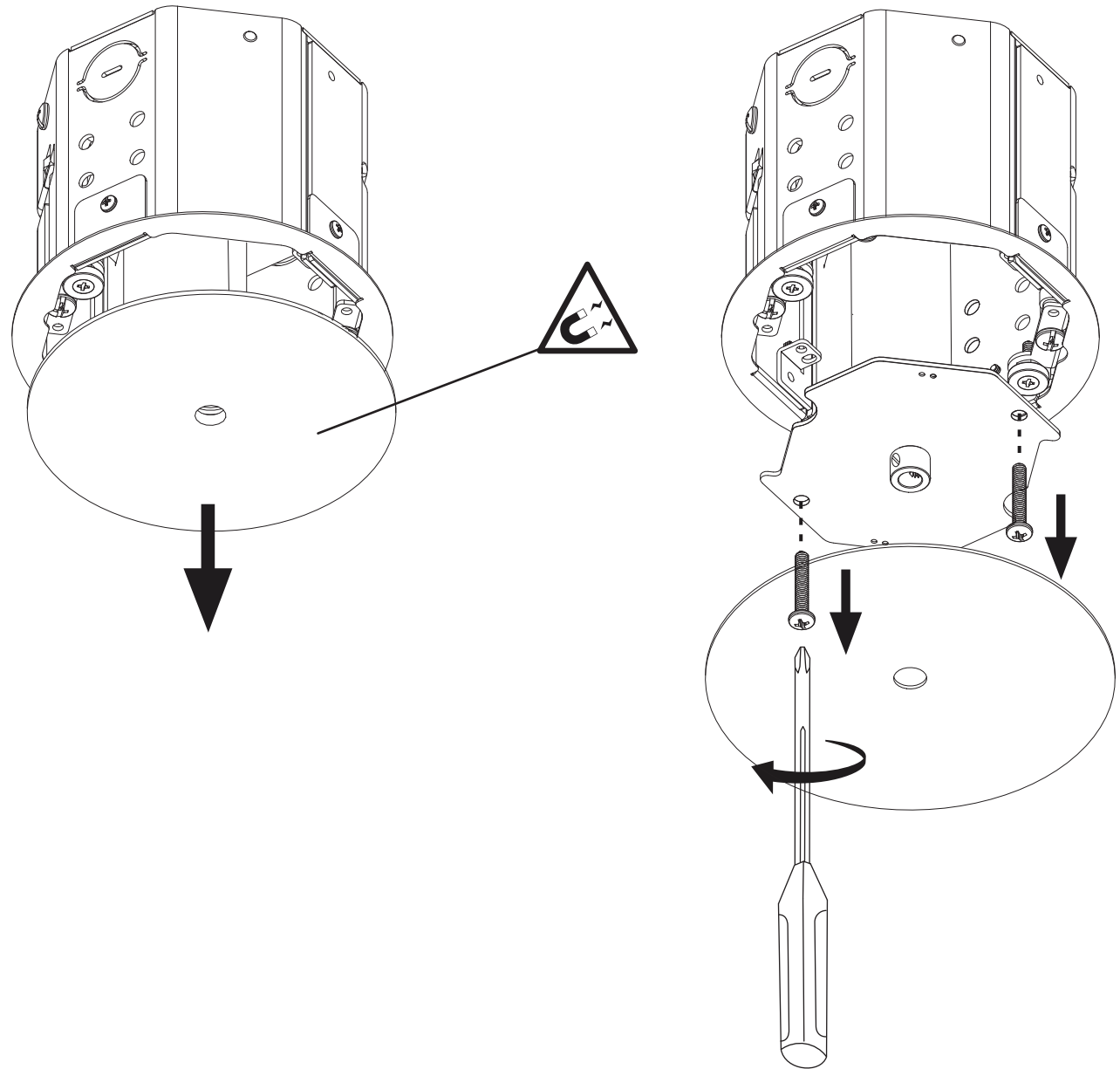

2

Remove endcap on short side of  
uplight. It is held in place with a magnet.  
Pull tape up to remove lens  
then remove tape.

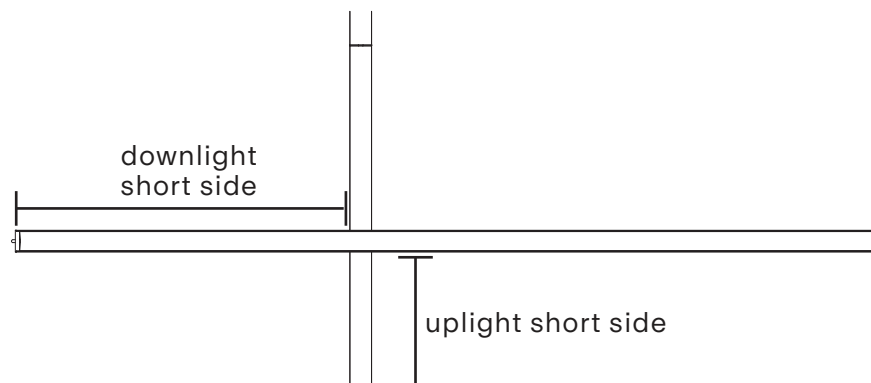
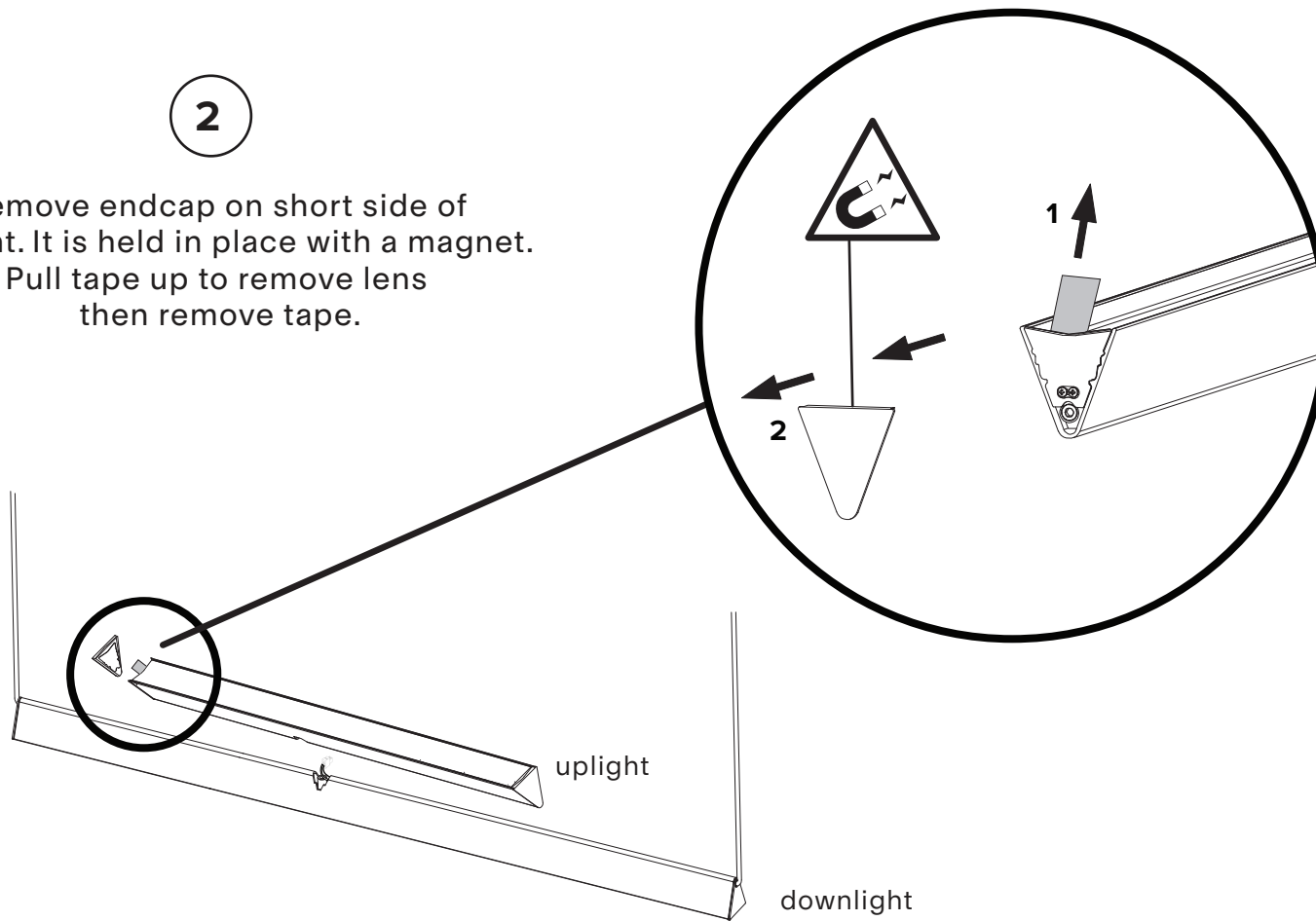

**Becareful when removing endcap that  
it does not stick to other surfaces which  
could result in scratches in the paint.**

3

Before connecting the two sections of your luminaire, rest the upright on the foam in which it was shipped.

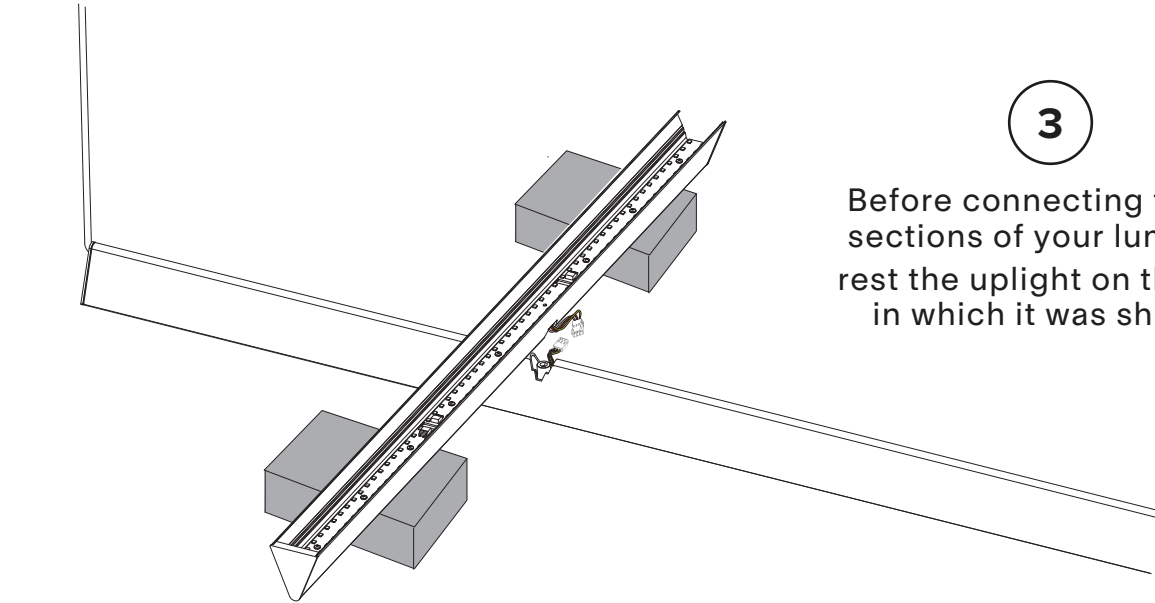

4

Make the connection between the two sections. Then carefully push them back into the upright long side.

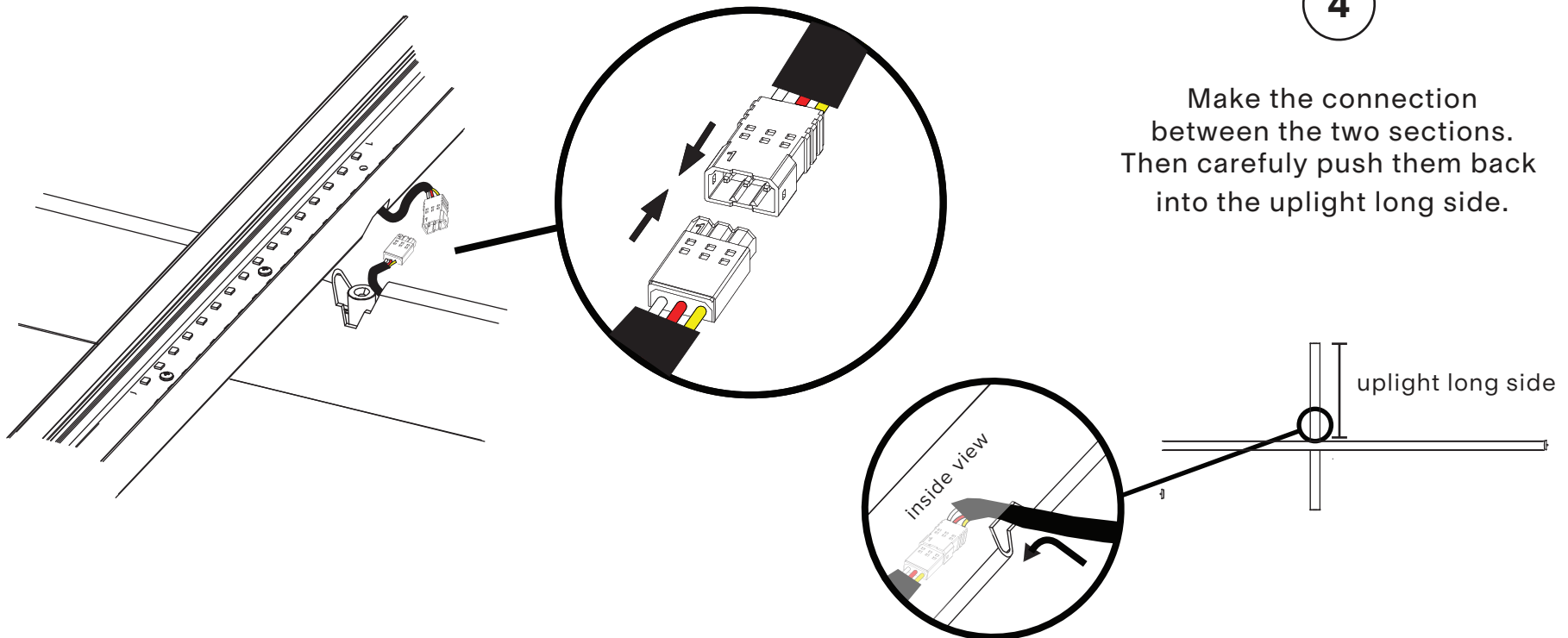

5

Reorientate uplight into the slot of the downlight.  
Screw it into place with provided allen key.

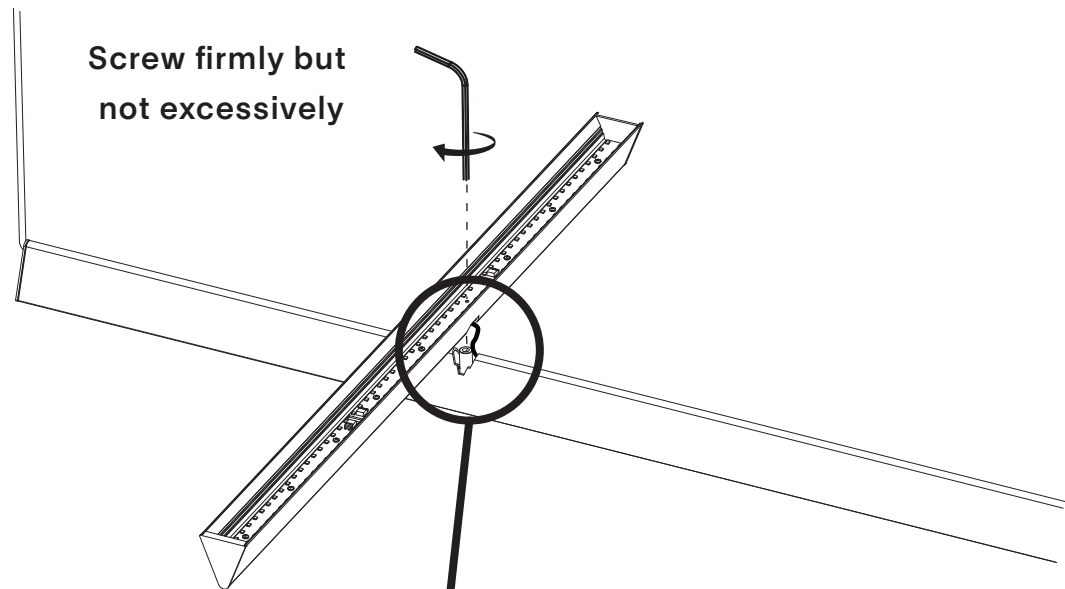

X



While you bring the two extrusions together ensure to place the downlight wires next to the anchor. Make sure the wire does not sit on top of the anchor and that it does not get pinched or scuffed.

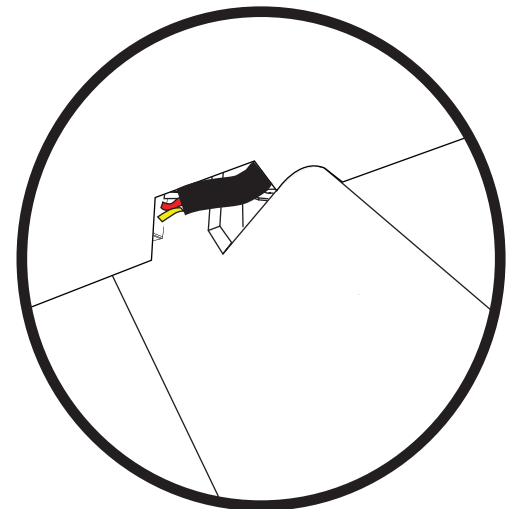
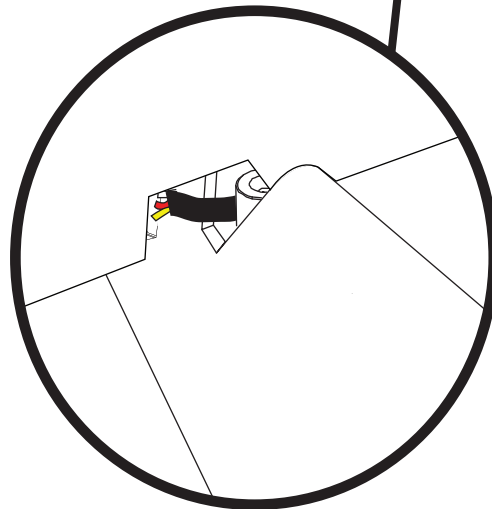

**6**

Slide lens into opposite endcap (1)  
then snap lens back into slots (2).  
Replace endcap (3).

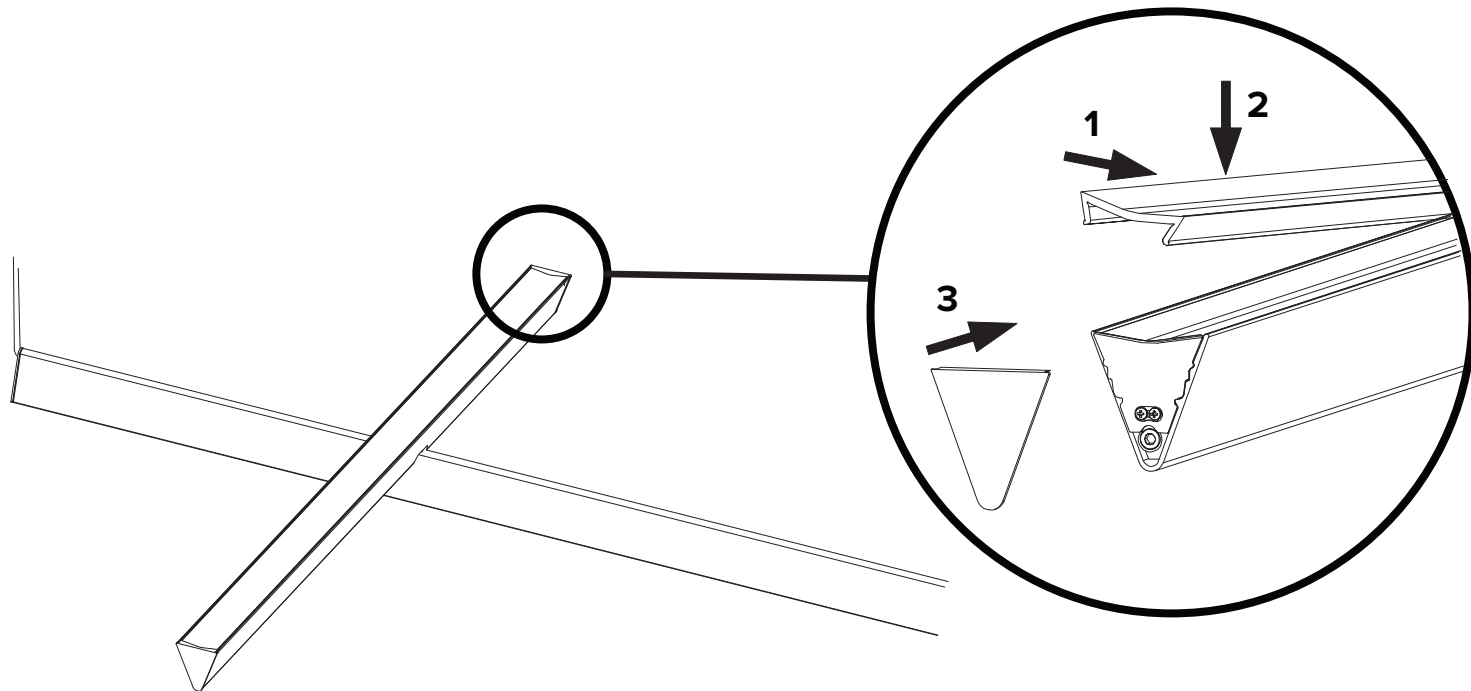

7

## Mark anchor locations

Be sure all ceiling holes are aligned.  
We recomend you mount luminaire with  
uplight aligned with junction box.

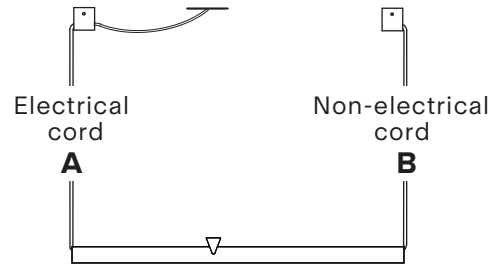

MILE 01  
&  
MILE 03

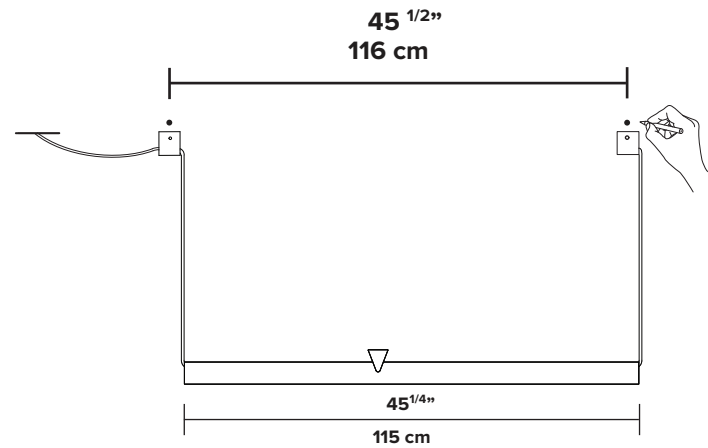
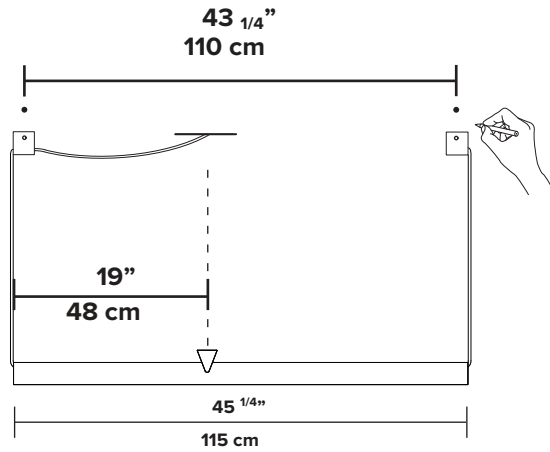

MILE 02

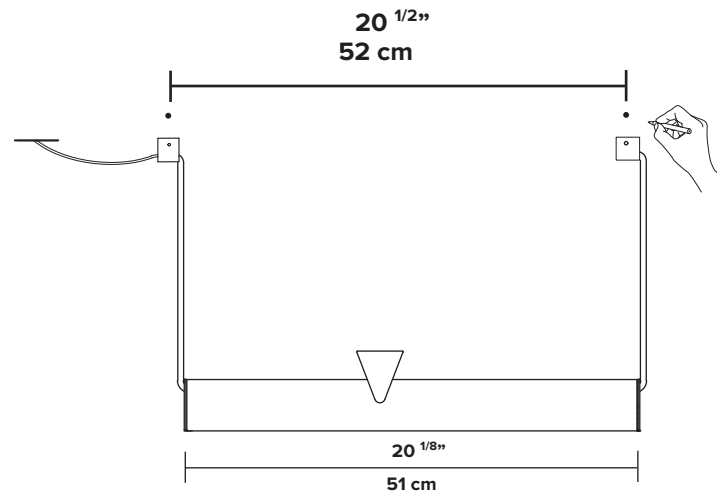
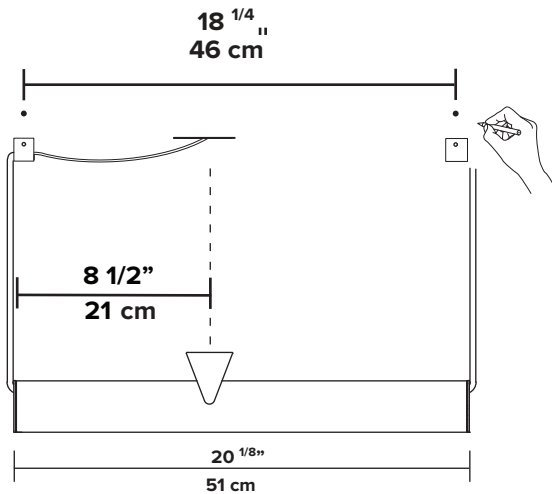

8

Mount double hole anchor  
with electrical cord

Pull wires to straighten them  
before mounting them.

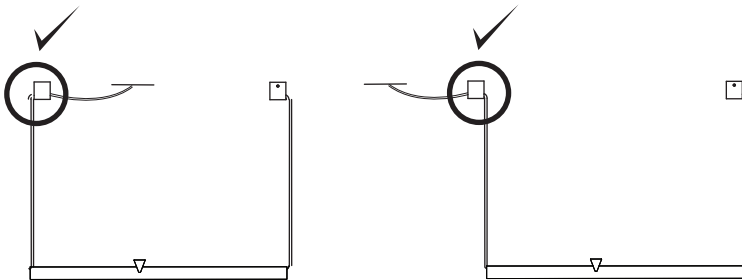
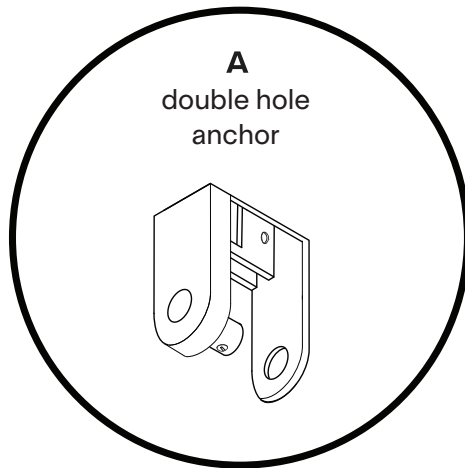

**Make sure to use appropriate  
anchors for ceiling material**

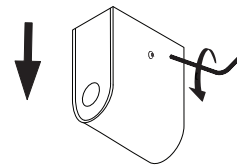

Remove or install  
cover by screwing and  
unscrewing set screw

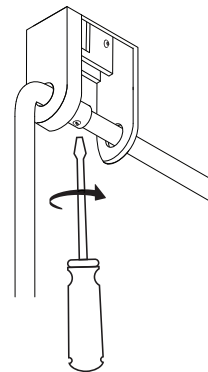
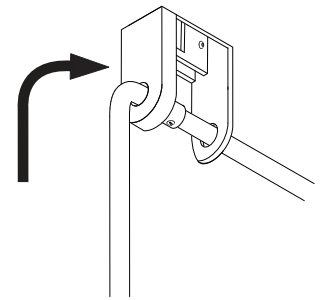
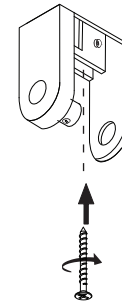

Screw gently, but firmly

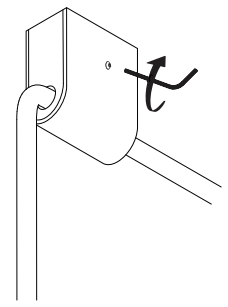
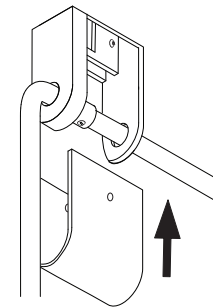



9

Mount single hole anchor  
with non-electrical cord

Pull wires to straighten them  
before mounting them.

B

single hole  
anchor

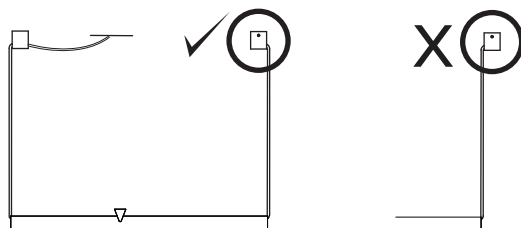
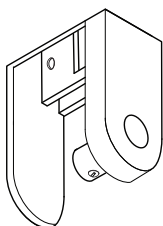

Make sure to use appropriate  
anchors for ceiling material

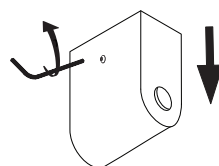
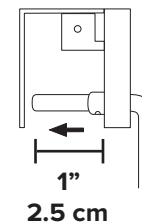

Remove or install  
cover by screwing and  
unscrewing set screw

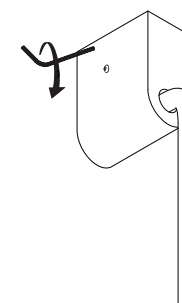
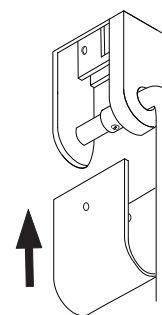
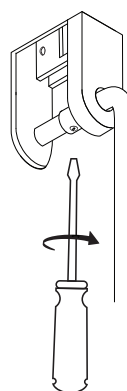
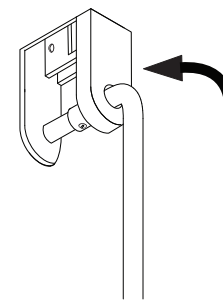
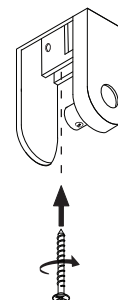

Screw gently, but firmly

Steps to be completed AFTER steps  
in recessed canopy annex

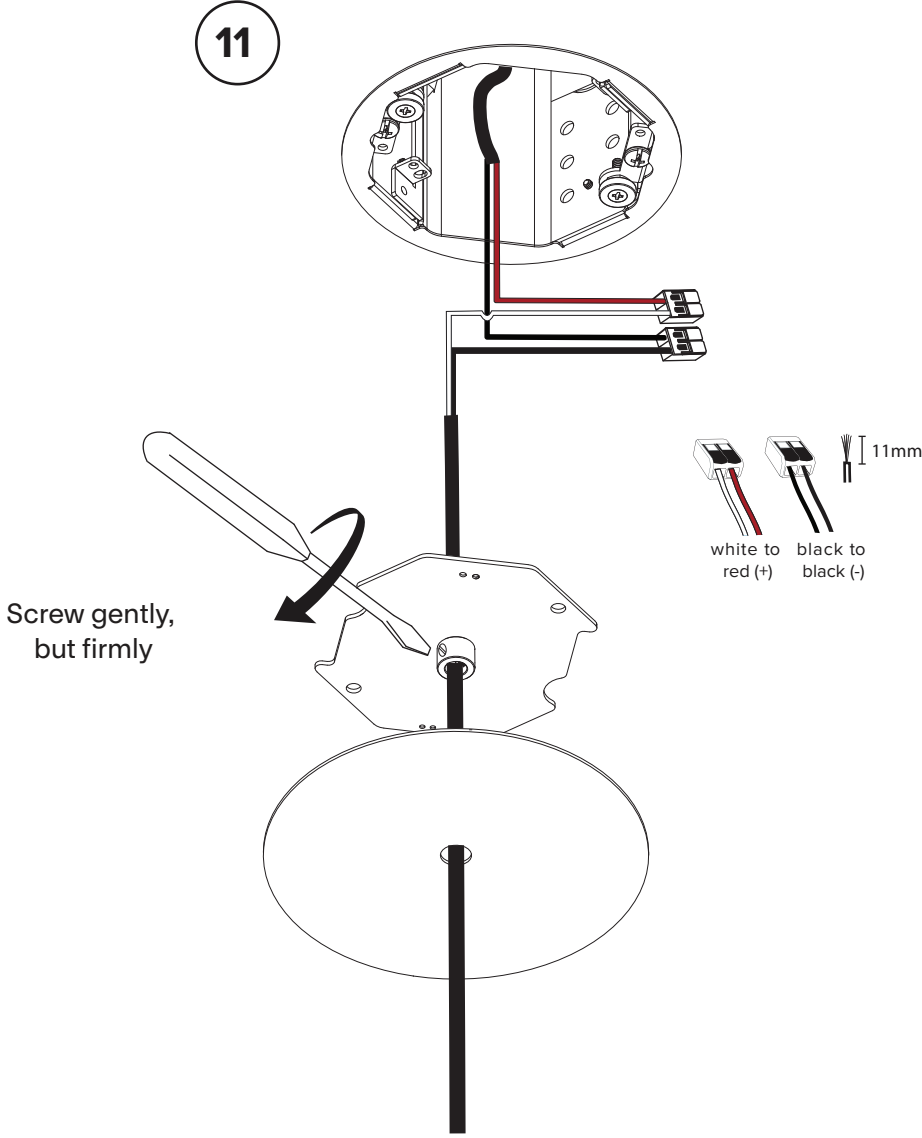
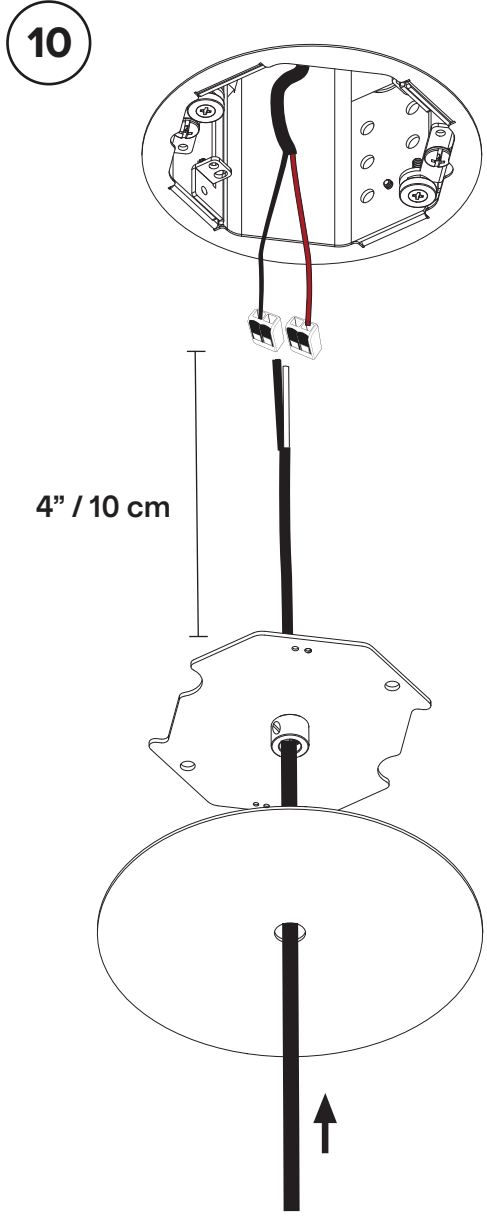

12

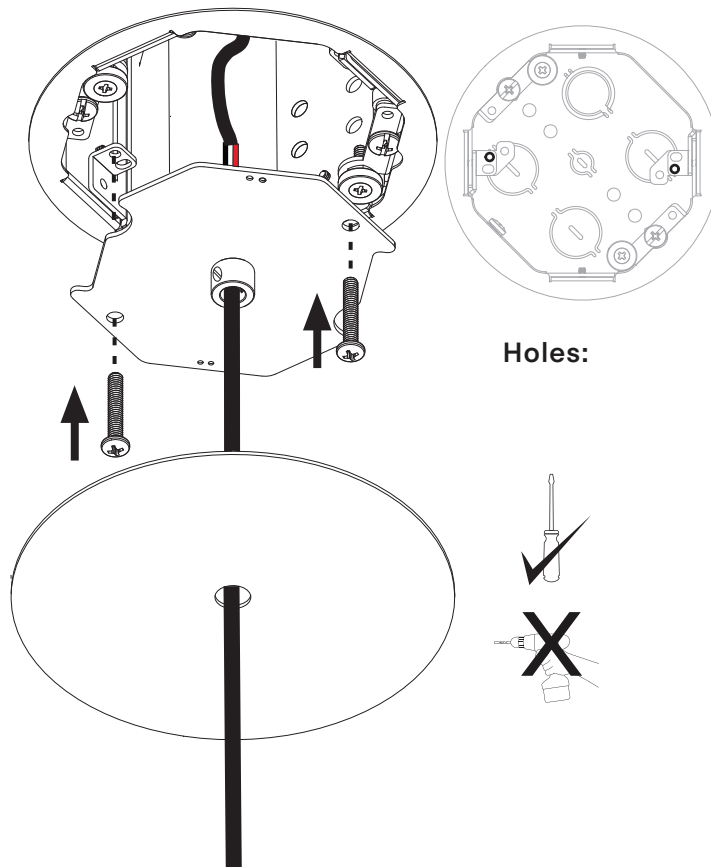

13

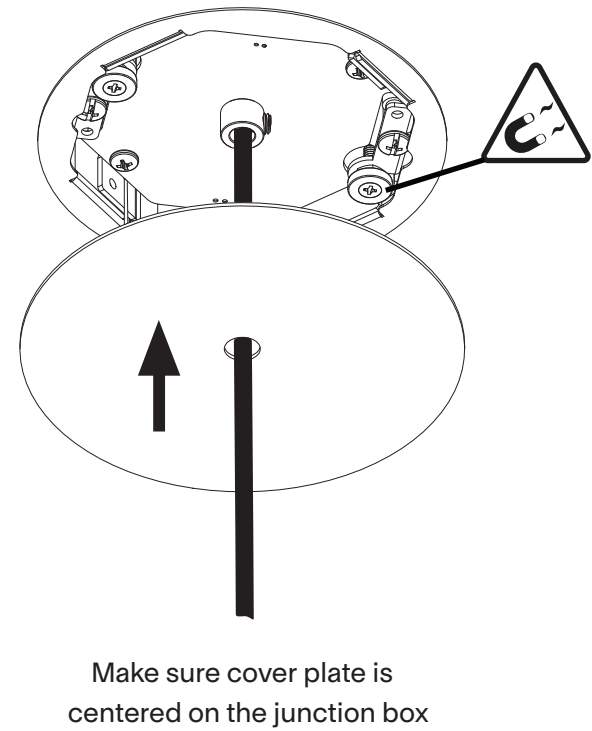

## Levelling the luminaire



Before adjusting wire length or interior weight, carefully attempt to balance the luminaire by hand. The wire's flex can allow micro adjustments of their own.

14

If necessary level downlight by adjusting length of wires

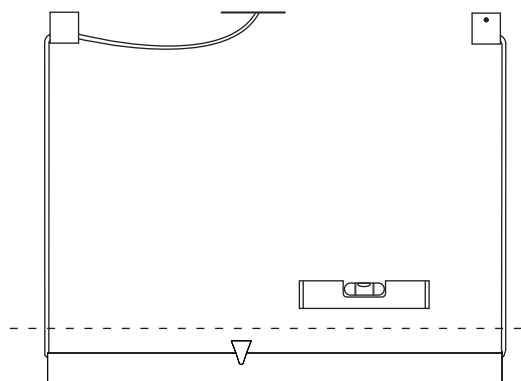

15

Should uplight adjustments be needed, remove endcap on short side arm

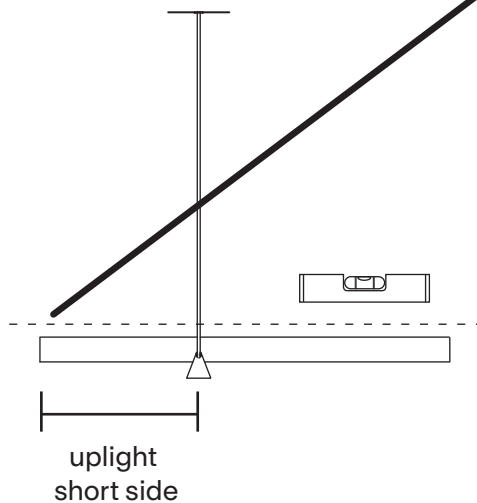

Endcap is held in place with a magnet

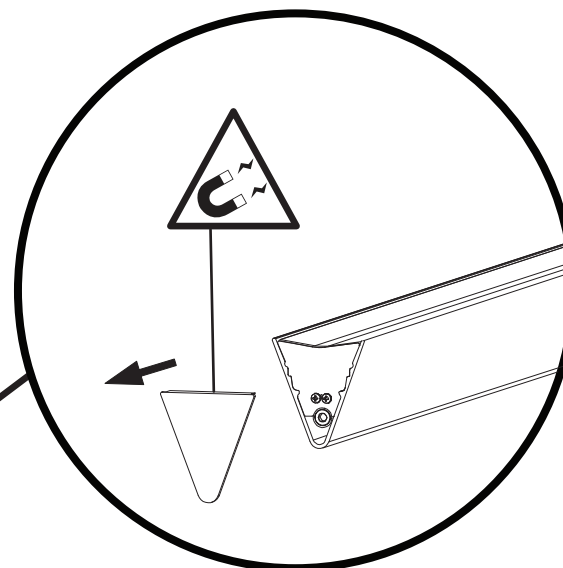

Be careful when removing endcap that it does not stick to other surfaces which could result in scratches in the paint.

16

The adjustment screw holding the balance weight is now visible.  
Use provided allen key to screw weight in or out depending on balance.



**Note that the endcap affects final balance of the luminaire!**

Luminaire will not appear balanced until the cap is in place.

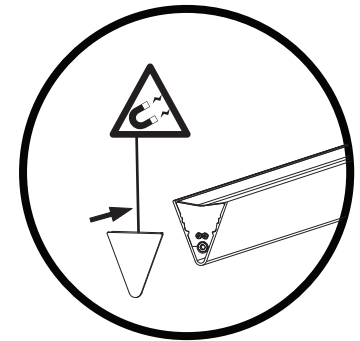
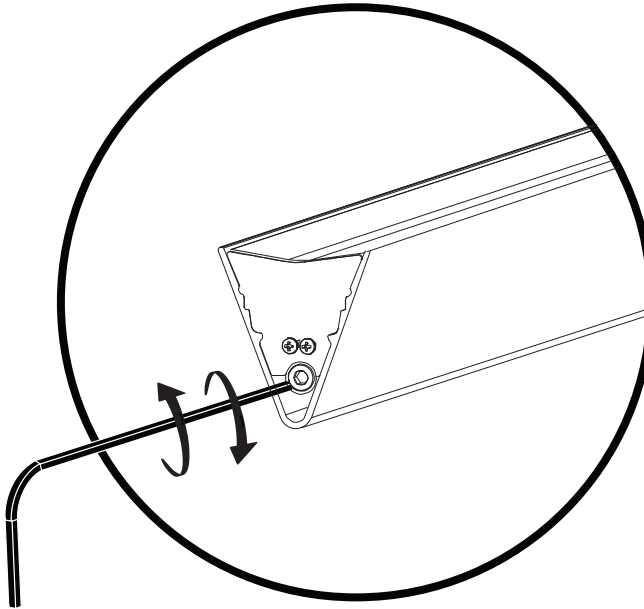

Replace endcap when adjustments are complete



Screw clockwise to pull weight towards you

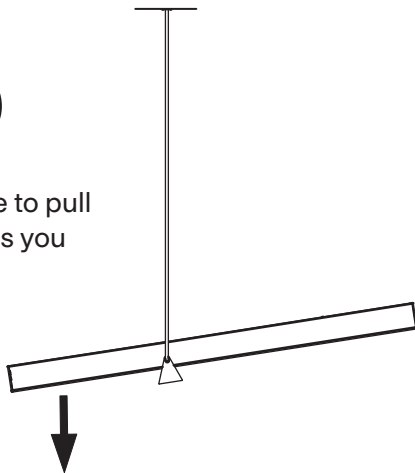

Screw counter-clockwise to push weight away from you

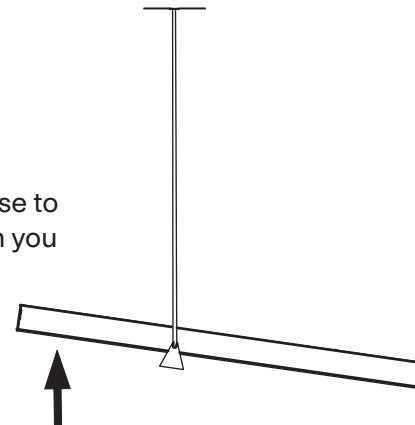

**Readjustments may be required as your luminaire settles and the wires flex**

## RECESSED CANOPY INSTALLATION

### Octobox with independent driver

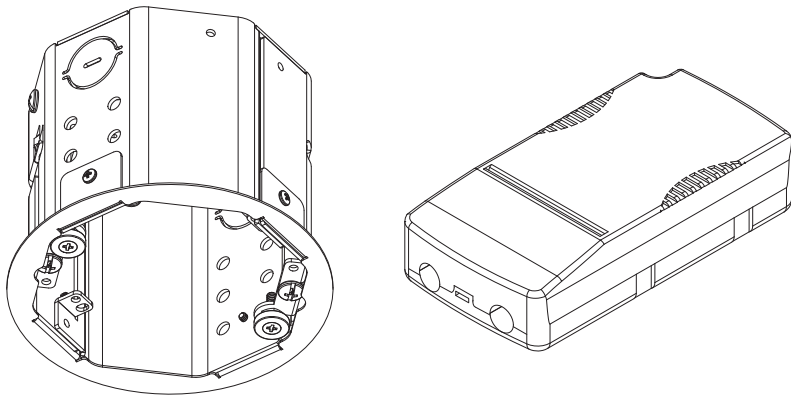

- Please read entire manual before beginning installation
- To be installed by an electrician
- Use appropriate screws where necessary
- For non-insulated hollow ceiling
- Wires for plenum not provided



For remote driver installation  
Consult chart below for max wire length.

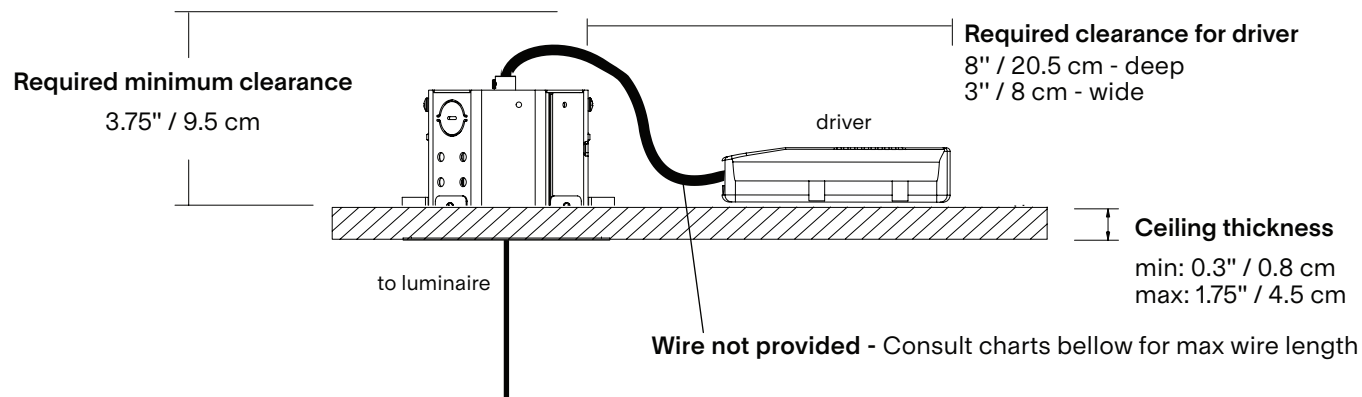

Distance between lamp and driver.

Wire gauge	Max Distance
18AWG	64.6 ft / 19.7m
16AWG	102.7 ft / 31.3m
14AWG	163.3 ft / 49.8m
12AWG	259.7 ft / 79.1m

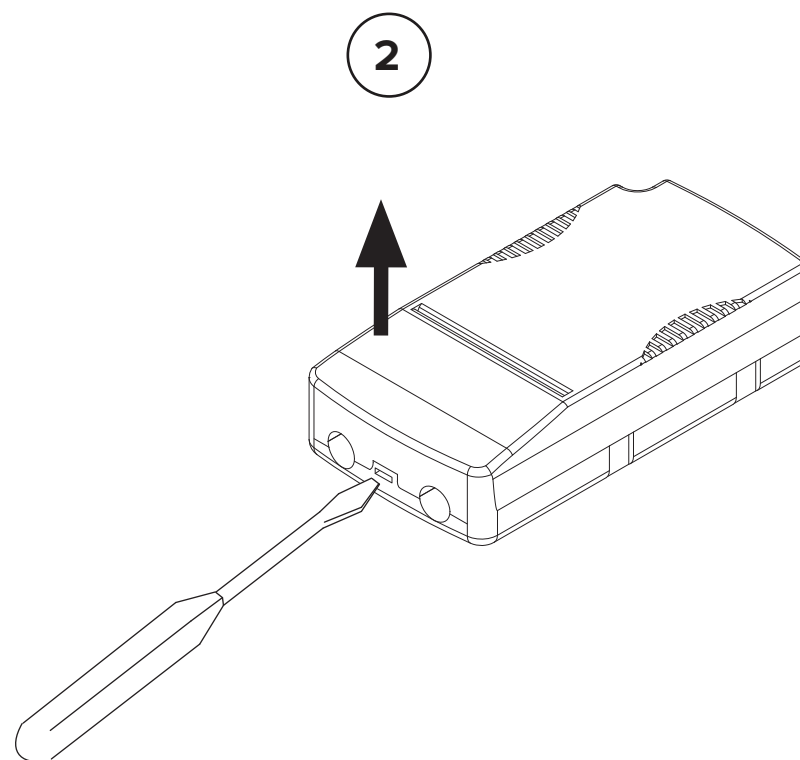
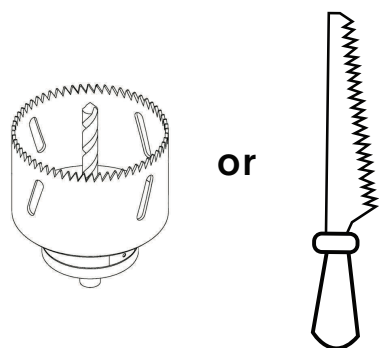
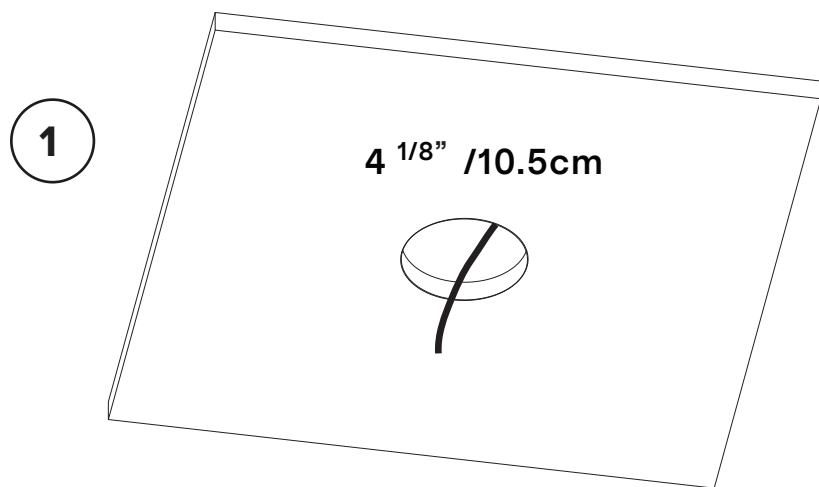

3

To luminaire  
(not provided)

from ceiling  
(not provided)

4

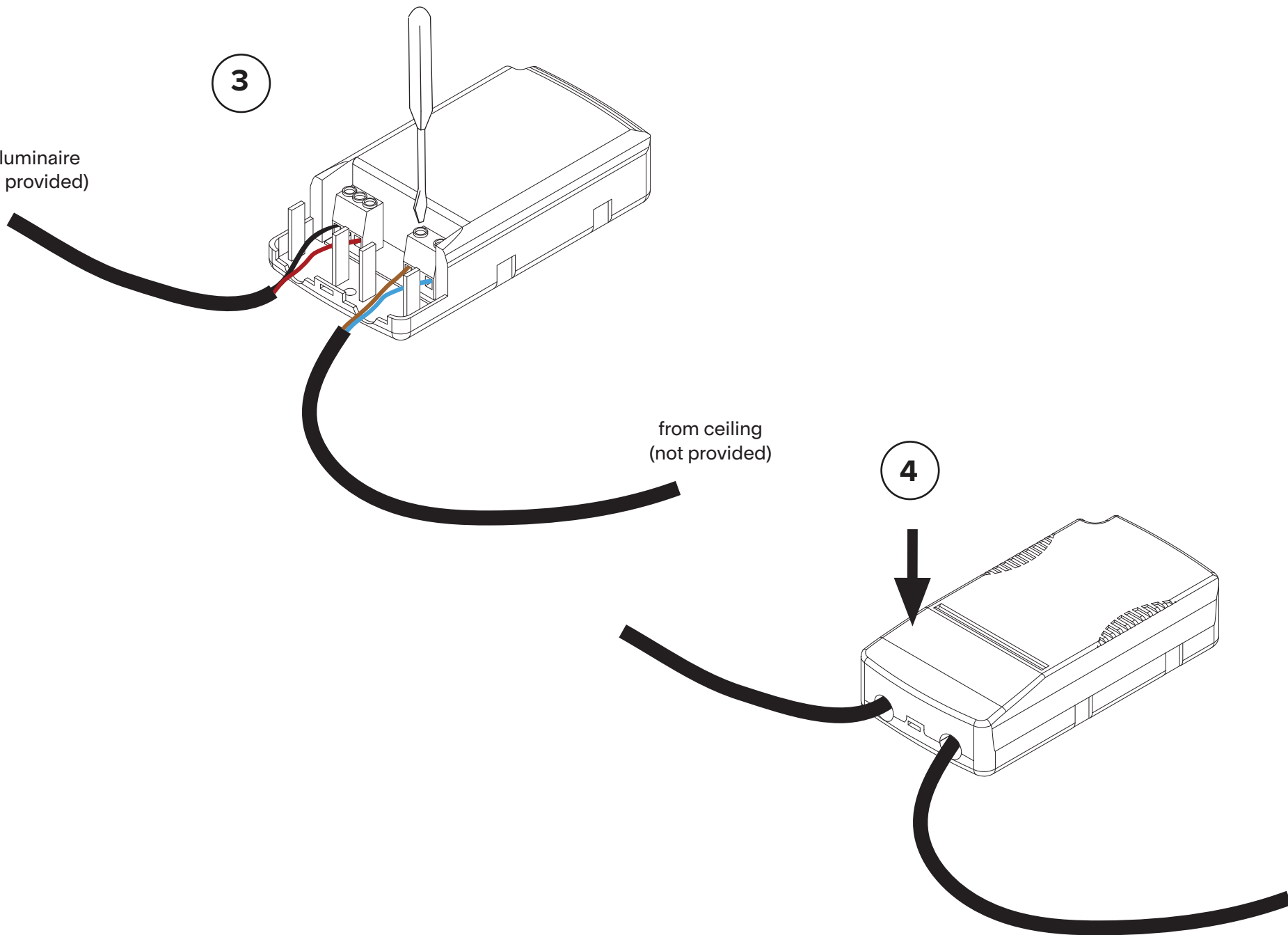



5

Remove desired knockout.

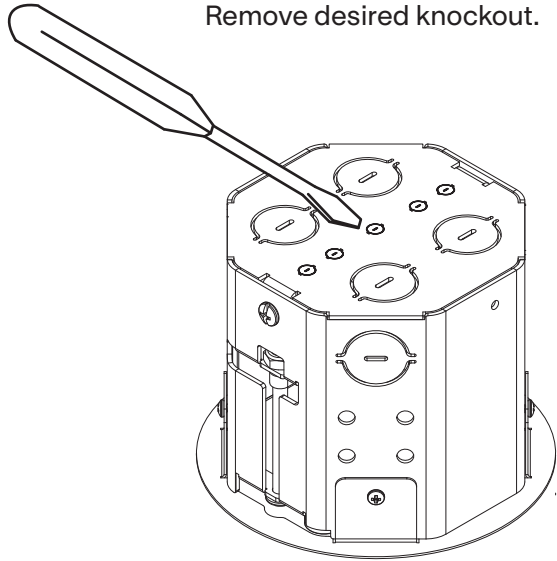

Use appropriate strain relief (not provided)  
depending on your wire gauge.

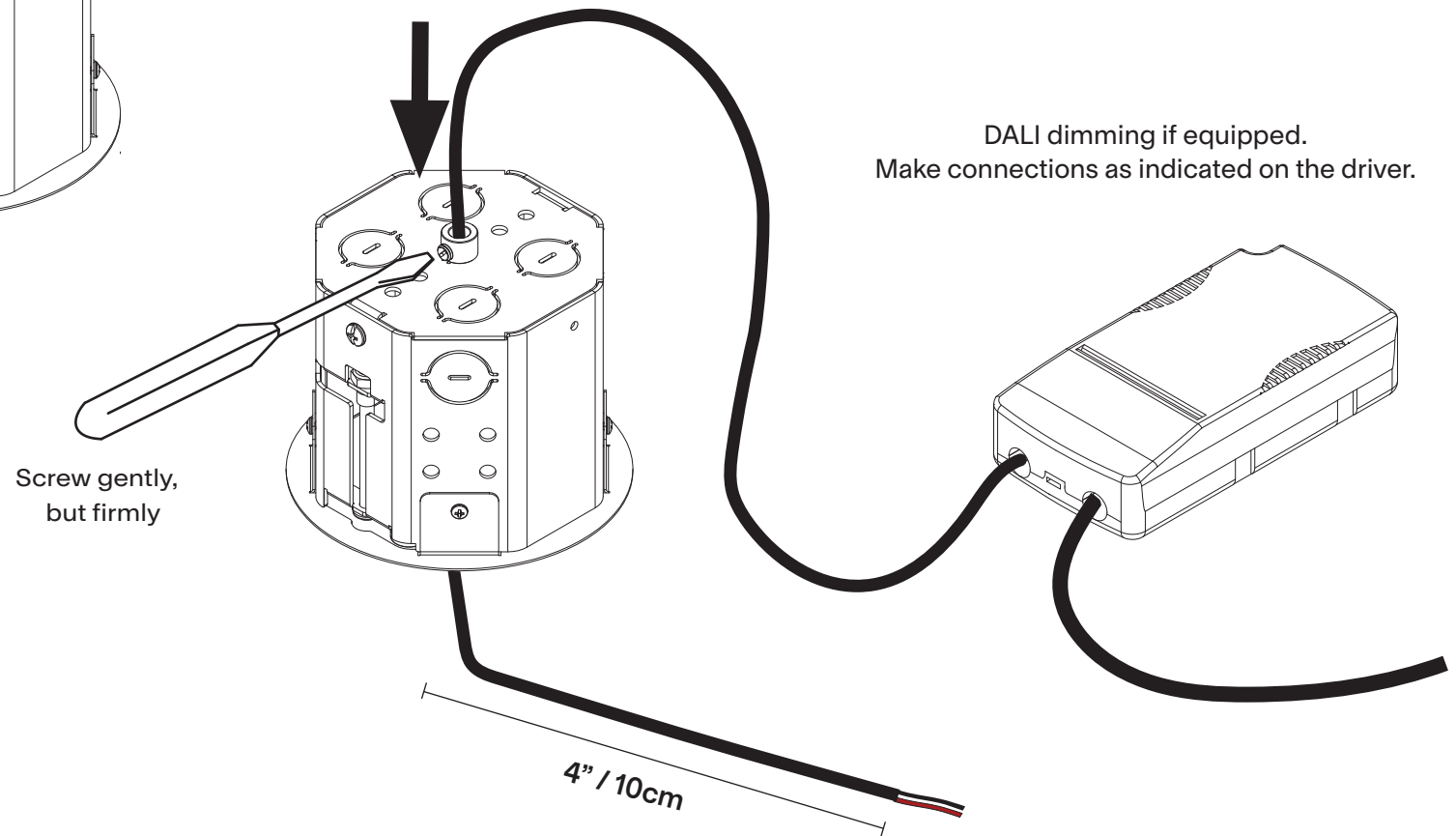

Screw gently,  
but firmly

DALI dimming if equipped.  
Make connections as indicated on the driver.

4" / 10cm

6

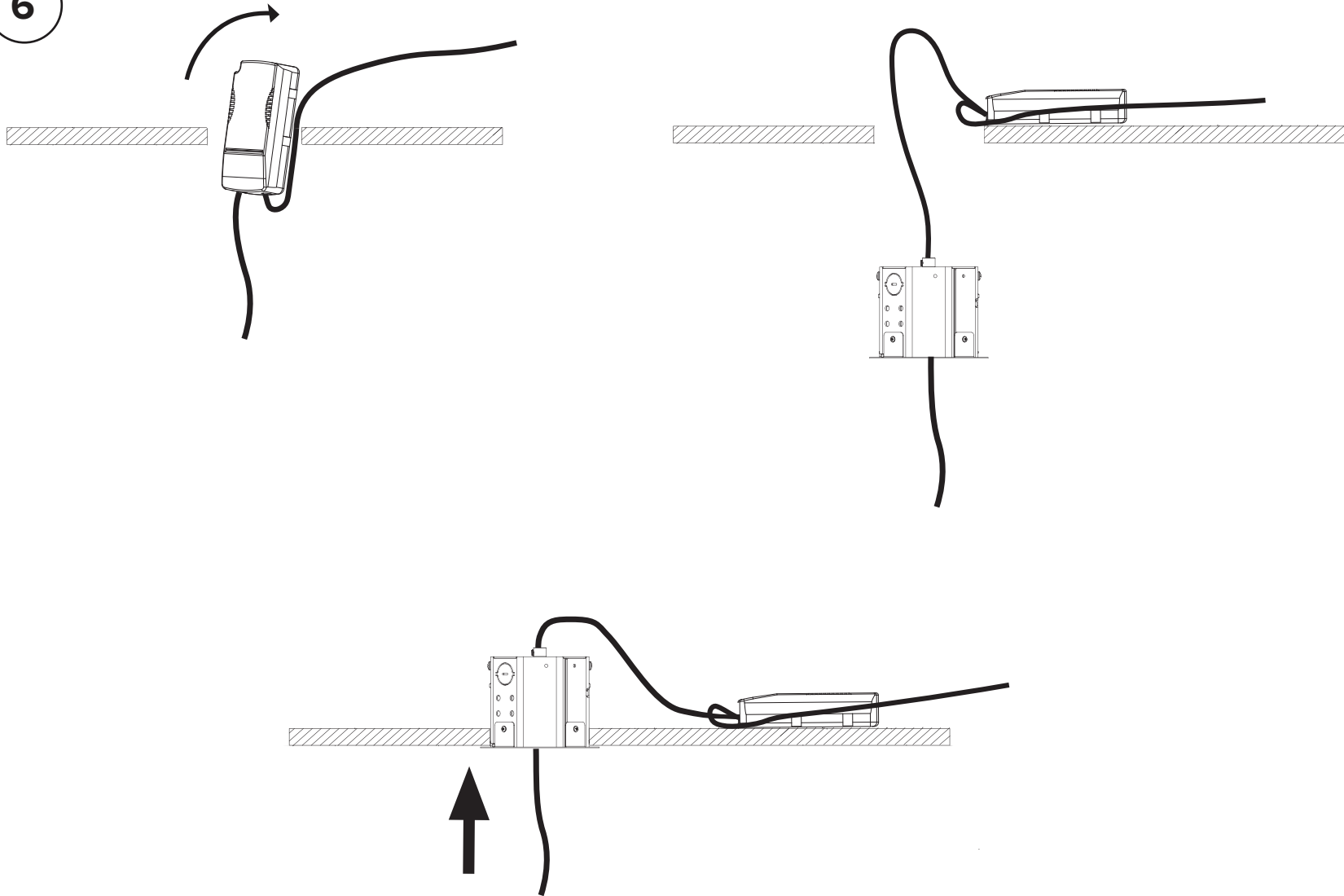

7

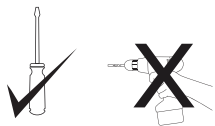
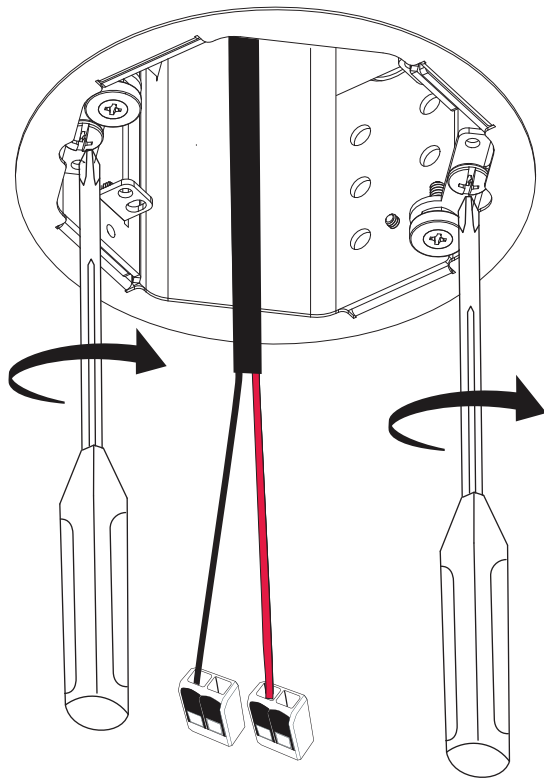

View from above

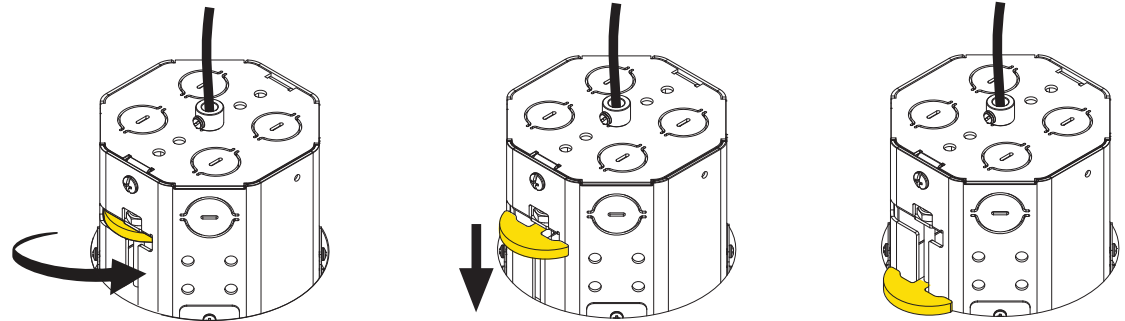

Stop when arms make contact with the surface

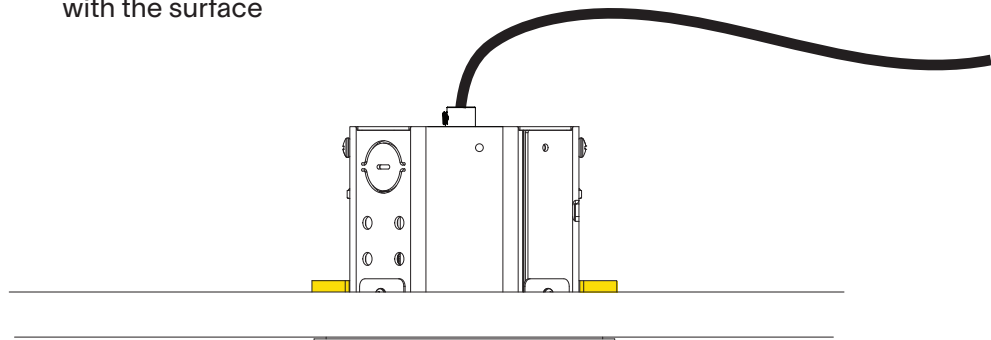

8

The recessed canopy is now installed, return to luminaire installation steps and follow the instructions (page 3).