

# LINARI

## WALL CONTROL

### Owner's Manual



#### PLEASE READ AND SAVE THESE INSTRUCTIONS FOR FUTURE USE.

- Make sure that all electrical connections comply with local codes, ordinances, the National Electrical Code and ANSI/NFPA 70. Hire a qualified electrician if you are unfamiliar with installing electrical wiring.
- **Note:** Refer to your ceiling fan owner's manual for safety and installation instructions.
- **Warning:** Do not exceed the maximum rating of the wall control. Install the wall transmitter away from excess heat or humidity
- This wall controller is designed for use exclusively with Linari ceiling fans and fan lights, and operates only on an AC 120V, 60Hz power supply.

Model #: WC100

Page 1

## Wall Control Wiring:

**Warning:** Before installation, turn the power off at the circuit breaker to avoid electrical shock. Installation must comply with local electrical codes.

**Note:** Before installing the wall control, turn the ON/OFF Switch to OFF

### Connect HOT (Live) Wire:

The Black AC IN L (HOT) wire from the house should be connected to the Black wire labeled "To AC IN L" on the wall control. This connection should pass through the outlet box.

### Connect Neutral Wire:

The White AC IN N (Neutral) wire from the house should be connected to the White wire from the fan receiver.

### Connect Receiver to Wall Control

The Black wire from the fan receiver should be connected to the Black wire labeled "To Motor L" on the wall control.

### Grounding:

Connect Green grounding wire to grounded wire from the outlet box.

**Note:** Refer to the wiring diagram for a visual guide. Make sure all wire nuts are securely fastened and no exposed copper is visible.

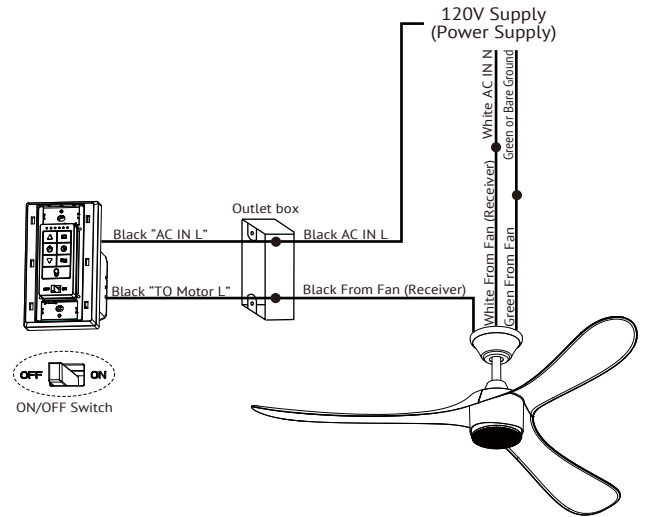

## Wall Control Installation:

### Mounting the Wall Control:

Secure the wall control into the outlet box using the machine screws provided in the package.

Align the control with the outlet box and tighten the screws until the unit is firmly fixed.

### Attaching the Face Panel:

Position the face panel over the wall control.

Gently press the panel into place until it clicks securely onto the base.

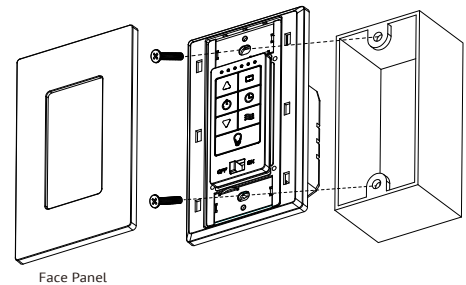

## Pairing Process:

Open the Front Panel by using a flathead screwdriver. Follow the below steps to pair your wall control to the fan.

- 1) Turn off the power to the ceiling fan for at least 30 seconds. Turn off the ON/OFF Switch on the wall control.
- 2) Turn the power back on to the fan, and turn on the ON/OFF switch. Wait for 5 seconds, then press and hold the "LEARN" button.
- 3) When the fan receives the "LEARN" signal, the fan will:
  - a. Spin for about 10 seconds
  - b. The light will blink, if applicable
- 4) Once paired, the fan will beep once.
- 5) Every fan can pair up to 2 remote controls.

You have 1 minute to complete the pairing process after turning the power back on. If 1 minute passes and the remote has not been paired, please start again beginning with Step 1.



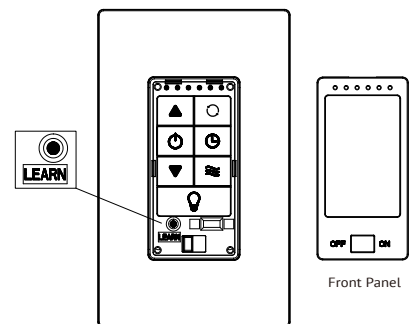

Alternatively, you can pair a remote to your ceiling fan using the Bond Home App.



**NOTE:** If you are installing/pairing more than one ceiling fan in an area, you must disconnect the power to all fans except the fan currently being paired.

Additionally, it is not possible to separately operate ceiling fans installed in the same area of remote control signal reach if they share the same power supply.

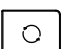
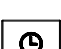
## Operation:

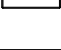
      	<p>Press this button to change the fan speed from low to high</p> <p>Press this button to stop the fan</p> <p>Press this button to change the fan speed from high to low</p> <p>Press this button to change fan direction, (forward/reverse) Note: This function only works when the fan is spinning. See Summer/Winter Mode instructions below.</p> <p>Press this button to set a timer to turn off the fan. (Press 1x = 1 hour, Press 2x = 2 hours, Press 3x = 3 hours, Press 4x = 4 hours, Press 5x = 6 hours, Press 6x = 8 hours)</p> <p>Press to turn on the natural breeze mode. <i>Note: With this function, your fan will alternate between various speeds to mimic the feel of a true natural breeze.</i></p> <p>Press this button turn your light ON/OFF. Press and hold to activate the light dimmer.</p>	<div data-bbox="987 304 1430 590"> <div>LED Indicator</div> <div>Speed Up</div> <div>Fan Off</div> <div>Speed Down</div> <div>Forward/Reverse</div> <div>Timer</div> <div>Natural Breeze</div> <div>Light ON/OFF, Dimmer</div> <div>ON/OFF Power Switch</div> </div> <p>NOTE: Changes to speed and timer selections are reflected on the LED indicator at the top of your wall transmitter.</p>
---	--	---

**Note:** Your ceiling fan will maintain the last setting if turned off by the on/off wall switch. If your fan automatically operates after installation and turning on the power, it is because your fan has still memorized the previous setting at the factory.

**Note:** Your ceiling fan is equipped with an energy saving DC motor. When your ceiling fan is turned on or you are operating the forward/reverse function, it will take a moment for the magnets in your DC motor to align before performing the function. This will appear as a slight shutter back and forth and is completely normal.

**Lock Protection:** The DC motor has a built-in safety feature against blade or motor obstruction during operation. If something obstructs the fan blades or motor, the motor will try 5 times to continue normal operation and then stop operation after about 30 seconds of interruption. Please remove obstacles and reset by turning the fan off, waiting 5 seconds, and turning it back on.

**Over Load Protection:** Your ceiling fan will immediately stop if the receiver detects an abnormal increase in motor power consumption.

### Summer / Winter Modes:



Use the forward/reverse button to change the fan direction. *This function only works when the fan is spinning.*

#### SUMMER MODE / FORWARD:

This creates a **downward** airflow, which has a cooling effect on those in the room. You can set your air conditioner at a warmer temperature without affecting your comfort.

#### WINTER MODE / REVERSE:

The fan will spin in a clockwise direction. This creates an **upward** airflow, and the gentle updraft produced will force warm air near the ceiling down into your space. You can comfortably adjust your heating unit to a cooler setting and benefit from energy and cost savings.

**Note:** Turn your ceiling fan off if the room is unoccupied to conserve energy and save money.

# LINARI

1930 Innovation Way, Suite 160  
Libertyville, IL 60048  
+1 224 633 1422  
[hello@linarifans.com](mailto:hello@linarifans.com)