

1 Remove the stem and the canopy box
Retirer le tuyau et la boîte de la canopée

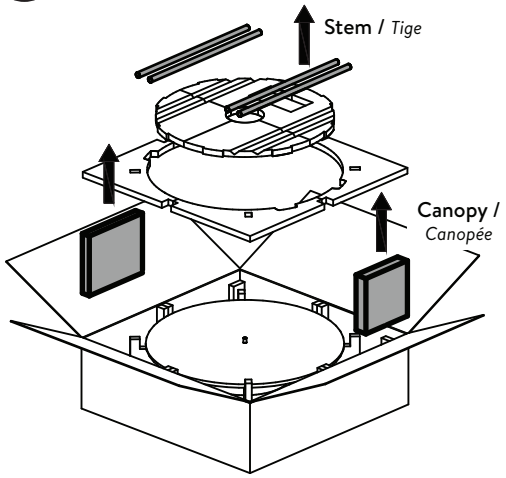

3

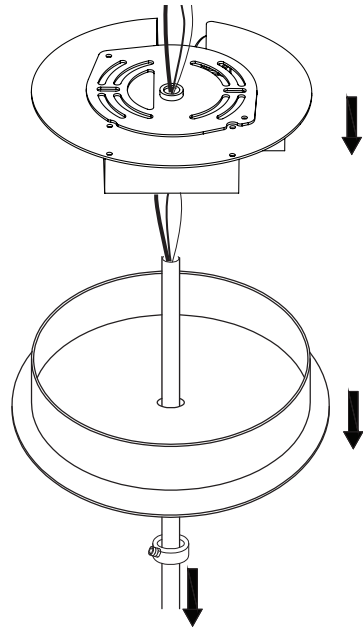

2 Screw the stem on the fixture while it's in the box
Vissez la tige au luminaire directement dans la boîte

4

! Ensure it is fully screwed. Failure to do so may compromise safety.
Assurez-vous ce soit complètement vissé. Le non-respect de cela peut compromettre la sécurité.

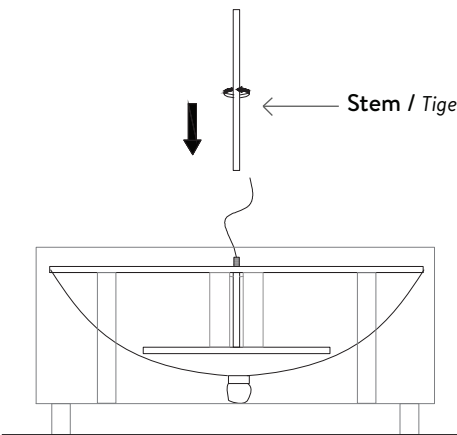

! Ensure it is fully screwed. Failure to do so may compromise safety.
Assurez-vous ce soit complètement vissé. Le non-respect de cela peut compromettre la sécurité.

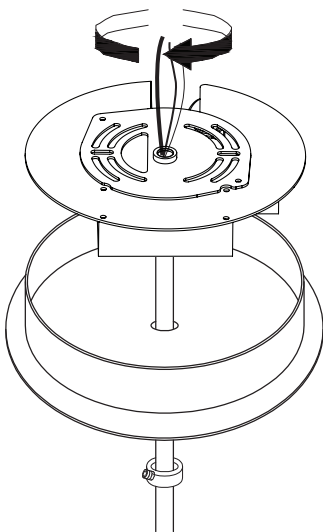

5

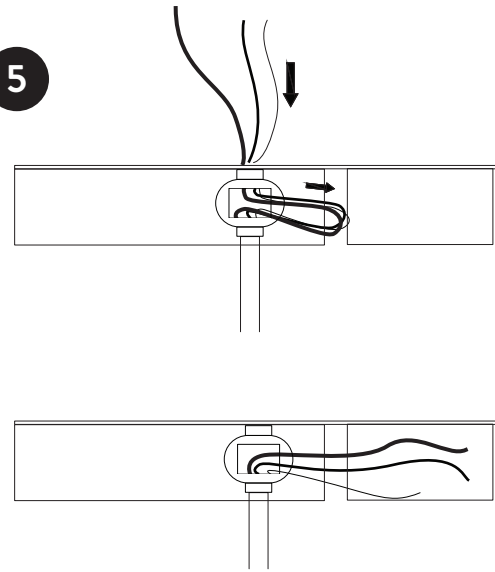

6

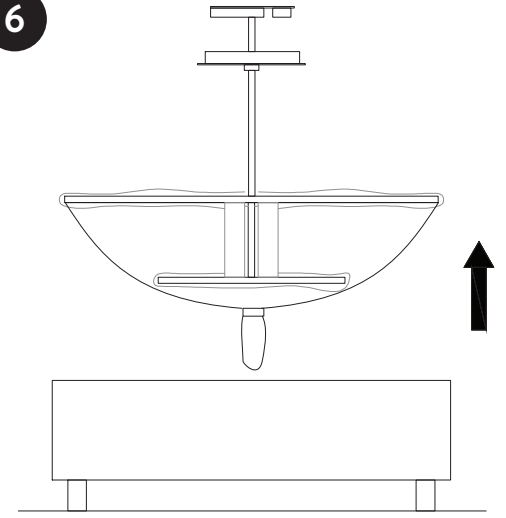

NEVER HOLD THE FIXTURE ON THE SIDE. IT WILL AUTOMATICALLY BREAK THE STEM
NE JAMAIS TENIR LE LUMINAIRE SUR LE CÔTÉ. CECI VA AUTOMATIQUEMENT BRISER LA TIGE

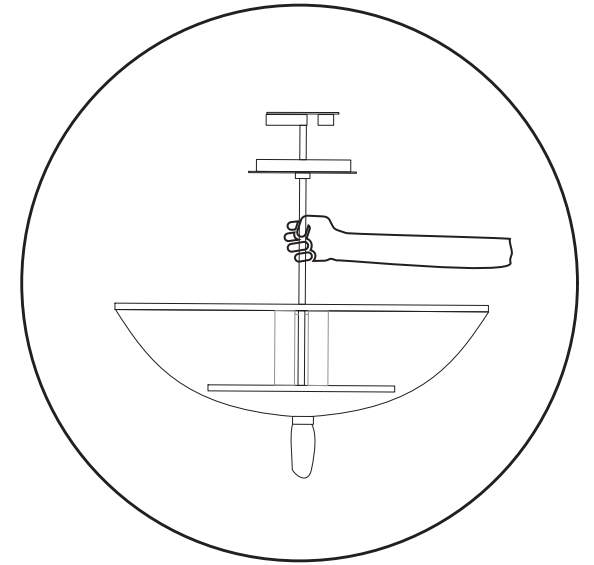
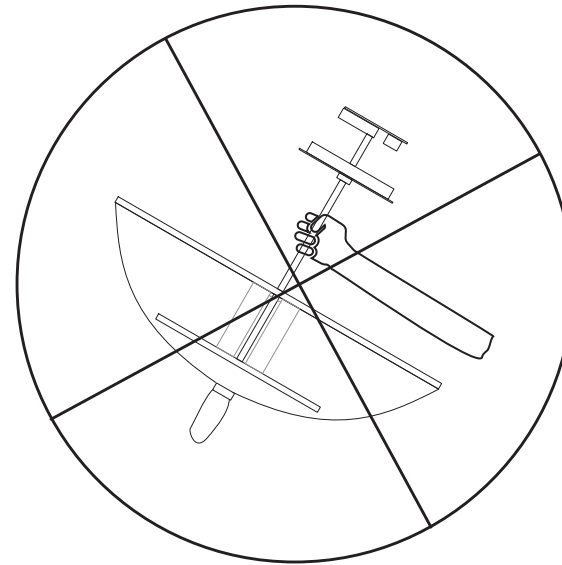

7

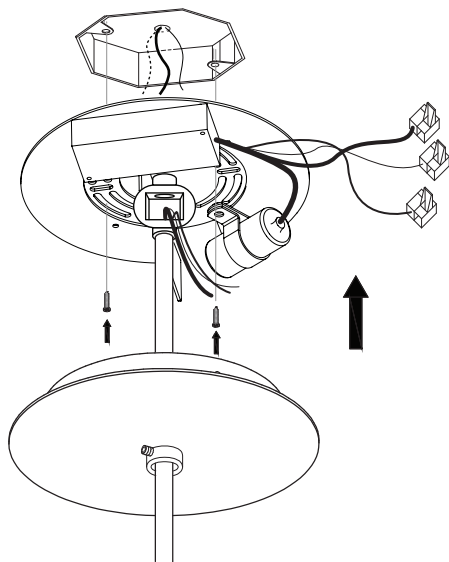

8

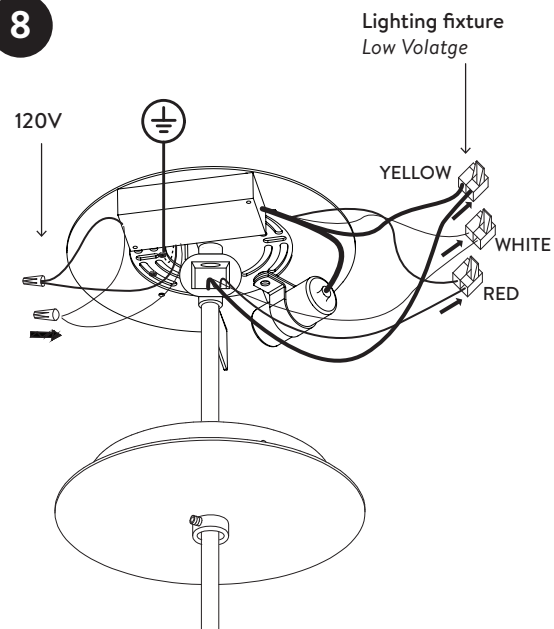

9

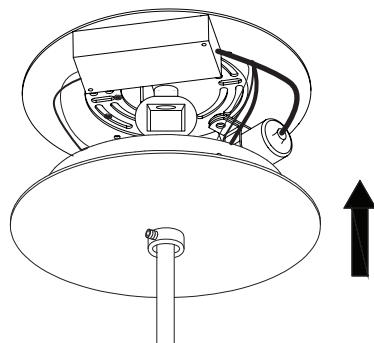

10

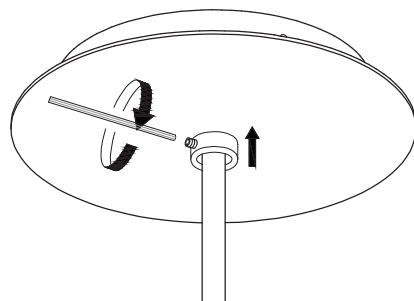

11

Gently unpack the fixture
Déballiez soigneusement le luminaire

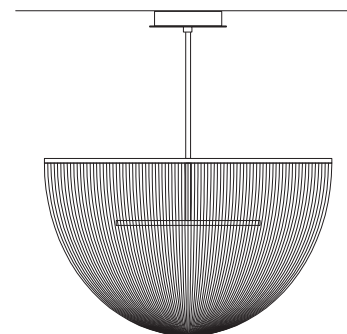

or/ou



or/ou

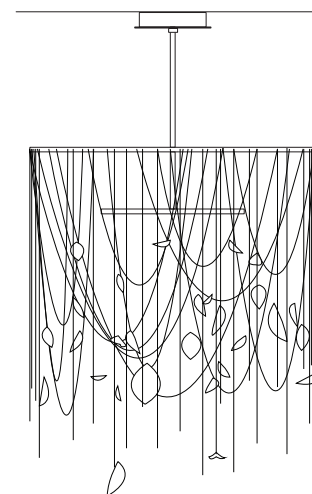

LAROSE GUYON

CAUTION / ATTENTION



- Before starting, turn off power at main circuit panel / *Couper l'alimentation avant à l'installation.*
- Use appropriate screws and anchors / *Utiliser les vis et les ancrages appropriés*
- Wear gloves when handling lamp and handle materials with care / *Portez des gants lors de la manipulation de la lampe et manipulez les matériaux avec précaution.*



MIN.

NOTES

LAROSE GUYON recommends that the lighting fixtures be installed by a professional. LAROSE GUYON is not responsible or liable under any circumstances for misfortunes and/or accidents that may occur due to the installation of their products. / *LAROSE GUYON recommande fortement l'utilisation des services d'un professionnel pour l'accrochage et l'installation de tous les luminaires. LAROSE GUYON n'est pas responsable, en aucun cas, des accidents dus à l'installation de leurs produits.*

ASSEMBLY / ASSEMBLAGE

Céleste