

# Katie Wall

LW1011, LW1022 1.0

GENERATION LIGHTING

## Wall

### GENERAL PRODUCT INFORMATION:

These fixtures are intended to be installed utilizing NEC compliant junction boxes.

This product is safety listed for damp locations.

Incandescent lamps may be dimmed with a standard incandescent dimmer. LED lamps may be dimmed with a LED dimmer. Consult lamp manufacturer for additional information.

This instruction shows a typical installation.

**CAUTION - RISK OF FIRE**  
 This product must be installed in accordance with the applicable installation code by a person familiar with the construction and operation of the product and the hazards involved.  
 Use minimum 90°C supply conductors.

GENERATION LIGHTING

7400 Linder Ave, Skokie, IL 16077

800.969.3347

[www.generationlighting.com](http://www.generationlighting.com)

© 2019 Generation Lighting. All rights reserved.  
 The "Generation Lighting" graphic is a registered trademark of Generation Lighting. Generation Lighting reserves the right to change specifications for product improvements without notification.

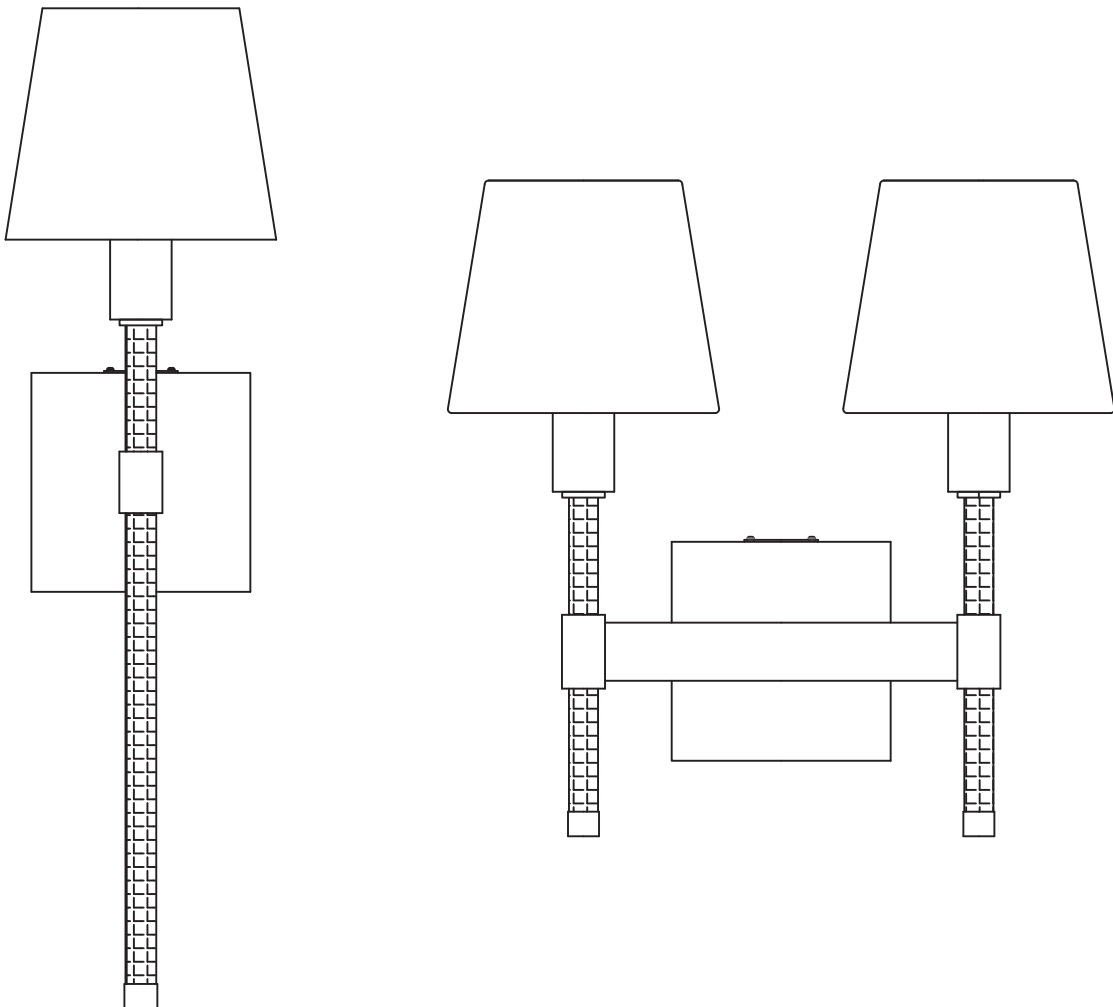

**SAVE THESE INSTRUCTIONS!**

## Install the Fixture

IA

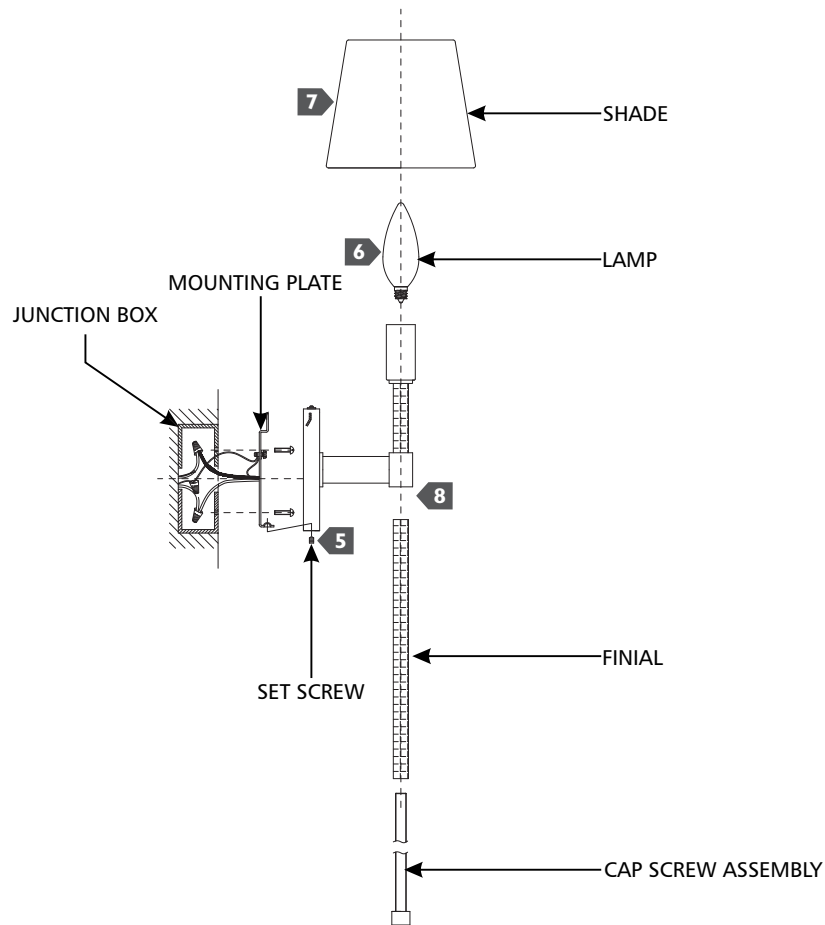

- 1 Secure the mounting plate to the junction box.
- 2 Connect the fixture ground wire to a suitable ground in accordance to local electrical codes.
- 3 Connect the white fixture wire to the neutral power line wire with a wire nut.
- 4 Connect the black fixture wire to the hot power line wire with a wire nut.
- 5 Properly place all wires and wire nut connections into the junction box/fixture base, mount the fixture onto the mounting plate, and secure it in place with the set screw using an Allen wrench.
- 6 Screw the lamp(s) into the socket(s). Refer to the label on the lamp socket for Max Wattage information.
- 7 Install the shade by placing it over the lamp. Repeat for remaining shades.
- 8 Install the finial to the bottom of the fixture and secure it in place using the cap screw assembly ensuring that the seam of the finial faces the backplate for best appearance. **NOTE: Model LW1011 has two finial options, 1 long and 1 short. Use the desired finial for installation.**