

INSTALLATION INSTRUCTIONS

Item# N3424-870A

READ AND SAVE THESE INSTRUCTIONS

WARNING! SHUT POWER OFF AT FUSE OR CIRCUIT BREAKER.
VERTISEMENT! COUPER LE COURANT AU NIVEAU DES FUSIBLES OU DU DISJONCTEUR.

ASSEMBLING THE FIXTURE (Fig.1)

1. Shut off power at the fuse box or circuit breaker box and remove the old fixture including the mounting hardware.
2. Carefully unpack your new fixture and lay out all the parts in a clean area. Take care not to misplace any small parts necessary for installation.
3. Thread the center rod (K) on the frame coupler then secure the loop (J).

HANGING THE FIXTURE (Fig.2)

4. Thread all thread (D) with hex nut (E) into ceiling loop (F) until snug.
5. Thread the other end of all thread (D) onto crossbar (A) with lock washer (B) and hex nut (E). Note: The Length of all thread (D) into crossbar (A) may be adjusted if necessary.
6. Take the crossbar assembly and mount to junction box (JB) (*not provided*) with mounting screws (C).
7. Open quick link (G) and connect to fixture loop (J).
8. Slip collar ring (I) and canopy (H) over quick link (G) to rest on fixture loop (J).
9. Connect quick link (G) to ceiling loop (F), then close quick link (G).
10. Feed fixture wires through quick link (G), ceiling loop (F) and crossbar assembly.

CONNECTING THE WIRE (Fig. 3)

11. Connect the electrical wire as shown in Fig. 3, making sure that all the wire connectors are secured. If your junction box has a ground wire (green, or bare copper), connect fixture's ground wire directly to crossbar using green screw provided.
12. Tuck wire connections neatly into junction box (JB). Fig.2.
13. Raise the canopy (H) over ceiling loop (F) and secure with collar ring (I)

ACCESSORIES INSTALLATION (Fig. 1)

14. To begin installing the accessories unwrap the ceramic leaf (M) from the packing.
15. Place the hole of the ceramic leaf (M) into the headless screw of the frame (L) and secure with ball nut (N) and washer provided. Do not over tighten.
16. Repeat the process until completed.

FINISHING THE FIXTURE (FIG. 1)

17. Install (4) four candelabra base bulbs up to 60 watts each or CFL or LED equivalent (not included) in accordance to fixture specifications.

DO NOT EXCEED THE MAXIMUM WATTAGE RATING!
(NE PAS DEPASSER LA PUISSANCE NOMINALE MAXIMALE!)

Your installation is now complete. You can now turn the power ON and test the fixture.

Note: Illustration (Fig. 1) on this manual is for installation purposes only. It may or may not be identical to the fixture purchased.

FIG. 1

Set # A-012A
-Crossbar
-Mounting Screw x 2
-Ground Screw

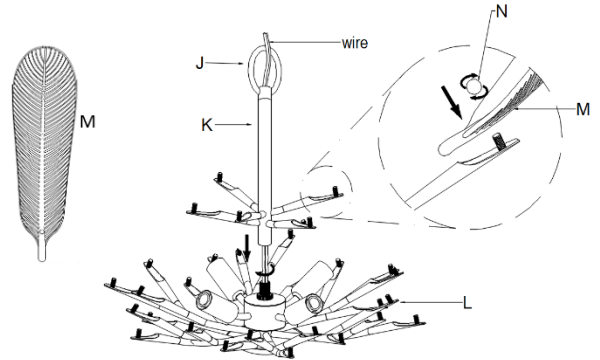

FIG. 2

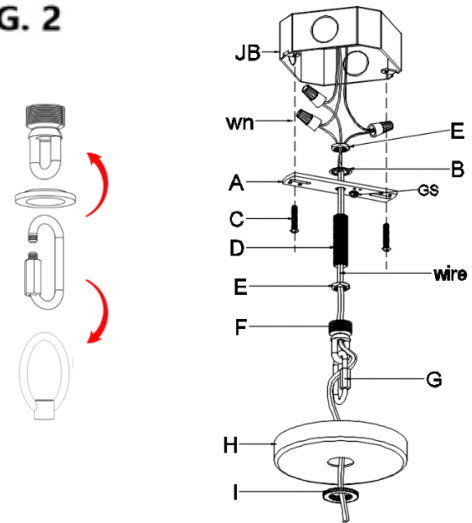

Fig. 3

