

Cinema-LED Pendant

PD-30803R/PD-30805R/PD-30809R/PD-30815R/PD-30821R

CAUTION: To prevent electrical shock, ensure electricity has been turned off at the circuit breaker before beginning.

- Read all instructions before installing.
- System is intended for installation by a licensed electrician in accordance with the National Electrical Code (NEC) and local regulations.
- When handling the fixture, do not apply pressure to the LEDs. Hold the fixture by the base only.
- Retain installation instructions for future maintenance reference.

WARNING: All parts must be used as indicated in these instructions. This product is designed for use only with the supplied parts and/or accessories designated for use by Modern Forms. Substitution of parts or accessories not designated for use with this product by Modern Forms could result in personal injury or property damage, and will void the warranty. Contact an authorized dealer or the manufacturer if any parts are damaged or missing.

MAINTENANCE NOTE: Coastal conditions may cause mineral and residue build-up on the fixture. We recommend that customers in coastal areas clean all external surfaces of the fixture once every two weeks with a wet cloth.

MISE EN GARDE: Pour éviter tout choc électrique, assurez-vous que le disjoncteur soit mis hors tension avant de commencer.

- Lisez toutes les instructions avant l'installation.
- Le système doit être installé par un électricien licencié conformément au code national de l'électricité (NEC), et également aux règlements locaux.
- Lors de la manipulation du luminaire, n'appuyez pas sur les LED. Tenez-le uniquement par la base.

ATTENTION: Toutes les pièces doivent être utilisées comme indiqué dans ces instructions. Ce produit est conçu pour être utilisé seulement avec les pièces et/ou accessoires fournis pour être utilisés avec les produits Modern Forms. Remplacer des pièces ou accessoires non conçus pour ce produit Modern Forms pourrait causer des dommages corporels ou matériels et pourrait également causer l'annulation de la garantie. Veuillez contacter un revendeur autorisé ou le fabricant si des pièces manquent ou sont endommagées.

NOTE D'ENTRETIEN: Les conditions côtières peut causer une accumulation de minéraux et de résidus sur le luminaire. Nous recommandons aux clients qui résident dans les zones côtières de nettoyer toutes les surfaces externes du luminaire une fois toutes les deux semaines avec un chiffon humide.

HARDWARE



Wire Connector
Qty: 3pcs+1 Extra



Canopy Screw
Qty: 1 Extra



Anchor Screw
Qty: 7pcs



Plastic Anchor
Qty: 7pcs

PD-30803R/PD-30805R/PD-30809R/PD-30815R/PD-30821R

U.L. Approved 100LB. Max.
Outlet Box and Hardware
(Sold Separately)

The diagram illustrates the assembly of the RPL-GLA-30816 Bubble Crystal chandelier. It shows the following components and their assembly sequence:

- Top Components:** Junction Box, Wire Connector (A), Plastic Anchor (D), Mounting Back Plate, and Junction Box Screw.
- Canopy Assembly:** The canopy is attached to the mounting back plate using Canopy Screws (B) and Anchor Screws (C).
- Electrical Components:** The 4CCT Switch and Driver are connected to the wiring within the canopy.
- Fixture Assembly:** The fixture is attached to the canopy using a Fixed Stud and a Fixed bracket.
- Adjustment:** A cable gripper is used to adjust the wire length by pushing the cable gripper on the canopy and pulling the wire as desired.
- Final Product:** The completed chandelier, labeled Bubble Crystal (RPL-GLA-30816), is shown hanging from the ceiling.

(Sold Separately)

Junction Box

A Wire Connector

D Plastic Anchor

Safety Cable

Switch Cover

Mounting Back Plate

Anchor Screw

Canopy

C Junction Box Screw

B Canopy Screw

4CCT Switch Driver

Push up

Cable-gripper

Instruction: Adjust the fixture wire length by pushing the cable gripper on the canopy and pulling the wire as desired.

Fixed Stud

Fixture

Fixed bracket

Bubble Crystal (RPL-GLA-30816)

PD-30815R/PD-30821R

A diagram of a DNA double helix structure. It shows two strands twisted around each other, with horizontal rungs representing base pairs. The structure is shown in a perspective view, tapering towards the top.

Fixture Wires Black or Smooth	House Wires Black (Live)
Fixture Wires White or Ribbed	House Wires White (Neutral)
Fixture Wires Bare wire (Ground)	House Wires Green or Bare Copper (Ground)

The diagram illustrates the wiring for a 12V LED strip lighting system. A power source (battery) is connected to a driver. The driver has an 'Input' terminal connected to the positive terminal of the power source and an 'Output' terminal connected to the positive terminal of the LED strip. The negative terminal of the LED strip is connected to the negative terminal of the power source. The LED strip is shown with various colored LEDs: Pink or Gray - Dim-, Purple - Dim+, Black - Live, and White - Neutral. The LED strip is connected to a canopy, which is shown with various colored LEDs: Brown (C), Bare (W), White (C), Green (+), and Black (-). The canopy is connected to the LED strip via a series of wires.

Diagram illustrating the wiring connections for a 12V LED strip lighting system, showing the connection of a power source, a driver, and a canopy with various colored LEDs.

Power Source Connections:

- Black (-)
- Blue (W)
- Brown (C)
- Bare (W)
- White (C)

Driver Connections:

- Output
- Input
- Black - Live
- White - Neutral

LED Strip Connections:

- Pink or Gray - Dim-
- Purple - Dim+
- Black - (-)
- Red (+)
- Green (+)

Canopy Connections:

- Black (-)
- Blue (W)
- Brown (C)
- Bare (W)
- White (C)
- Green (+)

Western Distribution Center
1750 Archibald Avenue
Ontario, CA 91760



Cinema-LED Pendant

PD-30803R/PD-30805R/PD-30809R/PD-30815R/PD-30821R

PREPARATION

1. Shut off the power at the circuit breaker and remove existing fixture, including the crossbar.
2. Carefully unpack your new fixture and lay out all the parts in a clear area. Be careful not to lose any small parts necessary for installation.

MOUNTING THE FIXTURE (Fig. 1)

3. Remove the fixture, loosen the fixing stud, take out the fixed bracket, align the slot of the bubble crystal with the hook of the fixing bracket, so that the crystal is firmly closed to the fixture, and then tighten the fixing stud.
4. Remove the canopy screw (B) from the ceiling plate.
5. The lamp can switch between four color temperatures (2700K-3000K-3500K-4000K), which can be adjusted to your preference with the switch in the canopy (Fig.3).

Note: The switch comes with a detachable switch cover, remove the switch cover prior to adjusting the color temperature, reattach the switch cover after adjustment is made.

6. Adjust the fixture wire length by pushing the cable gripper on the canopy and pulling the wire as desired.
 - a) Before securing the canopy in place, it is recommended to retract or extend the wire within the canopy to a desirable length.
 - b) Due to limited room within the canopy, shorten excess wires as necessary to make the installation easier. Make sure to identify and label all the wiring properly before any trimming/shortening. (Fig. 3 , Fig. 4)
7. Drill holes in the ceiling aligned with the key holes located in the ceiling plate. Insert the plastic anchors (D).
8. Recommended to use UL approved outlet box and hardware as indicated in Fig. 1 (sold separately). If standard duty JB is used, ensure fixture is adequately supported independent of the JB to secure the fixture to carry the weight.
9. Secure the ceiling plate to the junction box using the original junction box screws. Fasten the plate to the ceiling with the plastic anchors using the anchor screws (C) provided.

Note: (i) It is recommended to use only original junction box screws or replacements provided by junction box manufacturer.

(ii) The side of the ceiling plate marked "GND" must face out towards the installer.

CONNECTING THE WIRES (Fig. 2)

10. Attach the safety cable to the bracket on the ceiling plate to temporarily hang the fixture in place and aid in wiring.
11. Connect the Driver input wires to junction box as shown in Fig. 2. Making sure that all wire connectors (A) are secured. If your outlet box has a green or bare copper ground wire, connect the fixture's ground wire to it. Otherwise, connect the fixture's ground wire directly to the back plate using the GND screw provided. After wires are connected, tuck them carefully inside the junction box.

COMPLETING THE INSTALLATION

12. Secure the fixture to the ceiling plate using the canopy screw (B).

DIMMING WIRING INFORMATION (Fig. 3)

13. This fixture features electronic low voltage (ELV or TRIAC or 0-10V dimming capabilities. See notes below for specific dimming wires information.
14. To utilize ELV or TRIAC dimming: connect house wires as normal, using black (live), white (neutral) and house green wire or bare copper wire (ground). Do not use dimmer wires on driver for ELV or TRIAC dimming.
15. To utilize 0-10V dimming: use dimmer wires purple (dim+) and pink or gray (dim-) from driver and connect to corresponding wires in junction box. Connect house wires as normal.
16. NOTE: Make sure to connect 0-10V prior to powering up the fixture in order to allow the 0-10V dimming to function properly.

modernforms.com
Phone (800) 526.2588
Fax (800) 526.2585

Headquarters/Eastern Distribution Center
44 Harbor Park Drive
Port Washington, NY 11050

Central Distribution Center
1600 Distribution Ct
Lithia Springs, GA 30122

Western Distribution Center
1750 Archibald Avenue
Ontario, CA 91760



Cinema-LED Pendant

PD-30803R/PD-30805R/PD-30809R/PD-30815R/PD-30821R

MODERN FORMS

Ceiling plate Dimensions

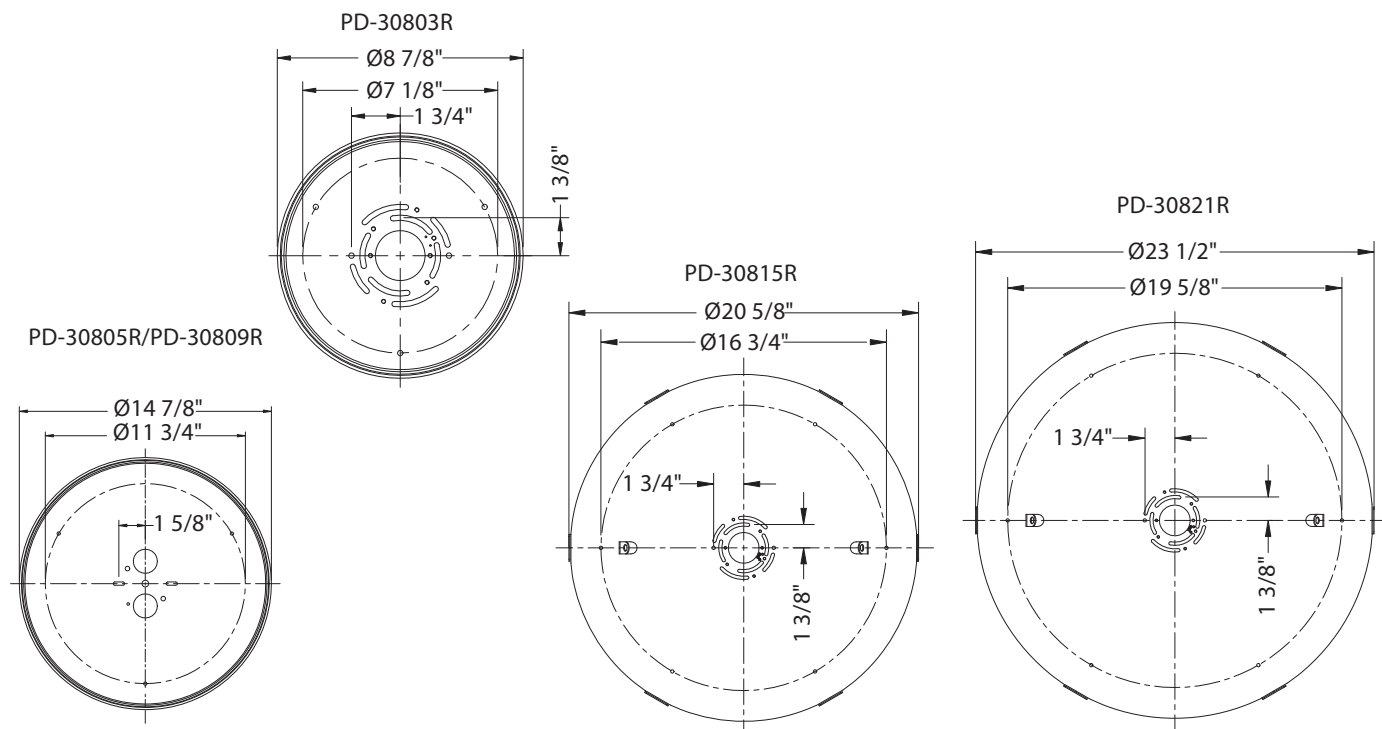
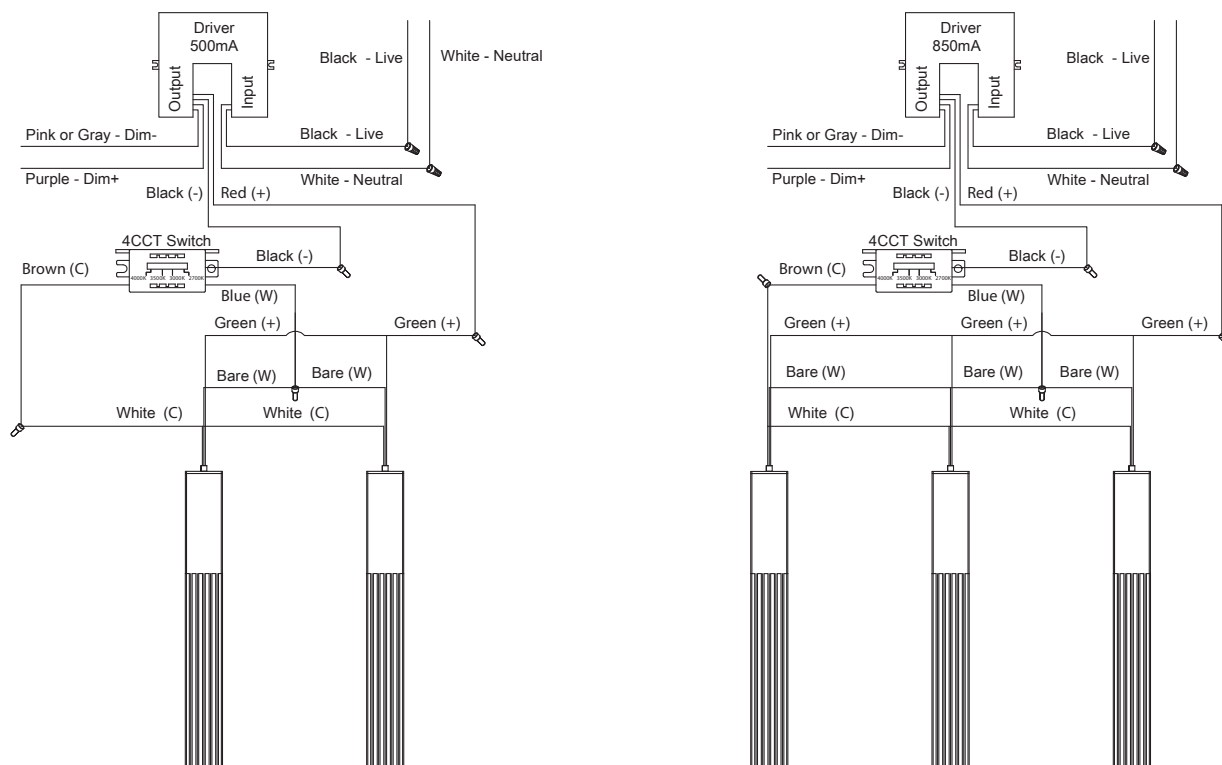

Fig. 4 Wire Diagram



modernforms.com
Phone (800) 526.2588
Fax (800) 526.2585

Headquarters/Eastern Distribution Center
44 Harbor Park Drive
Port Washington, NY 11050

Central Distribution Center
1600 Distribution Ct
Lithia Springs, GA 30122

Western Distribution Center
1750 Archibald Avenue
Ontario, CA 91760

