

WAC GROUP

ASSEMBLY INSTRUCTIONS

For F-STBLZ

MODEL: F-STBLZ

READ AND SAVE THESE INSTRUCTIONS

PARTS

- A) Mounting Bracket
- B) Mounting Bracket Clamp
- C) Downrod Ball
- D) Hardware Bag

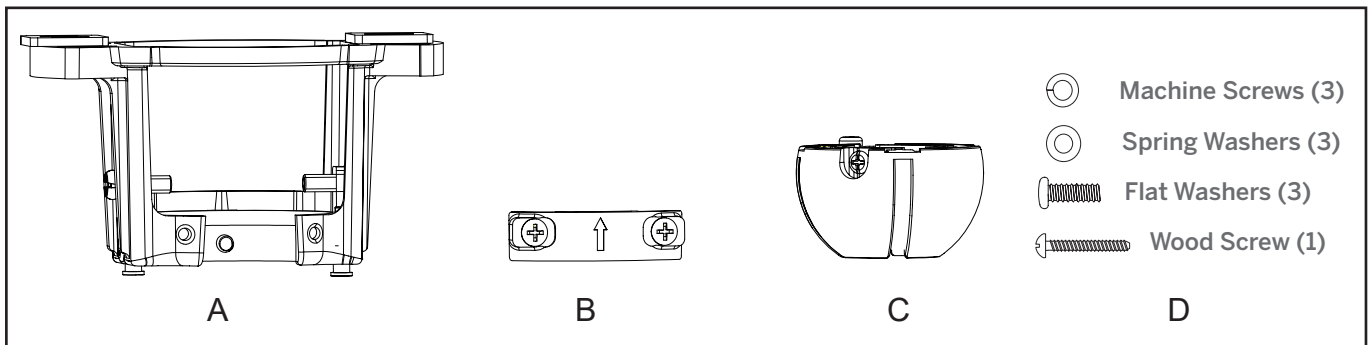

1. Installing the Mounting Bracket

CAUTION: Remember to disconnect the power at the circuit breaker.

1. Pass supply wires through mounting bracket and secure to outlet box. Verify supply wire colors and designations (Fig. 1).
2. Secure the mounting bracket to the ceiling outlet box with the screws and washers provided in the hardware bag. Use **D** hardware (Fig. 1A).

1

1A

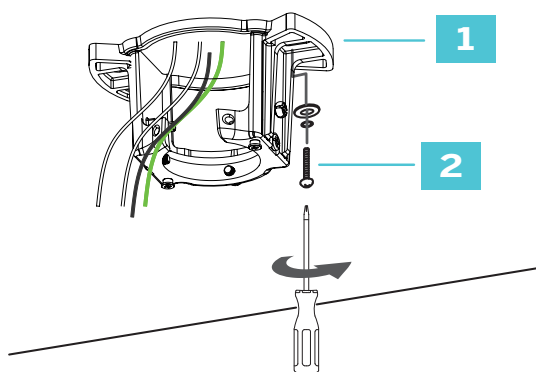

1. Mounting Bracket
2. Screw

(D) HARDWARE USED:
OutletBox Screws and Washers (2)

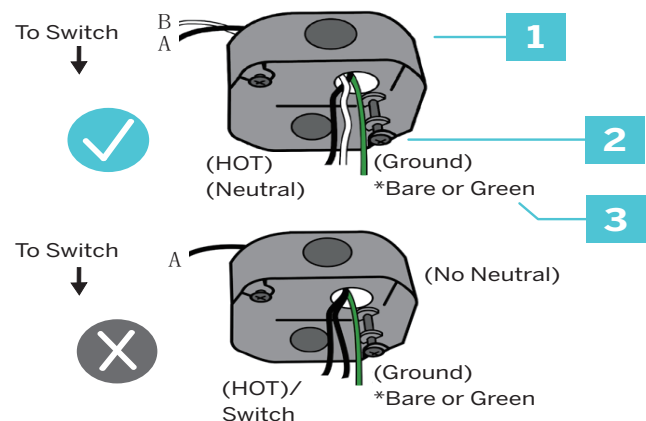

1. cUL Listed Electrical Box
2. Mounting Screws (outlet box screws not included)
3. 120 V Wires

2. How to Stabilize the Fan

NOTE: Ensure all steps shown in (Fig. 2) are completed. Reference your fan's installation manual for additional details.

1. Seat the downrod ball into the mounting bracket. Rotate the fan assembly until the ball drops into place and locks into the mounting bracket screw (Fig. 2A).
2. Secure the safety cable to the structure. Using the wood screw, flat washer, and spring washer provided (Hardware: D), fasten the safety cable directly into a structural ceiling beam (Fig. 2A).
3. Tighten the mounting bracket screws into the hanger ball. Confirm that each screw compresses the ball joint securely (Fig. 2B).
4. Secure the mounting bracket clamp onto the mounting bracket as shown (Fig. 2B).

NOTE: Safety cable and some wiring omitted from illustration for clarity.

2

2A

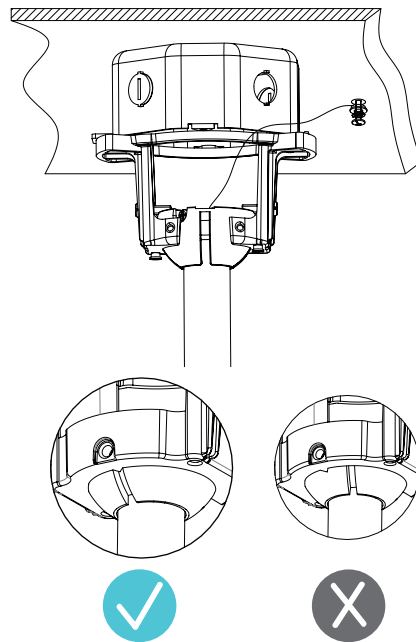
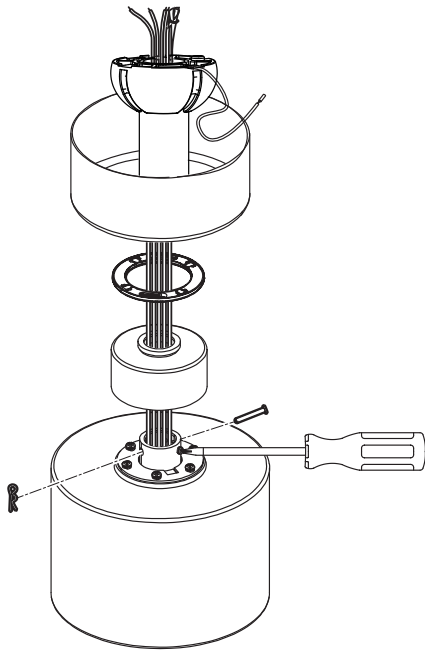

2B

