

INSTALLATION INSTRUCTIONS

Item#1916-732 1916-899(Convertible Lamps for Pendant) (New. 2025/11/22)

READ AND SAVE THESE INSTRUCTIONS

WARNING! SHUT POWER OFF AT FUSE OR CIRCUIT BREAKER.

AVERTISSEMENT! COUPER LE COURANT AU NIVEAU DES FUSIBLES OU DU DISJONCTEUR.

MOUNTING THE FIXTURE (Fig.1)

1. Shut off power at the fuse box or circuit breaker box and remove the old fixture including the mounting hardware.
2. Carefully unpack your new fixture and lay out all the parts in a clean area. Take care not to misplace any small parts necessary for installation.
3. Pass wire of fixture body (I) carefully through the frame (H). Determine the desired hanging height and thread rods (G/F) to the all thread (I) of fixture body. Attach canopy (C) by threading onto rod (G/F). Carefully feed wires through each rod as you assemble. Note: Remove all thread, if installing with one 6" rod only.
4. Unscrew the mounting screws (D) from the canopy (C) and detach the mounting plate (A). Attach mounting plate (A) to junction box (Not included) with outlet box screws (B) (Size: #8-32N*L1"). The side of the mounting plate (A) marked "GND" must face out.

CONNECTING THE WIRES (Fig. 2)

5. Connect the electrical wires as shown in fig 2, making sure that all wire connectors are secured. If your junction box has a ground wire (green or bare copper), connect the fixture's ground wire to it. Otherwise, connect the fixture's ground wire directly to the mounting plate (A) using the green screw (E) provided.
6. Tuck wire connectors neatly into the junction box.

FINISHING THE INSTALLATION (Fig.1)

7. Place canopy (C) over mounting plate (A) and secure with mounting screws (D).
8. Secure inner glass shade (J) and flat metal disc (K) over sockets by using socket ring (L).
9. Raise metal ring (M) and outer glass shade (P) up toward the arm of the frame(H) and secure the outer glass (P) onto the hole of arm of the frame (H) by using plastic washers(O) and lock nuts (N). Do not over tighten. Allow metal ring (M) rest on the lock nuts (N).
10. Install (1) one medium base bulb (Q) up to 60 watts each or CFL or LED equivalent (not included) in accordance with the fixture specification. — **DO NOT EXCEED THE MAXIMUM WATTAGE RATING! (NE PAS DEPASSER LA PUISSANCE NOMINALE MAXIMALE!)**

Your installation is now complete. Return power to the junction box and test the fixture.

Fig. 1

Set# A-021-122D

- Mounting plate
- Ground screw
- Mounting screws*2

Rod#

W32-H-732/899 (G-6")

W32-1-732 /899 X 3 (F-12")

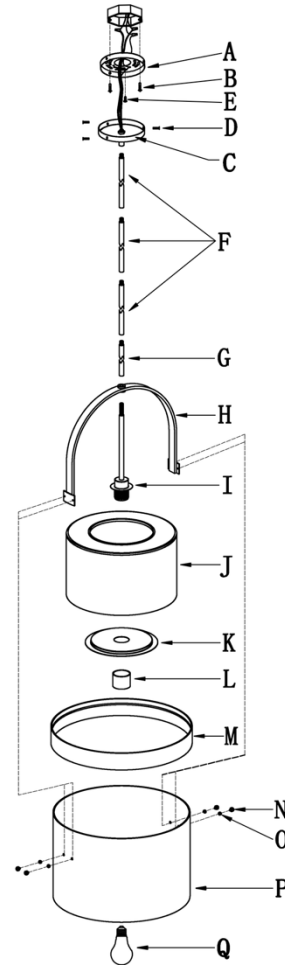
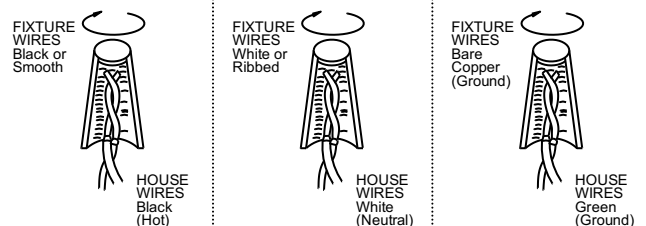

Fig. 2



Note: Illustration (Fig.1) on this manual is for installation purposes only. It may or may not be identical to the fixture purchased.

INSTALLATION INSTRUCTIONS

Item#1916-732 1916-899 (Convertible Lamps for Semi Flush Mount) (New. 2025/09/14)

READ AND SAVE THESE INSTRUCTIONS

WARNING! SHUT POWER OFF AT FUSE OR CIRCUIT BREAKER.

AVERTISSEMENT! COUPER LE COURANT AU NIVEAU DES FUSIBLES OU DU DISJONCTEUR.

MOUNTING THE FIXTURE (Fig.1)

1. Shut off power at the fuse box or circuit breaker box and remove the old fixture including the mounting hardware.
2. Carefully unpack your new fixture and lay out all the parts in a clean area. Take care not to misplace any small parts necessary for installation.
3. Pass wire of fixture body (I) carefully through the frame (H) and canopy (C). Thread canopy (C) onto all thread on top of fixture body (I).
4. Unscrew the mounting screws (D) from the canopy (C) and detach the mounting plate (A). Attach mounting plate (A) to junction box (Not included) with outlet box screws (B) (Size: #8-32N*L1"). The side of the mounting plate (A) marked "GND" must face out.

CONNECTING THE WIRES (Fig. 2)

5. Connect the electrical wires as shown in fig 2, making sure that all wire connectors are secured. If your junction box has a ground wire (green or bare copper), connect the fixture's ground wire to it. Otherwise, connect the fixture's ground wire directly to the mounting plate (A) using the green screw (E) provided.
6. Tuck wire connectors neatly into the junction box.

FINISHING THE INSTALLATION (Fig.1)

7. Place canopy (C) over mounting plate (A) and secure with mounting screws (D).
8. Secure inner glass shade (J) and flat metal disc (K) over sockets by using socket ring (L).
9. Raise metal ring (M) and outer glass shade (P) up toward the arm of the frame (H) and secure the outer glass (P) onto the hole of arm of the frame (C) by using plastic washers (O) and lock nuts (N). Do not over tighten. Allow metal ring (M) rest on the lock nuts (N).
10. Install (1) one medium base bulb (Q) up to 60 watts each or CFL or LED equivalent (not included) in accordance with the fixture specification. — **DO NOT EXCEED THE MAXIMUM WATTAGE RATING! (NE PAS DEPASSER LA PUISSANCE NOMINALE MAXIMALE!)**

The fixture is over 10 lbs. Please remove glasses before removing canopy from mounting plate to inspect wire connections in the future. This will allow you to hold the fixture body during wire connection or inspection or fixture removal.

Your installation is now complete. Return power to the junction box and test the fixture.

Note: Illustration (Fig.1) on this manual is for installation purposes only. It may or may not be identical to the fixture purchased.

Fig. 1

Set# A-021-122D

- Mounting plate
- Ground screw
- Mounting screws*2

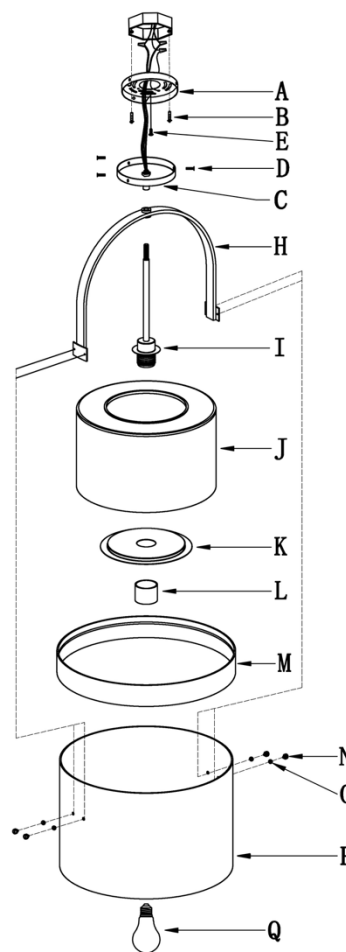

Fig. 2

