

TWO-LAYER PENDANT LAMP SPARE PART INSTRUCTION

— Thomas Bentzen

SPARE PARTS

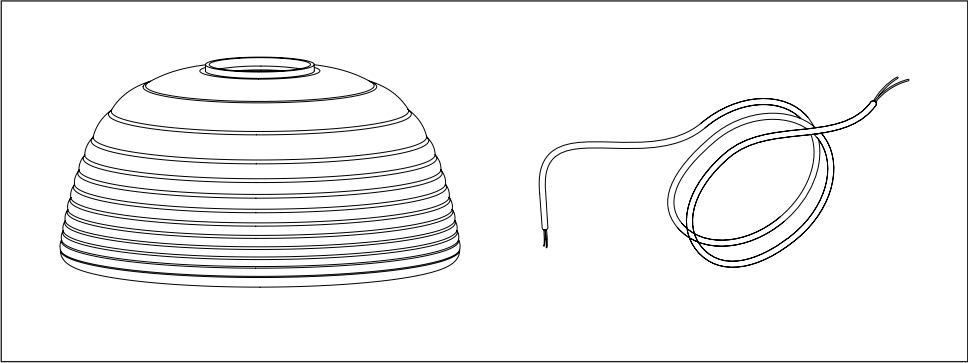

REPLACEMENT INSTRUCTION – GLASS SHADE

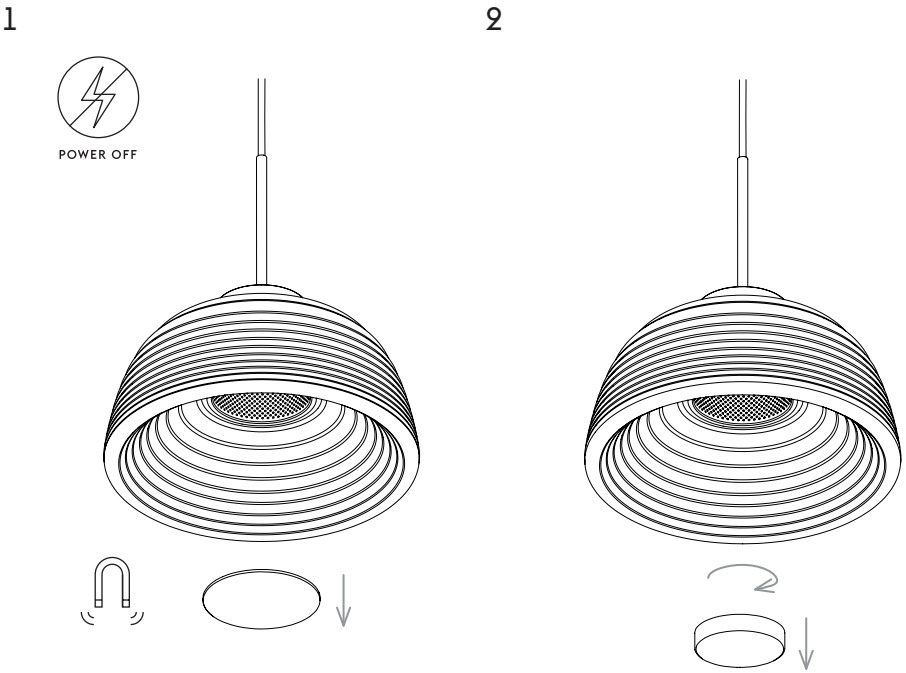

TWO-LAYER PENDANT LAMP
1x GX53 - MAX 9W LED
220-240V ~ 50/60HZ

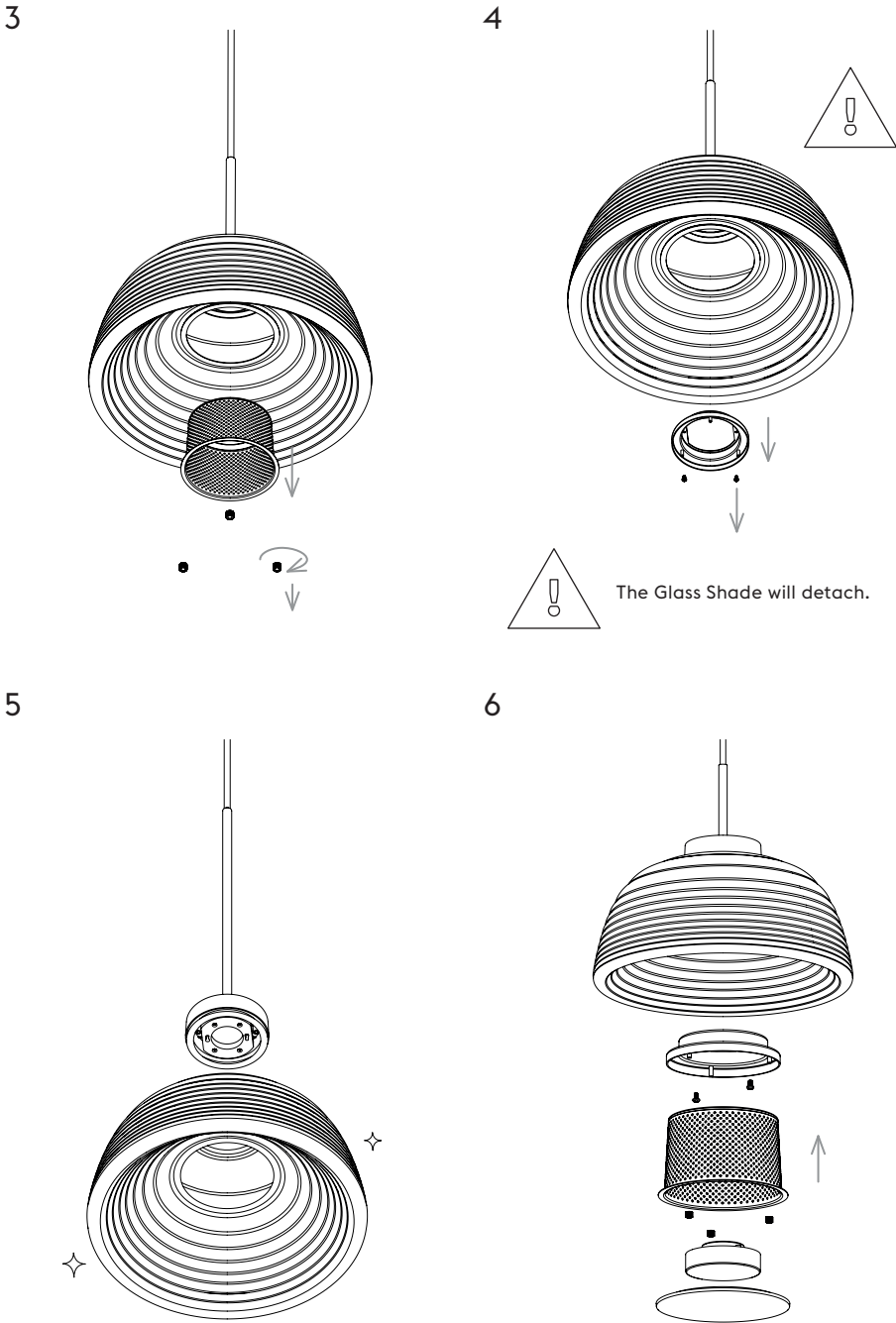

Replace the new glass shade.

Follow the previous steps
to assemble back.

REPLACEMENT INSTRUCTION-CORD

1

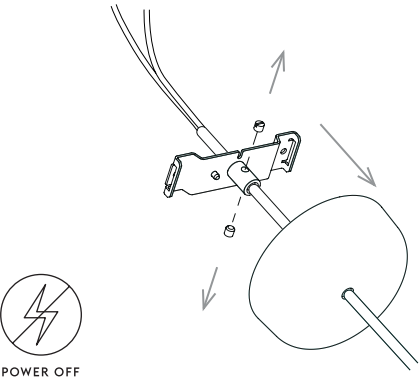

2

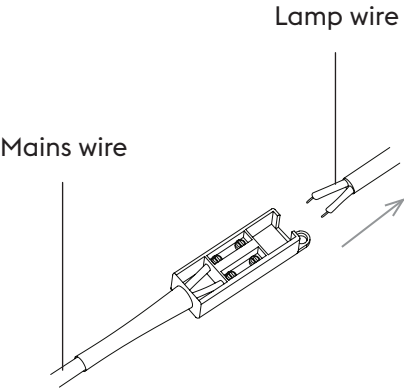

3

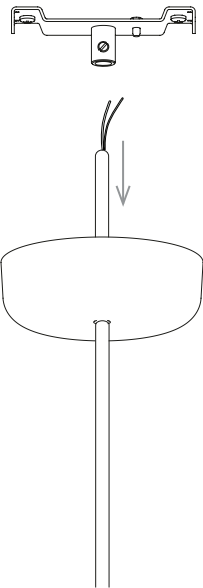

4

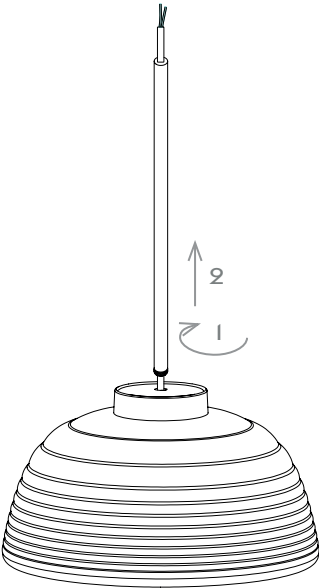

5

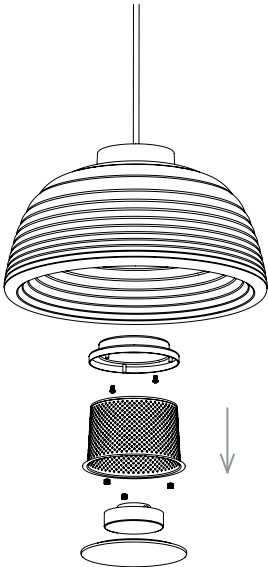

Follow the glass shade replacement instruction to disassemble.

6

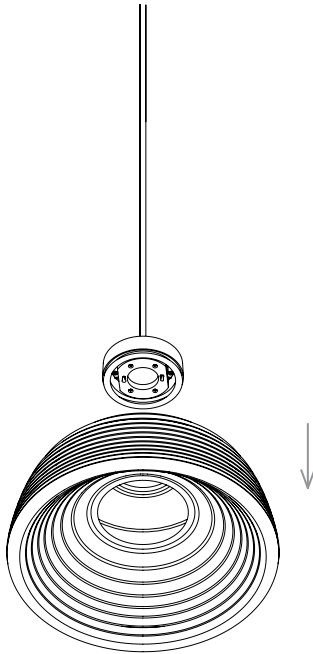

7

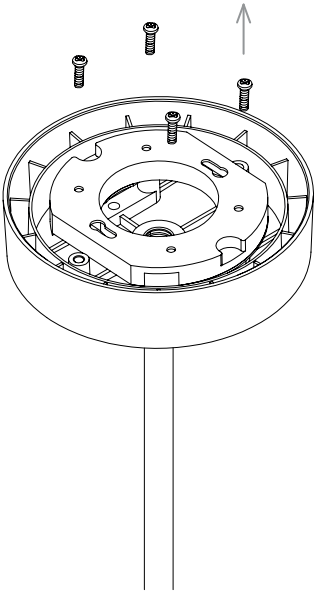

8

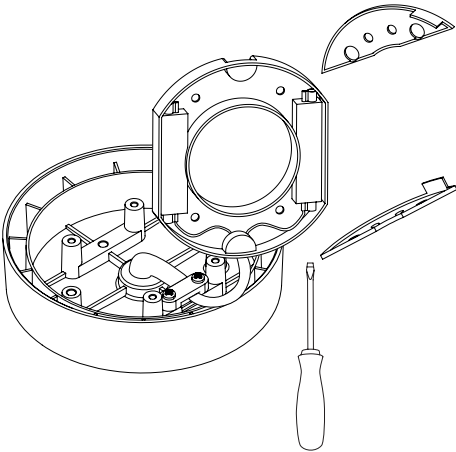

Pull up the bracket and use tool to take the lids off.

9

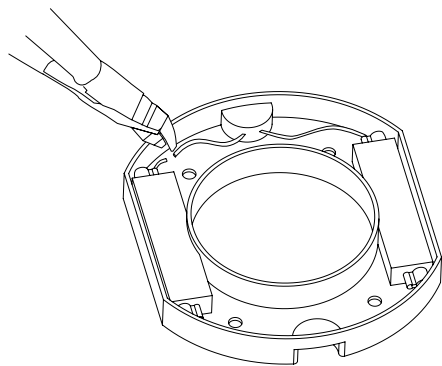

Use tool to cut the cord and discard.

10

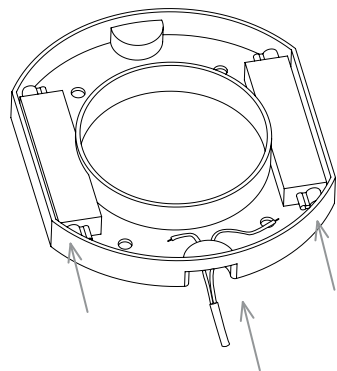

Insert the new cord on the other side of the hole.

12

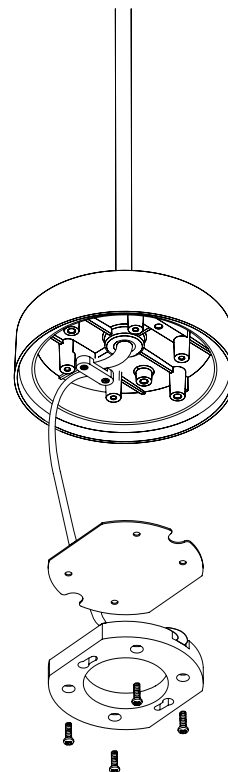

Assembly back after replacing the new cord.

13

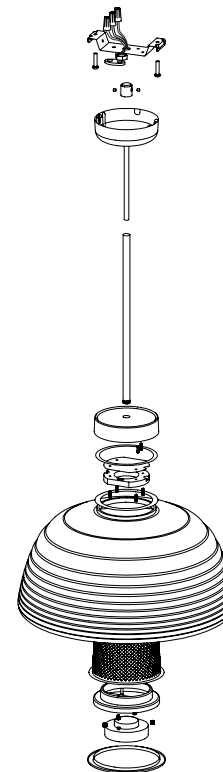

Follow the previous steps to assemble and reconnect the power.

11

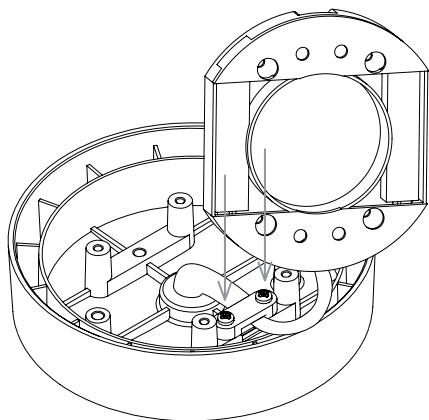

Put the lids back to the bracket and screw the wire release.

MUUTO HEAD OFFICE
ØSTERGADE 36-38, DK-1100
COPENHAGEN, DENMARK

FOR MORE INFORMATION
VISIT [MUUTO.COM](https://muuto.com)